

MJ. MATONOVICH W 1/2 SE 1/4 S. 10  
 APPROXIMATE STREAM CHANNEL

ANNE POWELL PROPERTY  
 WINDMILL WELL  
 HOUSE

T. GAY MEYERS-ET AL

SLUDGE BEDS

SEDIMENTATION BEDS

POLICE PISTOL RANGE

PROPOSED NURSERY

LINCOLN CO. POWER LINE 100' R/W  
 50° 06' E - S.M.P. DATA

GRAVEL ACCESS ROAD  
 (TO BE ABANDONED)

BASIS OF BEARINGS  
 PLANT MAP  
 N. 0° 36' 00" W 2736.75'  
 BLM  
 N. 60° 36' W 1751.2733.06'

**CITY OF LAS VEGAS NEVADA**  
**ENGINEERING DEPT**

PROPOSED DRAINAGE IMPROVEMENT  
 VICINITY SEWAGE TREATMENT PLANTS  
 S.W. 1/4 SECTION 10 T21S. R62E

NO.	BY	DESCRIPTION	DATE
1		PREVENT DITCH END AT P.C. 1996.4 EL. (SAID FILED)	

DESIGNED BY	DATE	SCALE 1" = 200'
DRAWN BY Hopkins	9/27/71	FIELD BOOK NO. 55-15X-2
CHECKED BY		WORK ORDER NO. 31-92-13
APPROVED		DRAWING NO. 325-4
CITY ENGR.		

PARAGON BLUE PRINT 200 12-54

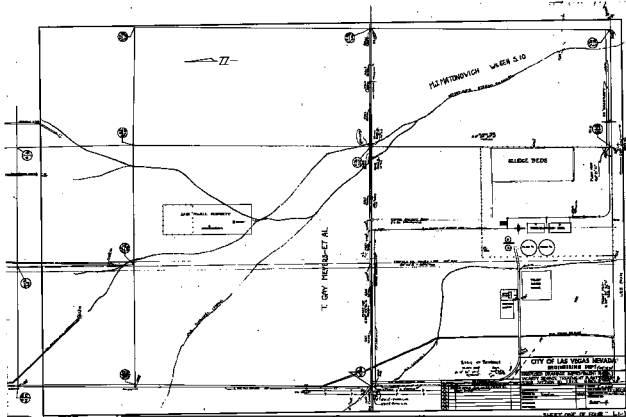

CITY OF LAS VEGAS NEVADA  
 ENGINEERING DEPT.  
 PLANNING DIVISION

Scale:	1" = 40'
Date:	1954
Sheet:	1 of 4