

BACK OF CURB RADIUS DATA

NO	DELTA	RADIUS	LENGTH	TANGENT
①	30°00'00"	25.00'	89.21'	15.00'
②	80°00'00"	15.00'	23.50'	15.00'
③	81°30'30"	25.00'	85.50'	21.64'

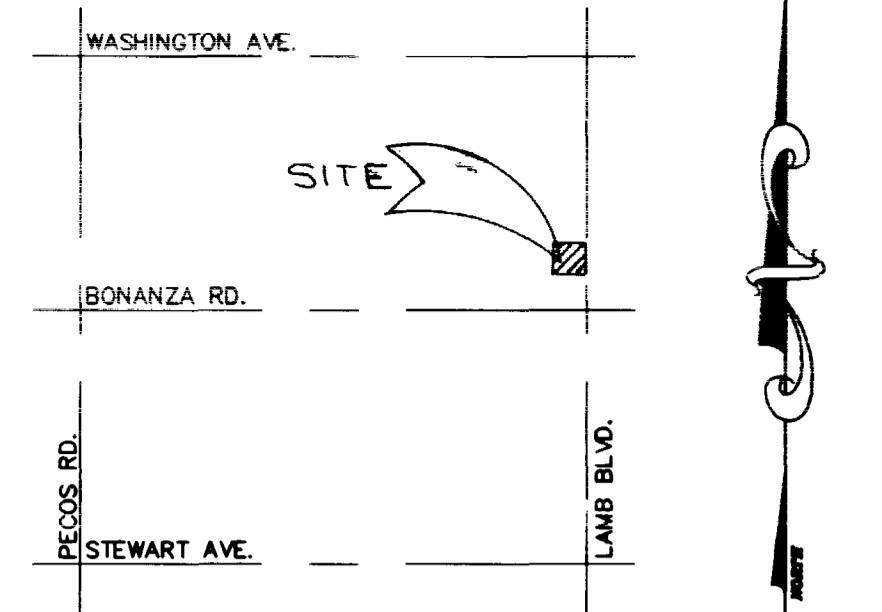

VICINITY MAP
NTS

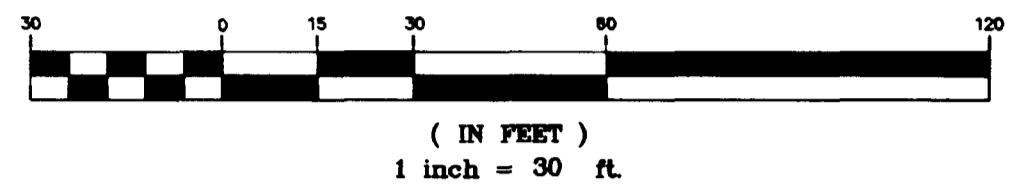

OWNER/DEVELOPER
TEAMSTERS LOCAL 631
307 WALL ST.
LAS VEGAS, NEVADA 89125
PHONE 702-385-1455

BENCHMARK
CITY OF LAS VEGAS VERTICAL DATUM,
STA. 2LV02295WMS, ELEV. = 542.83M EQUIVALENT IN
FEET 1780.94 (3,280.8 FT/M) (NAVD 88)
RIVET & PLATE IN TOP CURB, NORTHEAST RETURN
LAMB BLVD. AND HARRIS AVE.

BASIS OF BEARING
BEING N 00°33'07" E ALONG THE CENTERLINE OF LAMB BLVD,
BEING THE EAST LINE OF THE SOUTHEAST QUARTER (SE 1/4)
OF SECTION 30, T20S, R62E, M.D.M., COUNTY OF CLARK
STATE OF NEVADA.

LEGAL DESCRIPTION
BEING A PORTION OF THE NORTHEAST QUARTER (NE 1/4),
OF THE SOUTHEAST QUARTER (SE 1/4) OF THE SOUTHEAST
QUARTER (SE 1/4), OF SECTION 30, T20S, R62E, M.D.M.,
COUNTY OF CLARK, STATE OF NEVADA.

- GENERAL NOTES**
- GRADING PAVEMENT SECTIONS, AGGREGATE BASE AND STRUCTURAL FILL REQUIREMENTS FOR ALL OF THE STRUCTURES SHALL CONFORM TO THE GEOTECHNICAL REPORT AS PREPARED BY THE SOILS ENGINEER AND APPROVED BY THE CITY ENGINEER FOR THIS SITE.
 - THE QUANTITIES SHOWN HEREON ARE ESTIMATES ONLY AND ARE NOT TO BE USED FOR BIDDING PURPOSES.
 - CONTRACTORS SHALL VERIFY ALL CONDITIONS AND DIMENSIONS AND SHALL REPORT ALL DISCREPANCIES TO THE ENGINEER PRIOR TO THE COMMENCEMENT OF WORK.
 - ALL ELEVATIONS SHOWN HEREON WITHIN LANDSCAPED AREAS ARE 0.30 FEET BELOW FINAL FINISH GRADES TO ALLOW FOR THE ADDITION OF LANDSCAPING MATERIALS ATOP THESE ROUGH GRADES.
 - ALL GRADING AND SITE PREPARATION SHALL CONFORM TO THE REQUIREMENTS OF THE GEOTECHNICAL INVESTIGATION PREPARED BY: GEOSOLS, INC.-NEVADA, #578-LV DATED JUNE 17, 1996
 - ALL CURBS ARE "A" TYPE UNLESS OTHERWISE SHOWN.
 - CONCRETE FLAT WORK AT BUILDING (SIDEWALKS, TRASH PADS, ETC.) BY BUILDING CONTRACTOR.

- CONSTRUCTION NOTES**
- CONSTRUCT 8" VALLEY GUTTER PER STD. DWG. NO. 228
 - CONSTRUCT HANDICAP RAMP PER STD. DWG. NO. 235, CASE I
 - CONSTRUCT 4" CONCRETE SIDEWALK PER STD. DWG. NO. 234
 - CONSTRUCT 6" TYPE II A.B. CURBS PER STD. DWG. NO. 219
 - CONSTRUCT 24" TYPE II CURB & GUTTER PER STD. DWG. 216.
 - CONSTRUCT 24" VALLEY GUTTER PER STD. DWG. 216.
 - CONSTRUCT 4" SIDEWALK WITH TURN DOWN FACE PER STD. DWG. 216.

LEGEND

27	LOT NUMBER	GB	GRADE BREAK
①	CURB NUMBER	42.1	PAD GRADE
24.0	CONTOUR LINE (1' INTERVAL)	0.5%	DIRECTION AND RATE OF SLOPE
FG	FINISH GRADE	BVC	BEGIN VERTICAL CURVE
FL	FLOW LINE	MVC	MID-POINT OF VERTICAL CURVE
TC	TOP OF CURB	EVC	END VERTICAL CURVE
BC	BACK OF CURB		
BCR	BEGIN CURB RETURN		
EX	EXISTING		
VG	VALLEY GUTTER		
SCARP AREA			
EXISTING BLOCK WALL			
NG	NATURAL GROUND		
FF	FINISH FLOOR ELEVATION		
BFE	BASE FLOOD ELEVATION		

DRAINAGE CERTIFICATION
I CERTIFY THAT THIS GRADING PLAN IS IN CONFORMANCE WITH THE APPROVED DRAINAGE STUDY ON FILE AT THE CITY OF LAS VEGAS FOR THIS PROJECT.
MICHAEL J. CREHAN P.E. #10664
11/22/96
DATE

CALL BEFORE YOU DIG
1-800-227-2600
It's a Law

JOB NO.: 96071903
FILE: 9719G01
DESIGNER: PS
DRAWN BY: PAO/PS
CHECKED BY: MC
DATE: 9/6/96
SHEET NO. 2 OF 3

TEAMSTERS LOCAL 631

GRADING PLAN

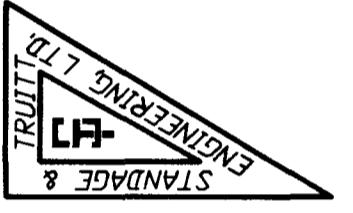

Standage & Truitt Engineering, Ltd.

CIVIL ENGINEERING AND SURVEYING
6855 W. CHARLESTON BOULEVARD
LAS VEGAS, NEVADA 89117
PHONE: (702) 255-2950
FAX: (702) 255-3090

REVISIONS

