

10-1117-2 (OFFICE 10)

10-1117-2 (01)

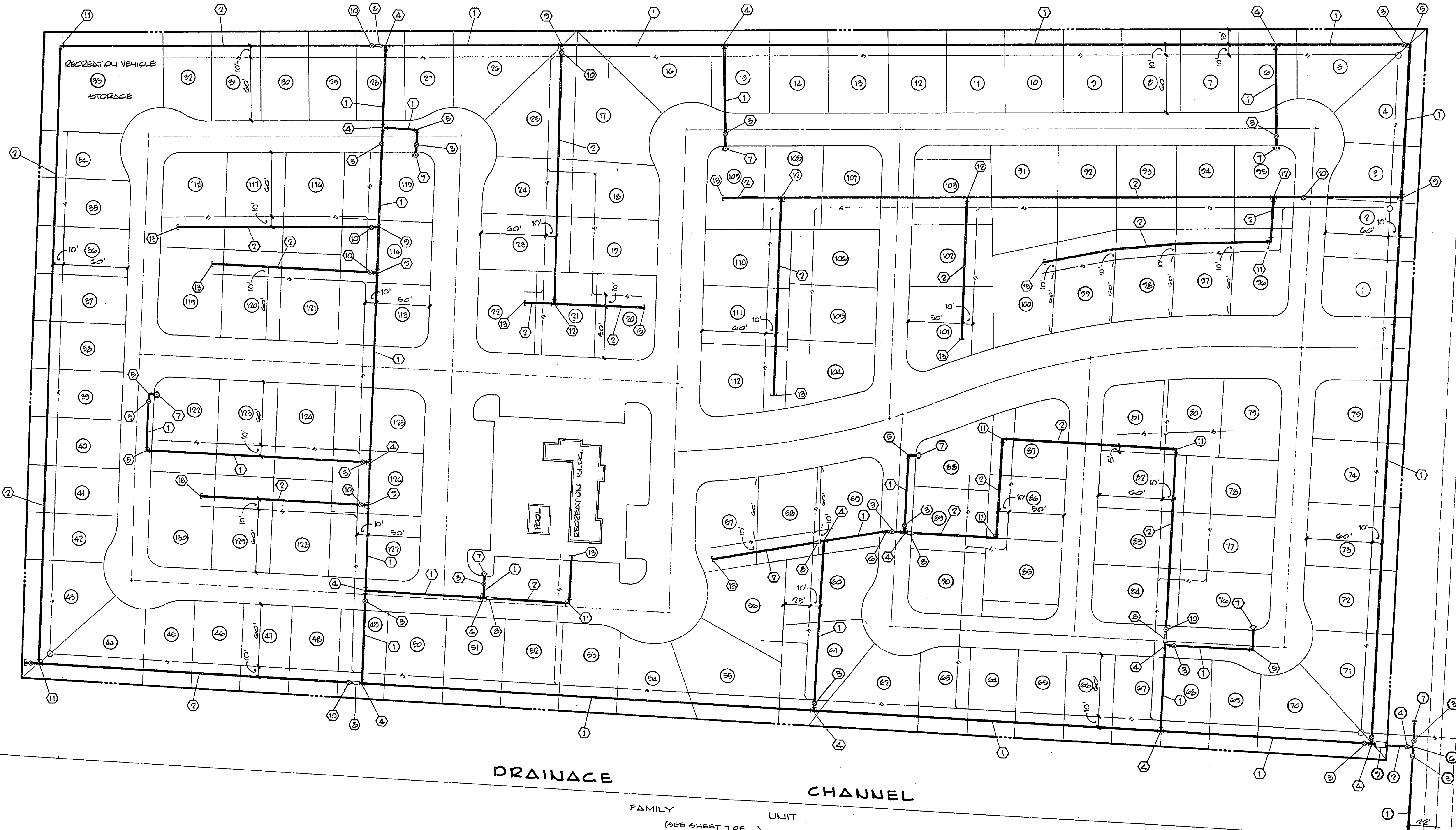

DRAINAGE CHANNEL
 FAMILY UNIT
 (SEE SHEET 7 OF)

ESTIMATED QUANTITIES (ADULT UNIT ONLY)

①	6" ACP WATER LINE	4223 L.F.
②	8" PVC WATER LINE	4013 L.F.
③	6" WRS GATE VALVE W/ VALVE BOX & COVER	10 EA.
④	6" x 6" x 6" TEE	15 EA.
⑤	6" 90° ELBOW	4 EA.
⑥	6" 22 1/2° ELBOW	1 EA.
⑦	FIRE HYDRANT	7 EA.
⑧	6" x 3" REDUCER	3 EA.
⑨	6" x 6" x 3" REFUSIC TEE	4 EA.
⑩	8" WRS GATE VALVE W/ VALVE BOX & COVER	8 EA.
⑪	8" 90° ELBOW	5 EA.
⑫	8" x 3" x 3" TEE	4 EA.
⑬	3" PLUG	10 EA.
⑭	3/4" SERVICE COLLECTIONS	129 EA.



JUN 05 1985

APPROVALS

M. Wells
 CITY OF LAS VEGAS ENGINEER DATE
 CITY OF LAS VEGAS FIRE DEPT DATE
 LAS VEGAS VALLEY WATER DIST. DATE
 8/10/78

107-V-1135 744 (MOBILE PK.)

SCALE 1" = 40'

PREPARED FOR: UNITED PLUMBING

PROJECT: SUNSHINE OAKS MOBILE HOME PARK ADULT UNIT

DATE: JULY 1977

DESIGN: BAUGHMAN & TURNER

CHECK: ANNA

SCALE: 1" = 40'

3233 WASHINGTON BOULEVARD LAS VEGAS, NEVADA 89103

WATER DESIGN SECTION 30, TOWNSHIP 20 SOUTH, RANGE 02 EAST, W. 12 R. 8 E. CITY OF LAS VEGAS, NEVADA

SUNSHINE OAKS MOBILE HOME PARK

PROJ. NO. 107-V-1135