

MATCH TO SH, SAME AS SHEET 19

STUB & CAP

CONTINUED ABOVE

APPROVED  
*William Harris* 3/8/78  
 CLV CITY ENGINEER DATE

*Thomas...* 2-27-78  
 CLV ELECTRICAL SUPERVISOR DATE

*...* 3/2/78  
 CLV ELECTRICAL COORDINATOR DATE

*...* 3-2-78  
 CLV FIELD OPERATIONS ENGINEER DATE

*...* 3/3/78  
 CLV QUALITY CONTROL ENGINEER DATE

*Michael B. Collins* 3-13-78  
 NEVADA POWER COMPANY DATE

Nevada Power Company approves the point of service to the street light system. This shall not be deemed to consent to the placement of light poles which may be in conflict with Nevada Power Company's prior rights and/or facilities.

3-13-78  
 (Date)  
*Michael B. Collins*  
 NEVADA POWER COMPANY

E CHARLESTON

EX. LITE

STUB & CAP

CONSULTING ENGINEERS • PLANNERS  
 2209 PARADISE ROAD LAS VEGAS, NEVADA 89102  
 702-735-1027

**vtn** nevada

STEWART PLACE-LIMIT 6A  
 STREETLIGHT & DRIVEWAY  
 LOCATION PLAN

SCALE:	WO. NO. 2377-6	DATE 1-26-78	SHEET	OF
HORIZ. 1"=50'	DES.	REV.	18	19
VERT.	CHK.	REV.		

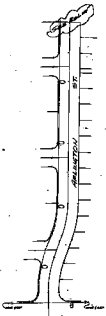
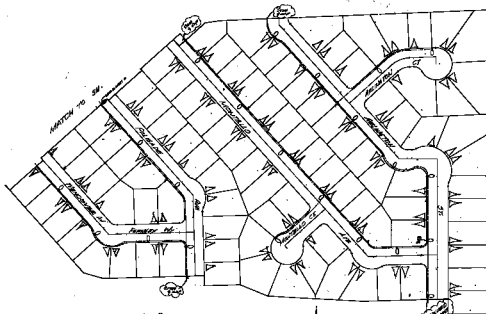

Lot Area	1.2
Front Lot	1.2
Back Lot	1.2
Side Lot	1.2
Other	1.2
Total	5.0

ALL DIMENSIONS ARE IN FEET  
 ALL CORNERS ARE TO BE SET BY THE SURVEYOR  
 ALL UTILITIES TO BE SHOWN BY THE SURVEYOR  
 ALL EASEMENTS TO BE SHOWN BY THE SURVEYOR  
 ALL NOTES TO BE SHOWN BY THE SURVEYOR



S. CHARLESTON  
 VTB  
 STREET LAYOUT & CONVEYANCE  
 CONVEYANCE PLAN  
 18 18  
 10-11-2015-24