

THE USE OF THESE PLANS AND SPECIFICATIONS SHALL BE RESTRICTED TO THE ORIGINAL SITE FOR WHICH THEY WERE PREPARED AND NO OTHER USE IS EXPRESSLY LIMITED TO SUCH USE. REPRODUCTION OR ALTERATION OF THESE PLANS IN ANY MANNER WITHOUT THE WRITTEN PERMISSION OF THE ENGINEER IS PROHIBITED. TITLE TO THE PLANS AND SPECIFICATIONS SHALL REMAIN WITH THE ENGINEER. NO LIABILITY SHALL BE ASSUMED BY THE ENGINEER FOR ANY DAMAGE TO PERSONS OR PROPERTY ARISING FROM THE USE OF THESE PLANS AND SPECIFICATIONS. THE ACCEPTANCE OF THESE PLANS AND SPECIFICATIONS DOES NOT CONSTITUTE AN ENDORSEMENT OF THE DESIGN OR CONSTRUCTION BY THE ENGINEER.

DATE	REVISION
JUN 9-22-83	REVISED PER C.L.U.
JUN 9-29-83	"
JUN 10-17-83	FINAL CLY REV.
JUN 10-21-83	FINAL REVISIONS
JUN 10-27-83	"

REVISIONS
 DEVEWAYS & ELEV.
 REVISED PER C.L.U.
 FINAL CLY REV.
 FINAL REVISIONS

PROJECT: SANDHILL VILLAS UNITS 1-6
 SANDHILL ROAD & SPINO AVE.
 PLAN & PROFILE
 SECTION 30
 NW 1/4 NE 1/4
 RANGE 62 EAST MOUNT DIABLO MERIDIAN
 CLARK COUNTY, NEVADA
 FOR PORTER CONSTRUCTION CO.
 1214 50 33rd ST., LAS VEGAS, NEV. 89101
 DRAWN BY: W.J. LANGFORD
 7-18-82

CAUSEY ENGINEERING SERVICE
 ENGINEERS-PLANNERS-SURVEYORS
 LAS VEGAS, NEVADA 89114
 APPROVED: [Signature]
 DATE: 9/28/83
 DAVIDE CAUSEY, P.E., L.S.
 1114 S. MOUNTAIN VIEW BLVD., SUITE 100, LAS VEGAS, NEV. 89102

JOB NO. 7893-1
 SHEET 4 OF 6

1079-2670-1.2.3.4.5.6

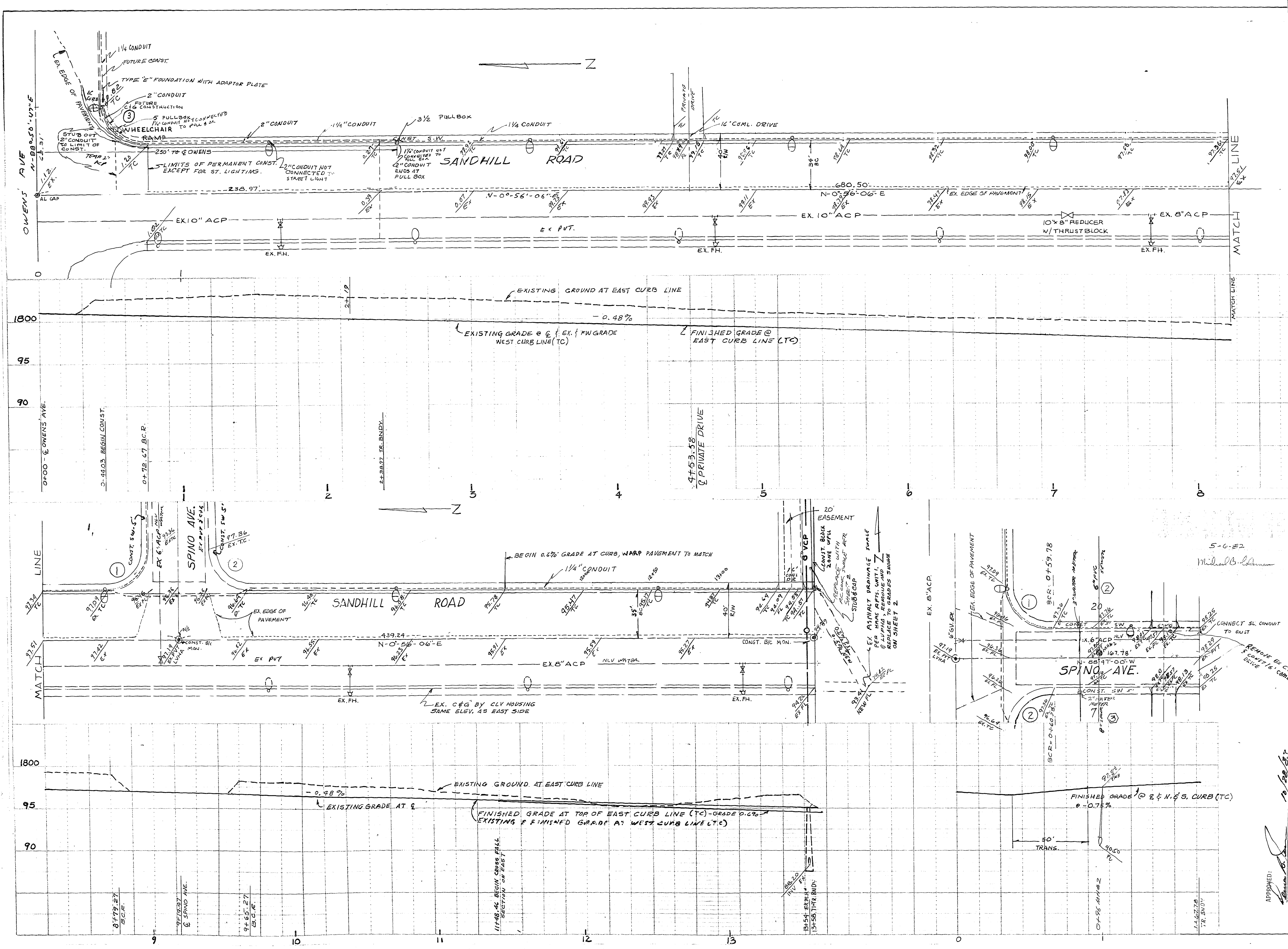

14.6-11