

PECOS DRIVE RIGHT OF WAY PROJECT

CHARLESTON BOULEVARD TO OWENS AVENUE

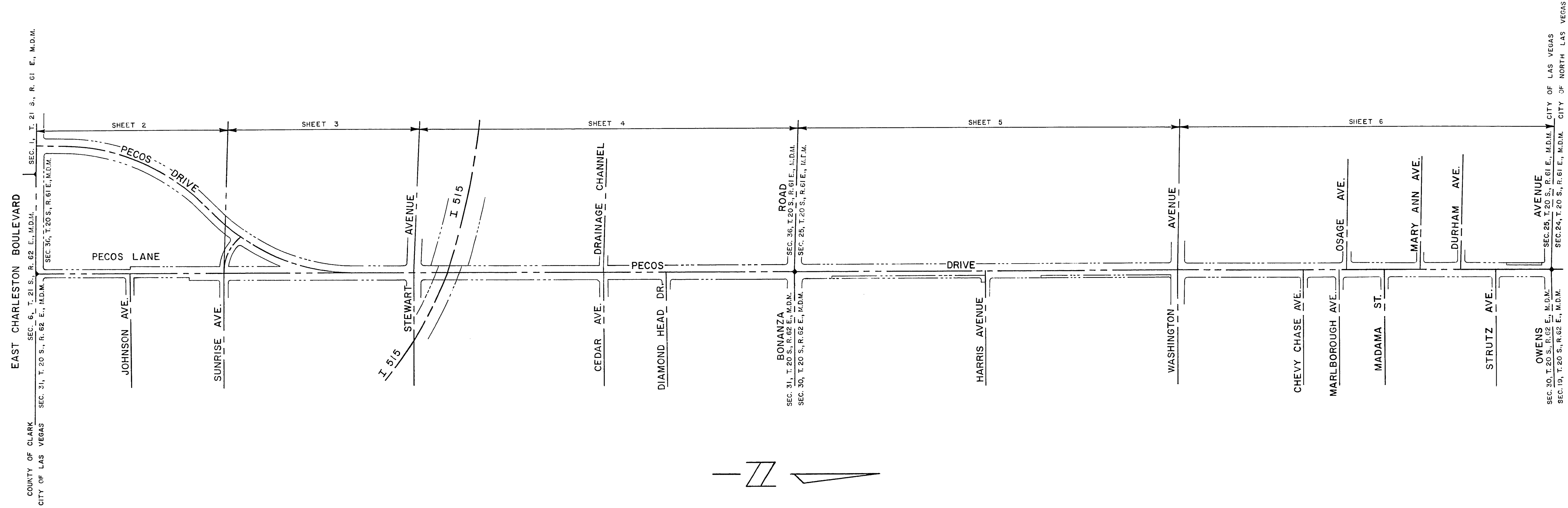

COUNTY OF CLARK
 CITY OF LAS VEGAS
 SEC. 6, T. 21 S., R. 62 E., M.D.M.
 SEC. 31, T. 20 S., R. 62 E., M.D.M.
 SEC. 30, T. 20 S., R. 61 E., M.D.M.
 SEC. 1, T. 21 S., R. 61 E., M.D.M.

LEGEND

- 2 LOT NUMBER
- 3 BLOCK NUMBER
- 2-845-24 TAX PARCEL NUMBER
- SUBDIVISION BOUNDARY
- UTILITY EASEMENT
- L.V.V.W.D. LAS VEGAS VALLEY WATER DISTRICT
- N.P.C. NEVADA POWER COMPANY
- P.U.E. PUBLIC UTILITY EASEMENT
- P.M. PARCEL MAP
- CENTEL CENTRAL TELEPHONE COMPANY
- R/W TO BE ACQUIRED

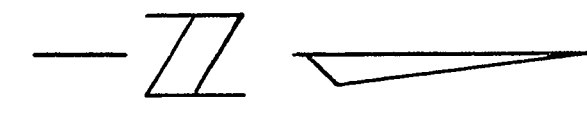

BASIS OF BEARINGS

NORTH 00° 02' 27" WEST-BEING THE WEST LINE OF SECTION 30,
 TOWNSHIP 20 SOUTH, RANGE 62 EAST, MOUNT DIABLO MERIDIAN
 AS PER C.L.V. DRAWING NUMBER 115-347.

DIRECTOR OF PUBLIC WORKS

APPROVED: GRANVILLE M. BOWMAN R.P.E. 5133

DATE: 9/29/82

Department of Public Services Engineering Design Division RIGHT OF WAY PECOS DRIVE	CHARLESTON BOULEVARD TO OWENS AVENUE	Scale (h) 1" = 400' Scale (v) 1" = 400' W.U. no. 1186	Checked by: <u>44</u>
	Design by <u>ggg</u> Approved by the City Engineer	Date Drawn by <u>mwb</u> Date	Revisions Date



Drawing no. 115-367 / 6