

WATER LINE NOTES

- All work to conform to Las Vegas Valley Water District latest Standard Plates and Specifications.
- All work, except as modified herein or by Note No. 1, shall be done in accordance with the most current draft or edition of Uniform Standard Specifications for Public Works Construction Office Improvements, Clark County Area.
- Notice to be given Engineering Department of the Las Vegas Valley Water District 48 hours prior to actual construction.
- Service saddles or capped collars will be required on all 3/4" and 1" service laterals. Service saddles only will be permitted on 1 1/2" and 2" service laterals. Double capped collars are not permitted.
- All lines to be pressure tested to 200 psi.
- Deflection angle shall not exceed 2 1/2 degrees per 13 foot section of pipe for pipe sizes smaller than 14 inches, and shall not exceed 2 degrees for pipe sizes between 14" and 16".
- All meters shall be located outside of driveways.
- Detector taps required in accordance with Standard Plate No. 27 where indicated and as follows:
 - Over all mains not installed at 6 feet from back of curb.
 - Over all service laterals not installed at right angle to main.
- Call Before You Dig 1-800-227-2600.

SEE SHEET U-2

Call before you Dig.
1-800-227-2600
UNDERGROUND SERVICE UTILITIES

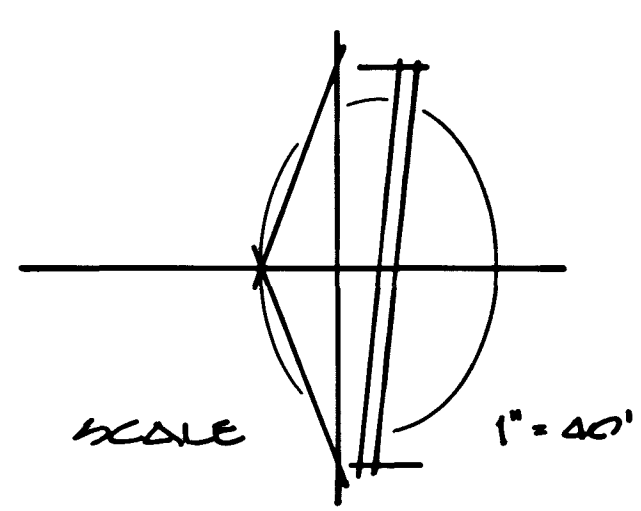

FIRE DEPT. NOTES

- All work shall be done in strict accordance with the City of Las Vegas Fire Department "Hydrant Specifications" and "Hydrant Installation Specifications", and Ordinance 93318.
- Authorized hydrants for this project are:
 - A - Kennedy Guardian
 - B - Mueller 4-425 Commercial
 - C - Clov Model 2546 Modelline
- On any new home or building construction, accessible fire hydrants shall be installed before combustible construction commences and said fire hydrants shall be in good working order with an adequate water supply.
- Contractor shall place a green reflective marker at centerline of street adjacent to fire hydrants.
- All fire hydrants must be connected to a dependable water supply capable of supplying the required fire flow. Call the Las Vegas Fire Department at 303-2888 for underground inspection, pressure and flow verification of all fire hydrants and fire lines before covering.
- Painting of the curbs and hydrant and any work necessary for protection of hydrants from physical damage per the "Hydrant Installation Specifications" shall be completed before approval by the City of Las Vegas Fire Department.
- Las Vegas Valley Water District to determine that hydrants are connected to a water supply capable of supplying the required fire flow.
- Fire hydrant spacing:
 - Residential 600 Ft. Maximum
 - Commercial 500 Ft. Maximum
 Fire hydrants shall be located within 500 ft. of any construction or combustible open storage, and shall be installed prior to construction.
- No fire hydrant shall be located within 6' of any curb return, driveway, power pole, street light, or any other obstruction.
- No fire hydrant shall be located within the required radius of a cul-de-sac or within 20 feet of the perimeter of the radius of a cul-de-sac.
- A permit must be obtained from the Fire Department for onsite fire water system installation prior to construction.

FIRE DEPT. DATA

BUILDING HEIGHTS 1 STORY

BUILDING	AREA	TYPE CONSTR	CALCD FIRE FLOW
UNIT A	102,951 SQ FT	III-U	2600 GPM
UNIT B	52,000 SQ FT	III-U	2600 GPM
UNIT C	4,076 SQ FT	III-U	1500 GPM
UNIT D	10,508 SQ FT	I-U	1500 GPM
UNIT E	71,658 SQ FT	III-U	3000 GPM
UNIT F	18,264 SQ FT	I-U	2300 GPM
UNIT G	50,000 SQ FT	III-U	2500 GPM
UNIT H	14,421 SQ FT	I-U	2000 GPM
UNIT L	21,000 SQ FT	II-U	1600 GPM

FIRE SPRINKLER SYSTEM ALL UNITS
TOTAL FIRE FLOW REQ'D 2600 GPM

ABANDON VALVE NOTE

The Contractor shall abandon all existing valves where shown on the drawings by removing a minimum of the top 12 inches of the valve box and then filling the remaining portion of the valve box with concrete having a compressive strength of at least 2,000 psi. All valves to be abandoned shall be abandoned in the closed position unless shown otherwise on the drawings. The Contractor shall then backfill and repair the area disturbed during abandonment of the valve in accordance with the most current draft or edition of Uniform Standard Specifications for Public Works Construction Office Improvements Clark County Area.

UTILITY NOTE

The location of underground utilities shown herein has been determined from surface evidence of their existence or from information obtained from the utility companies. The Engineer accepts no liability for the existence or non-existence of utility lines. Contractors and others using this map must confirm the location of underground lines or structures with the utility companies prior to commencing any excavation.

APPROVALS

2-05-90
LAS VEGAS VALLEY WATER DIST. DATE
CLV FIRE MARSHALL DATE

EXIST FIRE HYDRANT TO BE REMOVED PLUG & CAP EXIST. 6" WATER LINE. ABANDON EXIST GATE VALVE. (SEE 'ABANDON VALVE' NOTE THIS SHEET.)

WEST CHARLESTON BLVD

PARKWAY

FAIRCENTER

DECATUR BLVD

MATCH LINE

PROJECT NAME WESTLAND FAIR PHASE I
Date 1-16-90
1276 JB

NOTE A
ALL APPROVED TYPE PRESSURE REGULATOR OF 1/2" LD SHALL BE INSTALLED AND PRESSURE REDUCED TO 80 PSI OR LESS

CAUTION!
WATER PRESSURE WILL EXCEED 100 PSI. ALL BUILDINGS SHOULD BE PROTECTED WITH A PRESSURE REDUCING DEVICE PER THE UNIFORM PLUMBING CODE (SECTION 1007.02)

- NOTE:**
- The Contractor shall cut the existing pipe where shown on the drawing and install a mechanical joint cap. Where a joint or coupling in the existing pipe is uncovered at the cut and cap locations, the installation of a cap or plug may be permitted, with District approval.
 - The Contractor shall install a concrete thrust block in accordance with the provisions of the District's Standard plate No. 5 at all installed caps and / or plugs.

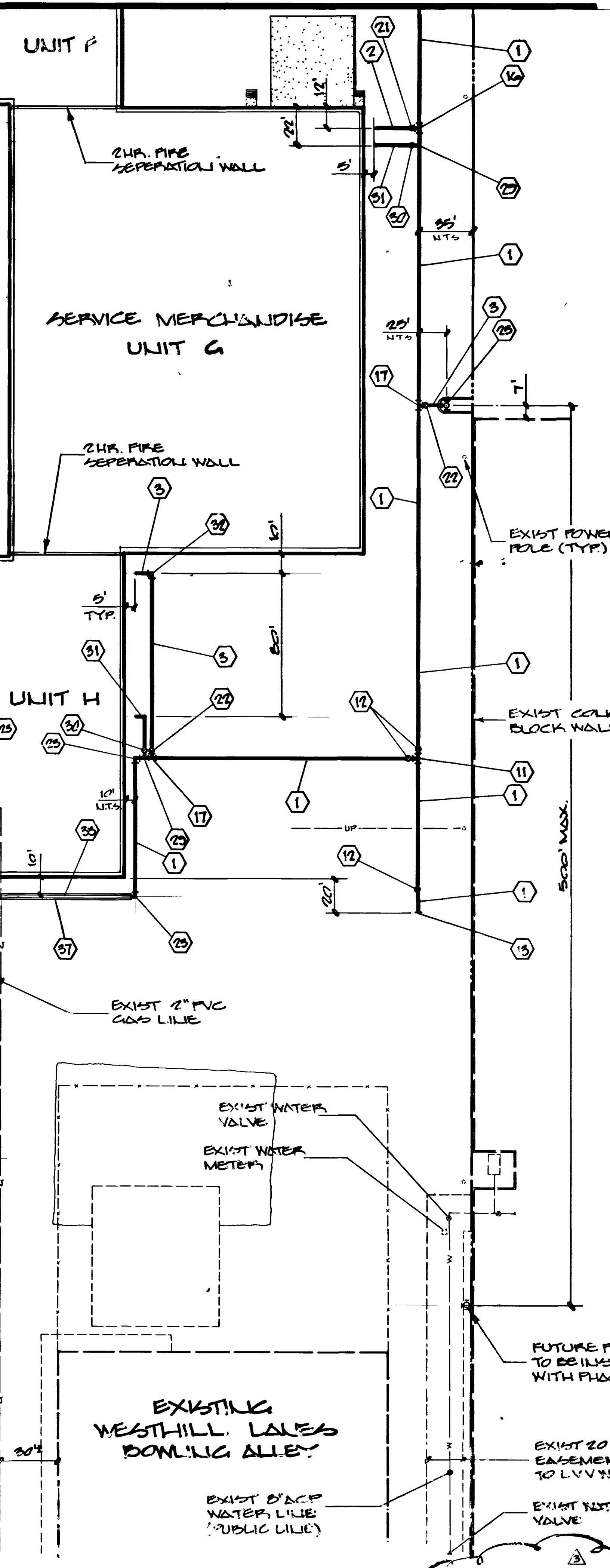

REVISIONS
DATE NO. DESCRIPTION
1-16-90 1 1276 JB
2-05-90 2 1276 JB

PREPARED BY: BAUGHMAN & TURNER
DATE: JAN 15, 1990
DESIGN: DAN M
DRAWN: DAN M
CHECK: DAN M
SCALE: 1" = 40'

BAUGHMAN & TURNER
MINING ENGINEERS
LAND SURVEYORS
3325 WEST CHARLESTON BOULEVARD
LAS VEGAS, NEVADA 89102
702-870-8771

WATER PLAN
SECTION G, TOWNSHIP 21 SOUTH, RANGE 12 EAST, M.D.B. 4 N.
CITY OF LAS VEGAS
WESTLAND FAIR PHASE I

SHEET 1 OF 1
20
PROJ. NO. 5614-4083-1

- WATER LINE NOTES:**
1. ALL WATER LINES SHALL BE 12" DIA. UNLESS OTHERWISE NOTED.
 2. ALL WATER LINES SHALL BE 15' DEEP UNLESS OTHERWISE NOTED.
 3. ALL WATER LINES SHALL BE 10' FROM EXISTING STRUCTURES UNLESS OTHERWISE NOTED.
 4. ALL WATER LINES SHALL BE 10' FROM EXISTING UTILITY LINES UNLESS OTHERWISE NOTED.
 5. ALL WATER LINES SHALL BE 10' FROM EXISTING DRIVEWAYS UNLESS OTHERWISE NOTED.
 6. ALL WATER LINES SHALL BE 10' FROM EXISTING SIDEWALKS UNLESS OTHERWISE NOTED.
 7. ALL WATER LINES SHALL BE 10' FROM EXISTING CURBS UNLESS OTHERWISE NOTED.
 8. ALL WATER LINES SHALL BE 10' FROM EXISTING DRIVEWAYS UNLESS OTHERWISE NOTED.
 9. ALL WATER LINES SHALL BE 10' FROM EXISTING SIDEWALKS UNLESS OTHERWISE NOTED.
 10. ALL WATER LINES SHALL BE 10' FROM EXISTING CURBS UNLESS OTHERWISE NOTED.

NOTE: EXISTING WATER LINES SHALL BE 12" DIA. UNLESS OTHERWISE NOTED. ALL WATER LINES SHALL BE 15' DEEP UNLESS OTHERWISE NOTED. ALL WATER LINES SHALL BE 10' FROM EXISTING STRUCTURES UNLESS OTHERWISE NOTED. ALL WATER LINES SHALL BE 10' FROM EXISTING UTILITY LINES UNLESS OTHERWISE NOTED. ALL WATER LINES SHALL BE 10' FROM EXISTING DRIVEWAYS UNLESS OTHERWISE NOTED. ALL WATER LINES SHALL BE 10' FROM EXISTING SIDEWALKS UNLESS OTHERWISE NOTED. ALL WATER LINES SHALL BE 10' FROM EXISTING CURBS UNLESS OTHERWISE NOTED.

CAUTION:
 ALL WATER LINES SHALL BE 12" DIA. UNLESS OTHERWISE NOTED. ALL WATER LINES SHALL BE 15' DEEP UNLESS OTHERWISE NOTED. ALL WATER LINES SHALL BE 10' FROM EXISTING STRUCTURES UNLESS OTHERWISE NOTED. ALL WATER LINES SHALL BE 10' FROM EXISTING UTILITY LINES UNLESS OTHERWISE NOTED. ALL WATER LINES SHALL BE 10' FROM EXISTING DRIVEWAYS UNLESS OTHERWISE NOTED. ALL WATER LINES SHALL BE 10' FROM EXISTING SIDEWALKS UNLESS OTHERWISE NOTED. ALL WATER LINES SHALL BE 10' FROM EXISTING CURBS UNLESS OTHERWISE NOTED.

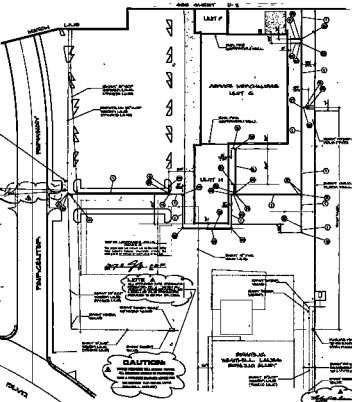

FIRE DRIFT NOTES:

1. ALL FIRE DRIFT LINES SHALL BE 12" DIA. UNLESS OTHERWISE NOTED.
2. ALL FIRE DRIFT LINES SHALL BE 15' DEEP UNLESS OTHERWISE NOTED.
3. ALL FIRE DRIFT LINES SHALL BE 10' FROM EXISTING STRUCTURES UNLESS OTHERWISE NOTED.
4. ALL FIRE DRIFT LINES SHALL BE 10' FROM EXISTING UTILITY LINES UNLESS OTHERWISE NOTED.
5. ALL FIRE DRIFT LINES SHALL BE 10' FROM EXISTING DRIVEWAYS UNLESS OTHERWISE NOTED.
6. ALL FIRE DRIFT LINES SHALL BE 10' FROM EXISTING SIDEWALKS UNLESS OTHERWISE NOTED.
7. ALL FIRE DRIFT LINES SHALL BE 10' FROM EXISTING CURBS UNLESS OTHERWISE NOTED.
8. ALL FIRE DRIFT LINES SHALL BE 10' FROM EXISTING DRIVEWAYS UNLESS OTHERWISE NOTED.
9. ALL FIRE DRIFT LINES SHALL BE 10' FROM EXISTING SIDEWALKS UNLESS OTHERWISE NOTED.
10. ALL FIRE DRIFT LINES SHALL BE 10' FROM EXISTING CURBS UNLESS OTHERWISE NOTED.

FIRE DRIFT DATA:

UNIT NO.	AREA	TYPE	DRIFT	DRIFT
UNIT A	WEST WYF	12" DIA.	10'	10'
UNIT B	WEST WYF	12" DIA.	10'	10'
UNIT C	EAST WYF	12" DIA.	10'	10'
UNIT D	EAST WYF	12" DIA.	10'	10'
UNIT E	EAST WYF	12" DIA.	10'	10'
UNIT F	EAST WYF	12" DIA.	10'	10'
UNIT G	EAST WYF	12" DIA.	10'	10'
UNIT H	EAST WYF	12" DIA.	10'	10'
UNIT I	EAST WYF	12" DIA.	10'	10'

ADDITIONAL WATER LINES:

ALL WATER LINES SHALL BE 12" DIA. UNLESS OTHERWISE NOTED. ALL WATER LINES SHALL BE 15' DEEP UNLESS OTHERWISE NOTED. ALL WATER LINES SHALL BE 10' FROM EXISTING STRUCTURES UNLESS OTHERWISE NOTED. ALL WATER LINES SHALL BE 10' FROM EXISTING UTILITY LINES UNLESS OTHERWISE NOTED. ALL WATER LINES SHALL BE 10' FROM EXISTING DRIVEWAYS UNLESS OTHERWISE NOTED. ALL WATER LINES SHALL BE 10' FROM EXISTING SIDEWALKS UNLESS OTHERWISE NOTED. ALL WATER LINES SHALL BE 10' FROM EXISTING CURBS UNLESS OTHERWISE NOTED.

UTILITY NOTES:

ALL UTILITY LINES SHALL BE 12" DIA. UNLESS OTHERWISE NOTED. ALL UTILITY LINES SHALL BE 15' DEEP UNLESS OTHERWISE NOTED. ALL UTILITY LINES SHALL BE 10' FROM EXISTING STRUCTURES UNLESS OTHERWISE NOTED. ALL UTILITY LINES SHALL BE 10' FROM EXISTING UTILITY LINES UNLESS OTHERWISE NOTED. ALL UTILITY LINES SHALL BE 10' FROM EXISTING DRIVEWAYS UNLESS OTHERWISE NOTED. ALL UTILITY LINES SHALL BE 10' FROM EXISTING SIDEWALKS UNLESS OTHERWISE NOTED. ALL UTILITY LINES SHALL BE 10' FROM EXISTING CURBS UNLESS OTHERWISE NOTED.

APPROVALS:
 [Signature]
 [Signature]

Vertical strip on the right edge of the drawing containing project information and a scale bar.

PROJECT NO. 100-1000
 SHEET NO. 100-1000
 DATE: 10/10/10
 SCALE: 1" = 10'-0"

DESIGNED BY: [Name]
 CHECKED BY: [Name]
 APPROVED BY: [Name]