

MATCH LINE 6+95.70  
SEE SHEET NO. 4

STA. 6+95.82 P.T.

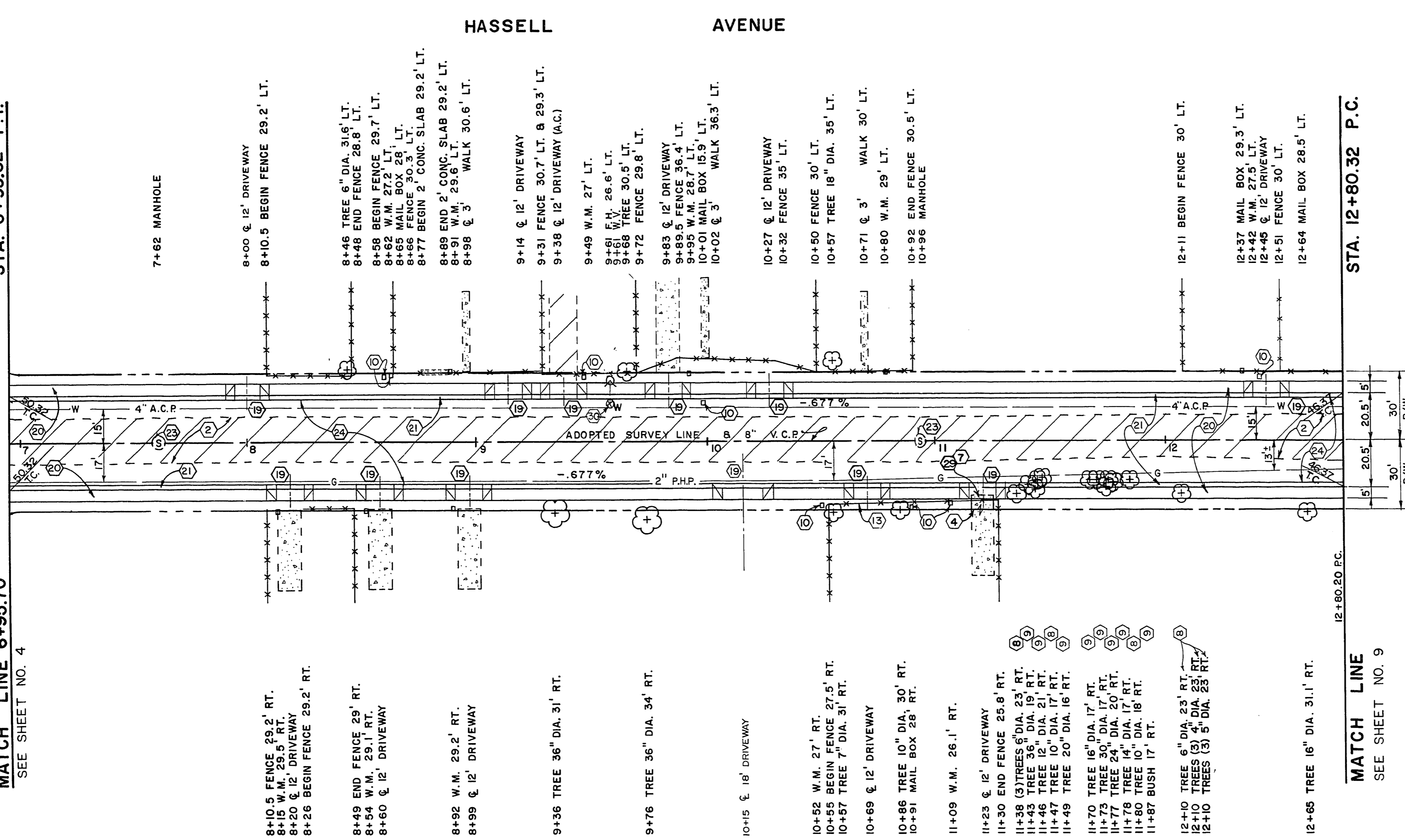

MATCH LINE  
SEE SHEET NO. 9

STA. 12+80.32 P.C.



Department of Public Works  
Engineering Division

VEGAS HEIGHTS  
HASSELL AVENUE

STA. 6+95.70 TO STA. 12+80.32

scale (h) 1" = 30'	scale (v) 1" = 2'	drawing no. SID 417
w.o.no. 4171	f.bk.no. 73-3X a	date 10 APR. 74
design by W.L. JAUBERT	drawn by	approved by Director of Public Works
date 6-20-75		sht. 27 of 63

Professional Engineer  
WILLIAM J. PURVIS  
8/1/74

RECEIVED  
JUN 27 1975

BM NO. 06121B2 RIVET IN PLATE  
NW COR. HIGHLAND DR. & Mc GUIRE DR.  
ELEV. 2053.64

ITEM	DESCRIPTION	CONST. NOTE NO.	C. L. V.	S. I. D.	TOTAL	UNIT
201.1001	EXCAVATION	(2)	363	194	557	CY
201.1002	REMOVE A.C. PAVEMENT	(4)	1299	10	1299	SY
200.1100	REMOVE CONCRETE	(7)	60	60	10	LF
200.1108	REMOVE CONCRETE DRIVEWAY-RESIDEN	(9)	12	12	60	SF
200.300	REMOVE TREE (4 IN - 10 IN.)	(9)	8	8	8	EA
200.400	REMOVE TREE (OVER 10 IN.)	(9)	82	82	82	LF
201.1006	REMOVE WOOD FENCE	(13)				
340.216	RESIDENTIAL DRIVEWAY	(19)		1722	1722	SF
340.114	CONCRETE SIDEWALK	(21)		4615	4615	SF
340.014	"L" TYPE CURB AND GUTTER (24IN)	(23)	923		923	LF
312.500	ADJUST SEWER MANHOLE	(24)	2		2	EA
334.112	6 INCH ASPHALT CONCRETE PAV. T.	(24)	841		841	TN
333.100	BITUMINOUS FOG SEAL	(24)	361		361	GL
302.100	TYPE I GRAVEL BASE	(24)	41	12	53	CY
302.200	TYPE II GRAVEL BASE	(24)	103		103	CY
340.124	4 IN CONCR DRIVEWAY TRANSITIONS	(24)	45		45	SF
360.060	ADJUST WATER VALVE BOX	(24)	1		1	EA