

- 7+65.3 BEGIN FENCE 41.2' RT.
- 7+74.6 MAIL BOX 36.5' RT.
- 7+91.3 TREE 3" DIA. 44.5' RT.
- 7+94.3 W.M. 39' RT.
- 8+02 MANHOLE
- 8+03.4 12' DRIVEWAY
- 8+15 FENCE 40.5' RT.
- 8+27 12' DRIVEWAY
- 8+55.5 TREE 22" DIA. 41.7' RT.
- 8+59.5 MAIL BOX 34' RT.
- 8+52.3 TREE 13" DIA. 43' RT.
- 8+67 TREE 18" DIA. 42.8' RT.
- 8+75.2 W.M. 37.7' RT.
- 8+82.3 TREE 12" DIA. 42.5' RT.
- 8+99.5 TREE 10" DIA. 43.2' RT.
- 9+16.7 TREE 12" DIA. 42.8' RT.
- 9+21 12' DRIVEWAY
- 9+32.9 TREE 13" DIA. 40.7' RT.
- 9+36 FENCE 38.5' RT.
- 9+46.7 14' DRIVEWAY
- 9+56 TREE 3" DIA. 39.3' RT.
- 9+59 W.M. 35.4' RT.
- 9+77.8 3' WALK
- 9+91.5 TREE 13" DIA. 47' RT.
- 10+04.7 14' DRIVEWAY
- 10+30.5 14' DRIVEWAY
- 10+48.8 W.M. 39' RT.
- 10+55.5 FENCE 39.3' RT.
- 10+65.8 12' DRIVEWAY
- 10+75.5 TREE 13" DIA. 40.4' RT.
- 10+88.8 TREE 13" DIA. 41.5' RT.
- 10+92 W.M. 37.9' RT.
- 11+01.6 TREE 9" DIA. 41.8' RT.
- 11+03.4 MANHOLE
- 11+10 TREE 9" DIA. 41.4' RT.
- 11+18.7 TREE 9" DIA. 41.4' RT.
- 11+22.5 END FENCE 40.3' RT.

- 7+33 MAIL BOX 36.2' LT.
- 7+49 TREE 9" DIA. 41.8' LT.
- 7+66.2 W.M. 39.8' LT.
- 7+76.8 FENCE 40.5' LT.
- 7+85.1 TREE 6" DIA. 41' LT.
- 7+91 W.M. 37' LT.
- 8+07 TREE 6" DIA. 43' LT.
- 8+33 TREE 13" DIA. 44' LT.
- 8+37.7 MAIL BOX 40' LT.
- 8+48.5 16' DRIVEWAY
- 8+59 FENCE 41' LT.
- 8+95.5 FENCE 41.5' LT.
- 9+02.1 16' DRIVEWAY
- 9+19.5 MAIL BOX 39.7' LT.
- 9+38.5 W.M. 36.4' LT.
- 9+75 END FENCE 38.5' LT.
- 10+37.7 BEGIN FENCE 35' LT.
- 10+39.7 TREE 9" DIA. 35.7' LT.
- 10+49 12' DRIVEWAY
- 10+69.6 MAIL BOX 32.4' LT.
- 10+92.2 W.M. 33.3' LT.
- 10+97 END FENCE 33' LT.

SEE SHEET NO. 10

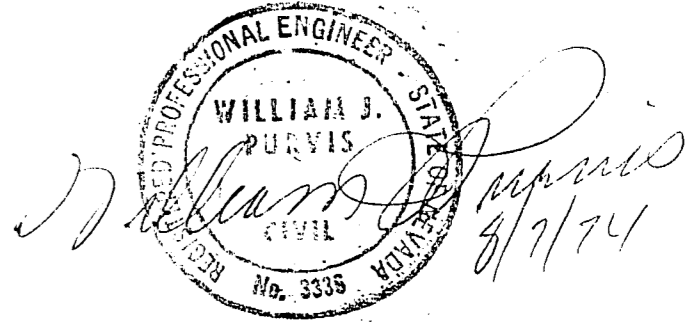
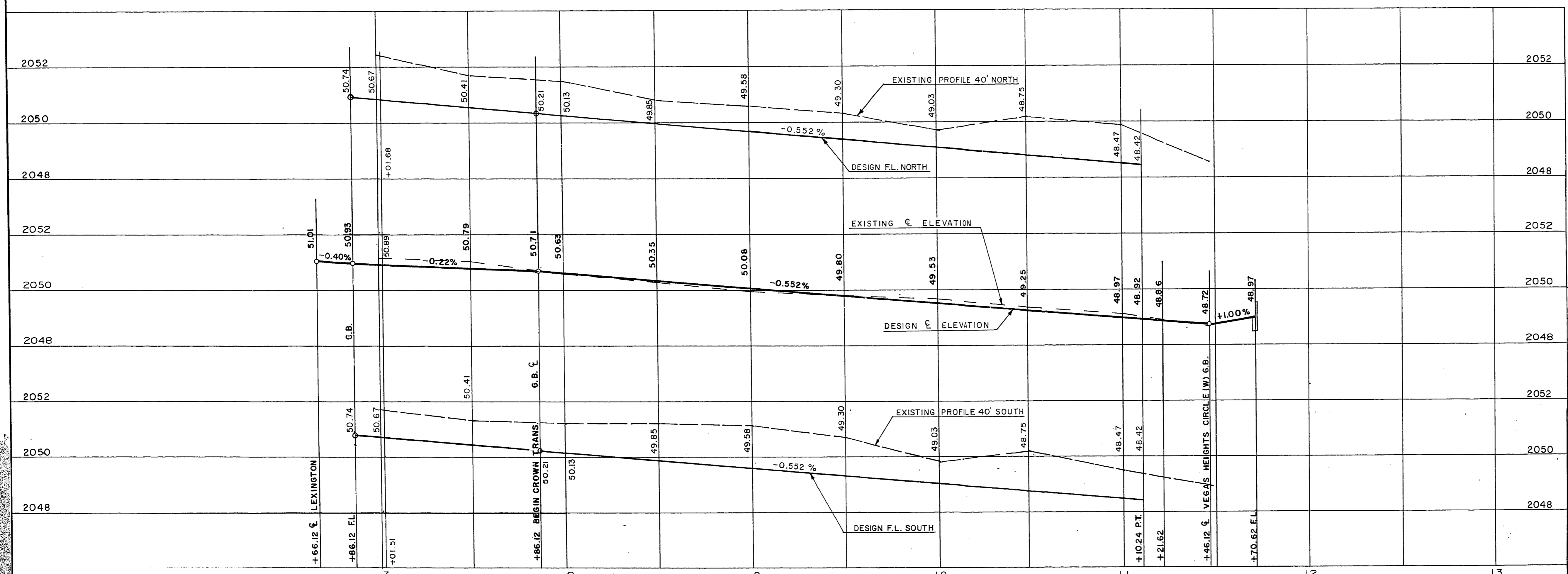

CONTRACT DRAWING
JUN 27 1974

BM NO. 0612183 RIVET IN PLATE
SW CORNER HIGHLAND DR. & BALZAR AVE.
ELEV. 2053.87

REVISIONS

| NO. | DESCRIPTION | BY | DATE | APPROVAL |
|-----|-------------|----|------|----------|
| | | | | |

CITY OF LAS VEGAS NEVADA
DEPARTMENT OF PUBLIC WORKS
SERVICES DIVISION

**VEGAS HEIGHTS
BALZAR AVENUE**
STA. 7+01.51 TO STA. 11+46.57

| | | | |
|-------------------|--------------------------------------|------------|-------------------|
| W.O. NO. 4171 | F.B.K. NO. 73-3X | DATE | DRAWING NO. |
| SC. (H) 1" = 30' | SC. (V) 1" = 2' | 10 APR. 74 | S.I.D. 417 |
| DES. W.L. JAUBERT | APPROVED BY DIRECTOR OF PUBLIC WORKS | FILE NO. | |
| DR. | | 6-20-75 | SHEET 35 OF 63 |