

APPROVED
 Date: 7/20/66
 1.00

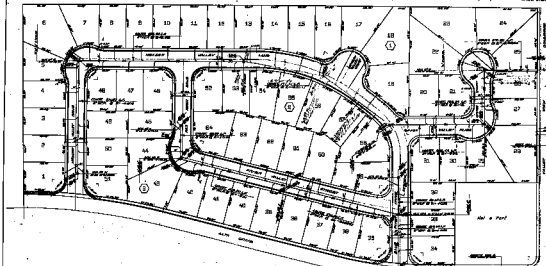

SYMBOLS

SYMBOL	DESCRIPTION
(Circle with cross)	MANHOLE
(Circle with dot)	WATER MAIN
(Circle with 'S')	SEWER
(Circle with 'E')	ELECTRIC
(Circle with 'G')	GAS
(Circle with 'T')	TELEPHONE
(Circle with 'C')	CITY
(Circle with 'P')	POST OFFICE
(Circle with 'S')	SCHOOL
(Circle with 'H')	HOSPITAL
(Circle with 'R')	RAILROAD
(Circle with 'A')	ARCADE
(Circle with 'M')	MUSEUM
(Circle with 'L')	LIBRARY
(Circle with 'C')	CINEMA
(Circle with 'S')	STATION
(Circle with 'P')	PARK
(Circle with 'G')	GOLF COURSE
(Circle with 'A')	ARMY
(Circle with 'N')	NAVY
(Circle with 'A')	AIR FORCE
(Circle with 'S')	SEWER
(Circle with 'E')	ELECTRIC
(Circle with 'G')	GAS
(Circle with 'T')	TELEPHONE
(Circle with 'C')	CITY
(Circle with 'P')	POST OFFICE
(Circle with 'S')	SCHOOL
(Circle with 'H')	HOSPITAL
(Circle with 'R')	RAILROAD
(Circle with 'A')	ARCADE
(Circle with 'M')	MUSEUM
(Circle with 'L')	LIBRARY
(Circle with 'C')	CINEMA
(Circle with 'S')	STATION
(Circle with 'P')	PARK
(Circle with 'G')	GOLF COURSE
(Circle with 'A')	ARMY
(Circle with 'N')	NAVY
(Circle with 'A')	AIR FORCE



SEWER PLAN
 VALLEY WEST, UNIT NO. 9
 L.A. 100-4, 100-5
 DIVISION OF PUBLIC WORKS
 COUNTY OF LOS ANGELES