

Avoid cutting underground utility lines. It's costly.

Call before you Dig.

1-800-227-2600

UNDERGROUND SERVICE ALERT (USA)

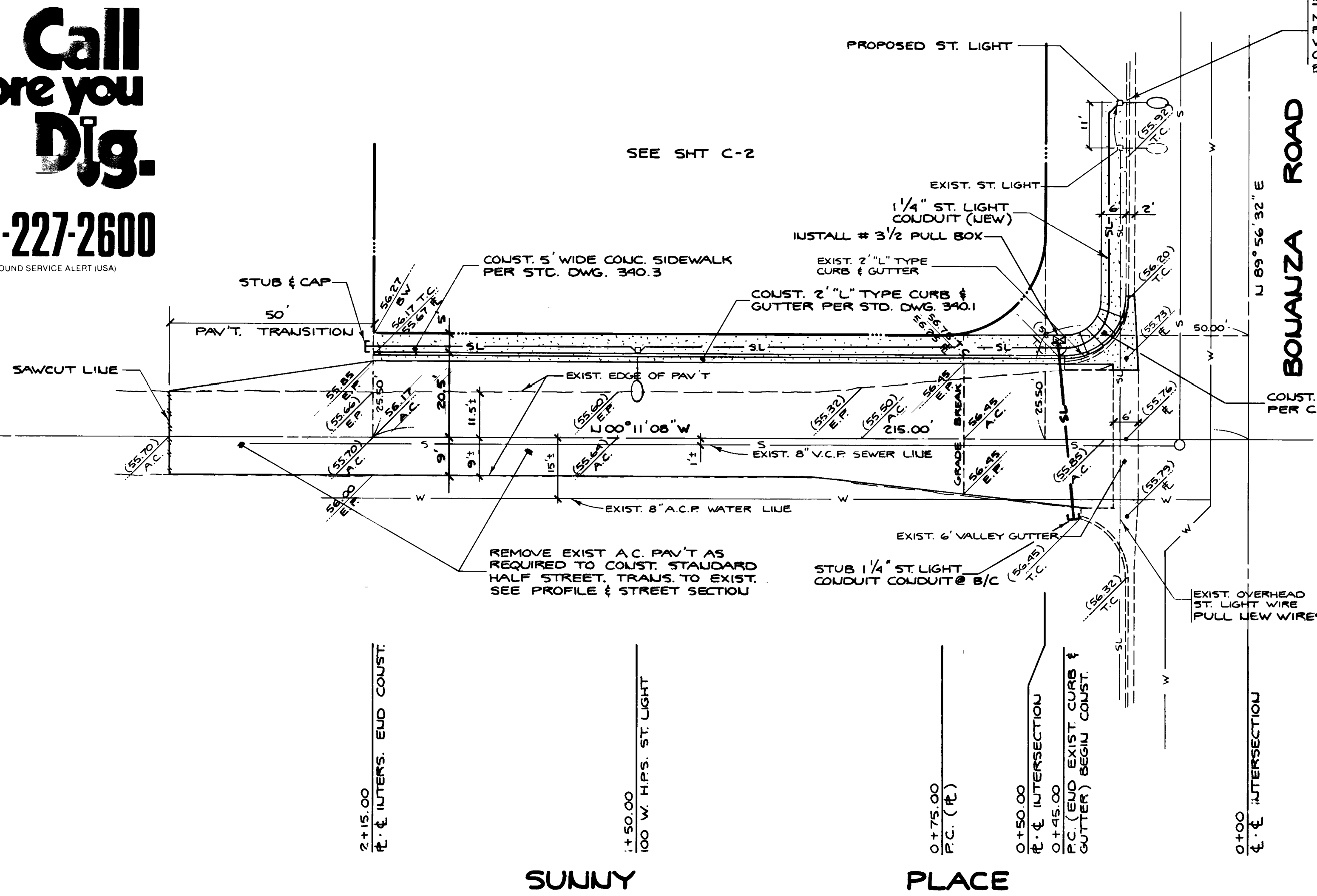

ESTIMATED QUANTITIES

GENERAL NOTES

- All construction and materials shall be in accordance with the "Uniform Standard Specifications for Public Works Construction Off-site Improvements, Clark County Area Nevada, issued 1978; the "Uniform Standard Drawings for Public Works Construction", City of Las Vegas, any other applicable approved standards issued by the controlling agency; the Uniform Building Code; and all Local City Codes and Ordinances Applicable.
- The existence and location of any underground utility pipes or structures shown on these plans are obtained by a search of the available records. To the best of our knowledge there are no existing utilities except as shown on these drawings. The contractor is required to take precautionary measures to protect the utility lines shown and any other lines not of record or not shown on these drawings.
- All grades are referenced to the top of the construction grade stakes or nails and this rule shall be observed. Three consecutive construction grade stakes or nails corresponding to three consecutive points shown on the approved plans as a straight grade shall be used in common and any variation shall be reported in writing before work proceeds. Contractors doing otherwise shall proceed at their total risk and responsibility.
- The quantity estimates shown hereon are approximate and one is to rely upon them for pay quantities. Each and every contractor shall have a set of approved plans and specifications on the job site at all times and shall rely upon them to a higher degree than the construction stakes in prosecuting the work.
- All construction shall be as shown on these plans, any alterations shall have the prior approval of the City Engineer.
- Contractor shall provide all necessary Horizontal and Vertical Transitions for proper drainage, extent of transitions shall be as shown or as determined by City Engineer or Inspector.
- If any curb grades are shown on plans at less than 0.40%, it is required by this office that the forms be checked by a survey crew prior to concrete placement. A 48 hour notification of work is required, and if this office is not notified, it will assume no responsibility for finished product.

APPROVALS

[Signature]
C.L.V. ENGINEER
DATE: 2 APRIL 1993

[Signature]
C.L.V. TRAFFIC ENGINEER
DATE: 4/4/93

[Signature]
C.L.V. ELECTRIC SUPERVISOR
DATE: 4-7-93

[Signature]
C.L.V. ELECTRIC COORDINATOR
DATE: 3/31/93

NA
C.L.V. QUALITY CONTROL ENGINEER
DATE:

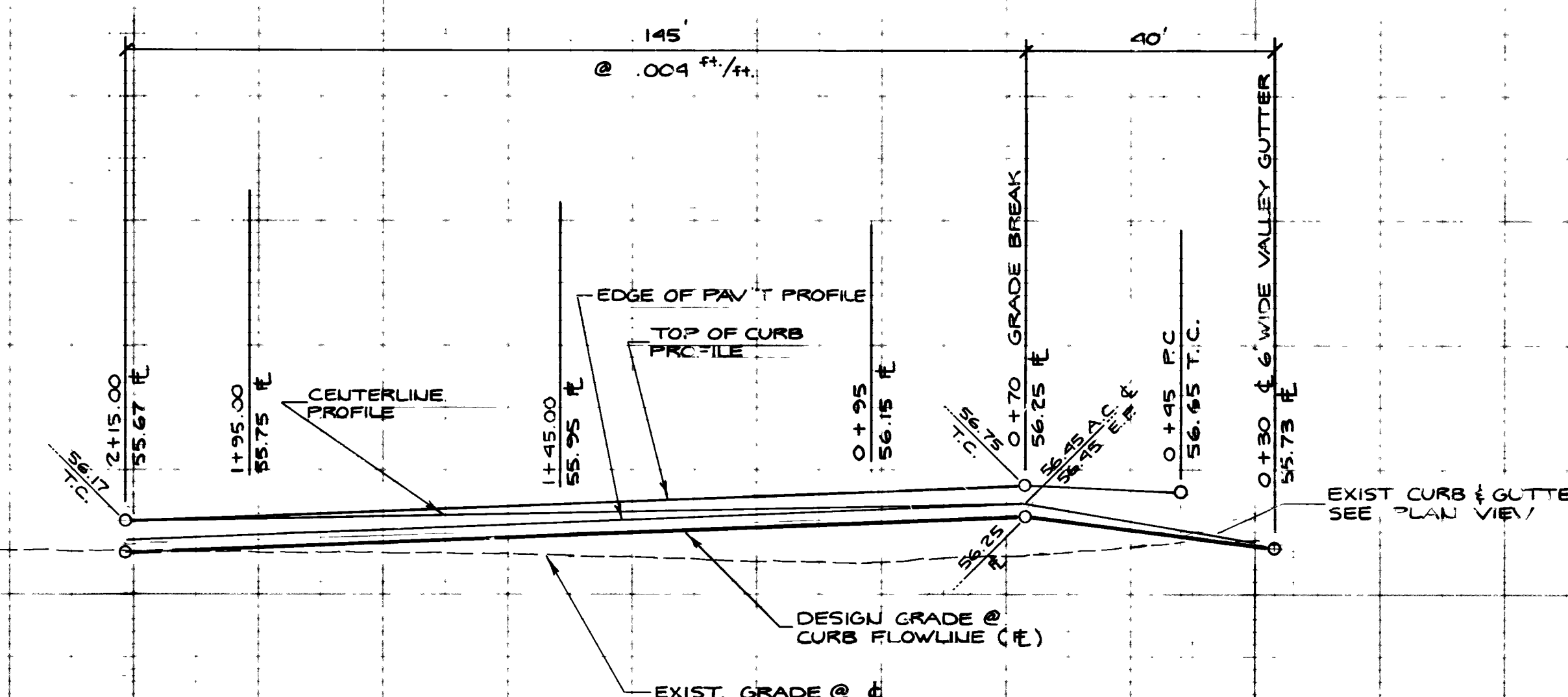

DATE: 4/1/93
DESIGN: BAUGHMAN & TURNER
DRAWN: CIVIL ENGINEERS
CHECK: MINING ENGINEERS
SCALE: LAS VEGAS, NEVADA 89102

PREPARED FOR: ATLAUTIC RICHFIELD COMPANY

DATE: 4/1/93
DESIGN: BAUGHMAN & TURNER
DRAWN: CIVIL ENGINEERS
CHECK: MINING ENGINEERS
SCALE: LAS VEGAS, NEVADA 89102

STREET & STREET LIGHT DESIGN
SUNNY PLACE
A PORTION OF THE 1/4 OF THE SW/4 OF SECTION 28 TOWNSHIP 20 SOUTH RANGE 61 EAST, MERIDIAN 11 WEST, CLARK COUNTY, NEVADA

SHEET: 4 OF 4
PROJ. NO: 107-V1394

