

APPROVALS

LAS VEGAS CITY ENGINEER _____ DATE _____

LAS VEGAS FIELD ENGINEER _____ DATE _____

SANITATION SUPT. _____ DATE _____

TC = 0.13' ABOVE ϵ GRADE

SCALE
 HORIZ: 1" = 40', VERT: 1" = 4'

NOTES

- ALL RADII — 5' UNLESS OTHERWISE NOTED
- ALL GRADES — TOP OF PAVEMENT UNLESS OTHERWISE NOTED

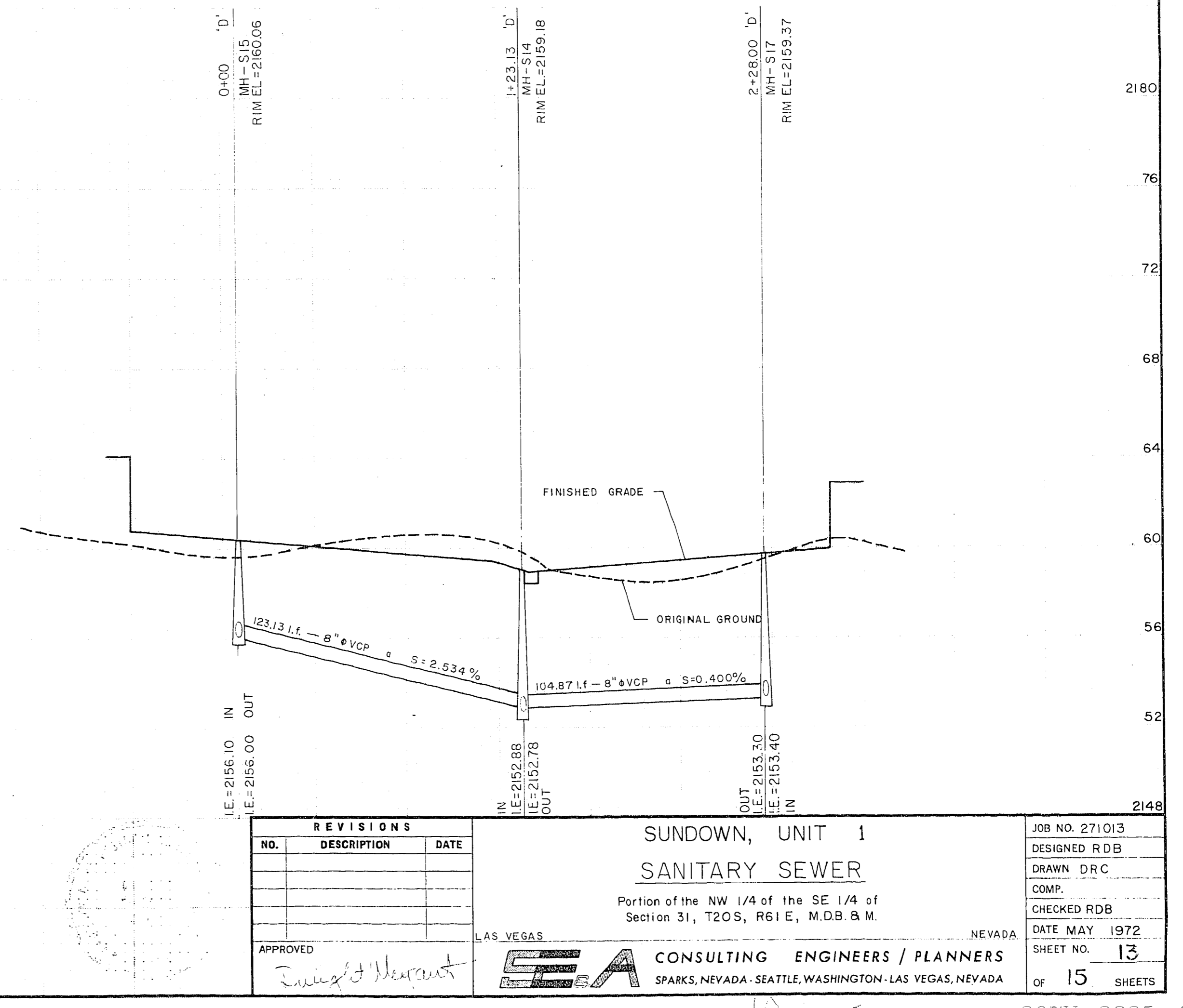
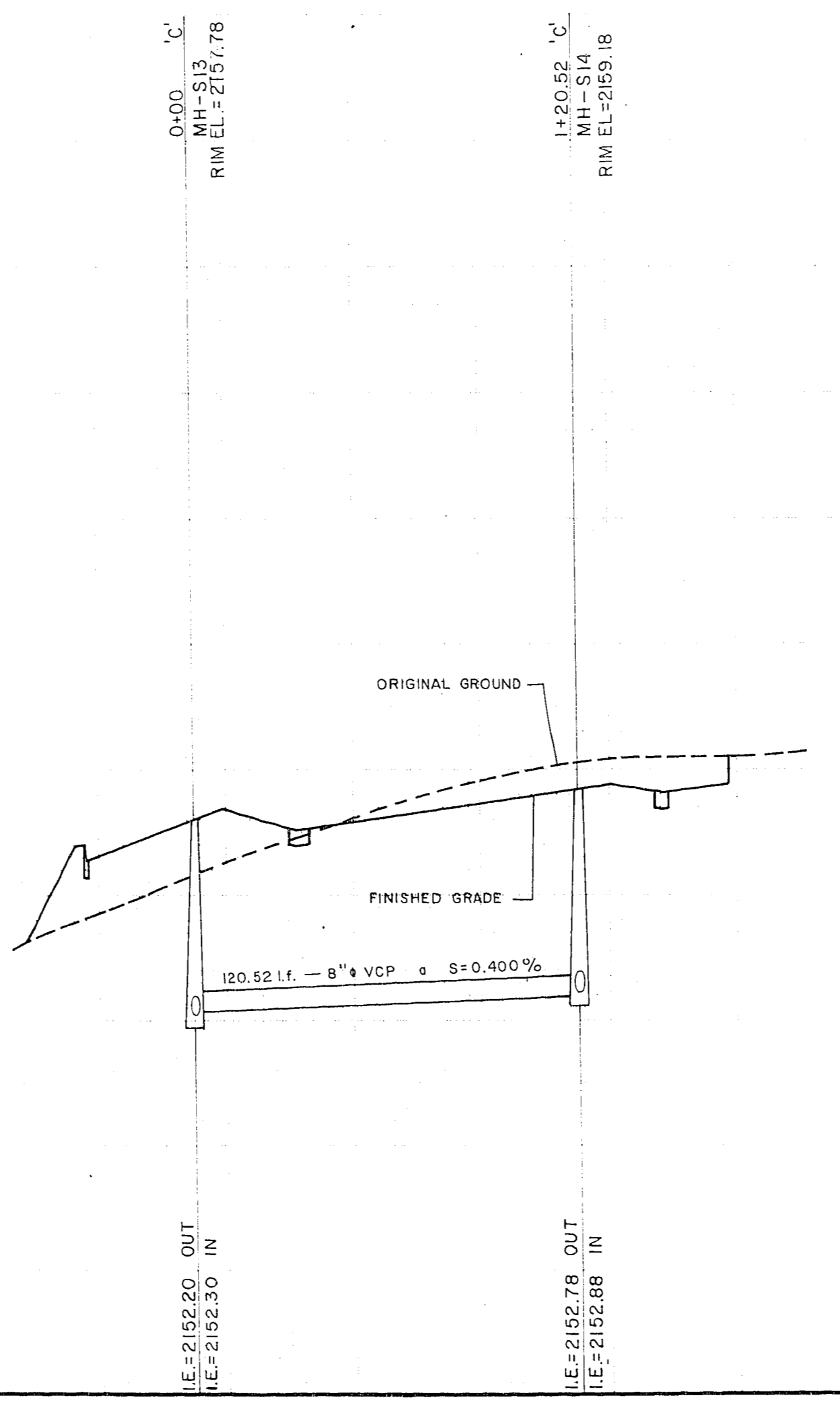
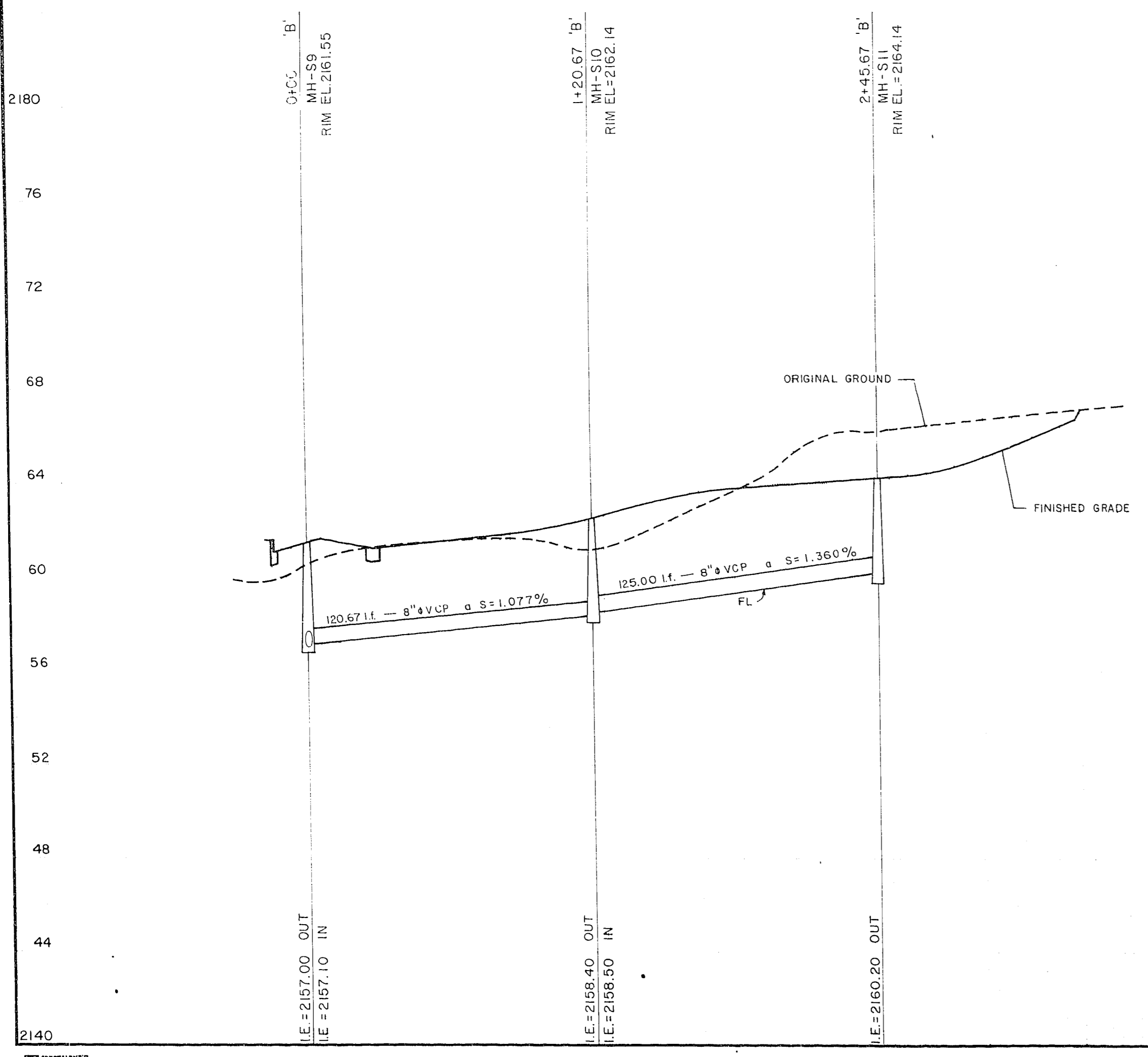

REVISIONS		
NO.	DESCRIPTION	DATE

SUNDOWN, UNIT 1
 SANITARY SEWER

Portion of the NW 1/4 of the SE 1/4 of
 Section 31, T20S, R61E, M.D.B. & M.

APPROVED _____

LAS VEGAS CONSULTING ENGINEERS / PLANNERS
 SPARKS, NEVADA - SEATTLE, WASHINGTON - LAS VEGAS, NEVADA

JOB NO. 271013
DESIGNED RDB
DRAWN DRC
COMP.
CHECKED RDB
DATE MAY 1972
SHEET NO. 13
OF 15 SHEETS

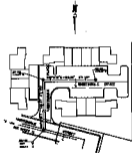

'A' LINE

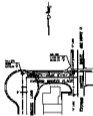

'C' LINE



'D' LINE



- NOTE:
 1. ALL LINES - 1" SCALE UNLESS OTHERWISE NOTED
 2. ALL LINES - 1/2" SCALE UNLESS OTHERWISE NOTED

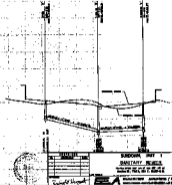
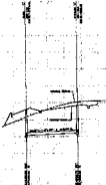
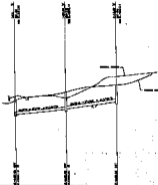

SINKOV, MAY 1 SANITARY ENGINEER 1001 N. 10th St. S.W. SEATTLE, WASH.		PROJECT NO. SHEET NO. DATE
---	--	----------------------------------