

9-13-76

MARTIN & MARTIN  
CIVIL ENGINEERS  
1909 S. JONES BLVD.  
SUITE B  
LAS VEGAS, NEVADA 89102  
PHONE (702) 248-8000

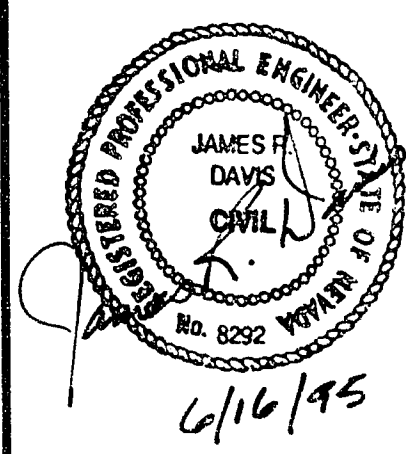

STRATOSPHERE PROJECT  
PROPOSED PARK  
UTILITY PLAN

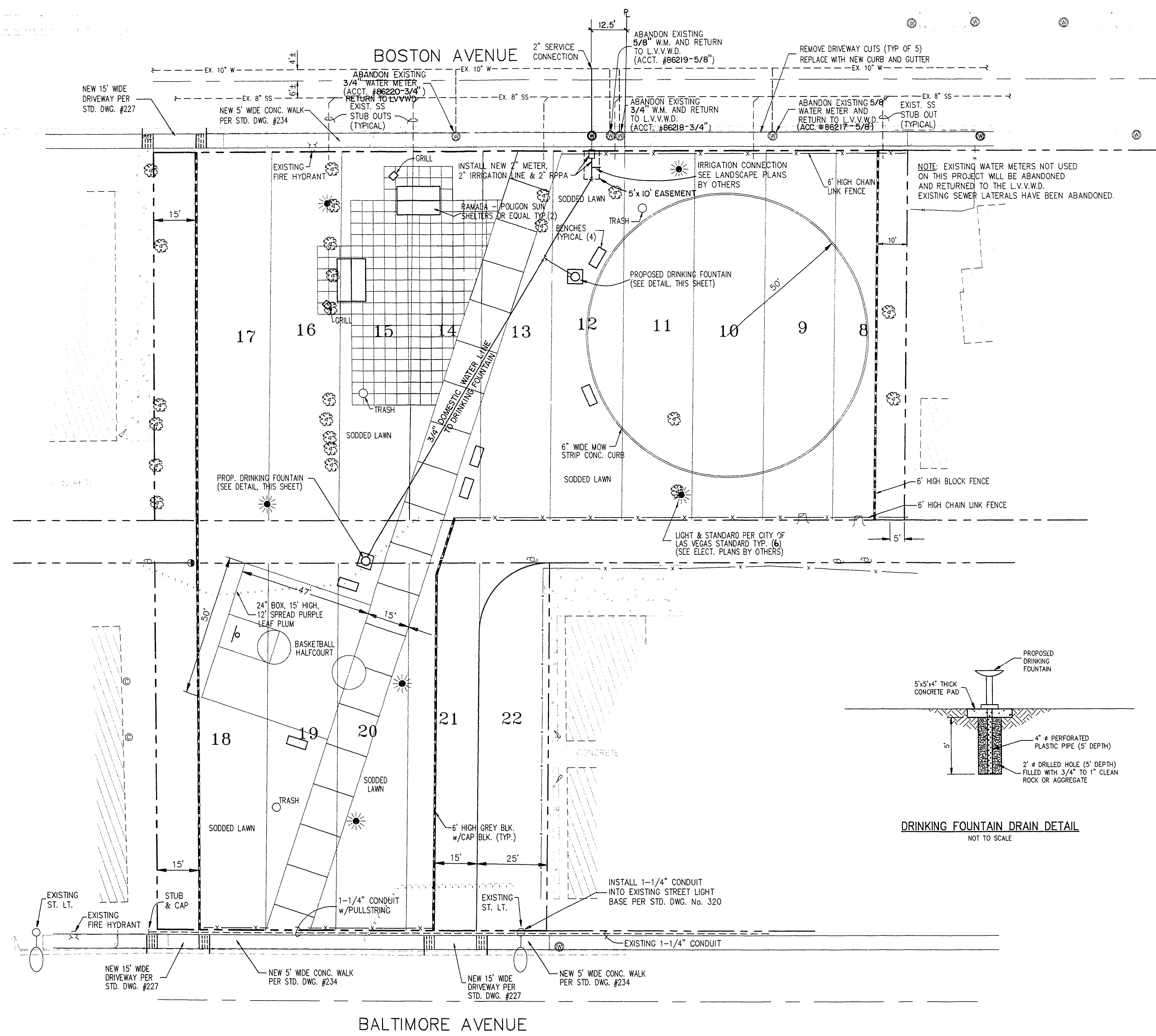
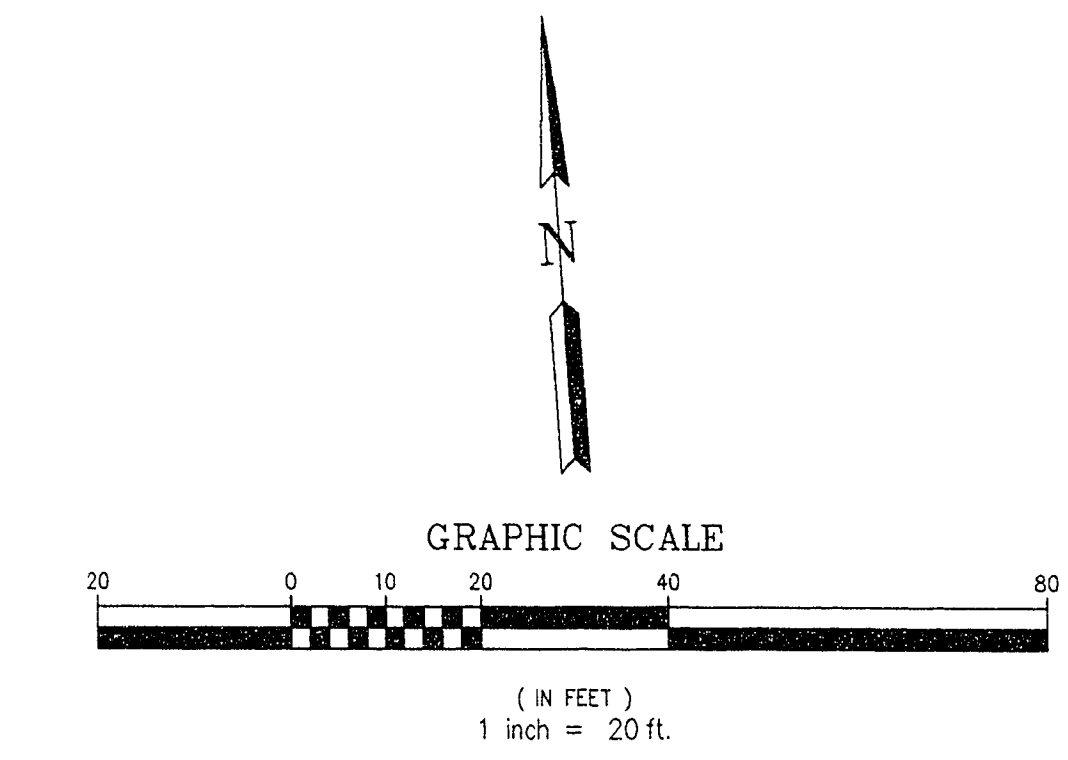

LEGEND

EXISTING	PROPOSED
--- R.O.W. ---	--- SCREEN / RETAINING WALL ---
--- CENTERLINE ---	--- WIRE OR CHAIN LINK FENCE ---
--- WATER LINE ---	--- TRASH ENCLOSURE ---
--- SANITARY SEWER LINE ---	--- GRADE BREAK ---
--- GAS LINE ---	--- FF+0.00 FINISH FLOOR ---
--- STORM DRAIN ---	--- C.O. INV. C.O. INV. CLEANOUT INVERT ELEVATION ---
--- POWER LINE / POWER POLE ---	--- (0.00) 0.00 FLOW LINE ---
--- TELEPHONE LINE ---	--- (0.00) 0.00 FINISH GRADE ---
--- FIRE HYDRANT ---	--- F.S. F.S. BACK OF SIDEWALK ---
--- WATER VALVE ---	--- (0.00) 0.00 B.S.W. TOP OF CURB ---
--- METERS / PULL BOXES ---	--- (0.00) 0.00 T.O.W. TOP OF WALL ---
--- REDUCER ---	--- (0.00) 0.00 T.O.W. ---
--- MANHOLE ---	--- (0.00) 0.00 TYPE "L" CURB & GUTTER ---
--- CLEANOUT ---	--- (0.00) 0.00 TYPE "A" CURB ---
--- STREET LIGHT ---	--- R.D. ROOF DRAIN ---
--- CONTOUR ---	--- E.R.W. END RETAINING WALL ---
--- CONCRETE ---	
--- A.C. PAVING ---	

LEGAL DESCRIPTION

LOTS 8-22, BLOCK 12  
THE MEADOWS  
PER BOOK 1, PAGE 43  
CLARK COUNTY RECORDS

BENCHMARK

RIVET AND PLATE IN TOP OF CURB, EAST CURB OF LAS VEGAS  
BOULEVARD AND BALTIMORE AVENUE.  
STA 2LV1035WW6  
ELEV: 2033.55

APPROVALS:

L.V.V.W.D. *[Signature]* 7/13/95  
DATE  
CLY FIREY DEPT. *[Signature]* 6/15/95  
DATE

WATER QUANTITIES

2" METER 1 EA.  
2" RPPA 1 EA.

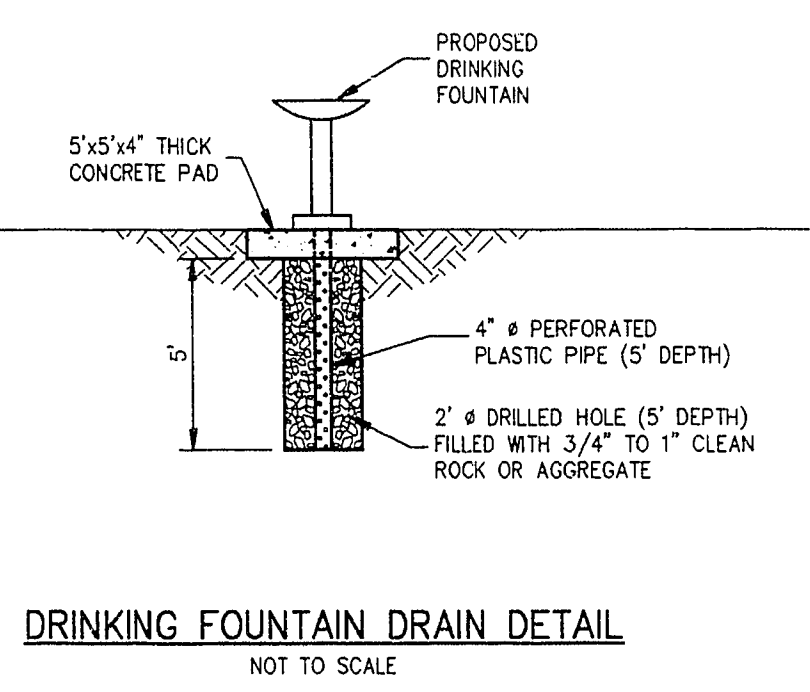

REDUCED PRESSURE PRINCIPLE ASSEMBLY - 2"  
Approved Reduced Pressure Principle Assembly(s) shall be installed per the UDACS Plate No. 11A. No water shall be taken from a service requiring backflow prevention until the reduced pressure principle assembly has been successfully tested by the LVVWD.

Any block wall or other fence material shall be designed and constructed around the outside of the easement(s) to allow the District direct access from the adjacent right-of-way.

ABANDONMENT OF EXISTING SERVICE(S) - 2" AND SMALLER  
The Contractor shall notify the Inspection Division at the LVVWD (702-258-3227) 48 hours prior to the requested removal time to allow the District to take the final meter reading of the meter. After the final reading, the Contractor may then begin removal procedures for the affected service as follows:  
Existing service laterals that are to be abandoned from the existing water main, shall have the corporation stop turned off at the main, the lateral cut 6" downstream from the corporation stop and cut again 6" downstream from the first cut such that a 6" piece of the existing service lateral is removed. If the corporation stop is damaged beyond repair or pulled from the existing water main, the main shall be repaired at the Contractor's expense, in a manner approved by the LVVWD. If the corporation stop is not water tight, the Contractor shall notify LVVWD Communication Support Center (702-258-7171) for further direction.

The Contractor shall remove the existing service meter box and appurtenances. Fill and grade any and all resulting voids and replace or restore to original conditions or better, all landscaping, irrigation systems, concrete, sidewalks, asphalt, or any other items damaged or removed during the removal of the existing service meter box.

AVOID CUTTING UNDERGROUND UTILITY LINES. IT'S COSTLY.  
Call before you Dig- 1-800-227-2600 UNDERGROUND SERVICE ALERT (U.S.A.)

AVOID OVERHEAD POWER LINE CONTACT  
Call before you OVERHEAD 1-702-593-6111 NEVADA POWER ENVIRONMENT AND SAFETY SERVICES DEPARTMENT

date	JUNE 15, 1995
job number	1353.11
design by	J. ENTSINGER
drawn by	M. GARRETT
checked by	

sheet number

C4

SHEET 4 OF 4

650.39