

DEVIATION FROM STD. DWGS.  
NONE

CITY OF LAS VEGAS GENERAL NOTES

- \*REQUIRED NOTES - OTHERS ONLY IF APPLICABLE
- ALL CONSTRUCTION AND MATERIALS SHALL BE IN ACCORDANCE WITH THE UNIFORM STANDARD SPECIFICATIONS FOR PUBLIC WORKS CONSTRUCTION OF-SITE IMPROVEMENTS, CLARK COUNTY AREA REVISION, LATEST EDITION; THE UNIFORM STANDARD SPECIFICATIONS FOR PUBLIC WORKS CONSTRUCTION, CLARK COUNTY AREA REVISION, LATEST EDITION; AND OTHER APPLICABLE APPROVED STANDARDS ISSUED BY THE CLARK COUNTY AREA REVISION, LATEST EDITION; AND OTHER APPLICABLE APPROVED STANDARDS ISSUED BY THE CLARK COUNTY AREA REVISION, LATEST EDITION.
  - THE EXISTING AND LOCATION OF ANY UNDERGROUND UTILITY PIPES OR STRUCTURES SHOWN ON THESE PLANS ARE OBTAINED BY A RESEARCH OF THE AVAILABLE RECORDS. THE CONTRACTOR IS RESPONSIBLE TO TAKE PRECAUTIONARY MEASURES TO PROTECT THE UTILITY LINES SHOWN AND ANY OTHER LINES NOT OF RECORD OR NOT SHOWN ON THESE DRAWINGS. EXISTING UTILITIES ARE LOCATED ON PLANS ONLY FOR THE CONVENIENCE OF THE CONTRACTOR. EXISTING UTILITY SERVICE LATERALS MAY NOT BE SHOWN ON THE PLANS.
  - THE CONTRACTOR SHALL TAKE ALL PRECAUTIONARY MEASURES NECESSARY TO PROTECT EXISTING IMPROVEMENTS WHICH ARE TO REMAIN IN PLACE, FROM DAMAGE, AND ALL SUCH IMPROVEMENTS OF STRUCTURES DAMAGED BY THE CONTRACTOR'S OPERATIONS SHALL BE REPAIRED OR RECONSTRUCTED SATISFACTORY TO THE OWNER AT THE EXPENSE OF THE CONTRACTOR.
  - THE CONTRACTOR SHALL NOT BACKFILL ANY TRENCHES IN WHICH WATER LINES HAVE BEEN UNCOVERED UNTIL THE WATER LINES HAVE BEEN INSPECTED BY THE LAS VEGAS VALLEY WATER DISTRICT. THE WATER DISTRICT SHALL BE NOTIFIED 48 HOURS IN ADVANCE OF CONSTRUCTION IN THE VICINITY OF WATER LINES.
  - ALL CONSTRUCTION SHALL BE AS SHOWN ON THESE PLANS, ANY ALTERATIONS SHALL HAVE THE PRIOR WRITTEN APPROVAL OF THE CITY ENGINEER.
  - THE CITY ENGINEER SHALL BE USED IN ALL OFF-SITE CONCRETE WORK. CONCRETE TO BE 3000 P.S.I. MINIMUM 4" OR GREATER. MIX DESIGN TO BE APPROVED BY THE QUALITY CONTROL DIVISION PRIOR TO USE ON THE PROJECT.
  - THE CONTRACTOR SHALL, AT HIS OWN EXPENSE, LOCATE ALL OVERHEAD INTERFERENCES WHICH MAY AFFECT HIS OPERATION DURING CONSTRUCTION AND SHALL TAKE ALL NECESSARY PRECAUTIONS TO AVOID DAMAGE TO SAME. THE CONTRACTOR SHALL USE EXTREME CAUTION WHEN WORKING NEAR OVERHEAD OR UNDERGROUND POWER, GAS AND/OR OTHER UTILITIES SO AS TO SAFELY PROTECT ALL PERSONNEL AND EQUIPMENT, AND SHALL BE RESPONSIBLE FOR ALL COSTS AND LIABILITY IN CONNECTION THEREWITH.
  - PERMITS ARE REQUIRED FOR ANY WORK IN THE PUBLIC RIGHT OF WAY. THE CONTRACTOR SHALL SECURE ALL PERMITS AND INSPECTIONS REQUIRED FOR THIS CONSTRUCTION.
  - EXPANSION JOINTS REQUIRED, MAXIMUM EVERY 300' IN EXTENDED TYPE CURB.
  - AS PAVEMENT TO BE 1/2" ABOVE LIP OF ALL UTILITY OR VALLEY CUTTERS AFTER CONSTRUCTION.
  - APPLY FOG SEAL ONLY AFTER ALL CORRECTIONS AND ADJUSTMENTS HAVE BEEN MADE.
  - CURB & GUTTER WITH A GRADE OF LESS THAN FOUR TENTHS OF ONE PERCENT SHALL BE CONSTRUCTED BY FORMING. EACH JOINT SHALL BE CHECKED FOR GRADE PRIOR TO CONSTRUCTION AND WHEN TESTED AS SOON AS POSSIBLE AFTER CONSTRUCTION.
  - WHEELCHAIR RAMPS SHALL BE CONSTRUCTED IN EACH QUADRANT OF AN INTERSECTION PER STANDARD DOMINANT 205. EXACT LOCATION OF RAMPS MAY BE ADJUSTED IN THE FIELD BY A CITY INSPECTOR.
  - CONTRACTOR SHALL PROVIDE ALL NECESSARY HORIZONTAL AND VERTICAL TRANSITIONS BETWEEN NEW CONSTRUCTION AND EXISTING SURFACES TO PROVIDE FOR PROPER DRAINAGE AND FOR THROUGH AND EGRESS TO NEW CONSTRUCTION. THE EXTENT OF TRANSITIONS TO BE AS SHOWN ON PLANS, OR AS INDICATED IN THE FIELD BY A CITY INSPECTOR.
  - ALL GRADING WORK SHALL CONFORM TO THE SOILS REPORT AS PREPARED BY THE SOILS ENGINEER AND APPROVED BY THE CITY ENGINEER.
  - EXACT LOCATION OF ALL SHADOW LINES MAY BE DETERMINED IN THE FIELD BY A CITY OF LAS VEGAS INSPECTOR IF LOCATION ON PLANS IS NOT CLEARLY SHOWN, OR EXISTING PERMITS CONTAINING REQUIRES REGULATION.
  - THE CONTRACTOR SHALL TAKE ALL PRECAUTIONS NECESSARY TO PROTECT EXISTING PERMANENT SURVEY MONUMENTS. ANY MONUMENTS DISTURBED SHALL BE REPLACED AND ADJUSTED PER AVAILABLE RECORDS IN ACCORDANCE WITH N.E.S. STATUTE NO. 625,550.
  - UTILITY COMPANY METER BOXES, MOUNTING LIDS, VALVE COVERS, ETC. SHALL BE LOCATED OUT OF DRIVEWAYS, DRIVEWAY APPROACHES, FLOWLINES, AND VALLEY CUTTERS UNLESS WRITTEN APPROVAL IS GRANTED BY THE UTILITY COMPANY.

REVISED 02/91

TRAFFIC NOTES:

- BEFORE ANY WORK IS STARTED IN THE RIGHT-OF-WAY, THE CONTRACTOR SHALL INSTALL ALL NECESSARY WARNING SIGNS FOR THE CONSTRUCTION ZONE. THE CONTRACTOR SHALL INSTALL TEMPORARY TRAFFIC CONTROL SIGNS AND TRAFFIC CONTROL DEVICES TO MAINTAIN SAFE TRAFFIC FLOW THROUGHOUT THE PROJECT. SIGNS SHALL BE INSTALLED AND MAINTAINED UNTIL THE WORK IS COMPLETED, AND SHALL MAINTAIN SAFE TRAFFIC FLOW THROUGHOUT THE PROJECT.
- IF THE IMPROVEMENTS NECESSARY TO PROTECT THE CONSTRUCTION ZONE, TEMPORARY TRAFFIC CONTROL SIGNS, WARNING SIGNS, AND TRAFFIC CONTROL DEVICES SHALL CONFORM TO THE "MANUAL ON STREET CONTROL, HANDBOOK-1985" AND "MANUAL OF UNIFORM TRAFFIC CONTROL DEVICES-1985".
- IF THE IMPROVEMENTS NECESSARY TO PROTECT THE CONSTRUCTION ZONE, TEMPORARY TRAFFIC CONTROL SIGNS, WARNING SIGNS, AND TRAFFIC CONTROL DEVICES SHALL CONFORM TO THE "MANUAL ON STREET CONTROL, HANDBOOK-1985" AND "MANUAL OF UNIFORM TRAFFIC CONTROL DEVICES-1985".
- THE DEVELOPER SHALL BE RESPONSIBLE FOR PROVIDING AND INSTALLING ALL PERMANENT SIGNAGE ON THE PLANS. STREET NAME SIGNS SHALL BE STANDARD 3116 UNIFORM SPECIFICATION SIGNAGE ON THE PLANS. ALL SIGN POSTS SHALL BE INSTALLED IN ACCORDANCE WITH STANDARD SPECIFICATION SIGNAGE.
- IF A PROPOSED STREET LIGHT STANDARDS IS FIELD LOCATED TO WITHIN FIVE (5) FEET OF ANY SIGN SIGNAGE TO BE INSTALLED ON A SIGN POST, THEN SIGNAGE SHALL MOUNT TO ONE OF THE STREET LIGHT STANDARDS.
- ALL PERMANENT TRAFFIC CONTROL DEVICES CALLED FOR HEREON SHALL BE IN PLACE AND IN FINAL POSITION PRIOR TO ALLOWING ANY PUBLIC TRAFFIC INTO THE PORTION OF THE RIGHT-OF-WAY BEING IMPROVED, REGARDLESS OF THE STATUS OF COMPLETION OF PAVING OR OTHER OFF-SITE IMPROVEMENTS CALLED FOR BY THESE PLANS.

The following are the requirements that must be met when there is a water-cover crossing:

- When protection of the waterline is considered, the minimum vertical distance of 18 inches must be maintained when the water line is installed over the sewer/main line. If this distance cannot be maintained because of physical obstructions or the waterline must be placed under the sewer/main line, the sewer/main line must be constructed with any one of the following:

- Extra heavy cast iron or ductile iron pipe
  - Water supply quality material
  - Encasement with 4 inches minimum of concrete of strength with water quality pipe
- Each of these provisions must be extended for 10 feet on either side of the waterline at 90 degree to the crossing.

LEGEND

- STREET LIGHT
- WM WATER METER
- FH FIRE HYDRANT
- WV WATER VALVE
- CENTERLINE
- FLOW LINE
- RIGHT OF WAY OR PROPERTY LINE
- CONTOUR LINE
- EXIST. FEATURE
- PROPOSED FEATURE
- M.H. MANHOLE
- GV GAS VALVE
- (ELEV.) EXIST. ELEV.
- (ELEV.) PROPOSED ELEV.
- FE FLOW LINE
- FG FIN. GRADE

3x1/4" INSTALL  
2" PVC @ 1.0%

2x1/4" INSTALL  
4" PVC @ 1.0%

NOTE:  
SPLIT CUT & MATCH ALL AC. (INCLUDING S.C. CURB  
REPLACE WITH SAME  
THICKNESS AC. & BASE

NOTE:  
ALL UTILITIES SHOWN ARE BELIEVED TO BE  
ACCURATELY LOCATED, BUT THE ACCURACY  
AND COMPLETENESS OF UTILITY INFORMATION  
IS NOT GUARANTEED. FOR EXACT LOCATION  
OF ANY UTILITY SEE THE APPROPRIATE  
UTILITY OR GOVERNMENT AGENCY.

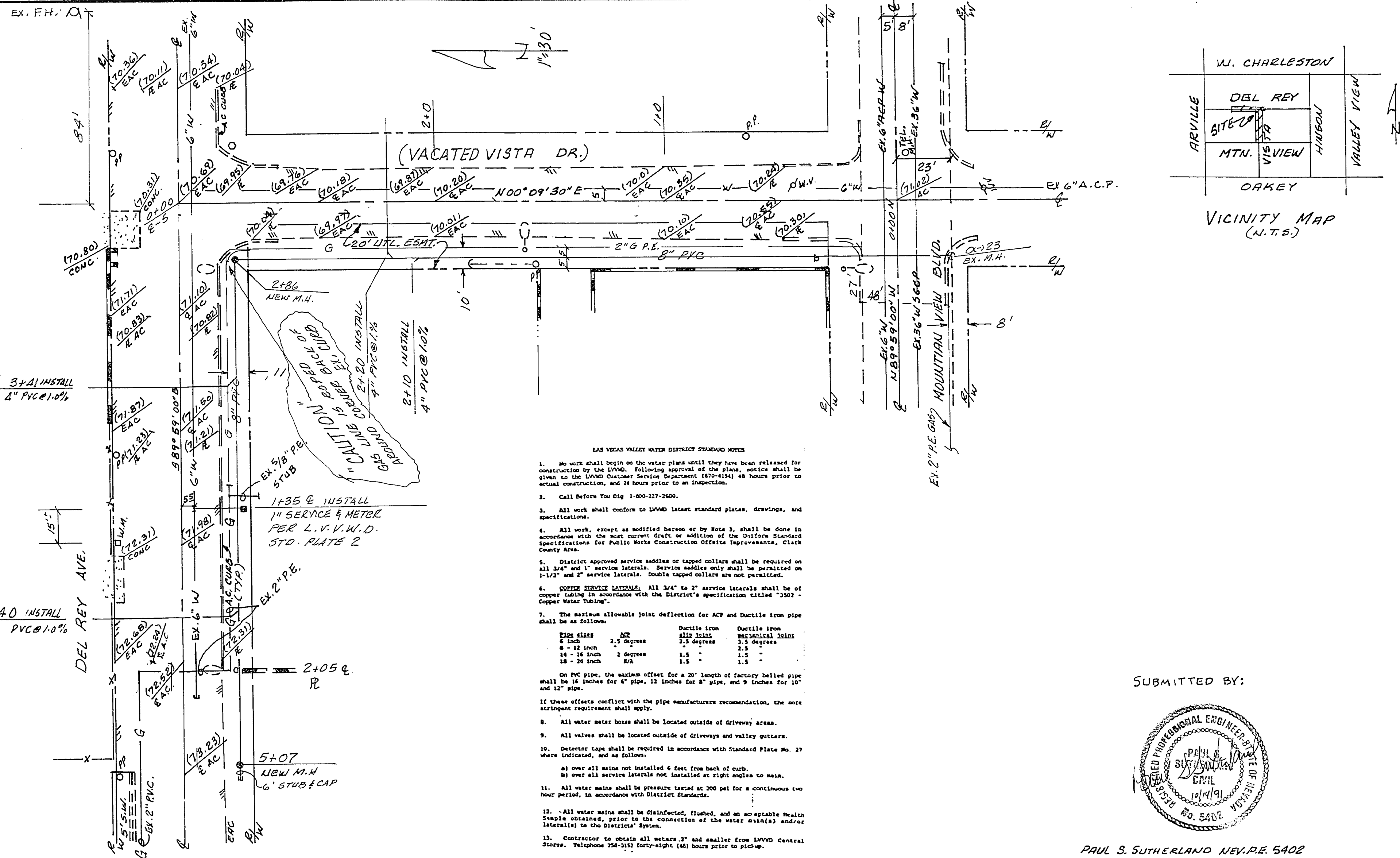

LAS VEGAS VALLEY WATER DISTRICT STANDARD NOTES

- No work shall begin on the water line until they have been released for construction by the LVWD. Following approval of the plans, notice shall be given to the LVWD Customer Service Department 180-2141 at least 48 hours prior to actual construction, and 24 hours prior to an inspection.
- Call Before You Dig 1-800-227-2600.
- All work shall conform to LVWD latest standard plans, drawings, and specifications.
- All work, except as modified herein by Note 3, shall be done in accordance with the most current draft or addition of the Uniform Standard Specifications for Public Works Construction (1979) with all amendments, Clark County Area.
- Correct approved service address or capped outlets shall be required on all 24" and 1" service laterals. Service address only shall be permitted on 12" and 8" service laterals. Double capped outlets are not permitted.
- CURB SERVICE LATERALS: All 24" and 1" service laterals shall be of copper tubing in accordance with the Bristle's specification titled "360" Copper Water Tubing".
- The maximum allowable joint deflection for AC and ductile iron pipe shall be as follows:
 

Pipe Size	AC	Ductile Iron	Allowable Deflection
6" - 12" inch	1.5 degrees	1.5 degrees	2.5
14" - 18" inch	2 degrees	1.5 degrees	2.5
18" - 24" inch	2 degrees	1.5 degrees	1.5
- On PVC pipe, the maximum offset for a 20' length of factory belted pipe shall be 16 inches for 4" pipe, 12 inches for 6" pipe, and 9 inches for 8" and 12" pipe.
- If these offsets conflict with the pipe manufacturer's recommendation, the more restrictive requirement shall apply.
- All water meter boxes shall be located outside of driveway areas.
- All valves shall be located outside of driveway and valley gutters.
- Detector caps shall be required in accordance with Standard Plate No. 27 where indicated, and as follows:
  - over all mains not installed 6 feet from back of curb.
  - over all service laterals not installed at right angles to main.
- All water mains shall be pressure tested at 200 psi for a continuous two hour period, in accordance with District Standards.
- All water mains shall be disinfected, flushed, and an acceptable health sample obtained, prior to the connection of the water mains and/or laterals to the district's system.
- Contractor to obtain all meters 3" and smaller from LVWD Central Store. Telephone 252-2111 forty-eight (48) hours prior to pick-up.

SUBMITTED BY:

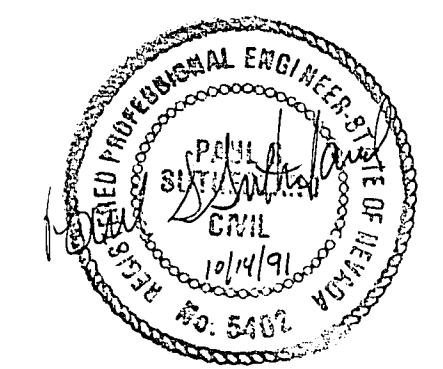

PAUL S. SUTHERLAND NEV. P.E. 5402

THESE DRAWINGS ARE "PRELIMINARY AND SUBJECT TO REVISION" UNTIL THEY BEAR AN APPROVAL SIGNATURE FROM ALL OF THE REVIEWING AGENCIES. QUANTITIES, ESTIMATES, AND BIDS BASED ON THESE PRELIMINARY DRAWINGS ARE APPROXIMATE ONLY. BEING GIVEN AS A BASIS FOR CONSIDERATION OF BIDS ONLY, AND THE ENGINEER RESERVES THE RIGHT TO MAKE SUCH ALTERATIONS, DEVIATIONS, ADDITIONS TO OR OMISSION FROM THE PRELIMINARY PLANS, INCLUDING THE RIGHT TO INCREASE OR DECREASE THE QUANTITY OF ANY ITEM OR PORTION OF WORK, AS DEEMED BY THE ENGINEER TO BE NECESSARY.

EST. OFF-SITE QUANTITIES

8" PVC	528 L.F.
MANHOLES	2 EA.
4" PVC	170 L.F.
8" x 3" x 4" W/2'S	4 EA.
1" SEC. & METER	1 EA.

APPROVALS

DATE	DESCRIPTION	DATE
5-13-92	C.L.V. CITY ENG.	DATE
10-25-91	Richard G. Brennan	DATE
5/07/92	C.L.V. FIRE DEPT.	DATE
10-25-91	L.V.V.W.D.	DATE
10-25-91	S.W. GAS	DATE
10/24/91	City of Las Vegas	DATE
	M.V. POWER	DATE

SCALE  
HORIZ. 1" = 30'  
VERT. 1" = 3'

BENCH MARK  
BM 101589 3.41 COR. MOUNT. VIEW  
DARMAA ELEV. = 2138.24 (C.L.V. DATUM)

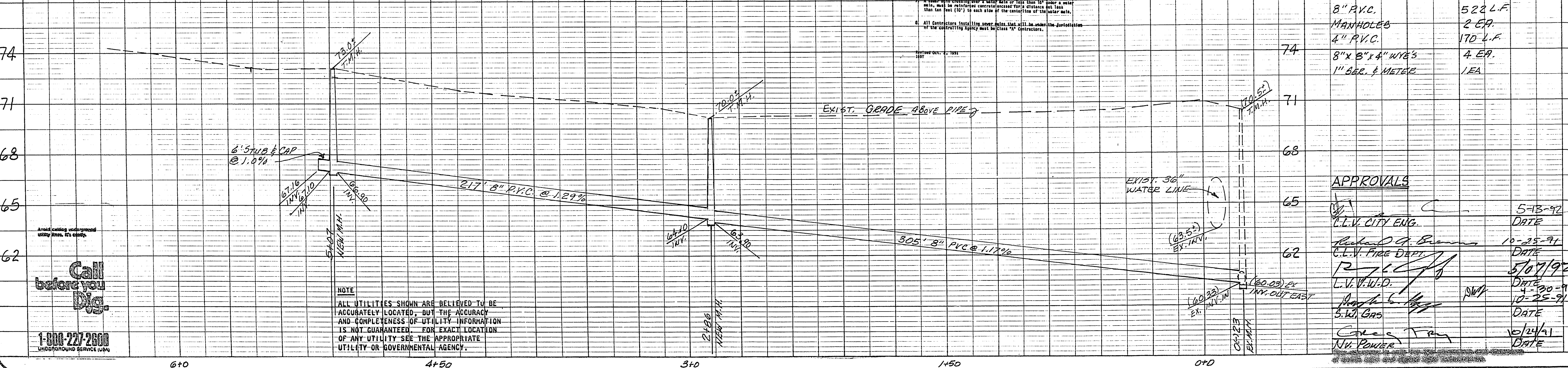

SIGMA NEVADA  
SURVEYING - ENGINEERING - PLANNING  
3355 SPRING MOUNTAIN ROAD  
SUITE 242  
LAS VEGAS, NEVADA 89102  
(702) 871-1378 386-7710

SEWER LINE EXT. & WATER SERVICE  
FOR  
JOHN LEE & BRENT STEWART  
N 1/2 Lot 3 Block 1, Book 1, No. 105 Plat B, Block 2, Book 2, No. 82 of Plans  
Sul 1/4, NE 1/4, Sec. 6, T. 21 S., R. 61 E., M.D.N. CLARK COUNTY, NV.

REVISIONS

NO.	DATE	DESCRIPTION
1	4/10/92	MOVE & LOWER SEWER LINE PER C.L.V. & L.V.W.D. ADD WATER SERVICE

PROJECT NO. 105-91  
SHEET NO. 1 of 1  
DATE: 10/8/91  
DRAWN BY: BC  
SCALE: 1" = 30'  
307-V7909

1-800-227-2600

76-1-116