

CITY OF LAS VEGAS TRAFFIC NOTES

- ALL CONSTRUCTION SIGNING, BARRICADING AND TRAFFIC DELINEATION SHALL CONFORM TO THE "NEVADA WORK ZONE TRAFFIC CONTROL HANDBOOK" LATEST EDITION AND TO THE "MANUAL ON UNIFORM TRAFFIC CONTROL DEVICES" LATEST EDITION.
- THE STREET SIGN CONTRACTOR SHALL OBTAIN STREET NAMES AND BLOCK NUMBERING FROM PLANNING DEPARTMENT PRIOR TO CONSTRUCTION.
- BEFORE ANY WORK IS STARTED IN THE RIGHT-OF-WAY, THE CONTRACTOR SHALL INSTALL ALL ADVANCE WARNING SIGNS FOR THE CONSTRUCTION ZONE. THE CONTRACTOR SHALL INSTALL TEMPORARY STOP SIGNS AT ALL NEW STREET ENCROACHMENTS INTO EXISTING CITY STREETS WHERE WARRANTED IMMEDIATELY AFTER FIRST GRADING WORK IS ACCOMPLISHED, AND SHALL MAINTAIN SAID SIGNS UNTIL PERMANENT SIGNS ARE INSTALLED.
- WHEN A DESIGNATED "SAFE ROUTE TO SCHOOL" IS ENCRoACHED UPON BY A CONSTRUCTION WORK ZONE AND PUBLIC WORK STAFF IDENTIFIES A NEED FOR STUDENTS TO BE ASSISTED IN THE SAFE CROSSING THROUGH THAT WORK ZONE, THE CONTRACTOR SHALL BE REQUIRED TO PROVIDE A QUALIFIED "CROSSING GUARD". THE GUARD SHALL BE PRESENT FOR THE FULL DURATION OF TIME THAT CHILDREN ARE LIKELY TO BE PRESENT.
- IF THE IMPROVEMENTS NECESSITATE THE OBLITERATION, TEMPORARY OBSTRUCTION, TEMPORARY REMOVAL, OR RELOCATION OF ANY EXISTING TRAFFIC PAVEMENT MARKING, SUCH PAVEMENT MARKING SHALL BE RESTORED OR REPLACED WITH LIKE MATERIALS TO THE SATISFACTION OF THE CITY TRAFFIC ENGINEER.
- THE CONTRACTOR SHALL BE RESPONSIBLE FOR PROVIDING AND INSTALLING ALL PERMANENT SIGNS SHOWN ON THE PLANS. STREET NAME SIGNS SHALL CONFORM IN THEIR ENTIRETY TO CURRENT CITY STANDARDS. ALL OTHER SIGNS SHALL BE STANDARD SIZE UNLESS OTHERWISE SPECIFIED ON THE PLANS. ALL SIGN POSTS SHALL BE INSTALLED IN ACCORDANCE WITH CURRENT CITY STANDARDS.
- WHEN A PROPOSED STREET LIGHT STANDARD IS LOCATED WITHIN FIVE (5) FEET OF ANY SIGN S HOWN ON THE PLANS TO BE MOUNTED ON A SIGNPOST, THE SIGN SHALL BE MOUNTED ON THE STREET LIGHT STANDARD AND THE SIGNPOST SHALL BE ELIMINATED.
- ALL PERMANENT TRAFFIC CONTROL DEVICES CALLED FOR HEREON SHALL BE IN PLACE AND IN FINAL POSITION PRIOR TO ALLOWING ANY PUBLIC TRAFFIC ONTO THE PORTIONS OF THE ROAD(S) BEING IMPROVED HEREUNDER, REGARDLESS OF THE STATUS OF COMPLETION OF PAVING OR OTHER OFF-SITE IMPROVEMENTS CALLED FOR BY THESE PLANS.
- STREET SIGNS AND STOP SIGNS SHALL BE INSTALLED PER CITY STANDARD SPECIFICATION FOR PLACEMENT OF STREET NAMES SIGNS.
- THE CONTRACTOR SHALL PROVIDE BARRICADES, SIGNS, FLASHERS, OTHER EQUIPMENT AND FLAG PERSONS NECESSARY TO INSURE THE SAFETY OF WORKERS AND PEDESTRIANS.
- WORK IN PUBLIC STREETS, ONCE BEGUN, SHALL BE EXPEDITED TO COMPLETION SO AS TO PROVIDE MINIMUM INCONVENIENCE TO ADJACENT PROPERTY OWNERS AND TO THE TRAVELING PUBLIC.
- THE CONTRACTOR SHALL BE RESPONSIBLE FOR NOTIFYING CITIZENS AREA TRANSIT(C.A.T.) IF THE CONSTRUCTION INTERRUPTS OR RELOCATES A BUS STOP OR HAS ADVERSE EFFECT ON BUS SERVICE ON THAT STREET TO ARRANGE FOR TEMPORARY RELOCATION OF STOP.
- GUARDS SHALL BE OBTAINED BY CONTACTING THE METROPOLITAN POLICE DEPARTMENT SPECIAL EVENTS UNIT (PHONE NO. IS 229-3442) WHO WILL PROVIDE OFFICERS PROPERLY TRAINED IN TRAFFIC CONTROL. FEES FOR THE USE OF THESE OFFICERS SHALL BE SET UP BY METRO AND WILL BE PAID BY THE CONTRACTOR. THE CONTRACTOR IS RESPONSIBLE FOR ALL ARRANGEMENTS WITH METRO.

CITY OF LAS VEGAS STREETLIGHT NOTES:

- ALL STREET LIGHTING INSTALLATIONS SHALL BE IN ACCORDANCE WITH THE STREET LIGHTING PLANS, THE "UNIFORM STANDARD SPECIFICATIONS FOR PUBLIC WORKS CONSTRUCTION OFF-SITE IMPROVEMENTS, CLARK COUNTY AREA, NEVADA", LATEST REVISION, AND THE "UNIFORM STANDARD DRAWINGS FOR PUBLIC WORKS CONSTRUCTION OFF-SITE IMPROVEMENTS, CLARK COUNTY AREA, NEVADA", LATEST REVISION.
- NO DEVIATION OF STREET LIGHT, PULL BOX, CONDUITS SHALL BE PERMITTED WITHOUT WRITTEN APPROVAL OF THE TRAFFIC/ELECTRICAL FIELD OPERATIONS DIVISION AND THE CITY ENGINEER. ANY DEVIATION FROM THE PLAN LOCATION WILL REQUIRE COMPLIANCE WITH SECTION 623.10.03 (E) OF THE SPECIFICATIONS.
- ALL EXISTING STREET LIGHTING SHALL REMAIN OPERATIONAL DURING CONSTRUCTION.
- ALL EMPTY CONDUIT SHALL HAVE PULL STRINGS INSTALLED PRIOR TO FINAL INSPECTION.
- ANY STRUCTURE SUCH AS BLOCK WALLS, CHAIN LINK FENCES, RETAINING WALLS, ETC. SHALL LEAVE A MINIMUM CLEARANCE OF EIGHTEEN INCHES (18") TO THE FACE OF STREET LIGHTING POLE ON ALL SIDES WHEN STREETLIGHT IS INSTALLED BEHIND SIDEWALK, AND SHALL AT NO TIME COMPLETELY ENCLOSE THE STREET LIGHTING POLE.
- AS-BUILT DRAWINGS SHALL BE SUPPLIED TO THE ELECTRICAL SERVICES SECTION PRIOR TO ANY PRELIMINARY INSPECTION. THE AS-BUILT DRAWING NEEDS TO BE STAMPED AS-BUILT AND SIGNED BY THE PREPARER.
- SERVICE POINT SHALL BE COORDINATED WITH NEVADA POWER COMPANY, AND WHEREVER POSSIBLE, BE LOCATED NEAR THE CENTER OF THE CIRCUIT. THIS SHALL BE THE CONTRACTORS RESPONSIBILITY.
- IT SHALL BE ASSUMED THAT IN THE ABSENCE OF AN EXISTING WORKABLE CIRCUIT TO ATTACH TO ALL INSTALLATIONS SHALL REQUIRE A NEW SERVICE FOR OPERATION OF THE CIRCUIT.
- WHEREVER THERE IS AN OVERHEAD UTILITY THAT MAY CONFLICT WITH THE INSTALLATION OF STREET LIGHTING CIRCUITS AND/OR POLES, THESE CONFLICTS MUST BE RESOLVED BETWEEN THE DEVELOPER AND THE UTILITIES INVOLVED BEFORE STREETLIGHT BASES ARE INSTALLED AT NO EXPENSE TO THE CITY OF LAS VEGAS.
- THE CONTRACTOR SHALL FURNISH COMPLETE SERVICE TO TRANSFORMERS AND CONTROL SYSTEMS IF REQUIRED ON PLANS.

CITY OF LAS VEGAS SEWER NOTES

- ALL CONSTRUCTION AND MATERIALS SHALL BE IN ACCORDANCE WITH THE LATEST EDITION OF THE DESIGN AND CONSTRUCTION STANDARDS FOR WASTEWATER COLLECTION SYSTEMS AND THE UNIFORM STANDARD SPECIFICATIONS FOR PUBLIC WORKS CONSTRUCTION OFF-SITE IMPROVEMENTS, CLARK COUNTY AREA, NEVADA, AS AMENDED. IT WILL BE THE RESPONSIBILITY OF THE CONTRACTOR TO BE AWARE OF THE CONTENTS OF THE ABOVE SPECIFICATIONS.
- IT SHALL BE THE CONTRACTOR'S RESPONSIBILITY TO PERFORM CONSTRUCTION AS PER PLANS. ANY ADDITIONS, DELETIONS, OR CHANGES SHALL FIRST MEET WITH THE APPROVAL OF THE CITY ENGINEER.
- CHISEL "S" OR "C" IN CURBS WHERE SEWER OR GAS LATERALS PASS UNDER THE CURB.
- POLYVINYL (PVC) SEWER PIPE SHALL MEET ASTM D-3034 SDR 35 SPECIFICATIONS, INSTALLED WITH SAND BEDDING AND BACKFILL OF TYPE II AGGREGATE BASE.
- ALL MANHOLES PAVED IN STREETS 80"/W AND LARGER SHALL HAVE CONCRETE COLLARS. STREETS LESS THAN 80"/W WILL REQUIRE RETROFIT IF PAVING DOES NOT CONFORM TO CITY STANDARDS AT THE MANHOLE.
- TEE SADDLES SHALL BE USED TO CONNECT SEWER LATERALS TO EXISTING MAIN LINES UP TO 12" DIA. CONNECTIONS TO 15" OR LARGER SHALL REQUIRE SPECIAL PROCEDURES. IN LINE "Y"'S SHALL BE USED ON LINES 12" OR ABOVE.
- A SEWER MAIN CROSSING OVER A WATER MAIN OR LESS THAN 18" UNDER A WATER MAIN, MUST BE REINFORCED CONCRETE ENCASED FOR A DISTANCE NOT LESS THAN TEN FEET (10') TO EACH SIDE OF THE CENTERLINE OF THE WATER MAIN.
- ALL CONTRACTORS INSTALLING SEWER MAINS THAT WILL BE UNDER THE JURISDICTION OF THE CITY OF LAS VEGAS MUST BE STATE OF NEVADA CLASS "A" CONTRACTORS.
- THE CITY OF LAS VEGAS WILL NOT ACCEPT ANY SEWER MAINS WHICH HAVE A VERTICAL DEFLECTION OF MORE THAN ONE TENTH (0.1) OF A FOOT FROM THE APPROVED CONSTRUCTION PLANS AT ANY LOCATION. SEWER MAINS FOUND TO EXCEED THIS TOLERANCE WILL HAVE TO BE REPAIRED OR REMOVED AND REPLACED TO THE SATISFACTION OF THE CITY ENGINEER PRIOR TO ACCEPTANCE BY THE CITY OF LAS VEGAS.
- INSTALLATION OF CURVED SEWER REQUIRES SPECIAL CONSTRUCTION PROCEDURES AND INSPECTIONS. CONTACT CITY OF LAS VEGAS CONSTRUCTION SERVICES 24 HOURS PRIOR TO INSTALLATION.

SEWER CONTRIBUTION

AVERAGE DAILY FLOW = 0.002 MGD
PEAK FLOW = 0.004 MGD

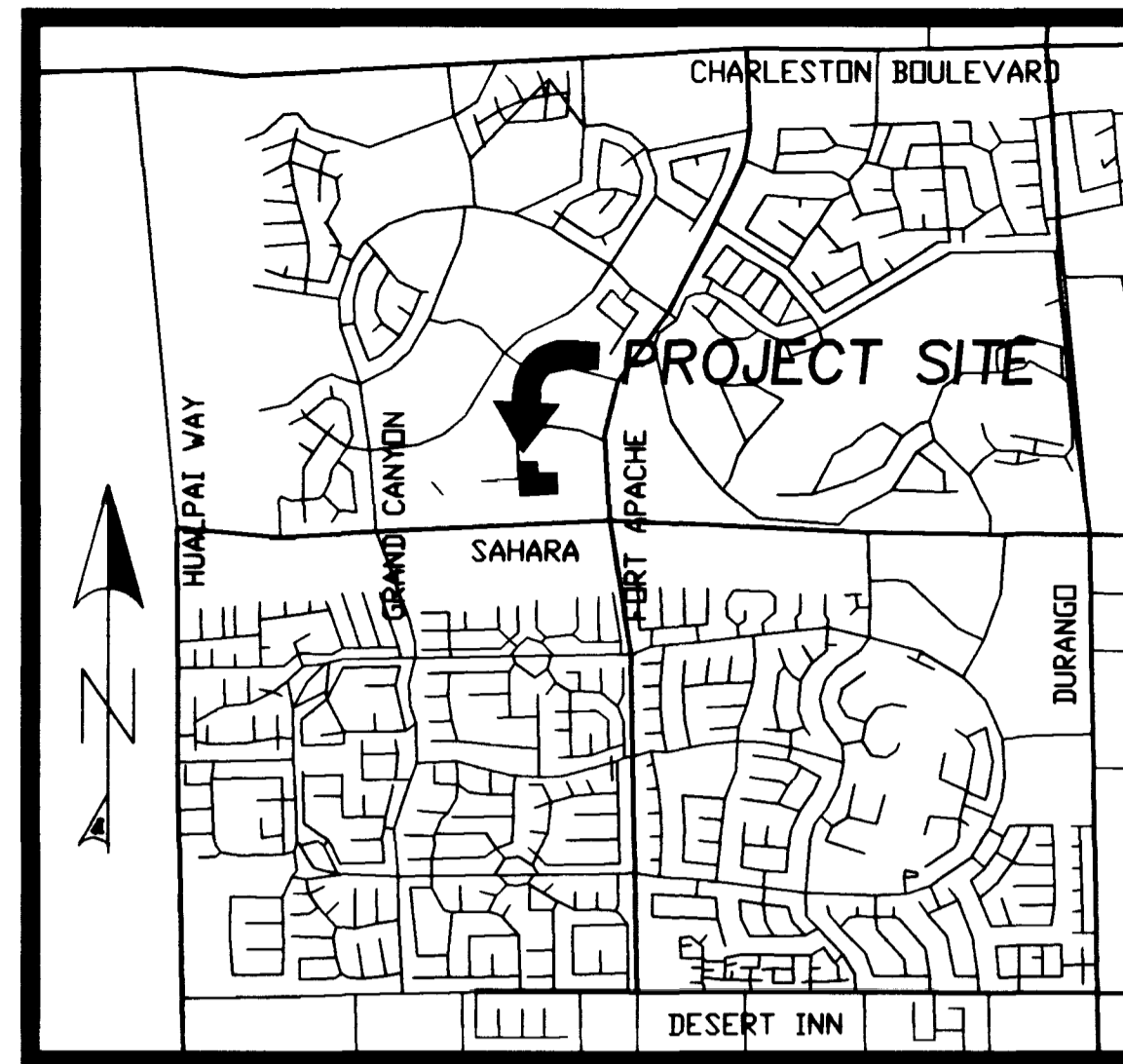

VICINITY MAP

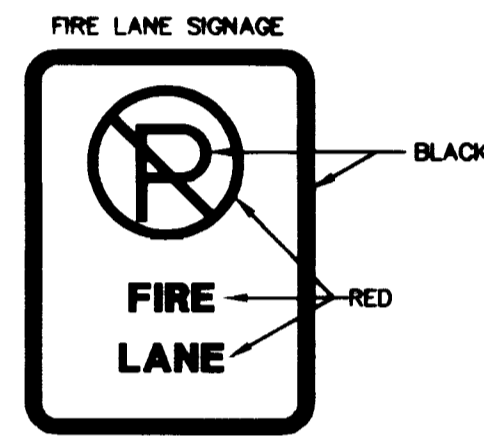

MINIMUM SPECIFICATIONS OF "NO PARKING FIRE LANE SIGNS" WITH CURB PAINTED RED (1) SIDE

SIZE: 1" WIDE X 1 1/2" LONG OR 2" WIDE X 2 1/2" LONG AS REQUIRED
COLOR: RED AND BLACK ON WHITE LUMINOUS BACKGROUND (SEE ABOVE EXAMPLE)

SYMBOL: INTERNATIONAL NO PARKING SYMBOL
HEIGHT: TO BE INSTALLED NOT LESS THAN SEVEN (7) FEET NOR MORE THAN TEN (10) FEET FROM GROUND LEVEL

NOTES:

FIRE LANE "NO PARKING" SIGNS SHALL BE INSTALLED PER THE DIRECTION OF THE FIRE DEPARTMENT INSPECTOR.

ALL CURBS SHALL BE PAINTED RED UNLESS ADJACENT TO PARKING SPACES, LOADING AREAS OR AS DIRECTED BY THE FIRE DEPT. INSPECTOR.

**FIRE LANE SIGN
TYPICAL DETAIL**

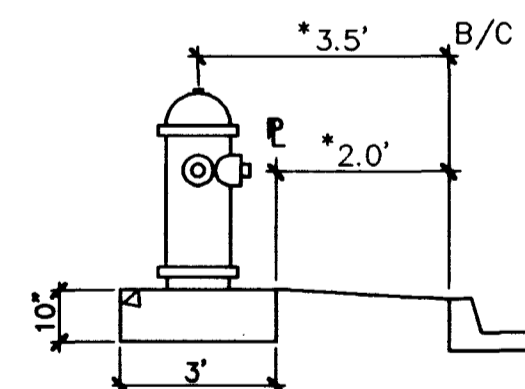

FIRE HYDRANT DETAIL

* AT LOCATIONS WITH ATTACHED SIDEWALK, PLACE CENTERLINE OF FIRE HYDRANT 1.5' FROM THE BACK OF WALK.

WATER DISTRICT STANDARD NOTES

- NO WORK SHALL BEGNN UNTIL THE WATER PLANS HAVE BEEN RELEASED FOR CONSTRUCTION BY THE LVVWD. FOLLOWING WATER PLAN APPROVAL, 48 HOUR NOTICE SHALL BE GIVEN TO THE LVVWD COMMUNICATION SUPPORT CENTER (258-7171) PRIOR TO THE START OF CONSTRUCTION. NOTICE MUST BE GIVEN BY 2:00 P.M. THE BUSINESS DAY PRIOR TO A LVVWD INSPECTION.
- ALL WORK SHALL CONFORM TO LVVWD STANDARD PLATES, DRAWINGS, AND SPECIFICATIONS, AND THE UNIFORM DESIGN AND CONSTRUCTION STANDARDS FOR WATER DISTRIBUTION SYSTEMS (UDACS), LATEST EDITION.
- ALL WORK, EXCEPT AS MODIFIED BY THESE PLANS OR BY NOTE 2, SHALL BE DONE IN ACCORDANCE WITH THE MOST CURRENT DRAFT OR EDITION OF THE UNIFORM STANDARD SPECIFICATIONS FOR PUBLIC WORKS CONSTRUCTION OFFSITE IMPROVEMENTS, CLARK COUNTY AREA.
- A SINGLE PIPE MATERIAL SHALL BE USED THROUGHOUT THE PROJECT UNLESS OTHERWISE APPROVED BY THE LVVWD.
- ALL SERVICE LATERALS TWO (2) INCHES IN DIAMETER AND SMALLER SHALL BE COPPER TUBING WITH LVVWD APPROVED SERVICE SADDLES.
- ALL WATER METER BOXES SHALL BE LOCATED OUTSIDE OF DRIVEWAY AREAS.
- ALL VALVES SHALL BE LOCATED OUTSIDE OF DRIVEWAYS, VALLEY AND CURB GUTTERS.
- THE FOLLOWING REQUIREMENTS MUST BE MET IN THE EVENT A WATER LINE AND A SANITARY OR STORM SEWER LINE CROSS:
A. A MINIMUM EIGHTEEN (18) INCH VERTICAL SEPARATION (OUTSIDE TO OUTSIDE) MUST BE MAINTAINED WHEN THE WATER LINE IS INSTALLED OVER THE SANITARY OR STORM SEWER LINE. IF THE VERTICAL SEPARATION CANNOT BE MAINTAINED OR THE WATER LINE MUST BE PLACED UNDER THE SANITARY OR STORM SEWER LINE, THE SANITARY OR STORM SEWER LINE MUST BE CONSTRUCTED WITH ONE OF THE FOLLOWING OR, AS SHOWN ON THESE PLANS:
A. POTABLE WATER SUPPLY QUALITY MATERIAL.
B. ENCASEMENT WITH FOUR (4) INCH CONCRETE (MINIMUM) ENCLOSURE WITH POTABLE WATER SUPPLY QUALITY PIPE.
C. SLEEVING WITH POTABLE WATER SUPPLY QUALITY PIPE.
EACH PROVISION MUST EXTEND ALONG THE SANITARY OR STORM SEWER, ON EITHER SIDE OF THE MAIN, A MINIMUM 10 FOOT DISTANCE PERPENDICULAR TO THE WATER MAIN EXTERIOR.
- WARNING TAPE SHALL BE REQUIRED OVER ALL MAINS, ALL SIX (6) INCH DIAMETER AND LARGER SERVICE LATERALS, AND ANY SERVICE LATERAL NOT INSTALLED PERPENDICULAR TO THE MAIN IN ACCORDANCE WITH STANDARD PLATE NO. 27.
- ALL WATER FACILITIES SHALL BE FILLED, DISINFECTED, PRESSURE TESTED, FLUSHED, FILLED AND AN ACCEPTABLE WATER SAMPLE OBTAINED PRIOR TO CONNECTION TO THE LVVWD'S DISTRIBUTION SYSTEM.
- THE CONTRACTOR MUST OBTAIN ALL METERS TWO (2) INCHES AND SMALLER FROM LVVWD CENTRAL STORES. TELEPHONE 258-3152 FORTY-EIGHT (48) HOURS PRIOR TO PICKUP.
- CONSTRUCTION MAY INTERRUPT SERVICE WITH LVVWD APPROVAL AND PROPER NOTIFICATION, BETWEEN THE HOURS OF 10 PM AND 6 AM, SUNDAY THROUGH THURSDAY. CIRCUMSTANCES MAY REQUIRE TEMPORARY SERVICE FEES BE INSTALLED, WITHOUT LVVWD REIMBURSEMENT. ANY TEMPORARY SERVICE FEES MUST HAVE PRIOR LVVWD APPROVAL.
- ALL WATER FACILITY CONSTRUCTION MATERIALS USED MUST BE AS LISTED ON THE LVVWD'S PRE-APPROVED MATERIALS AND MANUFACTURERS LISTING FOR NEW FACILITIES, LATEST REVISION, OR SPECIFICALLY APPROVED ON THESE PLANS.

WATER CROSSING NOTE

THE FOLLOWING ARE THE REQUIREMENTS THAT MUST BE MET WHEN THERE IS A WATER-SEWER CROSSING:

WHEN PROTECTION OF THE WATERLINE IS CONSIDERED, THE MINIMUM VERTICAL DISTANCE OF 18 INCHES MUST BE MAINTAINED WHEN THE WATER LINE IS INSTALLED OVER THE SEWER/STORM LINE. IF THIS DISTANCE CANNOT BE MAINTAINED BECAUSE OF PHYSICAL OBSTRUCTIONS OR THE WATERLINE MUST BE PLACED UNDER THE SEWER/STORM LINE, THE SEWER/STORM LINE MUST BE CONSTRUCTED WITH ANY ONE OF THE FOLLOWING:

- EXTRA HEAVY CAST IRON OR DUCTILE IRON PIPE
- WATER SUPPLY QUALITY MATERIAL
- ENCASEMENT WITH 4 INCHES MINIMUM OF CONCRETE OR SLEEVING WITH WATER QUALITY PIPE

EACH OF THESE PROVISIONS MUST BE EXTENDED TO 10 FEET ON EITHER SIDE OF THE WATERLINE AT 90 DEGREES TO THE CROSSING.

ONSITE SEWER NOTES:

ALL ONSITE SANITARY SEWERS ARE PRIVATELY OWNED AND MAINTAINED.

ALL ONSITE SAN. SEWER AND WATER SHALL SHALL BE CONSTRUCTED TO C.L.V. STANDARDS UNLESS SHOWN OTHERWISE IN THE PLANS.

BENCHMARK

CLV BENCHMARK #1LV-1065566
RIVET & PLATE IN TOP OF NORTH CURB
LINE AT 9501 W. SAHARA AVENUE.
ELEVATION = 860.879 METERS (NAVD 88)
= 2824.401 FEET (NAVD 88).

PLAN INFORMATION:

SEE COVER SHEET FOR GENERAL NOTES, LEGAL DESCRIPTION AND BASIS OF BEARINGS.
SEE THE RECORDED PLAT MAPS FOR BOUNDARY CONTROL INFORMATION.

CITY OF LAS VEGAS FIRE DEPARTMENT NOTES

- ALL WORK SHALL BE DONE IN STRICT ACCORDANCE WITH THE CITY OF LAS VEGAS FIRE DEPARTMENT "HYDRANT SPECIFICATIONS," "HYDRANT INSTALLATION SPECIFICATIONS" AND ORDINANCE #3944.
- AUTHORIZED HYDRANTS FOR THIS PROJECT ARE:
A. KENNEDY GUARDIAN
B. MUELLER A-423 CENTURIAN
C. GLOW MODEL 2546 MEDALLION
- ON ANY NEW HOME OR BUILDING INSTALLATION, ACCESSIBLE FIRE HYDRANTS SHALL BE INSTALLED BEFORE COMBUSTIBLE CONSTRUCTION COMMENCES AND SAID FIRE HYDRANTS SHALL BE IN GOOD WORKING ORDER WITH AN ADEQUATE WATER SUPPLY.
- CONTRACTOR SHALL PLACE A BLUE REFLECTIVE MARKER AT CENTERLINE OF STREET ADJACENT TO FIRE HYDRANT AS REQUIRED IN ORDINANCE #3944 TO IDENTIFY THE FIRE HYDRANT LOCATIONS.
- CONTRACTOR SHALL CALL THE LAS VEGAS BUILDING DEPARTMENT AT 229-2071 FOR UNDERGROUND INSPECTION, PRESSURE AND FLUSH VERIFICATIONS OF ALL FIRE HYDRANTS AND FIRE LINES BEFORE BACKFILLING.
- PAINTING OF THE CURBS AND HYDRANTS AND ANY WORK NECESSARY FOR PROTECTION OF HYDRANTS FROM PHYSICAL DAMAGE, PER ORDINANCE #3944, SHALL BE COMPLETED BEFORE APPROVAL BY THE CITY OF LAS VEGAS FIRE DEPARTMENT.
- A PERMIT IS REQUIRED FROM THE FIRE DEPARTMENT FOR ON-SITE WATER LINE AND FIRE HYDRANT. THE PERMIT AND CONTRACTOR'S MATERIAL AND TEST CERTIFICATE FOR UNDERGROUND PIPING FORM SHALL BE OBTAINED FROM THE FIRE PROTECTION ENGINEER PRIOR TO ANY WORK BEGINNING.
- PRIVATE FIRE HYDRANTS SHALL BE PAINTED RED.
- A FLOW TEST MUST BE WITNESSED BY THE FIRE DEPARTMENT PRIOR TO OCCUPANCY FOR VERIFICATION OF REQUIRED ON-SITE WATER SUPPLY.
- ALL ON-SITE FIRE MAIN MATERIALS MUST BE U.L. LISTED AND A N.W.A. APPROVED.
- FIRE HYDRANT SPACING:
RESIDENTIAL - 500 FEET UNSPRINKLERED, 1,000 FEET UNSPRINKLERED COMMERCIAL, INCLUDING MULTI-FAMILY - 300 FEET UNSPRINKLERED, 600 FEET SPRINKLERED.
- WHERE NEW WATER MAINS ARE EXTENDED ALONG STREETS, WHERE HYDRANTS ARE NOT NEEDED FOR PROTECTION OF STRUCTURES, FIRE HYDRANTS SHALL BE SPACED AT MAXIMUM 1,000 FOOT SPACING TO PROVIDE FOR TRANSPORTATION HAZARDS.
- NO FIRE HYDRANT SHALL BE LOCATED WITHIN THE REQUIRED RADIUS OF A CUL-DE-SAC OR WITHIN 20 FEET OF THE PERIMETER OF THE RADIUS OF THE CUL-DE-SAC.
- NO FIRE HYDRANT SHALL BE LOCATED WITHIN 6 FEET OF ANY CURB RETURN, DRIVEWAY, POWER POLE, STREET LIGHT OR ANY OTHER OBSTRUCTION.
- TWO SOURCES OF SUPPLY ARE REQUIRED WHENEVER THERE ARE 4 OR MORE HYDRANTS INSTALLED ON A SINGLE SYSTEM.
- NOT MORE THAN 2 HYDRANTS CAN BE OUT OF SERVICE DUE TO A SINGLE MAIN BREAK.
- FIRE APPARATUS ACCESS ROADS SHALL HAVE AN UNOBSTRUCTED WIDTH OF NOT LESS THAN 20 FEET PROVIDED NO PARKING IS ALLOWED, NOT LESS THAN 28 FEET IF PARALLEL PARKING IS ALLOWED ON ONE SIDE, AND NOT LESS THAN 36 FEET IF PARALLEL PARKING IS ALLOWED ON BOTH SIDES. VERTICAL CLEARANCE SHALL BE NOT LESS THAN 13 FEET 6 INCHES.
- THE TURNING RADIUS FOR ANY FIRE APPARATUS ACCESS ROAD AND/OR FIRE LANE, PUBLIC OR PRIVATE, SHALL BE NOT LESS THAN 45 FEET OUTSIDE RADIUS AND 22 FEET INSIDE RADIUS.
- A FIRE APPARATUS ROAD SHALL BE REQUIRED WHEN ANY PORTION OF AN EXTERIOR WALL OF THE FIRST STORY IS LOCATED MORE THAN 150 FEET FROM A FIRE DEPARTMENT VEHICLE ACCESS (SEE EXCEPTIONS IN UPC 94, SECTION 902.2).
- ALL DEAD END FIRE APPARATUS ACCESS ROADS AND/OR FIRE LANES, PUBLIC OR PRIVATE, IN EXCESS OF 150 FEET IN LENGTH SHALL BE PROVIDED WITH AN APPROVED TURN AROUND AREA. SEE ORDINANCE #3944.
- ACCESS ROADS SHALL BE MARKED BY PLACING APPROVED SIGNS AT THE START OF THE DESIGNATED FIRE LANE, ONE SIGN AT THE END OF THE FIRE LANE AND WITH SIGNS AT INTERVALS OF 100 FEET ALONG ALL DESIGNATED FIRE LANES. SIGNS TO BE PLACED ON BOTH SIDES OF AN ACCESS ROADWAY IF NEEDED TO PREVENT PARKING ON EITHER SIDE. SIGNS TO BE INSTALLED NO HIGHER THAN 10 FEET OR LESS THAN 6 FEET FROM ROADWAY LEVEL. THE CURBS ALONG OR ON THE PAVEMENT OR CEMENT IF CURBS IS NOT PRESENT, SHALL BE PAINTED WITH A RED WEATHER RESISTANT PAINT IN ADDITION TO THE SIGNS.
- ELECTRICALLY CONTROLLED ACCESS GATES SHALL BE PROVIDED WITH AN APPROVED EMERGENCY VEHICLE DETECTOR/RECEIVER SYSTEM. SAID SYSTEM SHALL BE INSTALLED IN ACCORDANCE WITH THE CITY OF LAS VEGAS GUIDELINES FOR AUTOMATIC EMERGENCY VEHICLE ACCESS GATES.

FIRE FLOW CALCULATIONS

FIRE FLOW REQUIREMENT IS 3125 GALLONS PER MINUTE AT 20 psi RESIDUAL PRESSURE.

BASED ON: THE HIGHEST FLOW RATE REQUIRED BY THE LARGEST BLDG.

ITEM	RETAIL BLD 5	CRAB SHACK
AREA-SQUARE FOOTAGE:	4200	6050
LARGEST AREA BETWEEN FOUR-HOUR AREA SEPARATION WALLS:	4200	6050
BUILDING HEIGHT:	25'	30'
NUMBER OF STORIES:	1	1
TYPE OF CONSTRUCTION:	5-B	5-B
OCCUPANCY:	M,B	A-3
FULL AUTOMATIC FIRE SPRINKLER SYSTEM:	YES	YES

APPROVALS:

By: *[Signature]* DATE: **SEPT 1998**
CITY OF LAS VEGAS FIRE MARSHALL

TRIPLE FIVE NEVADA DEVELOPMENT CORP.
9510 WEST SAHARA
LAS VEGAS, NEVADA 89117
702-242-8937

CONSULTING ENGINEERS • PLANNERS • LAND SURVEYORS
2727 SOUTH RAINBOW BOULEVARD
LAS VEGAS, NEVADA 89102-6148 PHONE (702) 875-7550 FAX (702) 362-2597

PHASE 4
MASTER UTILITY PLAN
RETAIL BLD 5 & JOE'S CRAB SHACK
WELLINGTON COMMERCIAL CENTER
AT PECOCLE RANCH

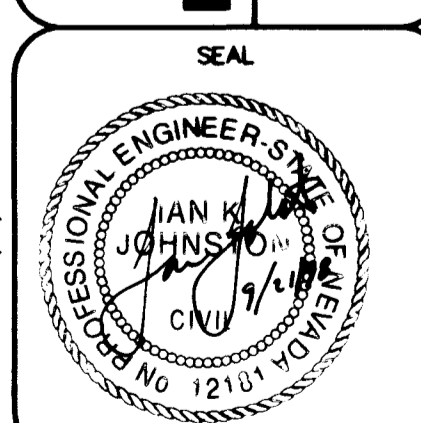

NO. 5085-4
DATE: **SEPT 1998**
SCALE: HORIZ. N/A
VERT. N/A
SHEET: **5** OF 8 SHEETS

CITY OF LAKE WAASH TRADING AREA

1. [REDACTED]

2. [REDACTED]

3. [REDACTED]

4. [REDACTED]

5. [REDACTED]

6. [REDACTED]

7. [REDACTED]

8. [REDACTED]

9. [REDACTED]

10. [REDACTED]

11. [REDACTED]

12. [REDACTED]

13. [REDACTED]

14. [REDACTED]

15. [REDACTED]

16. [REDACTED]

17. [REDACTED]

18. [REDACTED]

19. [REDACTED]

20. [REDACTED]

CITY OF LAKE WAASH TRADING AREA

1. [REDACTED]

2. [REDACTED]

3. [REDACTED]

4. [REDACTED]

5. [REDACTED]

6. [REDACTED]

7. [REDACTED]

8. [REDACTED]

9. [REDACTED]

10. [REDACTED]

11. [REDACTED]

12. [REDACTED]

13. [REDACTED]

14. [REDACTED]

15. [REDACTED]

16. [REDACTED]

17. [REDACTED]

18. [REDACTED]

19. [REDACTED]

20. [REDACTED]

SOLAR CONTRIBUTION

AVERAGE DAILY FLOW = 0.002 MGD
 PEAK FLOW = 0.004 MGD

CITY OF LAKE WAASH TRADING AREA

1. [REDACTED]

2. [REDACTED]

3. [REDACTED]

4. [REDACTED]

5. [REDACTED]

6. [REDACTED]

7. [REDACTED]

8. [REDACTED]

9. [REDACTED]

10. [REDACTED]

11. [REDACTED]

12. [REDACTED]

13. [REDACTED]

14. [REDACTED]

15. [REDACTED]

16. [REDACTED]

17. [REDACTED]

18. [REDACTED]

19. [REDACTED]

20. [REDACTED]

**Call
 360-578-3333**



VELOCITY CAP



DESCRIPTION - This device will limit the velocity of flow in the pipe to the velocity of the pipe. It is used to prevent the pipe from being damaged by high velocity flow.

INSTALLATION - This device should be installed in the pipe in the direction of flow. It should be installed in the pipe in the direction of flow.

MAINTENANCE - This device should be inspected regularly to ensure that it is functioning properly.

PIPE LANE SIGN



**FOR STREET SIGN
 12" x 18" x 1/2"**

CITY OF LAKE WAASH TRADING AREA

1. [REDACTED]

2. [REDACTED]

3. [REDACTED]

4. [REDACTED]

5. [REDACTED]

6. [REDACTED]

7. [REDACTED]

8. [REDACTED]

9. [REDACTED]

10. [REDACTED]

11. [REDACTED]

12. [REDACTED]

13. [REDACTED]

14. [REDACTED]

15. [REDACTED]

16. [REDACTED]

17. [REDACTED]

18. [REDACTED]

19. [REDACTED]

20. [REDACTED]

CITY OF LAKE WAASH TRADING AREA

1. [REDACTED]

2. [REDACTED]

3. [REDACTED]

4. [REDACTED]

5. [REDACTED]

6. [REDACTED]

7. [REDACTED]

8. [REDACTED]

9. [REDACTED]

10. [REDACTED]

11. [REDACTED]

12. [REDACTED]

13. [REDACTED]

14. [REDACTED]

15. [REDACTED]

16. [REDACTED]

17. [REDACTED]

18. [REDACTED]

19. [REDACTED]

20. [REDACTED]

GENERAL NOTES

1. ALL CONCRETE STRUCTURES SHALL BE REINFORCED WITH STEEL.

2. ALL STRUCTURES SHALL BE CONSTRUCTED TO ALL APPLICABLE STANDARDS AND SPECIFICATIONS.

3. ALL STRUCTURES SHALL BE CONSTRUCTED TO ALL APPLICABLE STANDARDS AND SPECIFICATIONS.

GENERAL NOTES

NO.	DESCRIPTION	DATE
1	ADD	
2	ADD	
3	ADD	
4	ADD	
5	ADD	
6	ADD	
7	ADD	
8	ADD	
9	ADD	
10	ADD	

[Signature]

PHASE 4

MASTERS UTILITY PLAN

RETAIL BLD 8 & JOE'S GRAB BRACK

WELLINGTON COMMERCIAL CENTER

AT RAINBOW BLVD

VTI

Call 360-578-3333

PHASE 4

MASTERS UTILITY PLAN

RETAIL BLD 8 & JOE'S GRAB BRACK

WELLINGTON COMMERCIAL CENTER

AT RAINBOW BLVD

VTI

Call 360-578-3333

PHASE 4

MASTERS UTILITY PLAN

RETAIL BLD 8 & JOE'S GRAB BRACK

WELLINGTON COMMERCIAL CENTER

AT RAINBOW BLVD

VTI

Call 360-578-3333