

**PARADISE FALLS ST. - PLAN**  
 HORIZONTAL SCALE: 1"=40'  
 (PRIVATE TO BE MAINTAINED BY HOMEOWNERS ASSOCIATION)

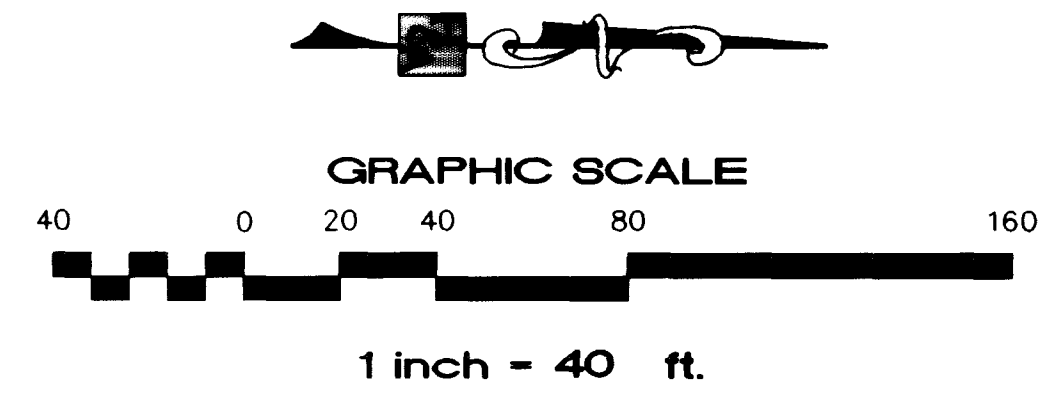

**CONSTRUCTION KEY**

- STREET IMPROVEMENTS**
- ① NOT USED
  - ② NOT USED
  - ③ 36" (PRIVATE) = CONSTRUCT 2" AC PAVING OVER 4" TYPE II BASE ON 6" TYPE I BASE PER U.S.D.C.C.A. STANDARD DWG. NO. 210.
  - ④ CONSTRUCT 8" WIDE CROSS GUTTER PER U.S.D.C.C.A. STANDARD DRAWING NO. 228
  - ⑤ CONSTRUCT SIDEWALK RAMP PER U.S.D.C.C.A. STANDARD DWG. NO. 235 A=B.0, B=B.0 UNLESS OTHERWISE NOTED ON PLANS.
  - ⑥ CONSTRUCT "L" CURB PER U.S.D.C.C.A. STANDARD DWG. NO. 216
  - ⑦ CONSTRUCT 5" WIDE CONCRETE SIDEWALK PER U.S.D.C.C.A. STANDARD DRAWING NO. 234
  - ⑧ CONSTRUCT WEDGE CURB PER DETAIL 6 ON SHEET DT1

**CONSTRUCTION NOTES**

1. HUNSAKER & ASSOCIATES SHALL BE NOTIFIED IMMEDIATELY OF ANY DISCREPANCIES IN THE PLANS OR CONDITIONS IN THE FIELD.
2. PRIOR TO CONSTRUCTION CONTRACTOR SHALL BE RESPONSIBLE FOR VERIFYING ALL EXISTING UTILITY LOCATION AND ELEVATIONS AND SHALL CONTACT ENGINEER IF ANY DISCREPANCIES ARE FOUND.
3. ADD 2300 TO ALL PAD ELEVATIONS AND FINISH FLOOR ELEVATIONS SHOWN.

**BACK OF CURB CURVE DATA TABLE**

CURVE	RADIUS	LENGTH	TANGENT	DELTA
C1	30.00'	47.12'	30.00'	90°00'00"
C2	30.00'	47.12'	30.00'	90°00'00"
C3	7.00'	21.99'	<math>\infty</math>	180°00'00"
C4	83.00'	65.00'	33.80'	40°02'34"
C5	107.00'	74.78'	38.99'	40°02'34"
C6	135.00'	84.35'	49.19'	40°02'34"
C7	85.00'	45.43'	23.89'	40°02'34"
C8	205.00'	146.88'	76.75'	41°03'09"
C9	177.00'	105.42'	54.33'	34°07'35"
C10	163.00'	97.09'	50.03'	34°07'35"
C11	135.00'	86.73'	50.54'	41°03'09"
C12	7.00'	21.99'	<math>\infty</math>	180°00'00"
C13	7.00'	21.99'	<math>\infty</math>	180°00'00"
C14	107.00'	56.83'	29.10'	30°28'00"
C15	83.00'	48.40'	25.30'	30°28'00"
C16	7.00'	21.99'	<math>\infty</math>	180°00'00"
C17	135.00'	85.95'	44.49'	36°28'47"
C18	85.00'	44.35'	7.21'	17°29'04"
C19	19.50'	38.60'	29.70'	113°29'20"
C20	19.50'	27.11'	16.26'	79°38'42"

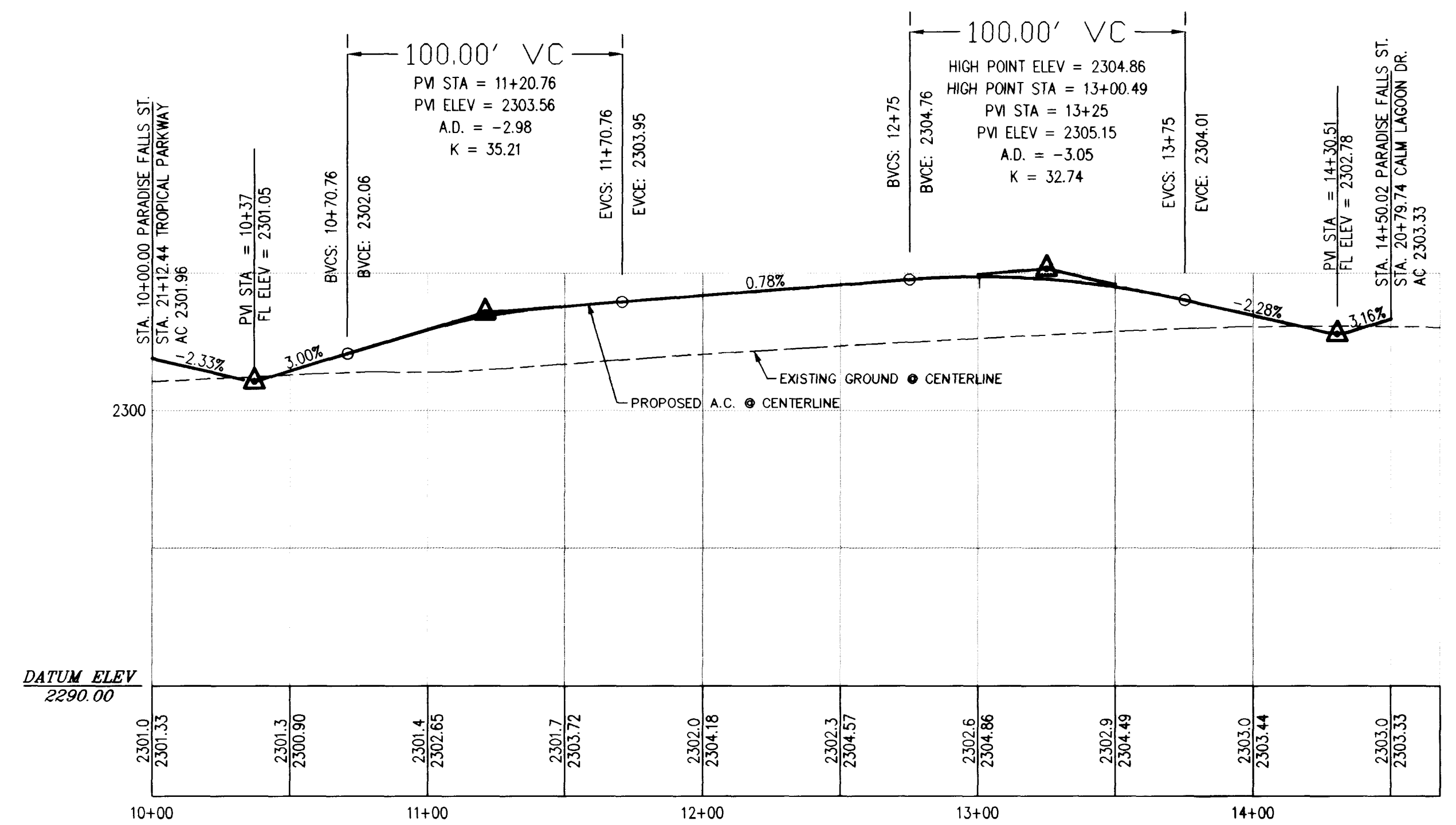

**PARADISE FALLS ST. - PROFILE**  
 HORIZONTAL SCALE: 1"=40'  
 VERTICAL SCALE: 1"=4'

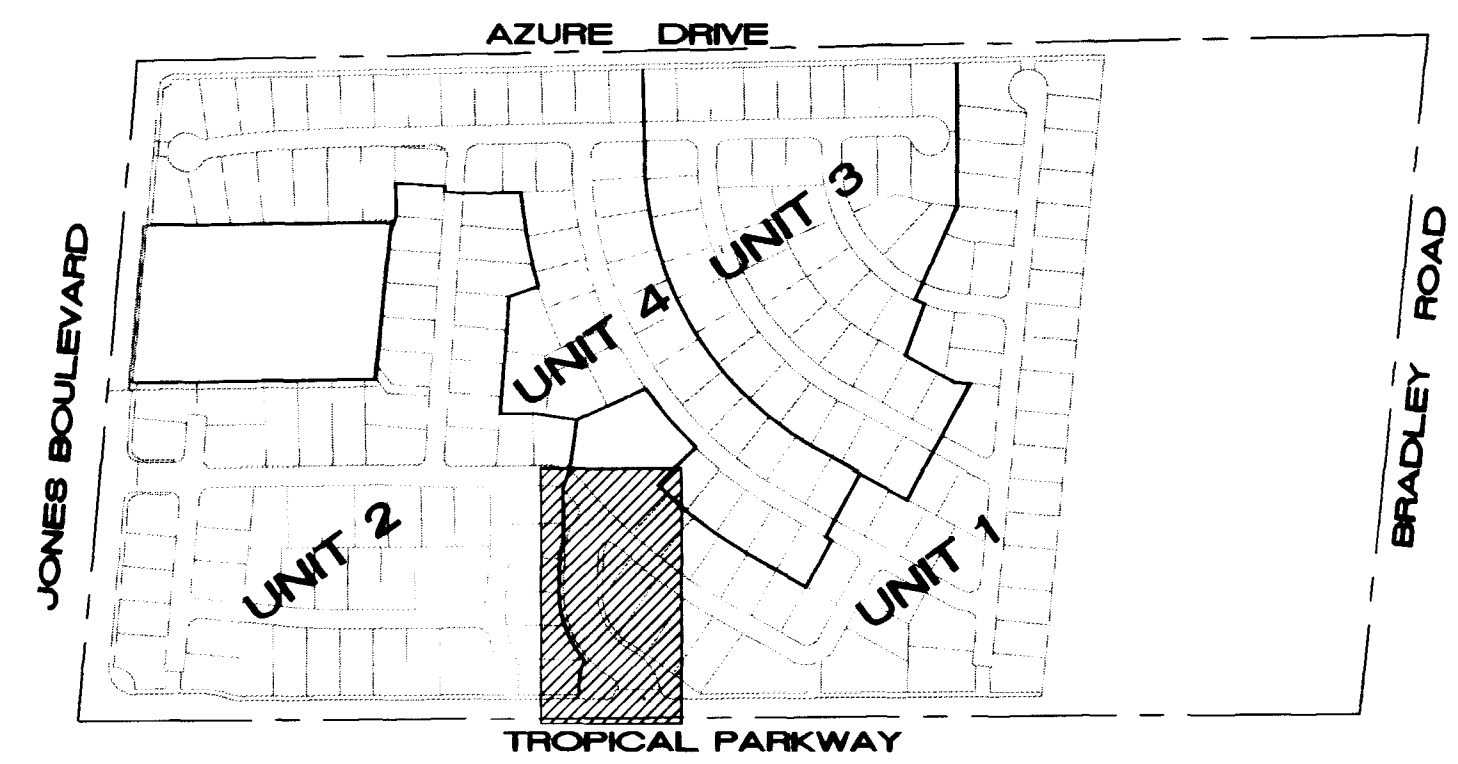

**KEY MAP**  
 NTS

**BASIS OF BEARING**

BEING THE CENTER LINE OF AZURE DRIVE BETWEEN BRADLEY ROAD AND LEON AVENUE, AS SHOWN ON THE RECORD OF SURVEY IN FILE 52 OF SURVEYS PAGE 70 WHICH BEARS NORTH 88°46'05" EAST.

**BENCHMARK**

CITY OF LAS VEGAS BENCHMARK NO. 11V90, 25N4  
 CAP ON REBAR, PLS 6201, CENTENNIAL PKWY. AND BRADLEY ROAD.  
 ELEVATION = 701.8865 METERS (NAVD 88)  
 2302.77 FEET (NAVD 88)

Avoid overhead power line contact  
**Call before you OVERHEAD**  
 1-702-593-6111  
 NEVADA POWER ENVIRONMENT SAFETY SERVICES DEPARTMENT

Avoid cutting underground utility lines. It's costly  
**Call before you Dig**  
 1-800-227-2600  
 UNDERGROUND SERVICE (USA)

	<b>D.R. HORTON</b> CUSTOM HOMES 2920 N. GREEN VALLEY PKWY, SUITE 111 HENDERSON, NV. 89014 (702) 435-4888, FAX (702) 435-4950
	<b>HUNSAKER &amp; ASSOCIATES</b> PLANNING ENGINEERING SURVEYING NEVADA, L.P.C. 401 N. BUFFALO DR. SUITE 100, LAS VEGAS, NEVADA 89128 (702) 545-4300
PARADISE FALLS STREET STREET PLAN AND PROFILE	TROPICAL / JONES UNIT 1 AKA PARADISE FALLS UNIT 1 CITY OF LAS VEGAS, NEVADA
DRAWN BY: P.DARRASH DESIGNED BY: P.DARRASH CHECKED BY: A.SANJICO PROJECT NO. 2291-1	SHEET QUALITY CONTROL BY: SCALE: 1" = 40' 1" = 1' 2291-1
SEAL 	SHEET <b>PP8</b> 21 OF 31 DRAWING NO. <b>107Y4592-1</b>

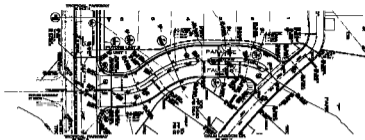

PARADISE FALLS ST. - PLAN  
SCALE: 1" = 40'



**CONSTRUCTION KEY**

**STREET IMPROVEMENTS**

- ① 10' WIDEN
- ② 15' WIDEN
- ③ 7' CURB, 1' SHOULDER, 1' SIDEWALK, 1' 1/2' 10' WIDEN
- ④ 7' CURB, 1' SHOULDER, 1' SIDEWALK, 1' 1/2' 10' WIDEN
- ⑤ 10' WIDEN, 1' SHOULDER, 1' SIDEWALK, 1' 1/2' 10' WIDEN
- ⑥ 10' WIDEN, 1' SHOULDER, 1' SIDEWALK, 1' 1/2' 10' WIDEN
- ⑦ 10' WIDEN, 1' SHOULDER, 1' SIDEWALK, 1' 1/2' 10' WIDEN
- ⑧ 10' WIDEN, 1' SHOULDER, 1' SIDEWALK, 1' 1/2' 10' WIDEN

**CONSTRUCTION METHODS**

1. EXISTING CURB AND GUTTER TO BE RECONSTRUCTED TO MATCH ADJACENT CURB AND GUTTER.
2. NEW CURB AND GUTTER TO BE RECONSTRUCTED TO MATCH EXISTING CURB AND GUTTER.
3. NEW CURB AND GUTTER TO BE RECONSTRUCTED TO MATCH EXISTING CURB AND GUTTER.

**BACK OF CURB CURVE DATA TABLE**

STATION	BACK OF CURB	CURVE DATA
0+00	10.00	10.00
0+10	10.00	10.00
0+20	10.00	10.00
0+30	10.00	10.00
0+40	10.00	10.00
0+50	10.00	10.00
0+60	10.00	10.00
0+70	10.00	10.00
0+80	10.00	10.00
0+90	10.00	10.00
1+00	10.00	10.00
1+10	10.00	10.00
1+20	10.00	10.00
1+30	10.00	10.00
1+40	10.00	10.00
1+50	10.00	10.00
1+60	10.00	10.00
1+70	10.00	10.00
1+80	10.00	10.00
1+90	10.00	10.00
2+00	10.00	10.00
2+10	10.00	10.00
2+20	10.00	10.00
2+30	10.00	10.00
2+40	10.00	10.00
2+50	10.00	10.00
2+60	10.00	10.00
2+70	10.00	10.00
2+80	10.00	10.00
2+90	10.00	10.00
3+00	10.00	10.00
3+10	10.00	10.00
3+20	10.00	10.00
3+30	10.00	10.00
3+40	10.00	10.00
3+50	10.00	10.00
3+60	10.00	10.00
3+70	10.00	10.00
3+80	10.00	10.00
3+90	10.00	10.00
4+00	10.00	10.00
4+10	10.00	10.00
4+20	10.00	10.00
4+30	10.00	10.00
4+40	10.00	10.00
4+50	10.00	10.00
4+60	10.00	10.00
4+70	10.00	10.00
4+80	10.00	10.00
4+90	10.00	10.00
5+00	10.00	10.00
5+10	10.00	10.00
5+20	10.00	10.00
5+30	10.00	10.00
5+40	10.00	10.00
5+50	10.00	10.00
5+60	10.00	10.00
5+70	10.00	10.00
5+80	10.00	10.00
5+90	10.00	10.00
6+00	10.00	10.00
6+10	10.00	10.00
6+20	10.00	10.00
6+30	10.00	10.00
6+40	10.00	10.00
6+50	10.00	10.00
6+60	10.00	10.00
6+70	10.00	10.00
6+80	10.00	10.00
6+90	10.00	10.00
7+00	10.00	10.00
7+10	10.00	10.00
7+20	10.00	10.00
7+30	10.00	10.00
7+40	10.00	10.00
7+50	10.00	10.00
7+60	10.00	10.00
7+70	10.00	10.00
7+80	10.00	10.00
7+90	10.00	10.00
8+00	10.00	10.00
8+10	10.00	10.00
8+20	10.00	10.00
8+30	10.00	10.00
8+40	10.00	10.00
8+50	10.00	10.00
8+60	10.00	10.00
8+70	10.00	10.00
8+80	10.00	10.00
8+90	10.00	10.00
9+00	10.00	10.00
9+10	10.00	10.00
9+20	10.00	10.00
9+30	10.00	10.00
9+40	10.00	10.00
9+50	10.00	10.00
9+60	10.00	10.00
9+70	10.00	10.00
9+80	10.00	10.00
9+90	10.00	10.00
10+00	10.00	10.00

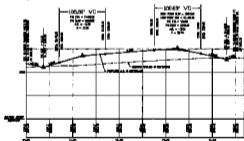

PARADISE FALLS ST. - PROFILE  
SCALE: 1" = 40'



KEY MAP

BASED ON BEARING  
**84°30'00" N**  
 FROM THE  
 BENCHMARK  
**84°30'00" N**  
 FROM THE  
 BENCH MARK

DATE: 11/11/11  
 DRAWN BY: [Name]  
 CHECKED BY: [Name]  
 APPROVED BY: [Name]

**D. R. HORTON**  
 ENGINEERS & ARCHITECTS  
 11111 N. 111th St., Suite 100, Omaha, NE 68148  
 (402) 426-1111  
 FAX: (402) 426-1112  
 www.drhorton.com

PROJECT NO. 11111  
 SHEET NO. 11111  
 DATE: 11/11/11

PARADISE FALLS STREET  
 STREET PLAN AND PROFILE  
 AKA PARADISE FALLS STREET  
 CITY OF LAS VEGAS, NEVADA