

COCKTAIL DRIVE - PLAN
HORIZONTAL SCALE: 1"=40'
(PRIVATE TO BE MAINTAINED BY HOMEOWNERS ASSOCIATION)

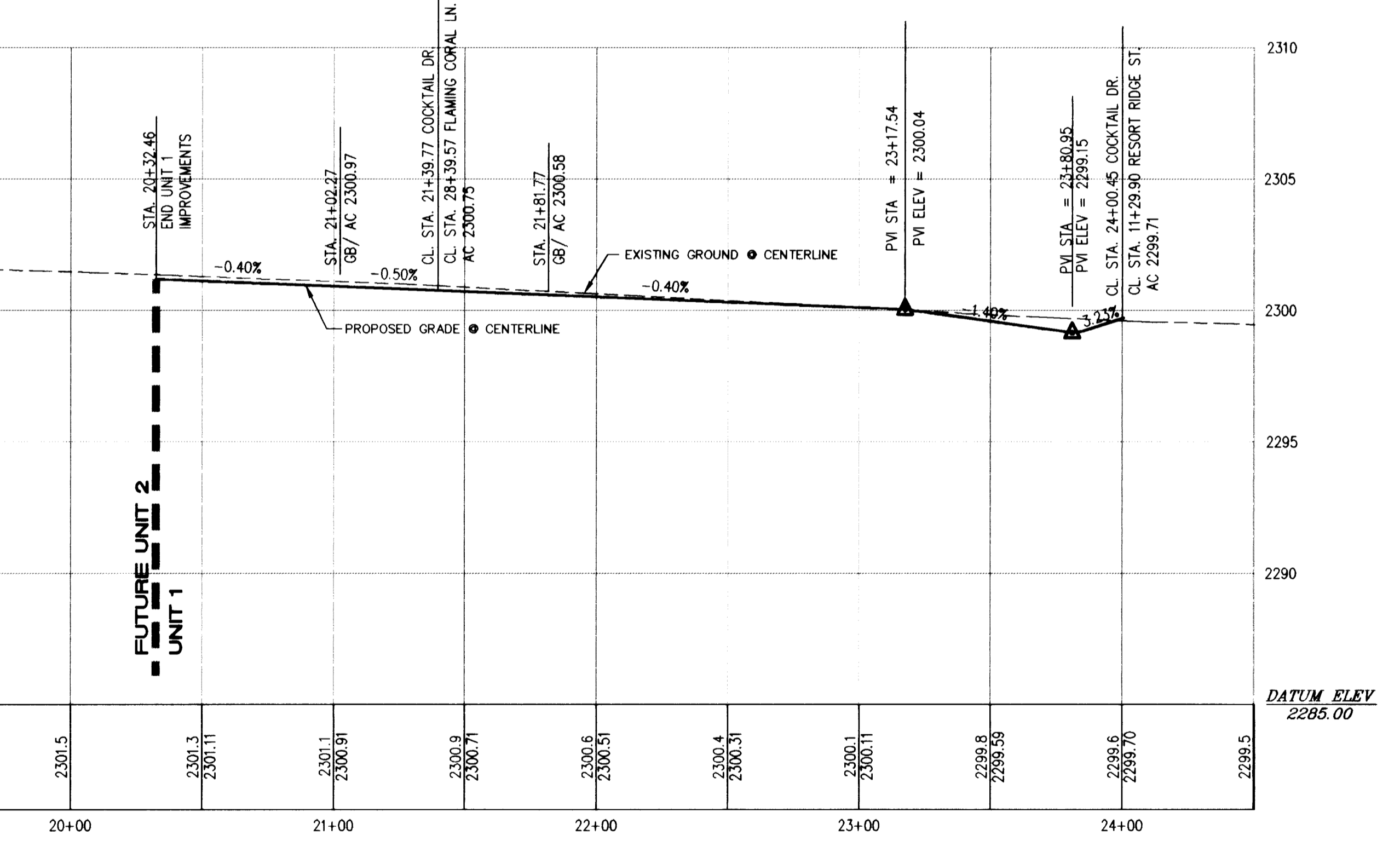

COCKTAIL DRIVE - PROFILE
HORIZONTAL SCALE: 1"=40'
VERTICAL SCALE: 1"=4'

BACK OF CURB CURVE DATA TABLE

CURVE	RADIUS	LENGTH	TANGENT	DELTA
C27	19.50	30.63	19.50	90°00'00"
C28	24.00	37.70	24.00	90°00'00"
C29	166.00	50.67	25.54	177°29'24"
C30	130.00	29.92	15.03	131°11'44"
C31	19.50	33.27	22.34	97°45'41"
C32	20.00	29.37	18.05	84°07'58"
C35	19.50	26.88	16.07	78°58'11"
C36	170.00	32.55	16.33	105°58'15"
C37	24.00	48.81	35.41	111°45'50"
C38	299.00	37.70	24.00	90°00'00"
C39	326.00	107.98	54.48	185°43'43"
C40	290.00	96.06	48.47	185°43'43"
C41	19.50	30.63	19.50	90°00'00"

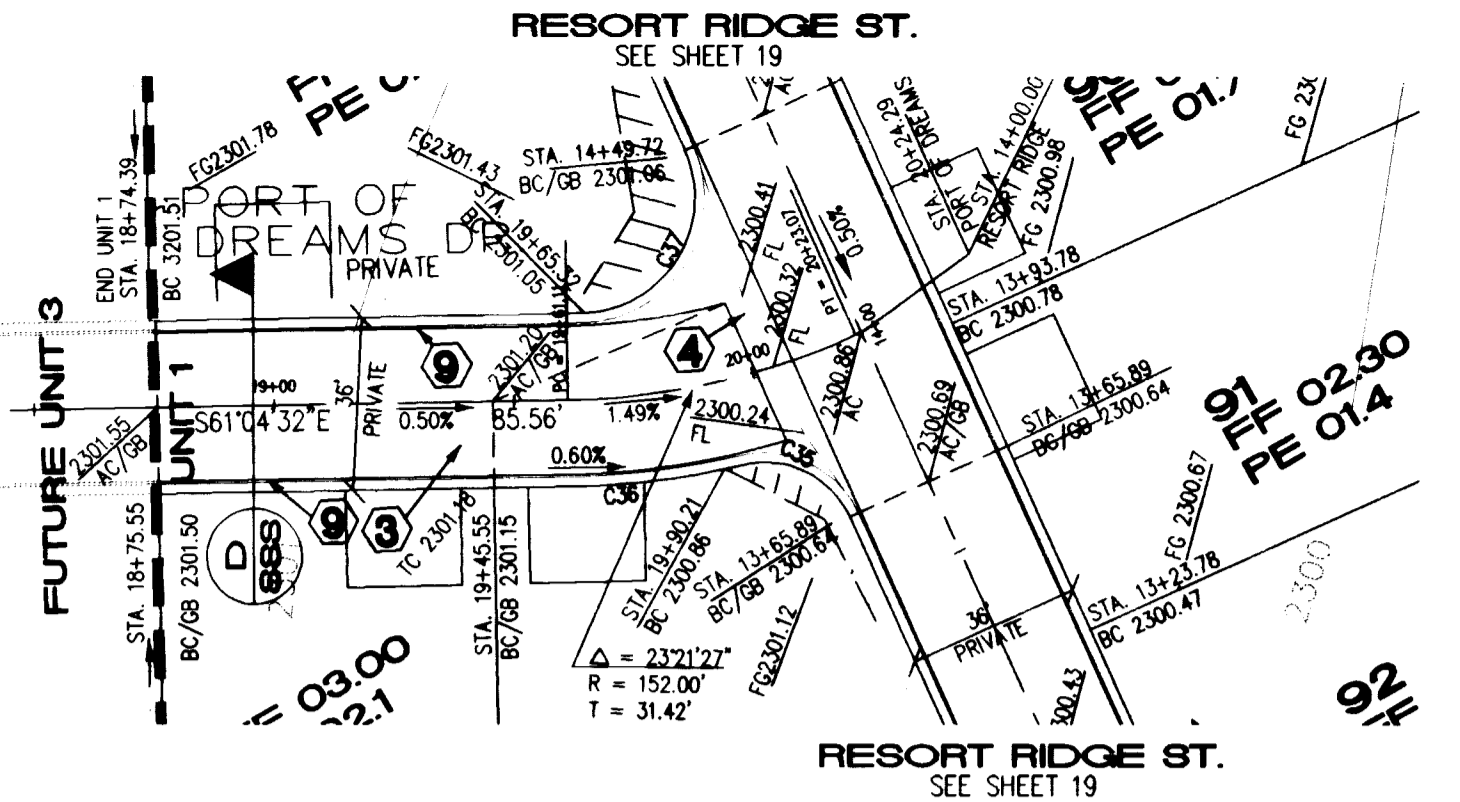

PORT OF DREAMS DR. - PLAN
HORIZONTAL SCALE: 1"=40'
(PRIVATE TO BE MAINTAINED BY HOMEOWNERS ASSOCIATION)

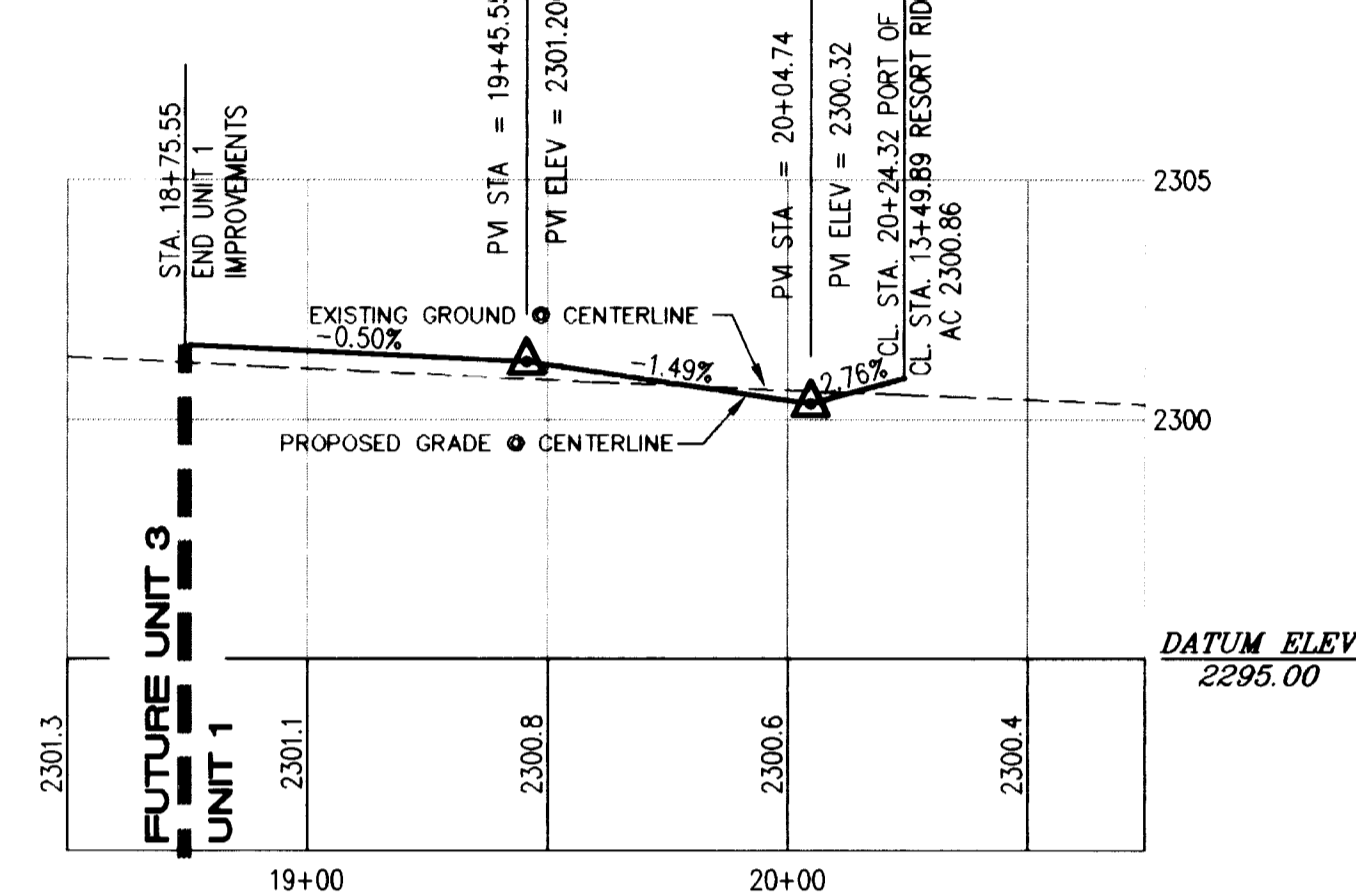

PORT OF DREAMS DR. - PROFILE
HORIZONTAL SCALE: 1"=40'
VERTICAL SCALE: 1"=4'

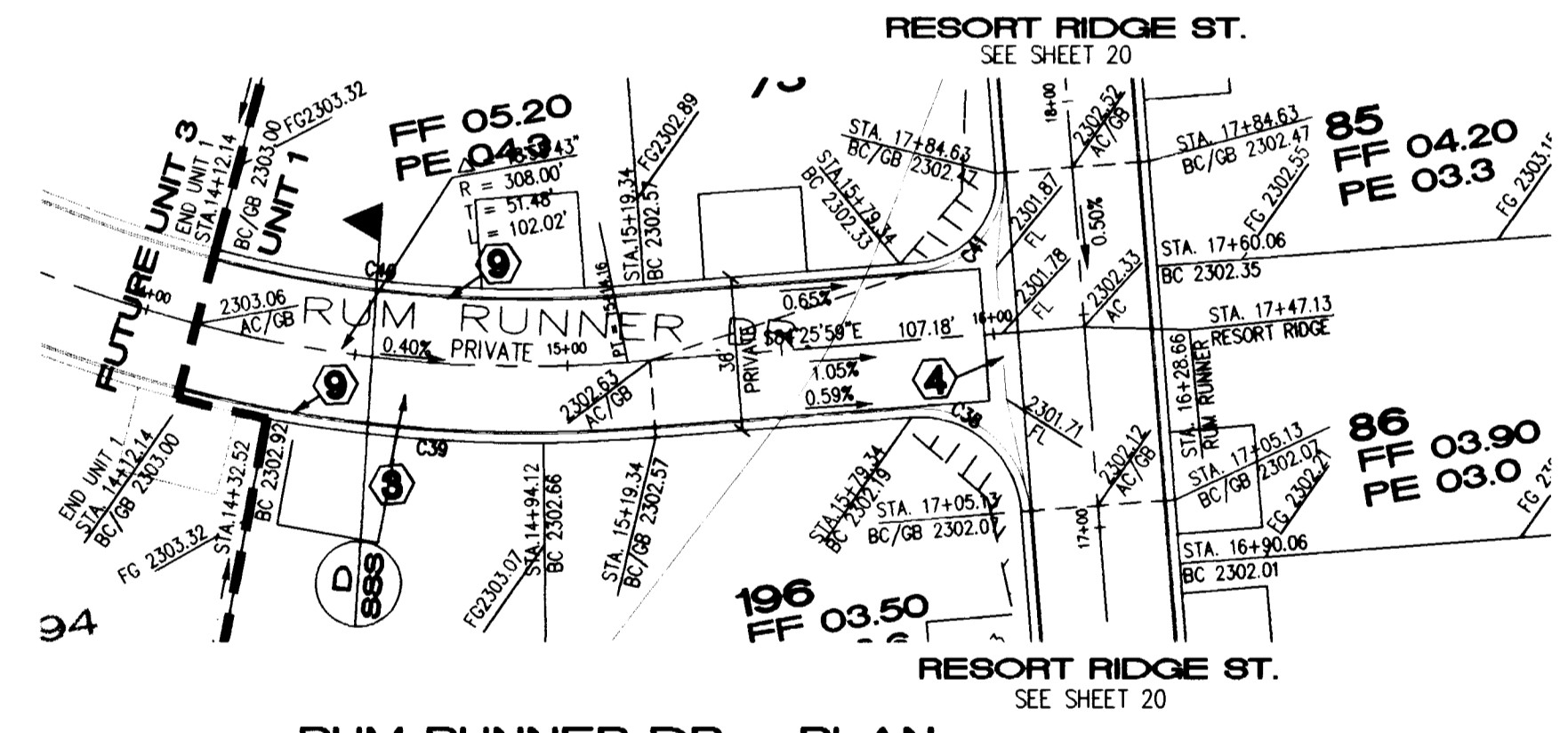

RUM RUNNER DR. - PLAN
HORIZONTAL SCALE: 1"=40'
(PRIVATE TO BE MAINTAINED BY HOMEOWNERS ASSOCIATION)

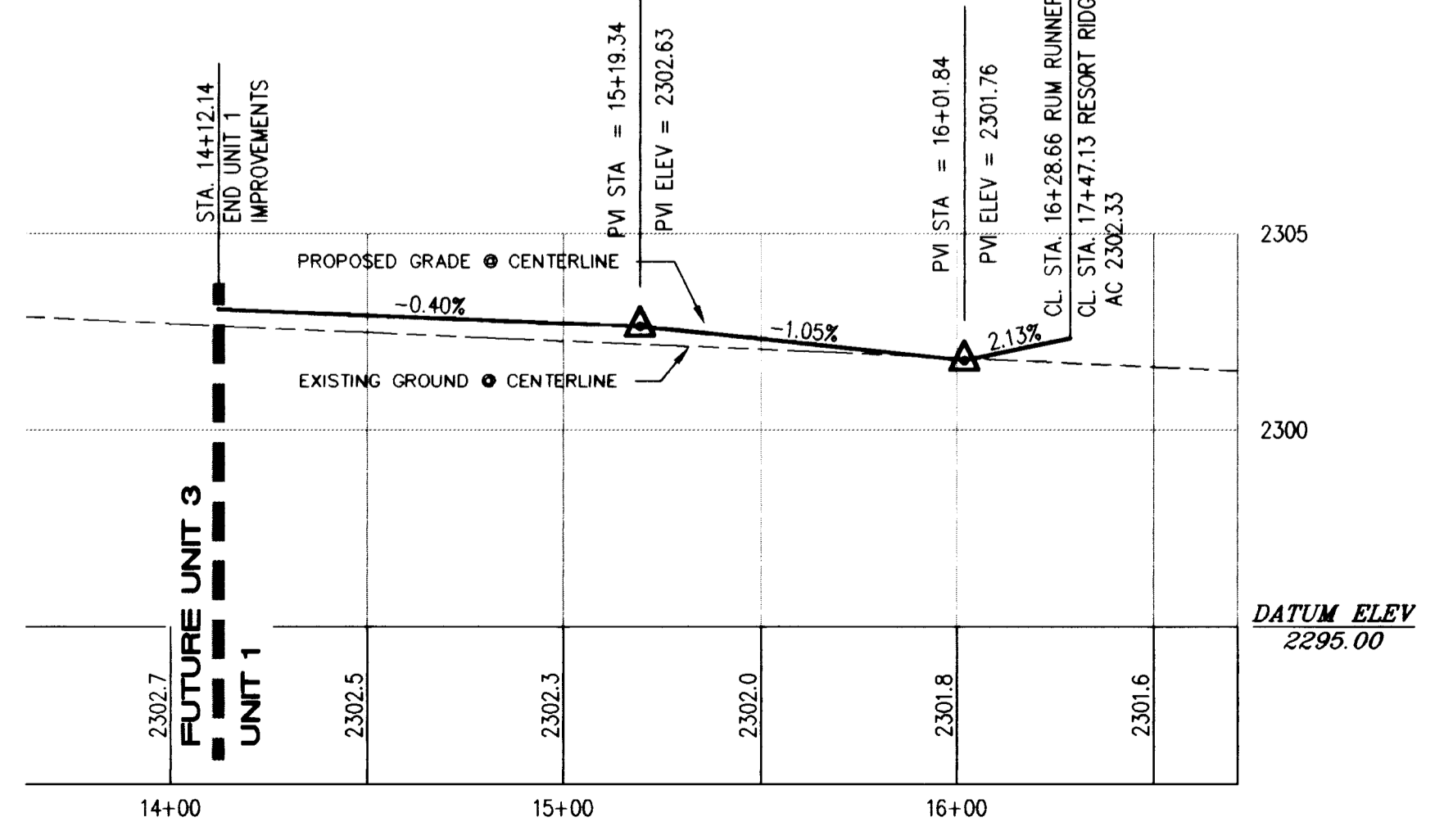

RUM RUNNER DR. - PROFILE
HORIZONTAL SCALE: 1"=40'
VERTICAL SCALE: 1"=4'

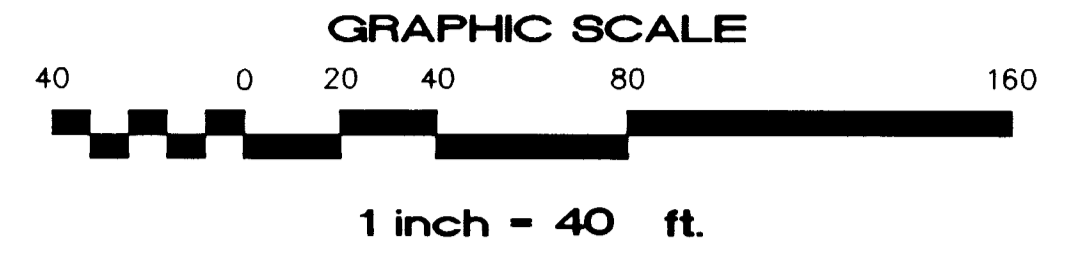

CONSTRUCTION KEY
STREET IMPROVEMENTS

- ① NOT USED
- ② NOT USED
- ③ 36' (PRIVATE) = CONSTRUCT 2" AC PAVING OVER 4" TYPE II BASE ON 6" TYPE I BASE PER U.S.D.C.C.A. STANDARD DWG. NO. 210.
- ④ CONSTRUCT 8' WIDE CROSS GUTTER PER U.S.D.C.C.A. STANDARD DRAWING NO. 228
- ⑤ CONSTRUCT SIDEWALK RAMP PER U.S.D.C.C.A. STANDARD DWG. NO. 235 A=8.0, B=8.0 UNLESS OTHERWISE NOTED ON PLANS.
- ⑥ CONSTRUCT "L" CURB PER U.S.D.C.C.A. STANDARD DWG. NO. 216
- ⑦ CONSTRUCT 5' WIDE CONCRETE SIDEWALK PER U.S.D.C.C.A. STANDARD DRAWING NO. 234
- ⑧ CONSTRUCT WEDGE CURB PER DETAIL 6 ON SHEET DT1

CONSTRUCTION NOTES

1. HUNSAKER & ASSOCIATES SHALL BE NOTIFIED IMMEDIATELY OF ANY DISCREPANCIES IN THE PLANS OR CONDITIONS IN THE FIELD.
2. PRIOR TO CONSTRUCTION CONTRACTOR SHALL BE RESPONSIBLE FOR VERIFYING ALL EXISTING UTILITY LOCATION AND ELEVATIONS AND SHALL CONTACT ENGINEER IF ANY DISCREPANCIES ARE FOUND.

BASIS OF BEARING

BEING THE CENTER LINE OF AZURE DRIVE BETWEEN BRADLEY ROAD AND LEON AVENUE, AS SHOWN ON THE RECORD OF SURVEY IN FILE 52 OF SURVEYS PAGE 70 WHICH BEARS NORTH 88°46'05" EAST.

BENCHMARK

CITY OF LAS VEGAS BENCHMARK NO. 1L90, 25N4 CAP ON REBAR, PLS 6201, CENTENNIAL PKWY. AND BRADLEY ROAD.
ELEVATION = 701.8865 METERS (NAVD 88)
2302.77 FEET (NGVD 88)

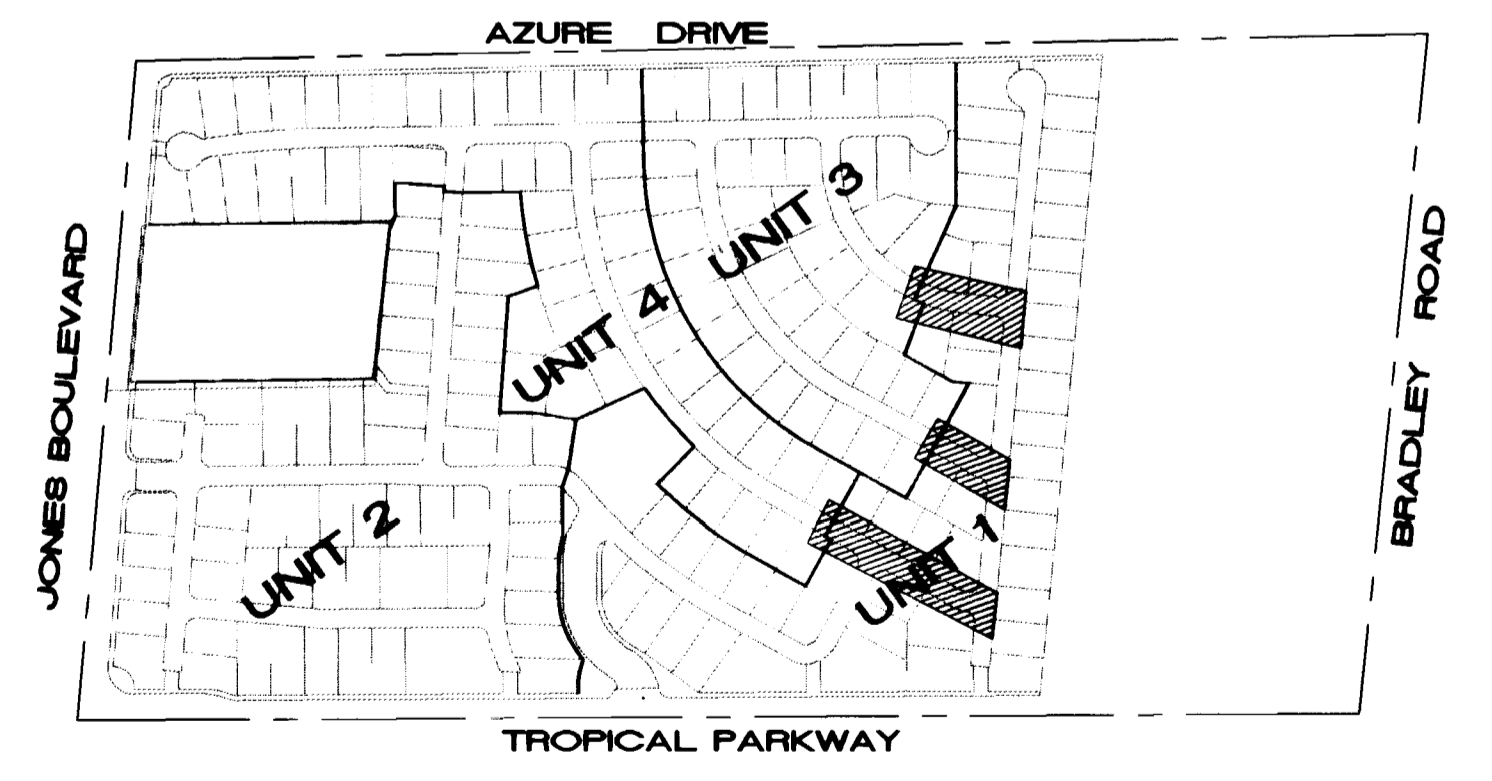

KEY MAP
NTS

Avoid overhead power line contact
Call before you OVERHEAD
1-702-593-6111
NEVADA POWER ENVIRONMENT SAFETY SERVICES DEPARTMENT

Avoid cutting underground utility lines. It's costly
Call before you Dig
1-800-227-2600
UNDERGROUND SERVICE (USA)

D.R. HORIZON CUSTOM HOMES 2920 N. GREEN VALLEY PKWY. SUITE 111 HENDERSON, NV. 89014 (702)435-4888, FAX (702)435-4950		HUNSAKER & ASSOCIATES PLANNING SURVEYING & ENGINEERING 401 N. BUFFALO DR. SUITE 100, LAS VEGAS, NEVADA 89108 (702) 242-4500	
SHEET: COCKTAIL DR., PORT OF DREAMS DR., RUM RUNNER DR. STREET PLAN AND PROFILE		TITLE: TROPICAL/JONES - UNIT 1 A.K.A. PARADISE FALLS UNIT 1 CITY OF LAS VEGAS, NEVADA	
QUALITY CONTROL BY: P. DIARRAH	DESIGNED BY: A. SALCIDO	CHECKED BY: A. SALCIDO	PROJECT NO: 2291-1
SCALE: 1"=40'	SCALE: 1"=40'	SCALE: 1"=40'	SCALE: 1"=40'
DRAWN BY: P. DIARRAH		DESIGNED BY: A. SALCIDO	
CHECKED BY: A. SALCIDO		PROJECT NO: 2291-1	
SEAL: PROFESSIONAL ENGINEER STATE OF NEVADA LABRY W. BESS 1115 KOWAN BLVD. LAS VEGAS, NV 89102		SEAL: PROFESSIONAL ENGINEER STATE OF NEVADA LABRY W. BESS 1115 KOWAN BLVD. LAS VEGAS, NV 89102	
SHEET: PP5		SHEET: 18 OF 31	
DRAWING NO: 107Y4592-1		DRAWING NO: 107Y4592-1	

