

IMPROVEMENTS PER JONES BOULEVARD S.I.D. #1471 (ULTIMATE BUILDOUT)

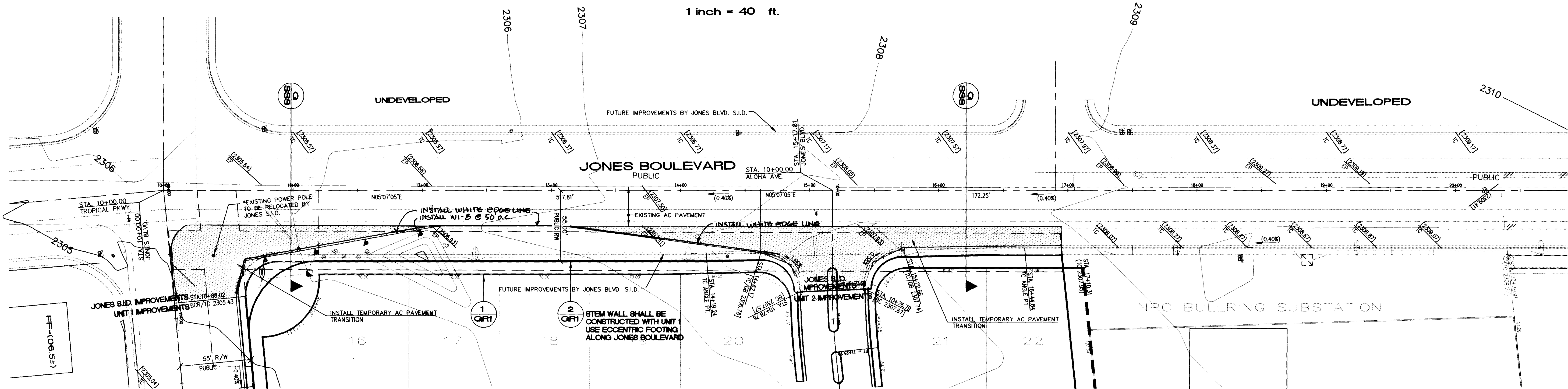
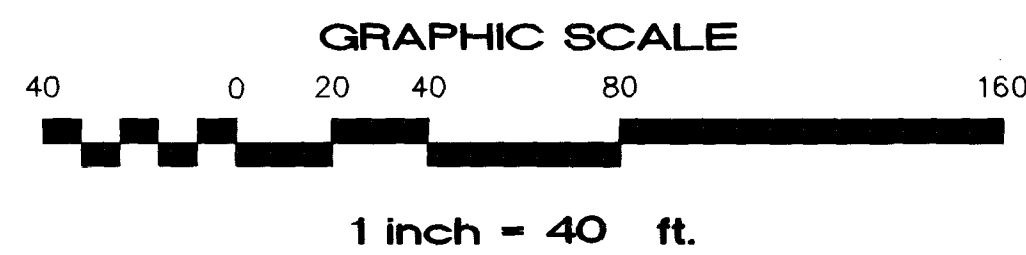

PROPOSED IMPROVEMENTS BY THIS DEVELOPMENT (INTERIM IMPROVEMENTS)

**BASIS OF BEARING**  
 BEING THE CENTER LINE OF AZURE DRIVE BETWEEN BRADLEY ROAD AND LEON AVENUE, AS SHOWN ON THE RECORD OF SURVEY IN FILE 52 OF SURVEYS PAGE 70 WHICH BEARS NORTH 88°46'05" EAST.

**BENCHMARK**  
 CITY OF LAS VEGAS BENCHMARK NO. 1LV90, 25N4  
 CAP ON REBAR, PLS 6201, CENTENNIAL PKWY. AND BRADLEY ROAD.  
 ELEVATION = 701.8865 METERS (NAVD 88)  
 2302.77 FEET (NAVD 88)

- CONSTRUCTION NOTES**
- HUNSAKER & ASSOCIATES SHALL BE NOTIFIED IMMEDIATELY OF ANY DISCREPANCIES IN THE PLANS OR CONDITIONS IN THE FIELD.
  - PRIOR TO CONSTRUCTION CONTRACTOR SHALL BE RESPONSIBLE FOR VERIFYING ALL EXISTING UTILITY LOCATION AND ELEVATIONS AND SHALL CONTACT ENGINEER IF ANY DISCREPANCIES ARE FOUND.
- IN THE EVENT S.I.D. PROJECT IS DELAYED, D.R. HORTON WILL BE REQUIRED TO CONTACT UTILITY COMPANY TO HAVE POLE RELOCATED TO PERMIT PAVEMENT TRANSITION TO JONES BE UTILIZED.

Avoid overhead power line contact  
**Call before you OVERHEAD**  
 1-702-593-6111  
 NEVADA POWER ENVIRONMENT SAFETY SERVICES DEPARTMENT

Avoid cutting underground utility lines. It's costly  
**Call before you Dig**  
 1-800-227-2600  
 UNDERGROUND SERVICE (USA)

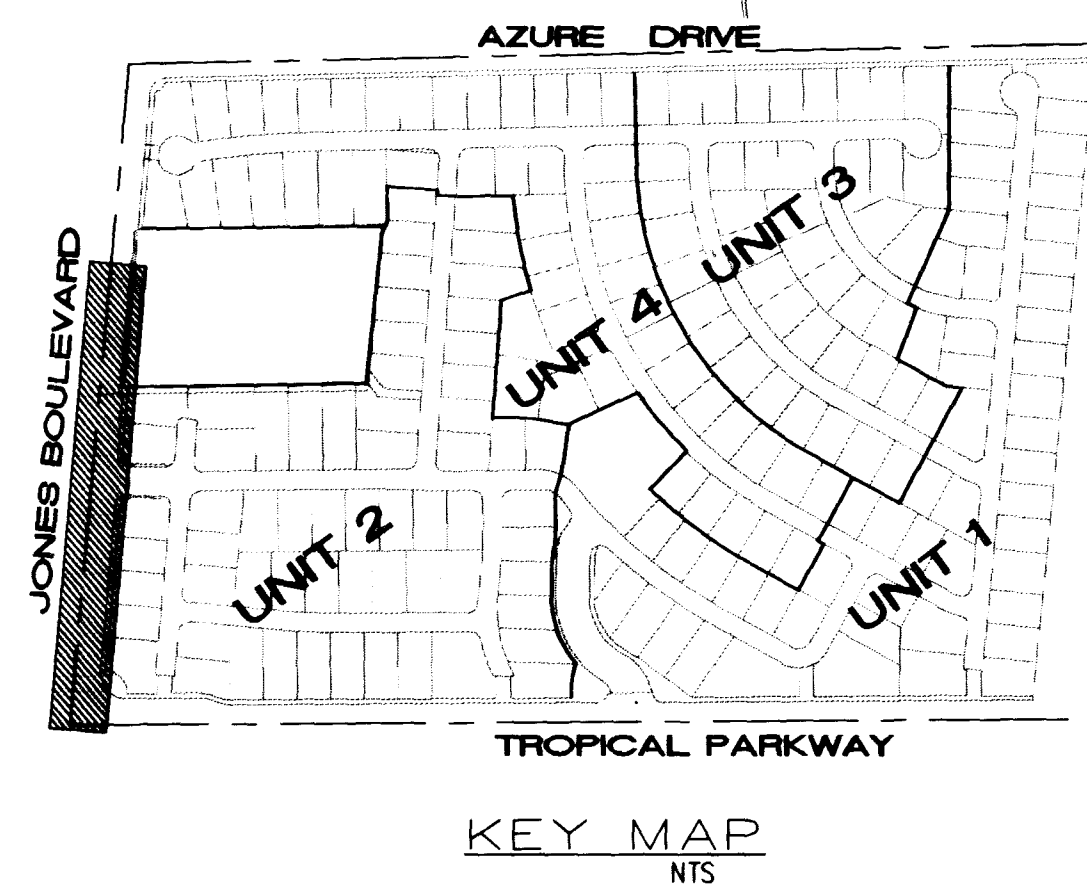

<b>D. R. HORTON</b> CUSTOM HOMES 2820 N. GREEN VALLEY PKWY. SUITE 111 HENDERSON, NV. 89014 (702)495-4888, FAX (702)435-4950	
<b>HUNSAKER &amp; ASSOCIATES</b> PLANNING & SURVEYING 401 N. Buffalo Dr. Suite 100, Las Vegas, Nevada 89128 (702) 242-4500	
<b>JONES BOULEVARD STREET PLAN AND PROFILE</b> <b>TROPICAL JONES UNIT 1 AKA PARADISE FALLS - UNIT 1</b> CITY OF LAS VEGAS, NEVADA	
SHEET QUALITY CONTROL BY: DRAWN BY: P. DARRIGH DESIGNED BY: P. DARRIGH CHECKED BY: A. SALUDO PROJECT NO. 2291-1	TITLE SCALE: 1" = 40' 1" = 4'
SEAL 	
SHEET <b>PP1</b> 14 OF 31 DRAWING NO. 107Y4592-1	

