

RAMP TRANSITION LENGTHS

RAMP NO.	GRADE %	"A" (FT) MIN.	"B" (FT) MIN.	CASE
5	-2 TO 2	8.0'	8.0'	1

CENTERLINE CURVE DATA

NO.	DELTA/BRG	RADIUS	LENGTH	TANGENT
1	Δ= 04°47'42"	1000.00'	83.69'	41.87'
2	Δ= 04°47'42"	1000.00'	83.69'	41.87'
3	Δ= 04°47'42"	1000.00'	83.69'	41.87'
4	Δ= 04°47'42"	1000.00'	83.69'	41.87'

CURB DATA

NO.	DELTA/BRG	RADIUS	LENGTH	TANGENT
1	N00°31'43"E	--	70.81'	--
2	N00°31'43"E	--	37.94'	--
3	N00°31'43"E	--	45.00'	--
4	Δ= 95°22'52"	20.00'	33.29'	21.97'
5	N00°31'43"E	--	45.00'	--
6	Δ= 84°40'44"	20.00'	29.56'	18.22'
7	N00°31'43"E	--	14.59'	--
8	Δ= 01°41'57"	1020.50'	30.26'	15.13'
9	Δ= 04°44'06"	979.50'	80.95'	40.50'
10	Δ= 02°31'04"	1020.50'	44.84'	22.43'
11	Δ= 00°34'41"	1020.50'	10.30'	5.15'
12	Δ= 02°02'38"	979.50'	34.94'	17.47'
13	Δ= 00°26'46"	1020.50'	7.95'	3.97'
14	Δ= 04°20'56"	1020.50'	77.46'	38.75'
15	Δ= 02°38'49"	979.50'	45.25'	22.63'
16	N00°31'43"E	--	4.92'	--
17	Δ= 95°22'52"	20.00'	33.29'	21.97'
18	Δ= 00°06'16"	979.50'	1.79'	0.89'

CURB DATA

NO.	DELTA/BRG	RADIUS	LENGTH	TANGENT
19	N00°31'43"E	--	43.22'	--
20	N00°31'43"E	--	45.00'	--
21	Δ= 84°37'08"	20.00'	29.54'	18.20'
22	N00°31'43"E	--	4.73'	--
23	Δ= 04°33'02"	1020.50'	81.05'	40.55'
24	Δ= 02°32'32"	979.50'	43.46'	21.73'
25	N00°31'43"E	--	1.78'	--
26	Δ= 02°15'11"	979.50'	38.52'	19.26'
27	Δ= 00°22'45"	1020.50'	6.75'	3.38'
28	Δ= 02°31'06"	1020.50'	44.85'	22.43'
29	Δ= 00°14'41"	1020.50'	4.36'	2.18'
30	Δ= 04°47'42"	979.50'	81.97'	41.01'
31	Δ= 01°53'52"	1020.50'	33.80'	16.90'
32	N00°31'43"E	--	11.04'	--
33	Δ= 95°22'52"	20.00'	33.29'	21.97'
34	N00°31'43"E	--	42.50'	--
35	N00°31'43"E	--	27.82'	--
36	Δ= 84°37'08"	20.00'	29.54'	18.20'

- CONSTRUCTION NOTES:**
- (X) INSTALL 4" MIN. A.C. #4" TYPE II AGGREGATE BASE & 9" TYPE I AGGREGATE BASE
 - (Y) INSTALL 3" MIN. A.C. #5" TYPE II AGGREGATE BASE & 6" TYPE I AGGREGATE BASE
 - (Z) INSTALL 2" MIN. A.C. #4" TYPE II AGGREGATE BASE & 6" TYPE I AGGREGATE BASE
 - (AA) INSTALL 24" "L" TYPE CURB & GUTTER #6" TYPE II AGGREGATE BASE
 - (AB) INSTALL 30" ROLL TYPE CURB & GUTTER #6" TYPE II AGGREGATE BASE
 - (AC) INSTALL 5" SIDEWALK 4" THICK #5" TYPE II AGGREGATE BASE
 - (AD) SAWCUT & REMOVE EXISTING A.C.
 - (AE) CONST. 8" CROSS GUTTER PER USD No. 228

BASIS OF BEARING
 NORTH 00°00'59" EAST, BEING THE CENTERLINE OF BRADLEY ROAD FROM ANN ROAD TO TROPICAL PARKWAY, CITY OF LAS VEGAS, CLARK COUNTY, NEVADA, AS SHOWN PER BOOK 77, PAGE 26 OF PLATS ON FILE IN THE OFFICE OF THE CLARK COUNTY RECORDER'S OFFICE.

BENCHMARK
 C.I.V. BENCHMARK NO. 38 (STATION 11V90 38M)
 RIVET & PLATE IN SOUTH TOP OF CURB
 ANN ROAD AT CURB ANGLE POINT,
 1530 FT. EAST OF CALVERTS STREET.
 ELEVATION = 696.2262 METERS (NAVDB88)
 ELEVATION = 2284.20 FEET

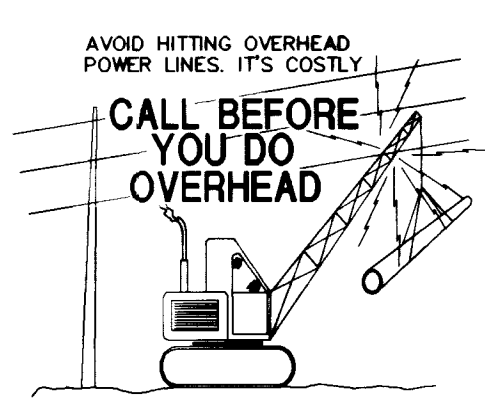

1-702-593-6111

AVOID CUTTING UNDERGROUND UTILITY LINES. IT'S COSTLY.
 Call before you Dig.
 1-800-227-2800
 UNDERGROUND SERVICE (USA)

WOOD PETAL ST.

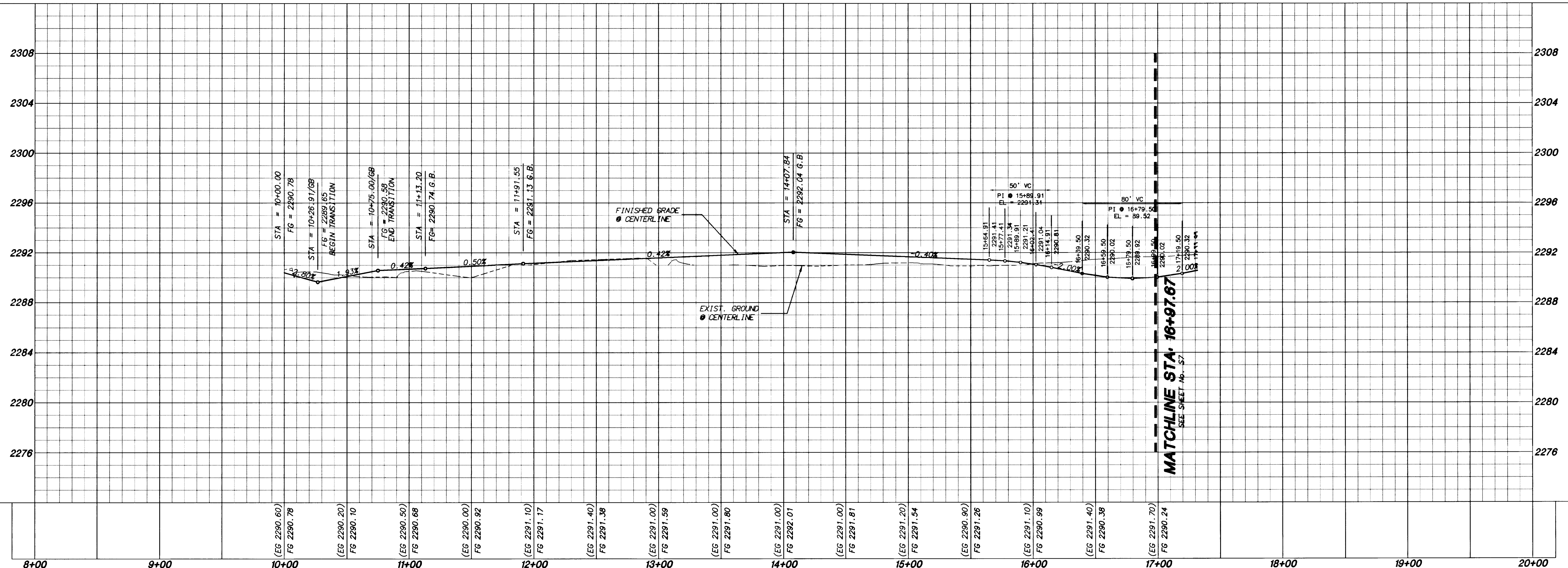

SIGNATURE HOMES
 801 S. RANCHO DRIVE # E-4
 (702) 368-5031 • FAX (702) 384-9296

Signature THE DREAM BUILDER
 Robert Bein, William Frost & Associates
 PROFESSIONAL ENGINEERS, PLANNERS & SURVEYORS
 2280 SOUTH WILKES BLVD, SUITE 100 LAS VEGAS, NV 89102
 (702) 368-0160 • FAX (702) 384-0188

WOOD PETAL STREET PLAN AND PROFILE
 STA. 10+00.00 TO 16+97.67

THE RIDGE II

DATE: 7/1/98
 DRAWN BY: C.W.W.
 DESIGNED BY: J.H.D.
 CHECKED BY: J.H.D.
 PROJECT NO: 75067
 SCALE: 1" = 40' HORIZ.
 1" = 4' VERT.

MARK W. JOHNSON
 CIVIL ENGINEER
 STATE OF NEVADA
 LICENSE NO. 10149

SHEET S6
 16 OF 39 SHEETS
 DRAWING NO. 1074-4606-2

