

CONSTRUCTION NOTES:

- (30) INSTALL 4" MIN. A.C. W/4" TYPE II AGGREGATE BASE & 9" TYPE I AGGREGATE BASE
- (31) INSTALL 3" MIN. A.C. W/5" TYPE II AGGREGATE BASE & 6" TYPE I AGGREGATE BASE
- (32) INSTALL 2" MIN. A.C. W/4" TYPE II AGGREGATE BASE & 6" TYPE I AGGREGATE BASE
- (33) INSTALL 24" "L" TYPE CURB & GUTTER W/6" TYPE II AGGREGATE BASE
- (34) INSTALL 30" ROLL TYPE CURB & GUTTER W/6" TYPE II AGGREGATE BASE
- (35) INSTALL 5" SIDEWALK 4" THICK W/5" TYPE II AGGREGATE BASE
- (36) SAWCUT & REMOVE EXISTING A.C.
- (37) CONST. 8" CROSS GUTTER PER USD No. 228



BASIS OF BEARING

NORTH 00°00'59" EAST, BEING THE CENTERLINE OF BRADLEY ROAD FROM ANN ROAD TO TROPICAL PARKWAY, CITY OF LAS VEGAS, CLARK COUNTY, NEVADA, AS SHOWN PER BOOK 77, PAGE 26 OF PLATS ON FILE IN THE OFFICE OF THE CLARK COUNTY RECORDER'S OFFICE.

BENCHMARK

C.L.V. BENCHMARK NO. 38 (STATION 1LV90 36M)
 RIVET & PLATE IN SOUTH TOP OF CURB
 ANN ROAD AT CURB ANGLE POINT,
 1530 FT. EAST OF CALVERTS STREET.
 ELEVATION = 696.2262 METERS (NAVDS88)
 ELEVATION = 2284.20 FEET

AVOID CUTTING UNDERGROUND UTILITY LINES. IT'S COSTLY.
 Call before you Dig.
 1-800-227-2600
 UNDERGROUND SERVICE (USA)

NO.	DELTA/BRG	RADIUS	LENGTH	TANGENT
1	Δ = 94°52'08"	25.00'	41.39'	27.22'
2	N85°08'51"E	--	50.13'	--
3	N85°08'51"E	--	55.00'	--
4	N85°08'51"E	--	45.00'	--
5	N85°08'51"E	--	50.00'	--
6	N85°08'51"E	--	45.00'	--
7	N85°08'51"E	--	50.00'	--
8	N85°08'51"E	--	45.00'	--
9	N85°08'51"E	--	50.00'	--
10	N85°08'51"E	--	45.00'	--
11	N85°08'51"E	--	30.07'	--
12	Δ = 84°37'08"	20.00'	29.54'	18.20'
13	Δ = 95°22'52"	20.00'	33.29'	21.97'
14	N85°08'51"E	--	83.49'	--

RAMP NO.	GRADE %	"A" (FT) MIN.	"B" (FT) MIN.	CASE
5	-2 TO 2	8.0'	8.0'	I
6	2.01 TO 3	9.5'	4.5'	I

EL CAMPO GRANDE (PUBLIC)

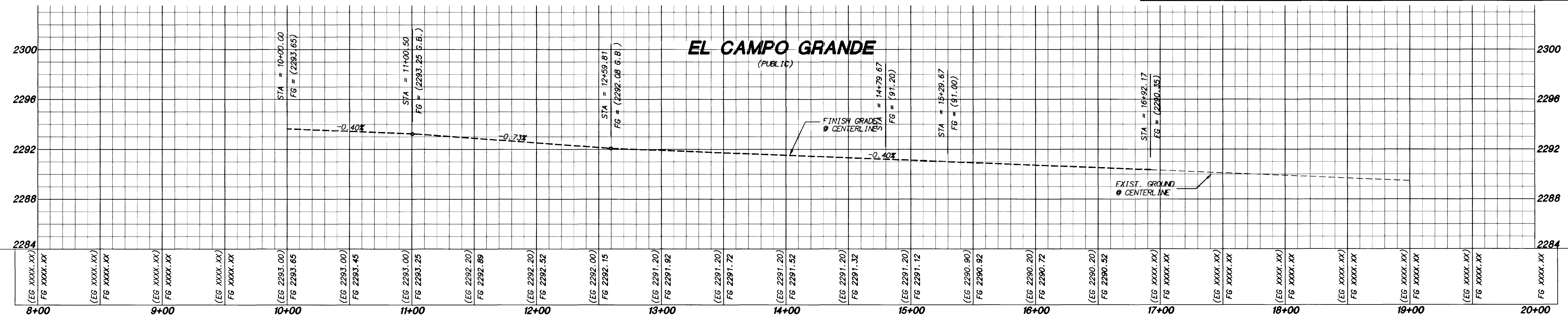

EL CAMPO GRANDE

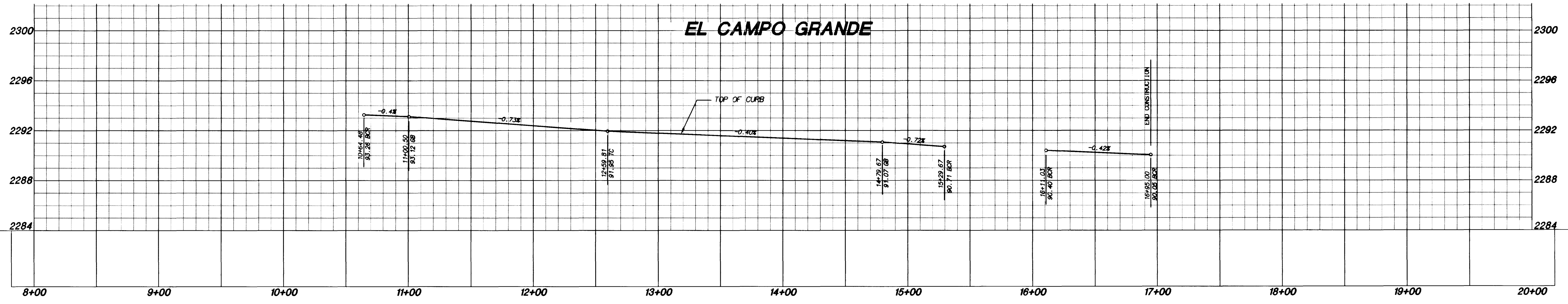

SIGNATURE HOMES
 801 S. RANCHO DRIVE # E-4
 (702) 385-5031 • FAX (702) 384-9286

Signature THE DREAM BUILDER

Robert Betz, William Frost & Associates
 PROFESSIONAL ENGINEERS, PLANNERS & SURVEYORS
 2280 SOUTH JONES BLVD, SUITE 100, LAS VEGAS, NV 89102
 (702) 364-0180 • FAX (702) 364-0189

EL CAMPO GRANDE PLAN AND PROFILE
 STA. 10+00.00 TO 16+92.17

THE RIDGE II

DRAWN BY: C.W.W. 7/1/98
 DESIGNED BY: 7/1/98
 CHECKED BY: J.H.D.
 PROJECT NO: 75067
 SCALE: 1" = 40' HORIZ.
 1" = 4' VERT.

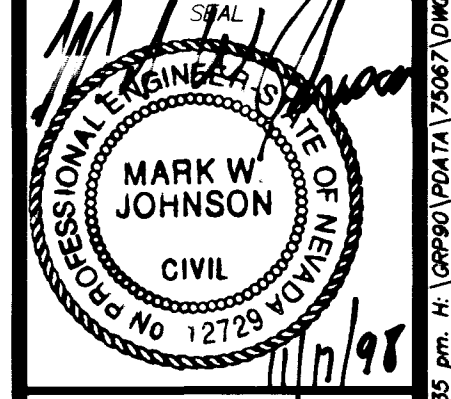

SHEET **S5**
 15 OF 39 SHEETS
 DRAWING NO. 1074-4606-2

