

CURB DATA				
NO.	DELTA/BRG	RADIUS	LENGTH	TANGENT
1	N84°37'34"E	--	30.51'	--
2	N84°37'34"E	--	48.00'	--
3	N84°37'34"E	--	45.00'	--
4	N84°37'34"E	--	45.00'	--
5	N84°37'34"E	--	45.00'	--
6	N84°37'34"E	--	45.00'	--
7	N84°37'34"E	--	45.00'	--
8	N84°37'34"E	--	45.00'	--
9	N84°37'34"E	--	45.00'	--
10	N84°37'34"E	--	45.00'	--
11	N84°37'34"E	--	45.00'	--
12	N84°37'34"E	--	96.76'	--
13	N84°37'34"E	--	61.67'	--

CONSTRUCTION NOTES:

- 1) INSTALL 4" MIN. A.C. 1/4" TYPE II AGGREGATE BASE & 9" TYPE I AGGREGATE BASE
- 2) INSTALL 3" MIN. A.C. 1/5" TYPE II AGGREGATE BASE & 6" TYPE I AGGREGATE BASE
- 3) INSTALL 2" MIN. A.C. 1/4" TYPE II AGGREGATE BASE & 6" TYPE I AGGREGATE BASE
- 4) INSTALL 24" "L" TYPE CURB & GUTTER 1/6" TYPE II AGGREGATE BASE
- 5) INSTALL 30" ROLL TYPE CURB & GUTTER 1/6" TYPE II AGGREGATE BASE
- 6) INSTALL 5" SIDEWALK 4" THICK 1/5" TYPE II AGGREGATE BASE
- 7) SAWCUT & REMOVE EXISTING A.C.

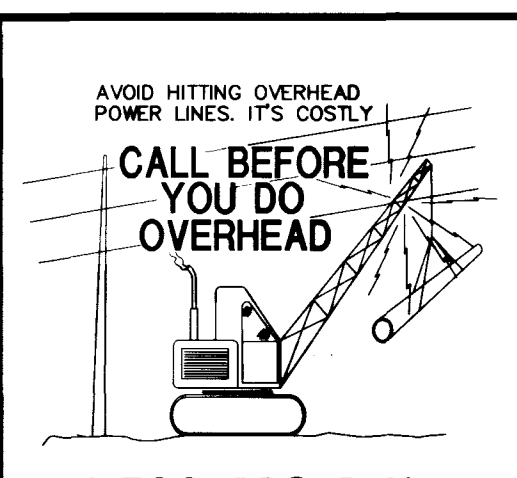

BASIS OF BEARING
 NORTH 00°00'59" EAST, BEING THE CENTERLINE OF BRADLEY ROAD FROM ANN ROAD TO TROPICAL PARKWAY, CITY OF LAS VEGAS, CLARK COUNTY, NEVADA, AS SHOWN PER BOOK 77, PAGE 28 OF PLATS ON FILE IN THE OFFICE OF THE CLARK COUNTY RECORDER'S OFFICE.

BENCHMARK
 C.L.V. BENCHMARK NO. 38 (STATION 11V90 38M)
 RIVET & PLATE IN SOUTH TOP OF CURB
 ANN ROAD AT CURB ANGLE POINT,
 1530 FT. EAST OF CALVERT'S STREET.
 ELEVATION = 696.2262 METERS (NAV088)
 ELEVATION = 2284.20 FEET

AVOID HITTING OVERHEAD POWER LINES. IT'S COSTLY

Call before you Dig.
 1-800-227-2800
 UNDERGROUND SERVICE (USA)

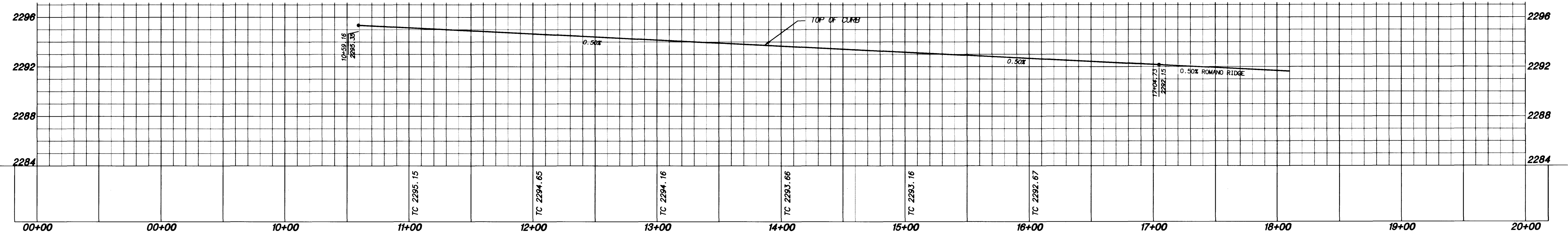
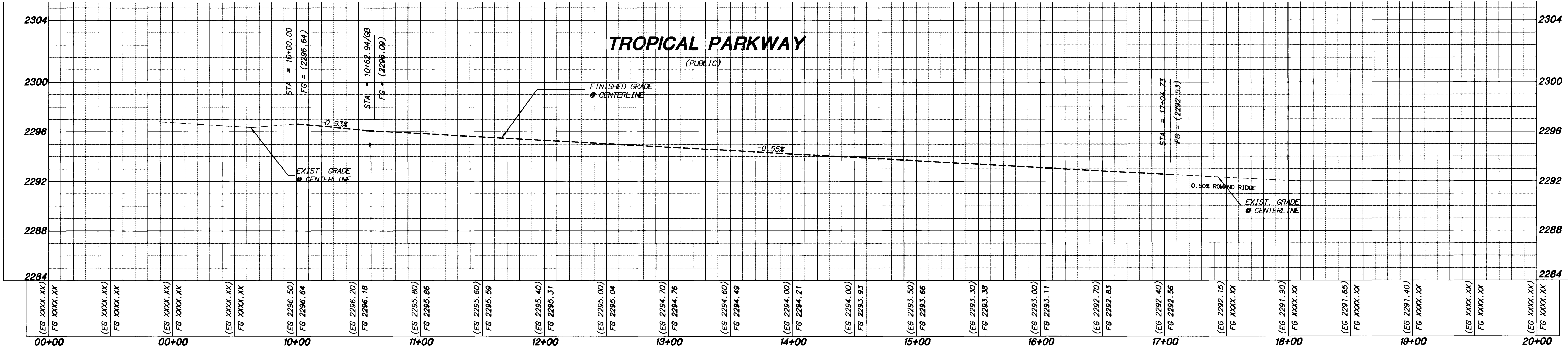

SIGNATURE HOMES
 801 S. RANCHO DRIVE # E-4
 (702) 385-5031 • FAX (702) 384-9296

Signature
 THE DREAM BUILDER

Robert Beirn, William Frost & Associates
 PROFESSIONAL ENGINEERS, PLANNERS & SURVEYORS
 2280 SOUTH JONES BLVD, SUITE 100, LAS VEGAS, NV 89102
 (702) 364-0180 • FAX (702) 364-0189

SHEET
TROPICAL PARKWAY
 PLAN AND PROFILE
 STA. 10+00.00 TO 17+04.73

TITLE
THE RIDGE II

DRAWN BY: C.M.W. 01/05/98
 DESIGNED BY: J.H.D. 7/1/98
 CHECKED BY: J.H.D.
 PROJECT NO: 75067
 SCALE: 1" = 40' HORZ.
 1" = 4' VERT.

SEAL
MARK W. JOHNSON
 CIVIL
 LICENSE NO. 12729

SHEET
S1
 11 OF 39 SHEETS
 DRAWING NO.
 1074-4606-2

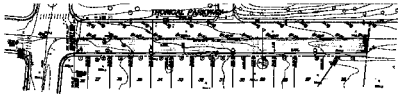

LEGEND

SYMBOL	DESCRIPTION
1	1.00' TO 1.99'
2	2.00' TO 2.99'
3	3.00' TO 3.99'
4	4.00' TO 4.99'
5	5.00' TO 5.99'
6	6.00' TO 6.99'
7	7.00' TO 7.99'
8	8.00' TO 8.99'
9	9.00' TO 9.99'
10	10.00' TO 10.99'
11	11.00' TO 11.99'
12	12.00' TO 12.99'
13	13.00' TO 13.99'
14	14.00' TO 14.99'
15	15.00' TO 15.99'
16	16.00' TO 16.99'
17	17.00' TO 17.99'
18	18.00' TO 18.99'
19	19.00' TO 19.99'
20	20.00' TO 20.99'
21	21.00' TO 21.99'
22	22.00' TO 22.99'
23	23.00' TO 23.99'
24	24.00' TO 24.99'
25	25.00' TO 25.99'
26	26.00' TO 26.99'
27	27.00' TO 27.99'
28	28.00' TO 28.99'
29	29.00' TO 29.99'
30	30.00' TO 30.99'
31	31.00' TO 31.99'
32	32.00' TO 32.99'
33	33.00' TO 33.99'
34	34.00' TO 34.99'
35	35.00' TO 35.99'
36	36.00' TO 36.99'
37	37.00' TO 37.99'
38	38.00' TO 38.99'
39	39.00' TO 39.99'
40	40.00' TO 40.99'
41	41.00' TO 41.99'
42	42.00' TO 42.99'
43	43.00' TO 43.99'
44	44.00' TO 44.99'
45	45.00' TO 45.99'
46	46.00' TO 46.99'
47	47.00' TO 47.99'
48	48.00' TO 48.99'
49	49.00' TO 49.99'
50	50.00' TO 50.99'
51	51.00' TO 51.99'
52	52.00' TO 52.99'
53	53.00' TO 53.99'
54	54.00' TO 54.99'
55	55.00' TO 55.99'
56	56.00' TO 56.99'
57	57.00' TO 57.99'
58	58.00' TO 58.99'
59	59.00' TO 59.99'
60	60.00' TO 60.99'
61	61.00' TO 61.99'
62	62.00' TO 62.99'
63	63.00' TO 63.99'
64	64.00' TO 64.99'
65	65.00' TO 65.99'
66	66.00' TO 66.99'
67	67.00' TO 67.99'
68	68.00' TO 68.99'
69	69.00' TO 69.99'
70	70.00' TO 70.99'
71	71.00' TO 71.99'
72	72.00' TO 72.99'
73	73.00' TO 73.99'
74	74.00' TO 74.99'
75	75.00' TO 75.99'
76	76.00' TO 76.99'
77	77.00' TO 77.99'
78	78.00' TO 78.99'
79	79.00' TO 79.99'
80	80.00' TO 80.99'
81	81.00' TO 81.99'
82	82.00' TO 82.99'
83	83.00' TO 83.99'
84	84.00' TO 84.99'
85	85.00' TO 85.99'
86	86.00' TO 86.99'
87	87.00' TO 87.99'
88	88.00' TO 88.99'
89	89.00' TO 89.99'
90	90.00' TO 90.99'
91	91.00' TO 91.99'
92	92.00' TO 92.99'
93	93.00' TO 93.99'
94	94.00' TO 94.99'
95	95.00' TO 95.99'
96	96.00' TO 96.99'
97	97.00' TO 97.99'
98	98.00' TO 98.99'
99	99.00' TO 99.99'
100	100.00' TO 100.99'

CONSTRUCTION NOTES:

1. ALL CONSTRUCTION SHALL BE IN ACCORDANCE WITH THE LATEST EDITIONS OF THE AASHTO AND STATE SPECIFICATIONS FOR HIGHWAY CONSTRUCTION.
2. ALL MATERIALS SHALL BE TESTED AND APPROVED BY THE ENGINEER BEFORE USE.
3. ALL DIMENSIONS SHALL BE AS SHOWN UNLESS OTHERWISE NOTED.
4. ALL UTILITIES SHALL BE DEPTH TESTED AND MARKED BEFORE CONSTRUCTION.
5. ALL EROSION CONTROL MEASURES SHALL BE INSTALLED AND MAINTAINED THROUGHOUT CONSTRUCTION.



1-700-000-000

STATE OF FLORIDA
 DEPARTMENT OF TRANSPORTATION
 DIVISION OF HIGHWAYS
 TROPICAL PARKWAY INTERCHANGE
 PROJECT NO. 1-700-000-000
 SHEET NO. 1-700-000-000-1

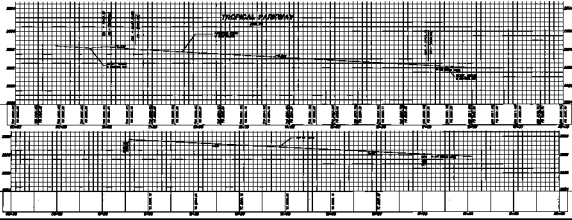

TROPICAL PARKWAY INTERCHANGE
 PLAN AND PROFILE
 WITH APPROVAL TO PROCEED

THE ENGINEER

DATE: _____
 DRAWN BY: _____
 CHECKED BY: _____
 APPROVED BY: _____

1-700-000-000-1