

CURB DATA				
NO.	DELTA/BRG	RADIUS	LENGTH	TANGENT
1	N85°08'51"E	--	21.16'	--
2	N85°08'51"E	--	45.00'	--
3	N85°08'51"E	--	45.00'	--
4	N85°08'51"E	--	45.00'	--
5	N85°08'51"E	--	45.00'	--
6	N85°08'51"E	--	45.00'	--
7	N85°08'51"E	--	45.00'	--
8	N85°08'51"E	--	45.00'	--
9	N85°08'51"E	--	2.53'	--
10	Δ= 48°36'43"	20.00'	16.97'	9.03'
11	Δ= 48°42'59"	40.50'	34.44'	18.34'
12	Δ= 89°53'44"	40.50'	63.54'	40.43'
13	Δ= 56°00'25"	40.50'	39.59'	21.54'

CURB DATA				
NO.	DELTA/BRG	RADIUS	LENGTH	TANGENT
14	Δ= 70°43'28"	40.50'	49.99'	28.74'
15	Δ= 11°52'50"	40.50'	8.40'	4.21'
16	Δ= 48°36'43"	20.00'	16.97'	9.03'
17	N85°08'51"E	--	26.22'	--
18	N85°08'51"E	--	45.00'	--
19	N85°08'51"E	--	45.00'	--
20	N85°08'51"E	--	45.00'	--
21	N85°08'51"E	--	45.00'	--
22	N85°08'51"E	--	45.00'	--
23	N85°08'51"E	--	45.00'	--
24	N85°08'51"E	--	45.00'	--
25	N85°08'51"E	--	24.87'	--

**CONSTRUCTION NOTES:**

- 30) INSTALL 4" MIN. A.C. 1/4" TYPE 11 AGGREGATE BASE & 9" TYPE 1 AGGREGATE BASE
- 31) INSTALL 3" MIN. A.C. 1/5" TYPE 11 AGGREGATE BASE & 6" TYPE 1 AGGREGATE BASE
- 32) INSTALL 2" MIN. A.C. 1/4" TYPE 11 AGGREGATE BASE & 6" TYPE 1 AGGREGATE BASE
- 33) INSTALL 24" "L" TYPE CURB & GUTTER W/6" TYPE 11 AGGREGATE BASE
- 34) INSTALL 30" "L" TYPE CURB & GUTTER W/6" TYPE 11 AGGREGATE BASE
- 35) INSTALL 4" SIDEWALK 4" THICK 1/5" TYPE 11 AGGREGATE BASE
- 36) SAWCUT & REMOVE EXISTING A.C.

**BASIS OF BEARING**  
 NORTH 00°00'59" EAST, BEING THE CENTERLINE OF BRADLEY ROAD FROM ANN ROAD TO TROPICAL PARKWAY, CITY OF LAS VEGAS, CLARK COUNTY, NEVADA, AS SHOWN PER BOOK 77, PAGE 26 OF PLATS ON FILE IN THE OFFICE OF THE CLARK COUNTY RECORDER'S OFFICE.

**BENCHMARK**  
 C.L.V. BENCHMARK NO. 38 (STATION 11V90.36M)  
 RIVET & PLATE IN SOUTH TOP OF CURB  
 ANN ROAD AT CURB ANGLE POINT  
 1530 FT. EAST OF CALVERTS STREET.  
 ELEVATION = 696.2262 METERS (NAVD88)  
 ELEVATION = 2284.20 FEET

AVOID HITTING OVERHEAD POWER LINES. IT'S COSTLY

**CALL BEFORE YOU DO OVERHEAD**

1-702-593-6111

AVOID CUTTING UNDERGROUND UTILITY LINES. IT'S COSTLY

**Call before you Dig**

1-800-227-2800  
 UNDERGROUND SERVICE (USA)

**BIG FAWN COURT**

**BIG FAWN COURT CULDESAC**

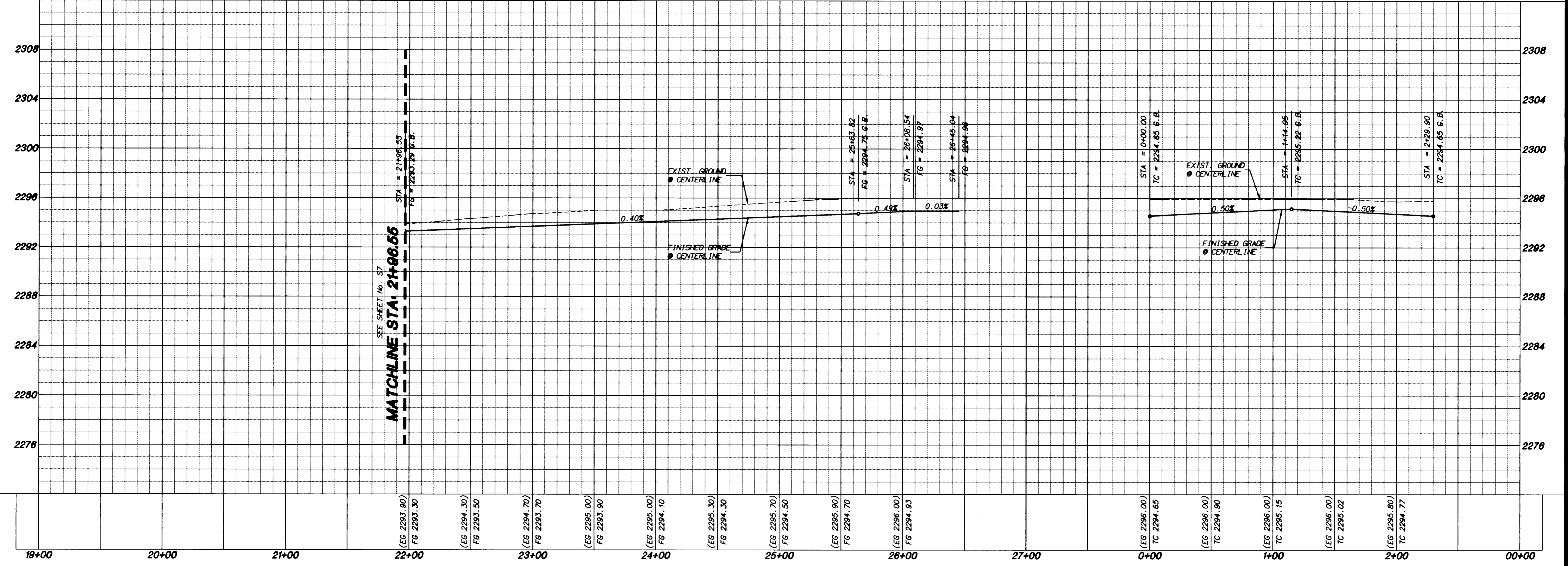

REVISIONS

1-14-99	MJ				
---------	----	--	--	--	--

SIGNATURE HOMES  
 801 S. RANCHO DRIVE # E-4  
 (702) 385-5031 • FAX (702) 384-9296

**Signature**  
 THE DREAM BUILDER™

Robert Bein, William Frost & Associates  
 PROFESSIONAL ENGINEERS, PLANNERS & SURVEYORS  
 2280 SOUTH JONES BLVD., SUITE 100, LAS VEGAS, NV 89102  
 (702) 364-0180 • FAX (702) 364-0189

**Signature**  
 THE DREAM BUILDER™

MARK W. JOHNSON  
 CIVIL  
 LICENSE NO. 12728

SHEET 11  
 21 of 39 SHEETS  
 DRAWING NO. 1074-4606-2

H:\GPP90\PD01A\75067.DWG 06/15/11.dwg Tue Nov 17 09:35:19 1998 By: BCF



STATION	AREA	PERCENT	PERCENT
1+00	100	100	100
2+00	100	100	100
3+00	100	100	100
4+00	100	100	100
5+00	100	100	100
6+00	100	100	100
7+00	100	100	100
8+00	100	100	100
9+00	100	100	100
10+00	100	100	100
11+00	100	100	100
12+00	100	100	100
13+00	100	100	100
14+00	100	100	100
15+00	100	100	100
16+00	100	100	100
17+00	100	100	100
18+00	100	100	100
19+00	100	100	100
20+00	100	100	100
21+00	100	100	100
22+00	100	100	100
23+00	100	100	100
24+00	100	100	100
25+00	100	100	100
26+00	100	100	100
27+00	100	100	100
28+00	100	100	100
29+00	100	100	100
30+00	100	100	100
31+00	100	100	100
32+00	100	100	100
33+00	100	100	100
34+00	100	100	100
35+00	100	100	100
36+00	100	100	100
37+00	100	100	100
38+00	100	100	100
39+00	100	100	100
40+00	100	100	100
41+00	100	100	100
42+00	100	100	100
43+00	100	100	100
44+00	100	100	100
45+00	100	100	100
46+00	100	100	100
47+00	100	100	100
48+00	100	100	100
49+00	100	100	100
50+00	100	100	100

STATION	AREA	PERCENT	PERCENT
1+00	100	100	100
2+00	100	100	100
3+00	100	100	100
4+00	100	100	100
5+00	100	100	100
6+00	100	100	100
7+00	100	100	100
8+00	100	100	100
9+00	100	100	100
10+00	100	100	100
11+00	100	100	100
12+00	100	100	100
13+00	100	100	100
14+00	100	100	100
15+00	100	100	100
16+00	100	100	100
17+00	100	100	100
18+00	100	100	100
19+00	100	100	100
20+00	100	100	100
21+00	100	100	100
22+00	100	100	100
23+00	100	100	100
24+00	100	100	100
25+00	100	100	100
26+00	100	100	100
27+00	100	100	100
28+00	100	100	100
29+00	100	100	100
30+00	100	100	100
31+00	100	100	100
32+00	100	100	100
33+00	100	100	100
34+00	100	100	100
35+00	100	100	100
36+00	100	100	100
37+00	100	100	100
38+00	100	100	100
39+00	100	100	100
40+00	100	100	100
41+00	100	100	100
42+00	100	100	100
43+00	100	100	100
44+00	100	100	100
45+00	100	100	100
46+00	100	100	100
47+00	100	100	100
48+00	100	100	100
49+00	100	100	100
50+00	100	100	100

**CONSTRUCTION NOTES**

1. ALL WORK SHALL BE IN ACCORDANCE WITH THE LATEST EDITIONS OF THE U.S. STANDARD SPECIFICATIONS FOR HIGHWAY CONSTRUCTION, LATEST EDITIONS OF THE U.S. STANDARD SPECIFICATIONS FOR STRUCTURAL STEEL, AND THE U.S. STANDARD SPECIFICATIONS FOR PORTLAND CEMENT CONCRETE.

2. ALL WORK SHALL BE IN ACCORDANCE WITH THE LATEST EDITIONS OF THE U.S. STANDARD SPECIFICATIONS FOR HIGHWAY CONSTRUCTION, LATEST EDITIONS OF THE U.S. STANDARD SPECIFICATIONS FOR STRUCTURAL STEEL, AND THE U.S. STANDARD SPECIFICATIONS FOR PORTLAND CEMENT CONCRETE.

3. ALL WORK SHALL BE IN ACCORDANCE WITH THE LATEST EDITIONS OF THE U.S. STANDARD SPECIFICATIONS FOR HIGHWAY CONSTRUCTION, LATEST EDITIONS OF THE U.S. STANDARD SPECIFICATIONS FOR STRUCTURAL STEEL, AND THE U.S. STANDARD SPECIFICATIONS FOR PORTLAND CEMENT CONCRETE.

**BASE OF ROADWAY**  
**17'5" (7'0" SIDEWAYS)**

**REVISIONS**  
 1. ALL WORK SHALL BE IN ACCORDANCE WITH THE LATEST EDITIONS OF THE U.S. STANDARD SPECIFICATIONS FOR HIGHWAY CONSTRUCTION, LATEST EDITIONS OF THE U.S. STANDARD SPECIFICATIONS FOR STRUCTURAL STEEL, AND THE U.S. STANDARD SPECIFICATIONS FOR PORTLAND CEMENT CONCRETE.

**SCALE**  
 1" = 20'

**DATE**  
 11/11/00

**BY**  
 [Signature]

**CHECKED**  
 [Signature]

**APPROVED**  
 [Signature]

**BIG FAWN COURT**

**BIG FAWN COURT GILDERAG**

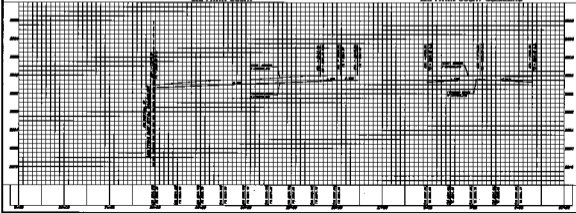

**PROJECT INFORMATION**

**PROJECT NAME:** BIG FAWN COURT GILDERAG

**CLIENT:** [Name]

**DATE:** 11/11/00

**SCALE:** 1" = 20'

**BY:** [Signature]

**CHECKED:** [Signature]

**APPROVED:** [Signature]

**PROJECT NO.:** [Number]

**DATE:** 11/11/00

**SCALE:** 1" = 20'

**BY:** [Signature]

**CHECKED:** [Signature]

**APPROVED:** [Signature]