

MATCH LINE

SEE SHEET C2.04

REVISIONS

- 7-23-98 ADDED HANDICAP ACCESSIBLE ROUTES PER CLV.
- 7-31-98 REVISED HANDICAP PARKING N/A
- 12-11-98 ADD SPEED HUMP N/A

GRAPHIC SCALE  
(IN FEET)  
1 inch = 30 ft.

PROFESSIONAL ENGINEER'S SEAL  
PAUL STEELMAN LTD  
ARCHITECTURE PLANNING  
3530 W. DESERT INN RD.  
LAS VEGAS, NEVADA 89102  
PHONE (702) 970-0221

2-11-98



PAUL STEELMAN LTD  
ARCHITECTURE PLANNING  
3530 W. DESERT INN RD.  
LAS VEGAS, NEVADA 89102  
PHONE (702) 970-0221

MARTIN & MARTIN  
CIVIL ENGINEERS  
1000 SOUTH KATE'S BLVD.  
SUITE 8  
LAS VEGAS, NEVADA 89102  
PHONE (702) 248-8000

THE RESORT AT SUMMERLIN  
HOTEL, CASINO & ENTERTAINMENT COMPLEX

DATE:	2-11-98
SCALE:	1" = 30'
JOB NO.:	1570
REVISION:	SEE COMMENTS 2-11-98
DESIGNED BY:	A. BULLION
CHECKED BY:	A. BULLION
DATE:	2-11-98

HORIZONTAL CONTROL

SHEET NUMBER  
**C2.03**  
SHEET 5 OF 32  
ISSUED FOR CONTRACT BULLETIN #8  
2-11-98  
107-12830

**BASIS OF BEARING**

NORTH 01°53'54" WEST, BEING THE CENTERLINE OF RAMPART BLVD. AS PER A MAP IN FILE 82, PAGE 64, OF PARCEL MAPS, CLARK COUNTY RECORDER'S OFFICE, CLARK COUNTY, NEVADA.

**BENCHMARK**  
OLV00 305EE6, BEING A RIVET AND PLATE, NEVADA POWER VAULT #UU-795, 9201, SUMMERLIN PARKWAY. ELEV: 828.1527 METERS NAVD88 (2717.03 FEET)

**CONSTRUCTION NOTES**

- INSTALL "L" TYPE CURB AND GUTTER PER SUMMERLIN STD. DWG. NO. S-47.
- INSTALL "A" TYPE CURB PER SUMMERLIN STD. DWG. NO. S-52.
- INSTALL 8" CROSS GUTTER PER SUMMERLIN STD. DWG. NO. S-64.
- INSTALL 2" A.C. PAVEMENT OVER 4" TYPE II AGG. BASE COURSE, AND 6" TYPE I AGG. SUBGRADE. (COMPACTED 95%).
- INSTALL 3" A.C. PAVEMENT OVER 4" TYPE II AGG. BASE COURSE AND 6" TYPE II AGG. SUBGRADE. (COMPACTED 95%).
- INSTALL 2' CONCRETE CHANNEL PER DETAIL (C5.01)
- INSTALL 10' WIDE GROUTED RIP RAP (RIVER ROCK, D<sub>50</sub> = 6") CHANNEL WITH DEPRESSED CURB ON EITHER END. SEE DETAIL (C5.01)
- INSTALL 3' CONCRETE VALLEY GUTTER PER DETAIL (C5.01)
- INSTALL 4" CONCRETE SIDEWALK PER SUMMERLIN STD. DWG. NO. S-72. (MIN. CROSS SLOPE=2%).
- INSTALL 20 LF OF DEPRESSED "L" TYPE CURB AND GUTTER PER SUMMERLIN STD. DWG. NO. S-47.
- INSTALL 4" A.C. PAVEMENT OVER 4" TYPE II AGG. BASE, OVER 9" TYPE I AGG. BASE PER SUMMERLIN STD. DWG. NO. S-5.
- INSTALL CASE I SIDEWALK RAMP PER SUMMERLIN DWG. NO. S-77. (A&B DIMENSIONS AS SHOWN). SEE DETAIL (C5.01)
- SAWCUT AND MATCH EXISTING A.C. PAVEMENT.
- INSTALL 5"x5" TYPE "A" CURB PER SUMMERLIN STD. DWG. NO. S-52 FOR TREE PLANTER.
- INSTALL SIDEWALK UNDERDRAIN PER CLARK COUNTY AREA STD. DWG. NO. 236.
- INSTALL SIDEWALK RAMP (MAXIMUM SLOPE=12:1).
- INSTALL 6" CONCRETE WITH 6"x6"-10/10 W.W.F. ON 6" TYPE II AGGREGATE BASE. (JOINT SPACING TO BE MAXIMUM 12").
- CONSTRUCT FIRE LANE WITH NETLON ADVANCED TURF PER DETAIL (C5.01)

**SIGNAGE AND STRIPING NOTES**

- INSTALL 4" WHITE PAINTED PARKING STALL LINES (TYPICAL PARKING STALL=9'x19')
- INSTALL 10' WIDE CROSSWALK USING 12" WHITE COLD POLYMER FILM.
- INSTALL 12" WHITE COLD POLYMER FILM STOP BAR.
- INSTALL COLD POLYMER FILM PAVEMENT MARKING.
- INSTALL R1-1 "STOP" SIGN (30"x30").
- INSTALL R3-7(R) SIGN (30"x30").
- INSTALL W4-2(R) SIGN (30"x30").
- INSTALL TYPE 4 LANE LINE PER CLARK COUNTY AREA STD. DWG. NO. 244A.
- INSTALL ADDED TURN LANE PER CLARK COUNTY AREA STD. DWG. NO. 246.
- INSTALL TYPE I CENTERLINE PER CLARK COUNTY AREA STD. DWG. NO. 244.
- INSTALL R4-7(R) SIGN (24"x30") AND R4-7P(R) (24"x18").
- INSTALL TYPE II CENTERLINE PER CLARK COUNTY AREA STD. DWG. NO. 244.
- INSTALL R6-1(R) SIGN (36"x12").
- INSTALL R3-2A(L) SIGN (24"x30").
- INSTALL 4" WHITE PAINTED MOTORCYCLE PARKING STALL LINES (TYPICAL MOTORCYCLE PARKING STALL = 4'x8')
- INSTALL RED PAINT ON CURB FOR FIRELANE.
- INSTALL "FIRELANE-NO PARKING" SIGN (18"x24") REFER TO DETAIL.
- INSTALL R3-4 SIGN (30"x30")
- INSTALL R7-8 SIGN (12"x18") \*\$100.00 IF USED BY OTHERS.
- INSTALL 8' WIDE AISLE WITH 4" WHITE PAINTED HATCH LINES 3' O.C. @ 45°.
- INSTALL R8-3A SIGN (24"x24") EVER 150' MINIMUM.

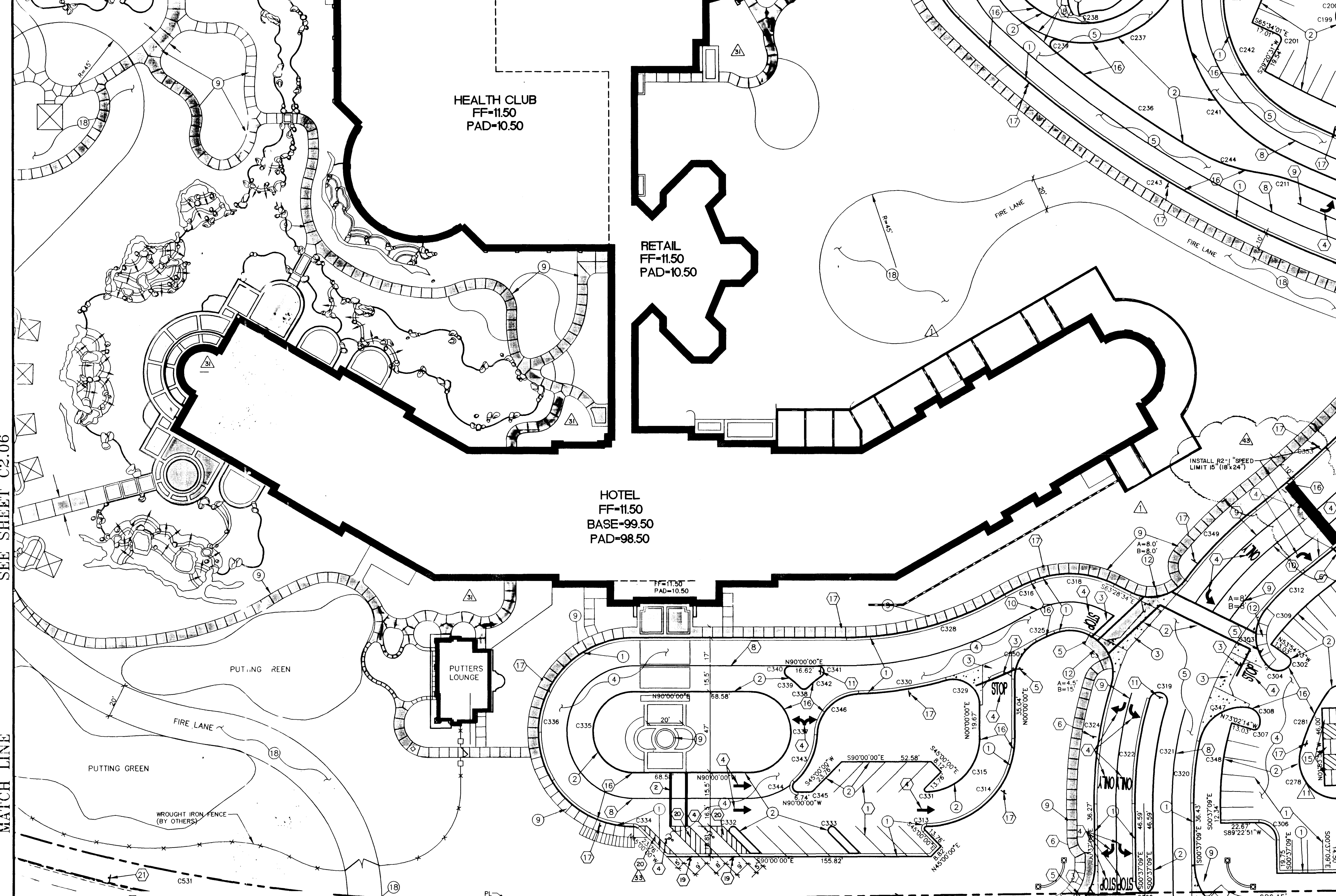

**LEGEND**

EXISTING	PROPOSED	DESCRIPTION
---	---	RIGHT-OF-WAY
---	---	CENTERLINE
---	---	CHAIN LINK FENCE
---	---	WATER LINE
---	---	SANITARY SEWER LINE
---	---	GAS LINE
---	---	STORM DRAIN
---	---	POWER LINE / POWER POLE
---	---	TELEPHONE LINE
---	---	FIRE HYDRANT
---	---	WATER VALVE
---	---	METERS / PULL BOXES
---	---	RECOVER
---	---	MANHOLE
---	---	CLEANOUT
---	---	CONTOUR
---	---	STREET LIGHTS
---	---	100 W.H.P.S.
---	---	150 W.H.P.S.
---	---	200 W.H.P.S.
---	---	250 W.H.P.S.
---	---	WS = WATER SURFACE

AVOID CUTTING UNDERGROUND UTILITY LINES. IT'S COSTLY.

Call before you Dig - 1-800-227-2600

AVOID OVERHEAD POWER LINE CONTACT

Call before you OVERHEAD - 1-702-593-6111

MARTIN & MARTIN ASSUMES NO RESPONSIBILITY FOR EXISTING UTILITY LOCATIONS AND ELEVATIONS. THE UTILITIES SHOWN ON THIS DRAWING HAVE BEEN PLOTTED FROM THE BEST AVAILABLE INFORMATION. IT IS, HOWEVER, THE CONTRACTOR'S RESPONSIBILITY TO FIELD VERIFY THE LOCATION AND ELEVATION OF ALL UTILITIES PRIOR TO THE COMMENCEMENT OF ANY CONSTRUCTION. CONTRACTOR TO FIELD VERIFY ALL EXISTING SITE CONDITIONS PRIOR TO CONSTRUCTION. IF A CONFLICT EXISTS BETWEEN WHAT IS SHOWN ON THESE DRAWINGS AND WHAT EXISTS IN THE FIELD, THE CONTRACTOR IS TO NOTIFY THE ARCHITECT OR ENGINEER IMMEDIATELY.

BY ANGEL PARK GOLF COURSE

CITY OF LAS VEGAS FIRE MARSHALL DATE

Call before you Dig - 1-800-227-2600

Call before you OVERHEAD - 1-702-593-6111

NEVADA POWER ENVIRONMENT AND SAFETY SERVICES DEPARTMENT

REFER TO C2.09 FOR CURVE TABLE

*R. G. Galt* 2/18/98  
CITY OF LAS VEGAS FIRE MARSHALL DATE

