

THORNE PINE AVE.

PLAN AND PROFILE
SCALE
HORIZ. 1" = 40'
VERT. 1" = 4'

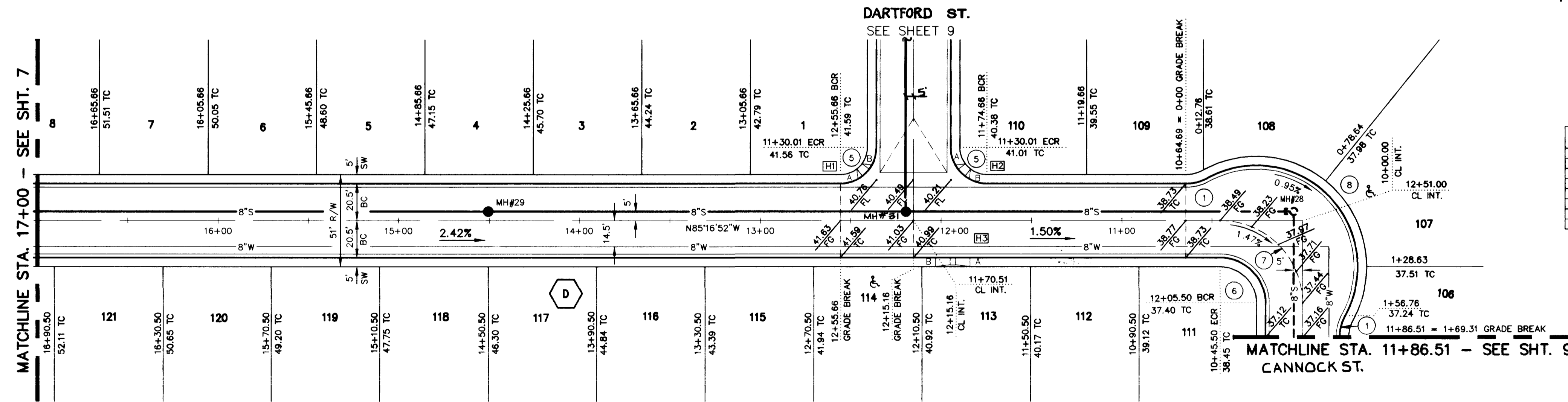

THORNE PINE AVE.

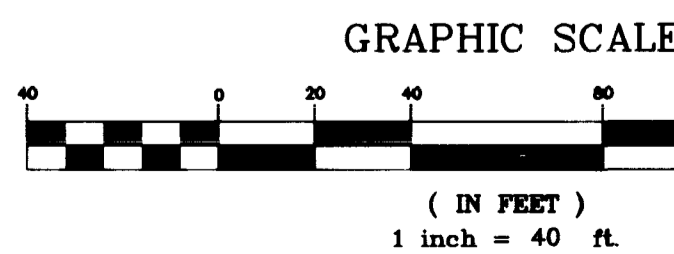

NO.	A	B	SLOPE
H1	8.0	8.0	1.78%
H2	12.0	4.5	3.06%
H3	8.0	8.0	1.50%

BACK OF CURB DATA TABLE

CURVE	DELTA	RADIUS	LENGTH	TANGENT
1	28°46'19"	25.00'	12.55'	6.41'
2	152°02'14"	56.00'	148.60'	224.91'
3	94°29'37"	45.50'	75.04'	49.22'
4	94°29'37"	25.00'	41.23'	27.04'
5	90°00'00"	20.00'	31.42'	20.00'
6	90°00'00"	25.00'	39.27'	25.00'
7	90°00'00"	45.50'	71.47'	45.50'
8	147°32'37"	56.00'	144.21'	192.40'

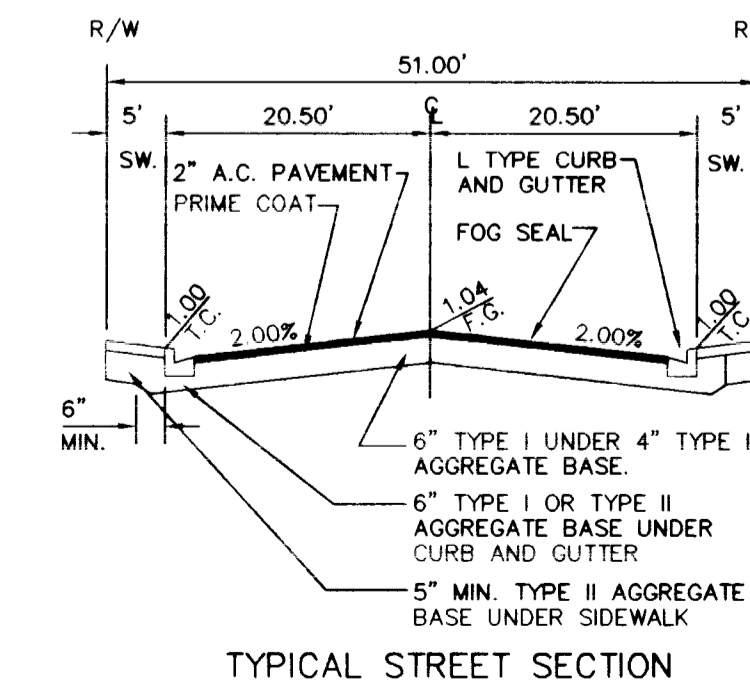

TYPICAL STREET SECTION
NO SCALE



REVISIONS
NO. DESCRIPTION DATE
1 REVISED SEWER INVERT 9-1-97
2 REVISED SEWER INVERT 8/14/97
3 NO. DESCRIPTION DATE

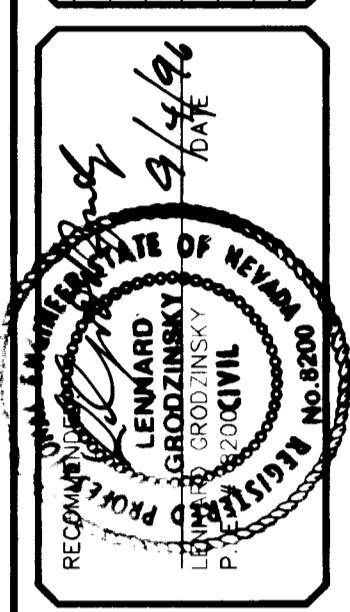

DATE: 7/18/96
DRAWN BY: [Signature]
DESIGNED BY: TC
CHECKED BY: [Signature]
JOB NO.: 0168.0090
SCALE: 1" = 40'

PENTACORE
CIVIL ENGINEERING • LAND SURVEYING • PLANNING
CONSTRUCTION MANAGEMENT • ADA CONSULTING
6763 WEST CHARLESTON BOULEVARD
LAS VEGAS, NEVADA 89102 (702)258-0115

RHODES HOMES
THE MEADOWS AT ELKHORN SPRINGS - UNIT 3
THORNE PINE AVENUE
STREET PLAN AND PROFILE

11-29-43

107Y-4457-3

