

IMPROVEMENT PLANS

OF

THE LAKES at West Sahara

PHASE 1A

CITY OF LAS VEGAS

GENERAL NOTES

- CURB AND GUTTER WITH A GRADE OF LESS THAN FOUR TENTHS OF ONE PERCENT SHALL BE CONSTRUCTED BY FORMING. EACH JOINT SHALL BE CHECKED FOR GRADE PRIOR TO CONSTRUCTION AND WATER TESTED AS SOON AS POSSIBLE AFTER CONSTRUCTION.
- WHEELCHAIR RAMPS SHALL BE CONSTRUCTED IN EACH QUADRANT OF AN INTERSECTION PER STANDARD DRAWING D22A. EXACT LOCATION OF RAMPS SHALL BE DETERMINED IN THE FIELD BY A CITY INSPECTOR.
- CONTRACTOR SHALL PROVIDE ALL NECESSARY HORIZONTAL AND VERTICAL TRANSITIONS BETWEEN NEW CONSTRUCTION AND EXISTING SURFACES TO PROVIDE FOR PROPER DRAINAGE AND OF INGRESS AND EGRESS TO SAID CONSTRUCTION. EXTENT OF TRANSITIONS TO BE DETERMINED BY THE CITY ENGINEER.
- EXISTING UTILITIES ARE LOCATED ON PLANS FOR THE CONVENIENCE OF THE CONTRACTOR. THE CONTRACTOR SHALL BEAR FULL RESPONSIBILITY FOR THE PROTECTION OF THE UTILITIES AND THE ENGINEER BEARS NO RESPONSIBILITY FOR UTILITIES NOT SHOWN ON PLANS OR NOT IN THE LOCATION SHOWN ON THE PLANS.
- CONSTRUCTION TO BE PER UNIFORM STANDARD SPECIFICATIONS AND DRAWINGS, CLARK COUNTY AREA, NEVADA (LATEST EDITION).
- TYPE V CEMENT TO BE USED IN ALL CONCRETE.
- CONCRETE TO BE DESIGNED FOR A 6.5 SACK MIX WITH A MAXIMUM WATER/CEMENT RATIO OF 0.45 (OR AS DESIGNED BY THE SOILS ENGINEER). MIX DESIGN TO BE APPROVED BY THE QUALITY CONTROL DIVISION PRIOR TO USE ON THE PROPERTY.
- ALL MANHOLES, WATER VALVES, AND CLEANOUTS THAT LIE WITHIN THE LIMITS OF ROADWAY CONSTRUCTION SHALL BE PLATED AT SUBGRADE LEVEL. AFTER PLACEMENT OF THE ASPHALT PAVEMENT AND BASE MATERIALS, THE MANHOLES SHALL BE BROUGHT TO FINISH GRADE AND A COLLAR SHALL BE CONSTRUCTED FOR EACH MANHOLE. INSPECTORS ARE TO BE NOTIFIED IN ADVANCE TO INSPECT WORK AT THE TIME OF ADJUSTMENT.
- TRAFFIC CONTROL DEVICES TO BE INSTALLED AS REQUIRED BY TRAFFIC ENGINEERING DIVISION & SHOWN ON PLANS.

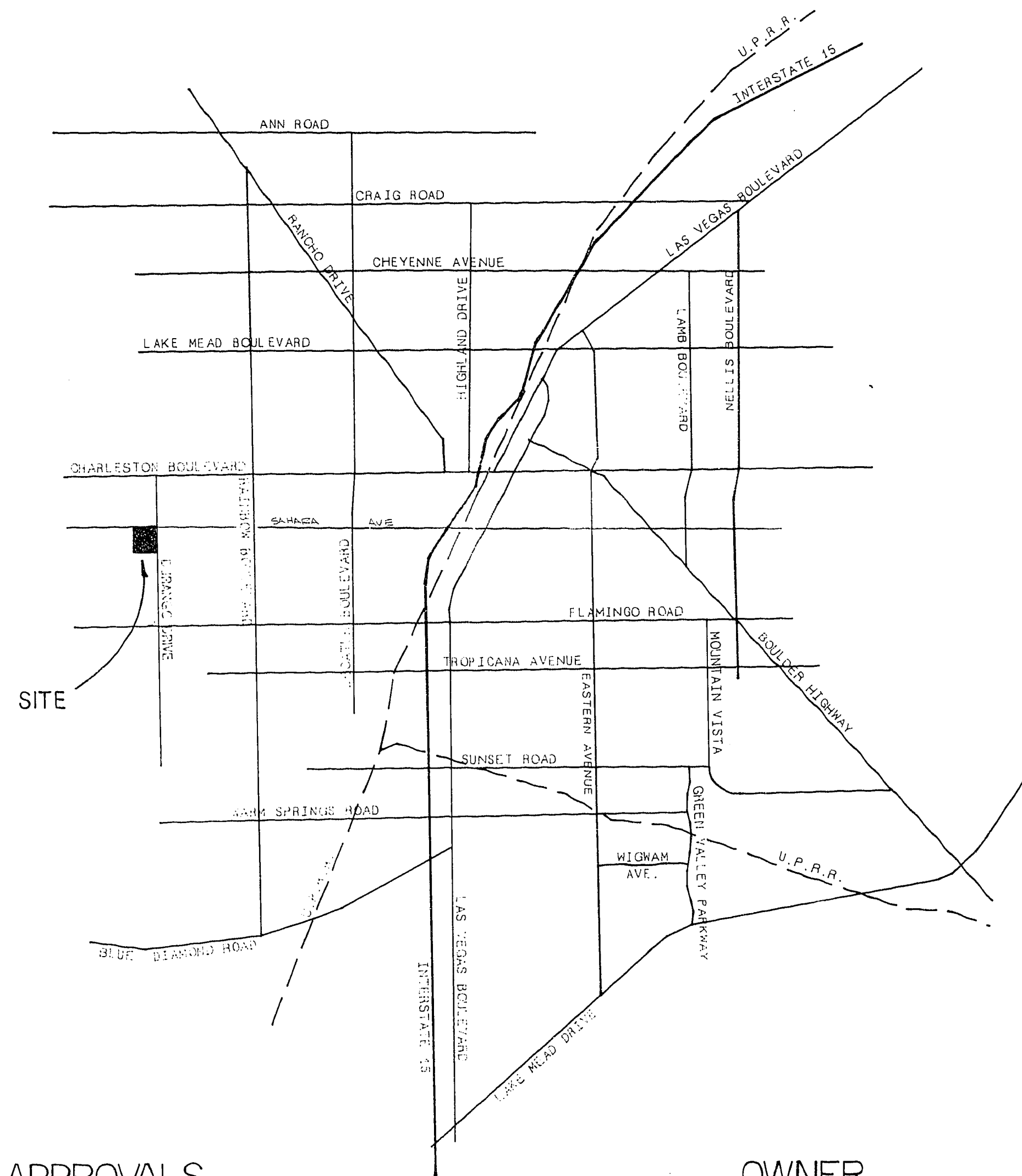

BENCHMARK

CLARK COUNTY BENCH MARK NO. C105W04 RAILROAD SPIKE AT INTERSECTION OF SAHARA AND DURANGO.

ELEVATION = 2659.63'

QUANTITY ESTIMATE

ITEM	QUANTITY	UNIT
WEST SAHARA INVESTMENTS CO.		
3.75" ASPHALTIC CONCRETE PAVING	27707	S.Y.
2.0" ASPHALTIC CONCRETE PAVING	970	S.Y.
CONCRETE VALLEY GUTTER	3730	S.F.
"L" TYPE CURB AND GUTTER	5804	L.F.
6" CONCRETE SIDEWALK	15375	S.F.
8" CONCRETE SIDEWALK	7453	S.F.
CITI-CORP.		
3.75" ASPHALTIC CONCRETE PAVING	24403	S.Y.
CONCRETE VALLEY GUTTER	4854	S.F.
"L" TYPE CURB & GUTTER	4596	L.F.
6" CONCRETE SIDEWALK	9053	S.F.

SHEET INDEX

SHEET NO.	DESCRIPTION
1	COVER SHEET
2	DETAIL SHEET
3	GRADING PLAN
4	STREET PLAN & PROFILE - SAHARA AVE.
5	STREET PLAN & PROFILE - SAHARA AVE.
6	STREET PLAN & PROFILE - SAHARA AVE.
7	STREET PLAN & PROFILE - DURANGO DR.
8	STREET PLAN & PROFILE - LAKE SAHARA DR.
9	STREET PLAN & PROFILE - LAKE SAHARA DR.
10	STREET PLAN & PROFILE - CRYSTAL WATER WAY
11	STREET PLAN & PROFILE - EAST LAKE DR.
12	STREET PLAN & PROFILE - EAST LAKE DR.
13	MASTER SEWER PLAN
14	SEWER PLAN & PROFILE - DURANGO DR.
15	SEWER PLAN & PROFILE - DURANGO DR.
16	SEWER PLAN & PROFILE - DURANGO DR. & STARBOARD DR.
17	SEWER PLAN & PROFILE - STARBOARD DR.
18	SEWER PLAN & PROFILE - LAKE EAST DR.
19	SEWER PLAN & PROFILE - LAKE EAST DR.
20	SEWER PLAN & PROFILE - CRYSTAL WATER WAY
21	SEWER PLAN & PROFILE - LAKE SAHARA DR.
22	SEWER PLAN & PROFILE - LAKE EAST DR.
23	SEWER PLAN & PROFILE - LAKE EAST DR.
24	SEWER PLAN & PROFILE - LAKE EAST DR.
25	SEWER PLAN & PROFILE - LAKE EAST DR.
26	SEWER PLAN & PROFILE - CRYSTAL WATER WAY
27	SEWER PLAN & PROFILE - CRYSTAL WATER WAY
28	SEWER PLAN & PROFILE - PROMENADE DR.
29	MASTER WATER PLAN
30	MASTER STREET LIGHT PLAN

APPROVALS

Carl P. Melus 11-9-84
C.L.V. CITY ENGINEER DATE

Val P. Fisher 11-9-84
C.L.V. QUALITY CONTROL DATE

R. G. Santos 11-9-84
C.L.V. LAND DEVELOPMENT & FLOOD CONT. DATE

R. G. Santos 11-9-84
C.L.V. SANITATION ENGINEER DATE

OWNER

WEST SAHARA INVESTMENT CO.
BOX 42427 HUNTRIDGE STATION
LAS VEGAS, NEVADA 89116

DEVELOPER

COLLINS BROTHERS CORP.
BOX 42427 HUNTRIDGE STATION
LAS VEGAS, NEVADA 89116

7022 W. CHARLESTON BLVD
LAS VEGAS, NEVADA 89117
PHONE: 702 / 363-6415

ENGINEERS & SURVEYORS INCORPORATED

SUBMITTED BY: *[Signature]*

COVER SHEET

THE LAKES at WEST SAHARA PHASE 1A

WO NO 830802-1A

BY D. KRAMETSBAUER

DATE 8-14-84

SCALE NO SCALE

SHEET 1 OF 30 SHEETS

1078-1933-1A