

STREET IMPROVEMENT PLANS OF THE LAKES at West Sahara Phase 7 (LAKE SOUTH DR.) CITY OF LAS VEGAS

GENERAL NOTES

- CURB AND GUTTER WITH A GRADE OF LESS THAN FOUR TENTHS OF ONE PERCENT SHALL BE CONSTRUCTED BY FORMING. EACH JOINT SHALL BE CHECKED FOR GRADE PRIOR TO CONSTRUCTION AND WATER TESTED AS SOON AS POSSIBLE AFTER CONSTRUCTION.
- WHEELCHAIR RAMPS SHALL BE CONSTRUCTED IN EACH QUADRANT OF AN INTERSECTION PER STANDARD DRAWING D22A. EXACT LOCATION OF RAMPS SHALL BE DETERMINED IN THE FIELD BY A CITY INSPECTOR.
- CONTRACTOR SHALL PROVIDE ALL NECESSARY HORIZONTAL AND VERTICAL TRANSITIONS BETWEEN NEW CONSTRUCTION AND EXISTING SURFACES TO PROVIDE FOR PROPER DRAINAGE AND OF INGRESS AND EGRESS TO SAID CONSTRUCTION. EXTENT OF TRANSITIONS TO BE DETERMINED BY THE CITY ENGINEER.
- EXISTING UTILITIES ARE LOCATED ON THE PLANS FOR THE CONVENIENCE OF THE CONTRACTOR. THE CONTRACTOR SHALL BEAR FULL RESPONSIBILITY FOR THE PROTECTION OF THE UTILITIES AND THE ENGINEER BEARS NO RESPONSIBILITY FOR UTILITIES NOT SHOWN ON PLANS OR NOT IN THE LOCATION SHOWN ON THE PLANS.
- CONSTRUCTION TO BE PER UNIFORM STANDARD SPECIFICATIONS AND DRAWINGS, CLARK COUNTY AREA, NEVADA (LATEST EDITION).
- TYPE V CEMENT TO BE USED IN ALL CONCRETE.
- ALL MANHOLES, WATER VALVES AND CLEANOUTS THAT LIE WITHIN THE LIMITS OF ROADWAY CONSTRUCTION SHALL BE PLATED AT SUBGRADE LEVEL. AFTER PLACEMENT OF THE ASPHALT PAVEMENT AND BASE MATERIALS, THE MANHOLES SHALL BE BROUGHT TO FINISH GRADE AND A COLLAR SHALL BE CONSTRUCTED FOR EACH MANHOLE. INSPECTORS ARE TO BE NOTIFIED IN ADVANCE TO INSPECT WORK AT THE TIME OF ADJUSTMENT. COLLARS TO BE PER CIV SPECIFICATIONS.
- CHISEL S OR G WHEREVER SEWER OR GAS LINES PASS UNDER CURB.

CITY OF LAS VEGAS SEWER TRENCH NOTES

- BACKFILL SHALL BE ANY EXCAVATED, IMPORTED OR TRANSPORTED MATERIAL WHICH IS FREE FROM LARGE LUMPS GREATER THAN 6" IN DIAMETER AND FREE OF ORGANIC MATERIAL. BACKFILL SHALL BE COMPACTED BY FLOODING OR TAMPING TO A DENSITY SPECIFIED BY THE SOILS ENGINEER.
- TRENCH NOTES FOR VCP SEWER PIPE ONLY. IF PVC ALTERNATE IS USED, THEN TRENCH BACKFILL SHALL COMPLY WITH CITY OF LAS VEGAS INTER-OFFICE MEMORANDUM DATED JANUARY 25, 1980.
- BACKFILL TO 12" MINIMUM COVER OVER PIPE WITH SELECTED SAND OR GRAVEL, NO LARGER THAN 2" DIAMETER. BACKFILL TO BE PLACED BY HAND FOR PIPES 27" IN DIAMETER AND SMALLER.

LAS VEGAS VALLEY WATER DISTRICT NOTES

- ALL WORK TO CONFORM TO LAS VEGAS VALLEY WATER DISTRICT STANDARD PLATES AND SPECIFICATIONS.
- ALL WORK, EXCEPT AS MODIFIED HEREON OR BY NOTE NO. 1, SHALL BE DONE IN ACCORDANCE WITH THE MOST CURRENT DRAFT OR EDITION OF UNIFORM STANDARD SPECIFICATIONS FOR PUBLIC WORKS CONSTRUCTION OFF-SITE IMPROVEMENTS, CLARK COUNTY AREA.
- NOTICE TO BE GIVEN ENGINEERING DEPARTMENT OF THE LAS VEGAS VALLEY WATER DISTRICT 48 HOURS PRIOR TO ACTUAL CONSTRUCTION.
- SERVICE SADDLES OR TAPPED COLLARS WILL BE REQUIRED ON ALL 3/4" AND 1" SERVICE LATERALS. SERVICE SADDLES ONLY WILL BE PERMITTED ON 1 1/2" AND 2" SERVICE LATERALS. DOUBLE TAPPED COLLARS ARE NOT PERMITTED.
- ALL LINES TO BE PRESSURE TESTED TO 200 PSI.
- DEFLECTION ANGLE SHALL NOT EXCEED 2 1/2 DEGREES PER 13 FOOT SECTION OF PIPE FOR PIPE SIZES SMALLER THAN 14 INCHES, AND SHALL NOT EXCEED 2 DEGREES FOR PIPE SIZES BETWEEN 14" AND 18".
- ALL METERS SHALL BE LOCATED OUTSIDE OF DRIVEWAYS.
- DETECTOR TAPE REQUIRED IN ACCORDANCE WITH STANDARD PLATE NO. 27 WHERE INDICATED AND AS FOLLOWS:
 - OVER ALL MAINS NOT INSTALLED AT 6 FEET FROM BACK OF CURB.
 - OVER ALL SERVICE LATERALS NOT INSTALLED AT RIGHT ANGLES TO MAINS.
- CALL BEFORE YOU DIG - 1-800-227-2600.

CITY OF LAS VEGAS STREET LIGHT NOTES

ALL STREET LIGHTING INSTALLATIONS SHALL CONFORM TO THE LATEST ISSUE OF THE STANDARD DETAILS AND SPECIFICATIONS OF THE CITY OF LAS VEGAS, AND SHALL ALSO CONFORM TO THE UNIFORM STANDARD SPECIFICATIONS FOR PUBLIC WORKS CONSTRUCTION OF OFF-SITE IMPROVEMENTS, CLARK COUNTY AREA, NEVADA (LATEST EDITION), UNLESS OTHERWISE NOTED.

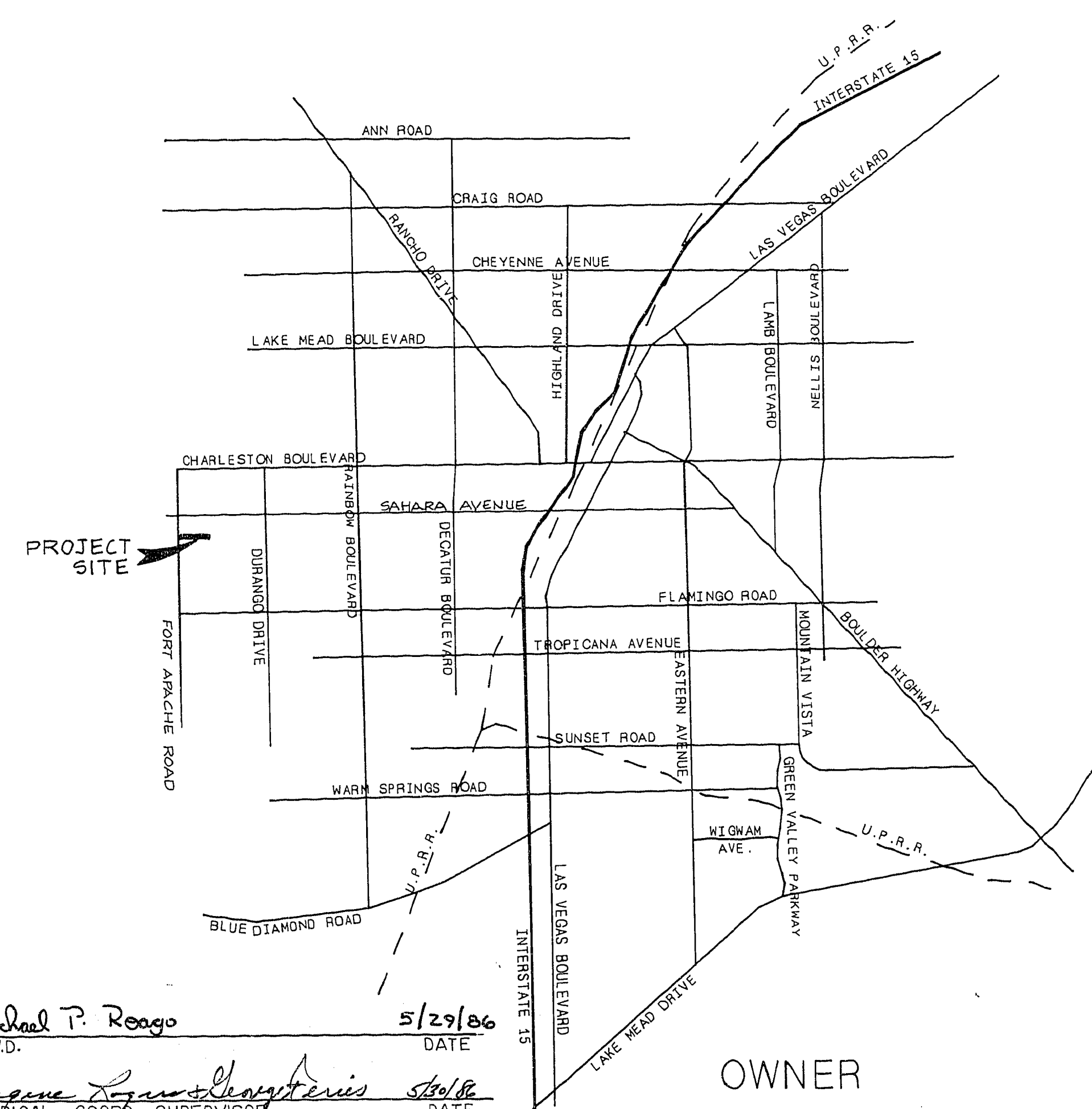

Michael P. Roago 5/29/86
L.V.V.W.D. DATE

Enrique S. Sandoval 5/29/86
ELECTRICAL COORD. SUPERVISOR DATE

P.G. Dator 6-2-86
SANITATION SUPERVISOR DATE

6-23-86
C.L.V. CITY ENGINEER DATE

6/20/86
C.L.V. FIRE MARSHAL DATE

6-23-86
C.L.V. CHIEF LAND DEVELOPMENT DATE

OWNER
WEST SAHARA INVESTMENTS, INC.
P.O. BOX 42427 HUNTRIDGE STATION
LAS VEGAS, NEVADA 89119

DEVELOPER
WEST SAHARA INVESTMENTS, INC.
P.O. BOX 42427 HUNTRIDGE STATION
LAS VEGAS, NEVADA 89119

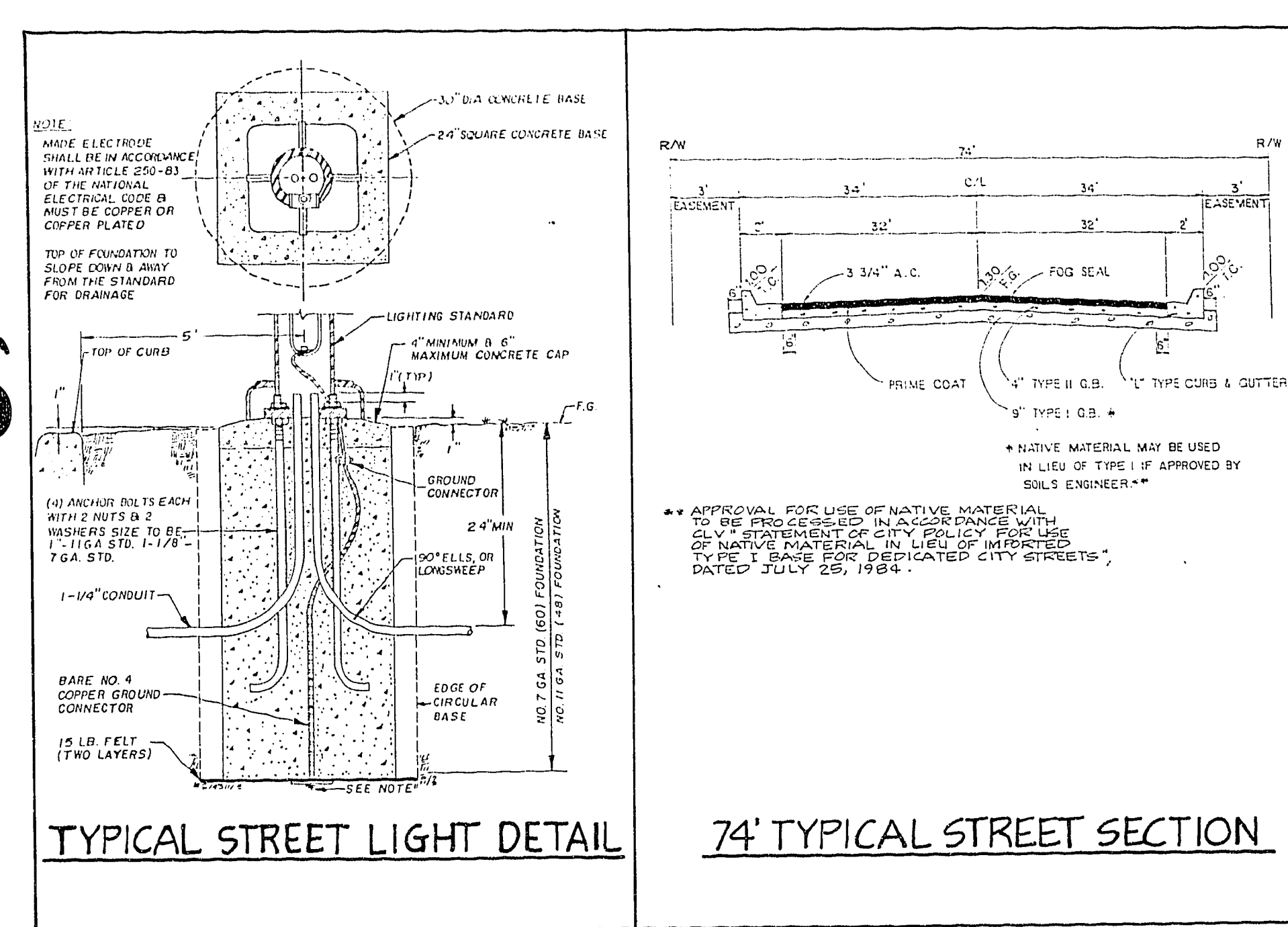

BENCHMARK

CLARK COUNTY BENCHMARK NO. C105W04: RAILROAD SPIKE AT INTERSECTION OF SAHARA AVE. AND DURANGO DR.
ELEVATION = 2659.53'
(C.C. DATUM - 1.04' = CIV DATUM)

QUANTITY ESTIMATE

LAKE SOUTH DRIVE IMPROVEMENTS:		SEWER:	
3 3/4" ASPHALTIC CONCRETE PAVING	7,445.5	8" SEWER MAIN	1,086 L.F.
1" TYPE CURB & GUTTER	1,917 L.F.	4" DIA. MANHOLE	4 EA.
CONCRETE VALLEY CUTTER	3,134.5		
WATER:		STREET LIGHTS & SIGNS:	
16" A.C.P. WATER MAIN	1,083 L.F.	100-W. U.P.S. (W/REEL LUMINAIRE)	6 EA.
10" A.C.P. WATER MAIN	280 L.F.	CONC. AGGREGATE STANDARD	6 EA.
16" x 16" x 10" TEE	2 EA.	# 3 1/2" P.B.	2 EA.
16" BUTTERFLY VALVE	1 EA.	1 1/4" CONDUIT	11,951 L.F.
10" G.V.	4 EA.	STOP SIGN	2 EA.
2" SLODOFF	5 EA.	STREET SIGN	2 EA.
2" METER SERVICES	4 EA.	3 DIAMOND BARRICADES	1 EA.

SHEET INDEX

SHEET NO.	DESCRIPTION
1.	COVER SHEET
2.	STREET PLAN & PROFILE: LAKE SOUTH DRIVE: STA. 64 + 45.85 TO FORT APACHE ROAD

REVISIONS PER DISTRICT CHANGED QUANTITY	5-14-86	PL	5/23/86	T.B.	2-15-86	PL	7-15-86	PL
REVISIONS PER DISTRICT CHANGED QUANTITY	5-14-86	PL	5/23/86	T.B.	2-15-86	PL	7-15-86	PL
REVISIONS PER DISTRICT CHANGED QUANTITY	5-14-86	PL	5/23/86	T.B.	2-15-86	PL	7-15-86	PL
REVISIONS PER DISTRICT CHANGED QUANTITY	5-14-86	PL	5/23/86	T.B.	2-15-86	PL	7-15-86	PL

ENGINEERS & SURVEYORS
PAUL E. HUNTER
REGISTERED ENGINEER STATE OF NEVADA
NO. 1418
PAUL E. HUNTER
REGISTERED SURVEYOR STATE OF NEVADA
NO. 1418

COVER SHEET

THE LAKES at West Sahara Phase 7
(LAKE SOUTH DRIVE)

1
OF 2 SHEETS