

CURVE DATA REPRESENTS PARTIAL DATA, THIS SHEET ONLY.

CURVE	DELTA	RADIUS	LENGTH	TANGENT
1	02°33'54"	1246.00'	55.78'	27.89'
2	11°11'37"	300.00'	58.61'	29.40'
3	08°51'11"	300.00'	35.38'	17.96'
4	20°54'56"	1161.00'	423.82'	214.29'
5	20°54'56"	1200.00'	438.05'	221.49'
6	14°00'37"	1239.00'	302.97'	152.24'

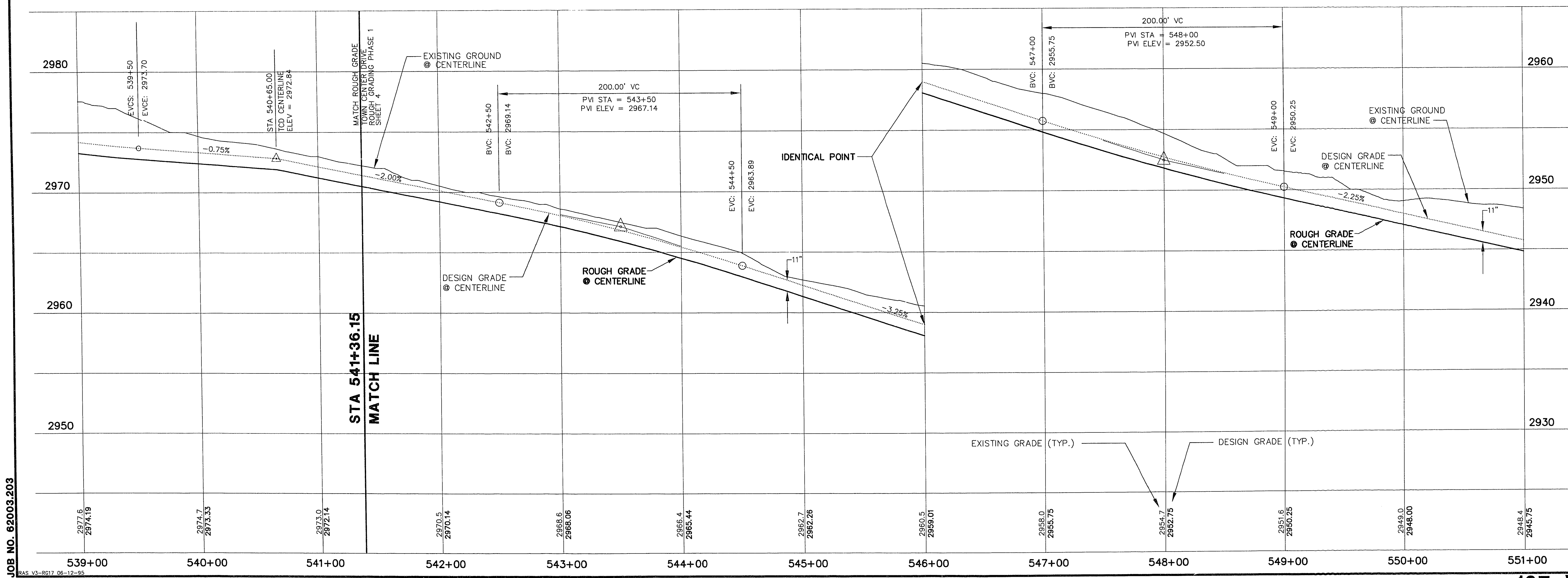

JOB NO. 62003.203

REVISIONS V3-RG17 06-12-95

NO.	DATE	DESCRIPTION	APPROVAL
1	11/17/11	ISSUED FOR PERMITS	BERT A. WALLACE
2	11/17/11	ISSUED FOR PERMITS	BERT A. WALLACE
3	11/17/11	ISSUED FOR PERMITS	BERT A. WALLACE
4	11/17/11	ISSUED FOR PERMITS	BERT A. WALLACE
5	11/17/11	ISSUED FOR PERMITS	BERT A. WALLACE
6	11/17/11	ISSUED FOR PERMITS	BERT A. WALLACE
7	11/17/11	ISSUED FOR PERMITS	BERT A. WALLACE
8	11/17/11	ISSUED FOR PERMITS	BERT A. WALLACE
9	11/17/11	ISSUED FOR PERMITS	BERT A. WALLACE
10	11/17/11	ISSUED FOR PERMITS	BERT A. WALLACE

RECOMMENDED BY  
BERT A. WALLACE  
CIVIL ENGINEER  
No. 10258

STATE OF NEVADA  
COUNTY OF CLATSOP  
BARTON W. WALLACE  
CIVIL ENGINEER  
No. 10258

G.C. WALLACE, INC.  
Engineering/Architecture  
1555 SOUTH MAINWAY BLVD./LAS VEGAS, NEVADA 89102

SHEET  
**17**  
SHT 17 OF 47

**VILLAGE 3 ROUGH GRADING**  
**ALTA DRIVE**  
**PLAN & PROFILE**  
**STA 541+36.15 TO 551+00.00**

20. 2-129

107-V2355