

TYPICAL CONC. ARCH END TREATMENT

NOT TO SCALE

5
40A

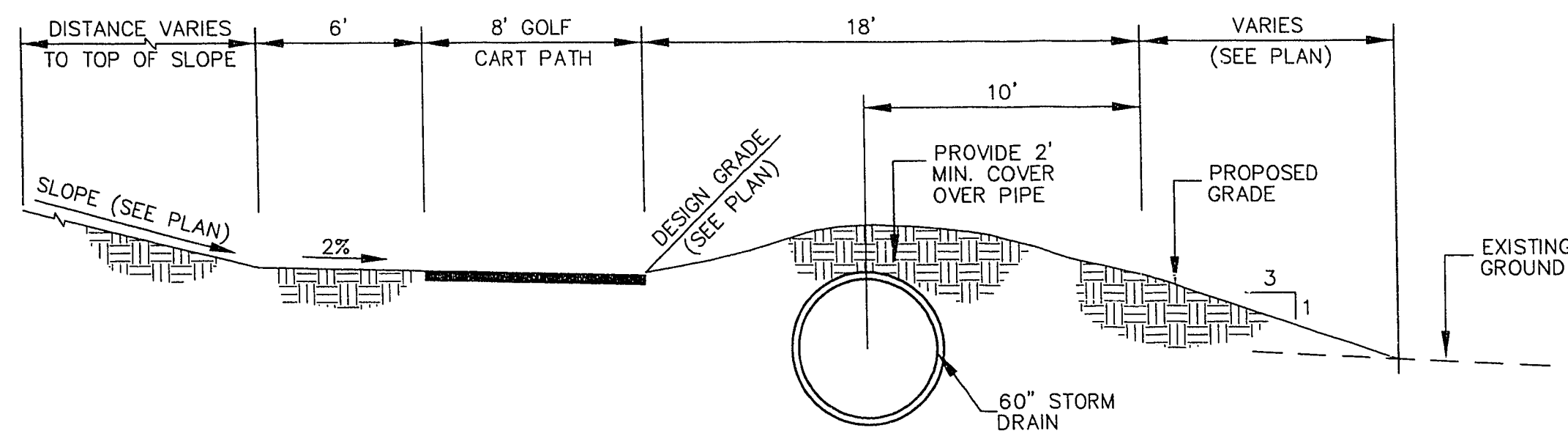

GOLF CART/GRADING SECTION

SCALE: 1" = 5'

4
40A

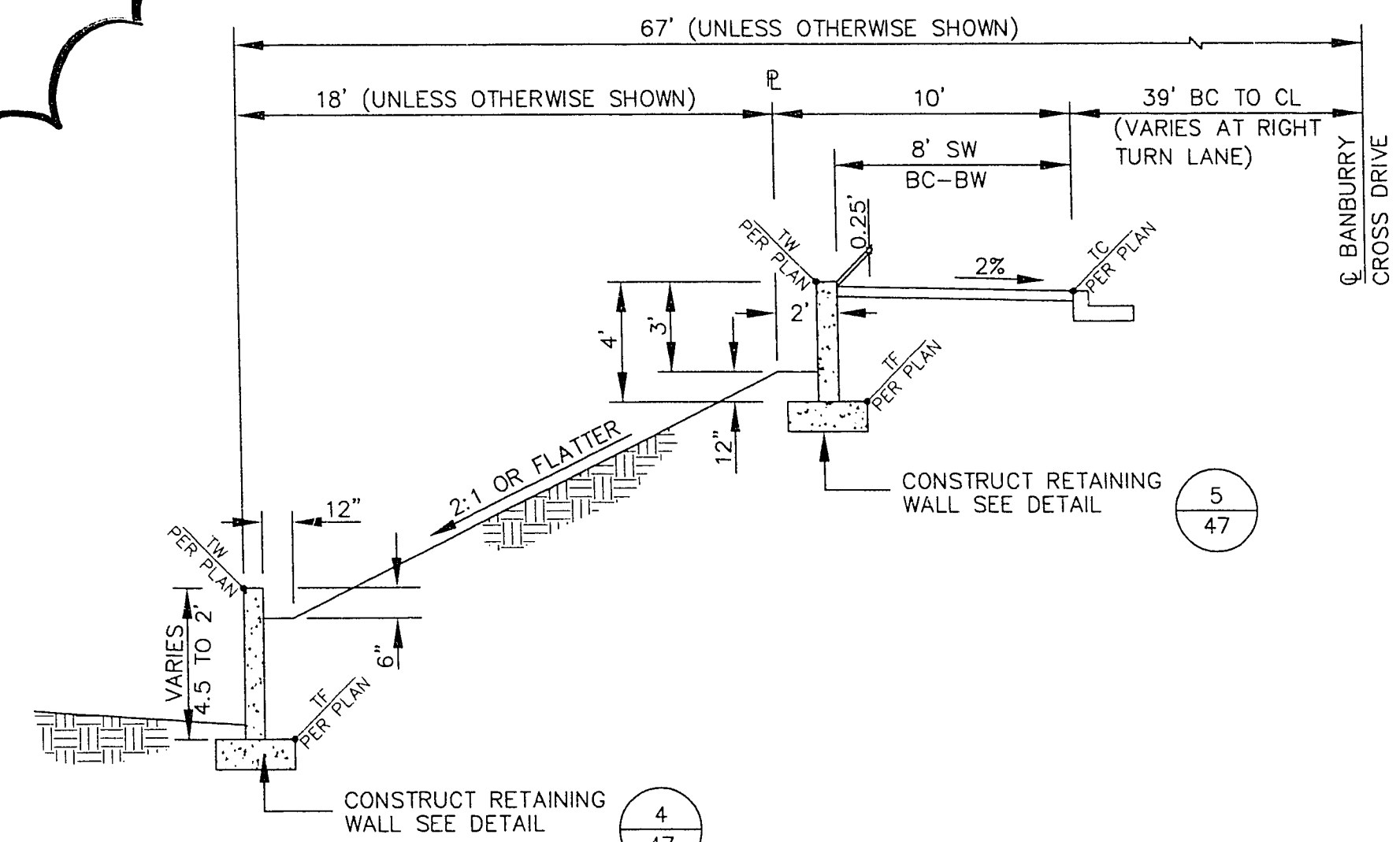

TYPICAL RETAINING WALL SECTION

SCALE: 1" = 5'

3
40A

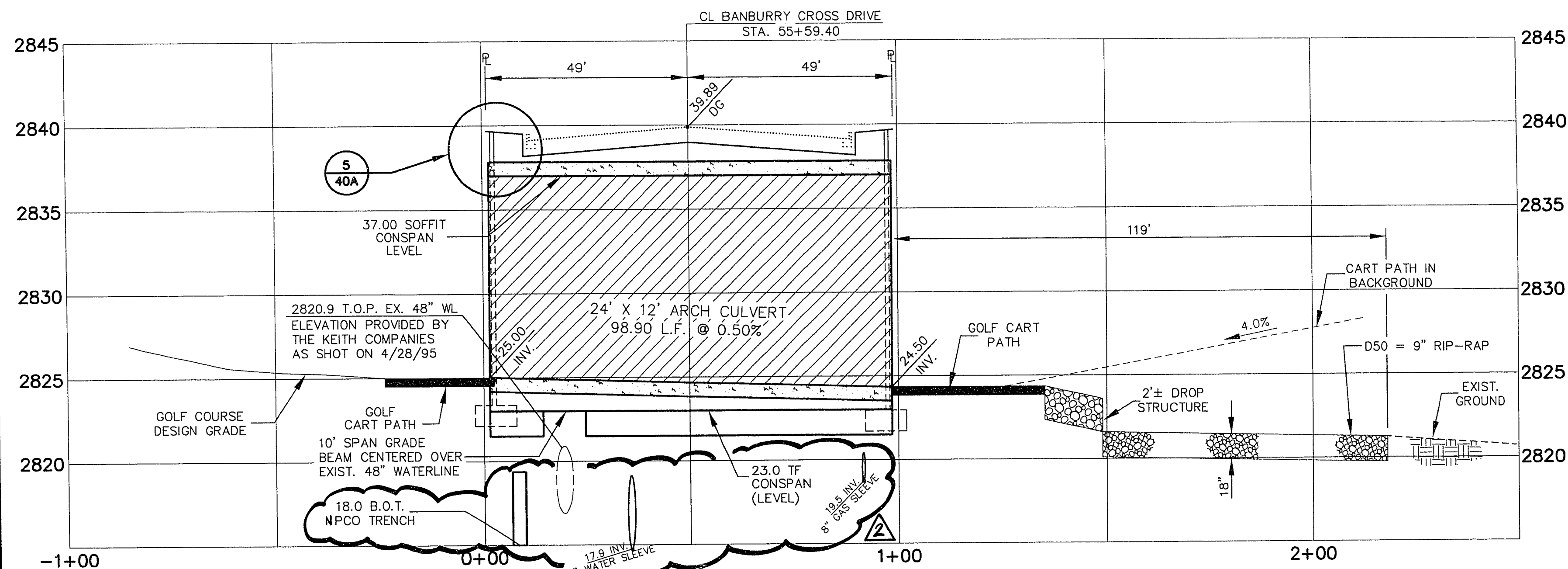

CROSSING NO. 1 @ BANBURY CROSS DR. STA. 55+59.40 PROFILE

SCALE: HORIZ. 1" = 20'
VERT. 1" = 5'

2
40A

NOTE:
THIS REINFORCED CONCRETE ARCH CULVERT AND HEADWALLS DESIGN AND STRUCTURAL CALCULATIONS SHALL BE SIGNED AND STAMPED BY A LICENSED PROFESSIONAL ENGINEER, REGISTERED IN THE STATE OF NEVADA, WHOSE SERVICES SHALL BE RETAINED BY THE CONTRACTOR.

APPROVAL OF THESE DESIGN DRAWINGS DOES NOT CONSTITUTE APPROVAL OF THIS ARCH CULVERT. DETAILS ARE PROVIDED HERE ONLY FOR GRADING AND HYDRAULIC RELATIONSHIP.

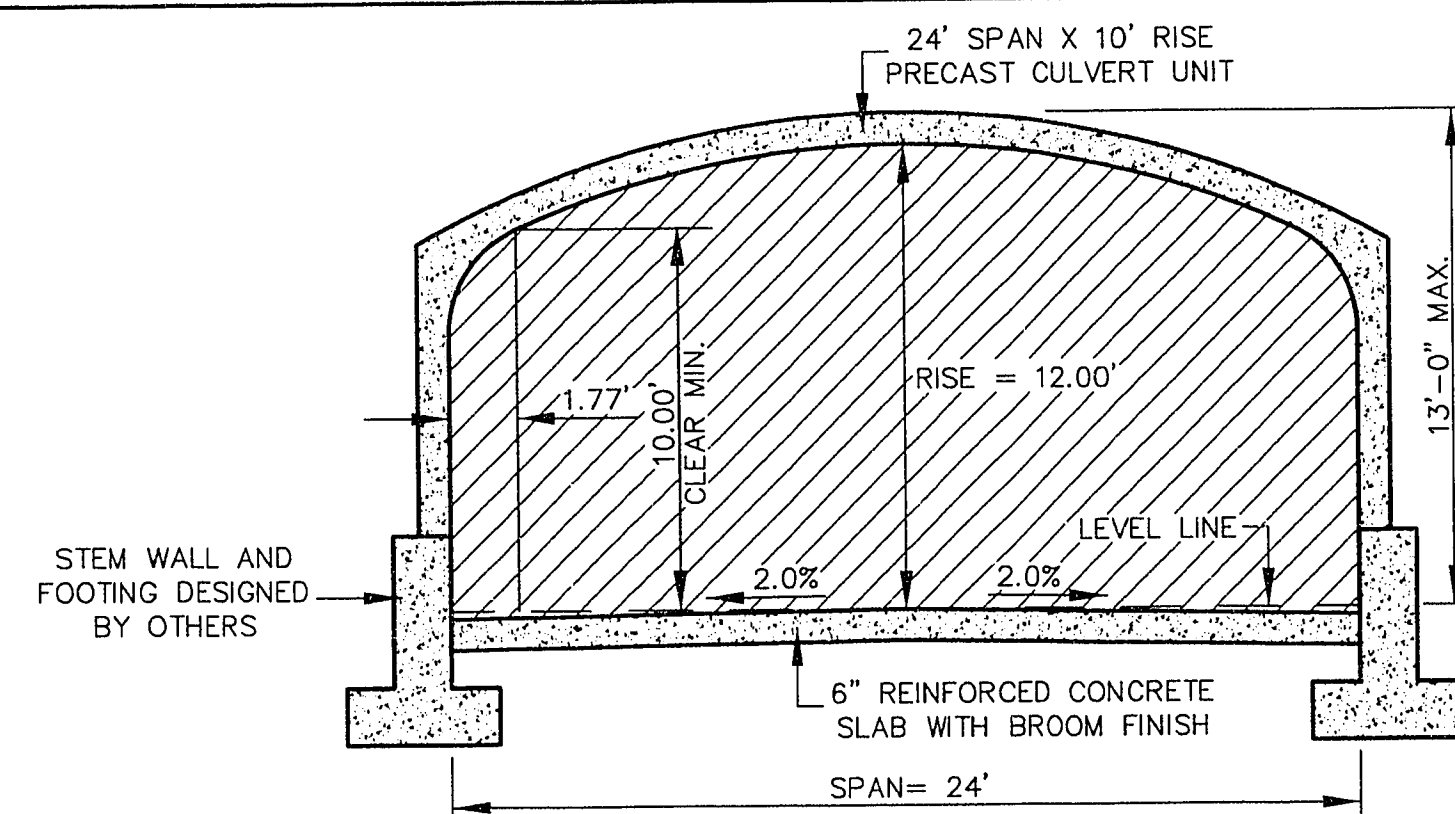

TYPICAL 24' X 12' ARCH CULVERT SECTION

SCALE: 1" = 5'

1
40A

RECOMMENDED	DATE	DESCRIPTION
1	12/14/95	ADD UTILITY SLEEVES IN PROFILE
2	12/14/95	REV. TUNNEL PROFILE WALLS
3	12/14/95	REV. TUNNEL PROFILE WALLS
4	12/14/95	REV. TUNNEL PROFILE WALLS
5	12/14/95	REV. TUNNEL PROFILE WALLS

ENGINEER - STATE OF NEVADA
BERT A. WALLACE
CIVIL
No. 10239

RECOMMENDED BY
G.C. WALLACE, INC.
Engineering/Architecture
1555 SOUTH RANBURY BLVD./LAS VEGAS, NEVADA 89102

SUMMERLIN
DRAINAGE/GOLF CART CROSSINGS SCHEMATICS
DRAINAGE/GOLF CART CROSSING NO. 1
BANBURY CROSS DRIVE STA. 55+59.40
PLAN AND PROFILE

SHEET
40A
SHT 40A OF 47

JOB NO. 62003.203

S.T.S. L.G. V3-R40A 08/27/91

24-8-155 107-V2355