

- LEGEND:**
- 100.00 DESIGN ELEVATION
  - (100.00) EXISTING ELEVATION
  - FL FLOWLINE
  - TC TOP OF CURB
  - FG FINISH GRADE
  - DW DRIVEWAY
  - SW SIDEWALK
  - GB GRADE BREAK
  - FL FLOW LINE
  - 1 EXISTING CONTOUR (1' INTERVAL)
  - 5 EXISTING CONTOUR (5' INTERVAL)
  - RETAINING WALL
  - BLOCK WALL
  - STREET CENTERLINE
  - (PAD=72.87) FUTURE PAD ELEV
  - NEW PAVEMENT
  - PAVEMENT REPLACED

NOTE: BLOCKWALLS & RETAINING WALLS TO BE CLV STD DWG. CLV-102 & CLV STD DWG. TITLED "REGULAR C.M.U. & MORTARLESS HEADJOINT MASONRY WALL".

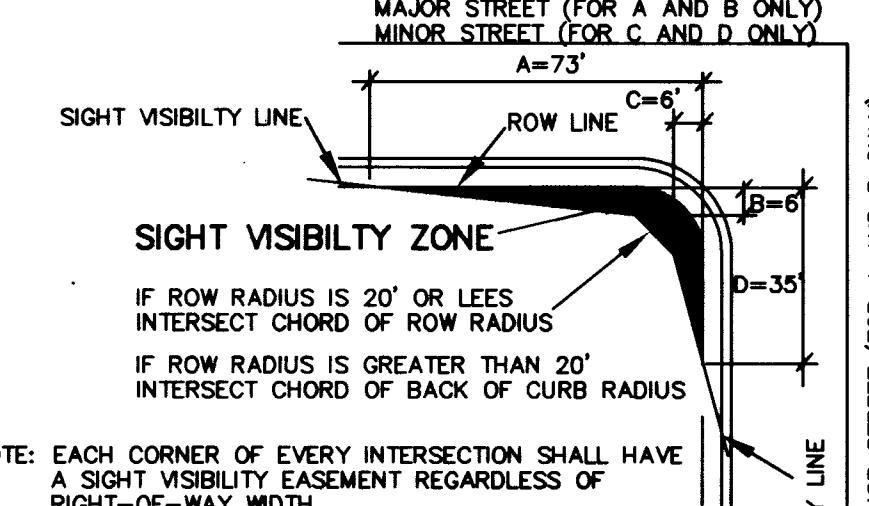

NO WALLS, FENCES, TREES, SHRUBS, UTILITY APPURTENANCES OR ANY OTHER OBJECT, OTHER THAN TRAFFIC CONTROL DEVICES AND STREETLIGHT POLES, MAY BE CONSTRUCTED OR INSTALLED WITHIN THE SITE VISIBILITY ZONE UNLESS SAID OBJECT IS MAINTAINED AT LESS THAN 24 INCHES IN HEIGHT, MEASURED FROM TOP OF CURB, OR WHERE NO CURB EXISTS, A HEIGHT OF 27 INCHES MEASURED FROM THE TOP OF ADJACENT ASPHALT, GRAVEL, OR PAVEMENT STREET SURFACE.

TYPICAL INTERSECTION CORNER

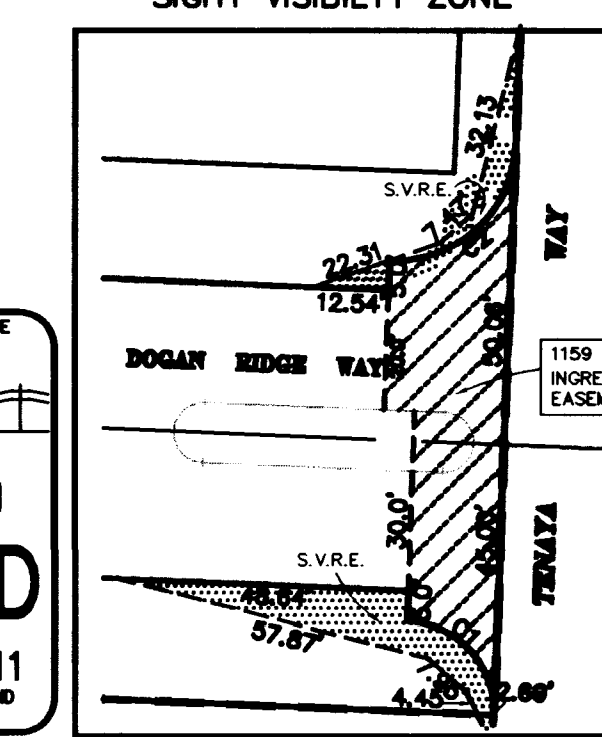

ENTRY DETAIL

CURVE TABLE

No.	RADIUS	DELTA	LENGTH	TANGENT
C1	20.00'	90°00'00"	31.42'	20.00'
C2	25.00'	90°11'04"	39.35'	25.00'
C3	55.00'	90°00'00"	86.39'	55.00'
C4	4.00'	180°00'00"	12.57'	4.00'
C5	35.00'	90°00'00"	54.98'	35.00'
C11	20.00'	90°00'00"	31.42'	20.00'
C12	15.00'	90°00'00"	23.56'	15.00'
C13	40.50'	282°29'44"	199.98'	40.50'
C14	40.50'	78°30'10"	56.20'	33.68'
C15	40.50'	78°24'48"	54.01'	31.88'
C16	40.50'	88°17'03"	82.40'	39.31'
C17	40.50'	38°17'45"	27.07'	14.08'
C18	25.00'	51°14'52"	22.36'	11.99'
C19	40.50'	28°18'36"	18.57'	9.48'
C20	40.50'	80°16'28"	56.74'	34.10'
C21	40.50'	89°34'18"	49.18'	28.13'
C22	40.50'	81°28'41"	57.59'	34.88'
C23	40.50'	24°53'44"	17.80'	8.94'
C24	44.00'	90°42'50"	69.86'	44.58'
C25	25.00'	90°42'50"	39.55'	25.31'

LINE TABLE

No.	BEARING	DISTANCE	
L1	N02°21'03"E	5.00'	
L2	N87°38'57"E	5.00'	
L3	N87°38'57"W	40.00'	
L7	N87°38'57"W	30.00'	
C20	40.50'	78°24'48"	54.01'
C21	40.50'	89°34'18"	49.18'
C22	40.50'	81°28'41"	57.59'
C23	40.50'	24°53'44"	17.80'
L31	N02°21'03"E	30.00'	
L30	N87°38'57"E	5.00'	

**CONSTRUCTION NOTES**

- 1 HANDICAP RAMP PER CCA STD. DWG. 236, CASE II A-B 3-0
- 2 12.5" LF 24" CLASS II RCP @ 0.5%

I CERTIFY THAT THIS GRADING PLAN CONFORMS TO THE APPROVED DRAINAGE STUDY FOR THIS SITE ON FILE WITH CLV FLOOD CONTROL.

EDWARD M. RAJNOVICH P.E. NO. 10149 DATE 2/16/99

**PROJECT BENCHMARK**

CITY LAS VEGAS BENCHMARK #48  
ST. 1LV9022W6, RIVET & PLATE ON POWER - TRANS PAD 500' EAST OF BUFFALO DR. @ 7535 W. DEER SPRINGS RD. ELEV. = 727.8646 M. (NAVD 88) ELEV. = 2385.6000 FT.

**BASIS OF BEARING**

SOUTH 88°32'51" EAST - BEING THE NORTH LINE OF THE NORTHWEST QUARTER (NW 1/4) OF SECTION 22, TOWNSHIP 19 SOUTH, RANGE 60 EAST, M.D.M., CLARK COUNTY, NEVADA AS SHOWN IN BOOK 74 OF PLATS, PAGE 53 OFFICIAL RECORDS, CLARK COUNTY, NEVADA

**NOTE**

CONTRACTOR TO VERIFY LOCATION AND ELEVATION OF ALL EXISTING UNDERGROUND UTILITIES PRIOR TO CONSTRUCTION. NOTIFY THE ENGINEER OF ANY DISCREPANCIES.

**NOTE - PRIVATE STREETS**

ALL PRIVATE STREETS ARE W/P.U.E. & CLV SEWER EASEMENT.

**DESERT OAK HOMES**

POST: BUCKLEY, SCHULZ & JERNIGAN ENGINEERING - SURVEYING - CONSTRUCTION SERVICES

901 N. Green Valley Pkwy. Suite 100 Henderson, NV 89014 Phone: 702/565-7275 Fax: 702/565-7280

**GRADING PLAN UNIT #1 DESERT OAK HOMES**

SHEET 07/08/98 06/04/98 06/23/98

DESIGNED BY: ER

CHECKED BY: ER

PROJECT NO.: 51558

SCALE: 1" = 40'

SHEET 4 OF 12 SHEETS DRAWING NO. 107Y-4581-1

REVISION

REV	DATE	BY	DESCRIPTION
1	5/11/99	REF	REVISE STORM DRAIN TO AVOID CONFLICT WITH W.L.
2	6/11/99	REF	REVERT TO ORIGINAL DESIGN FOR STORM SEWER
3	6/11/99	REF	REPLACE "ROLL CURB WITH WEDGE CURB"

