

- LEGEND:**
- 100.00 DESIGN ELEVATION
 - (100.00) EXISTING ELEVATION
 - FL FLOWLINE
 - TC TOP OF CURB
 - FG FINISH GRADE
 - DW DRIVEWAY
 - SB SIDEWALK
 - GB GRADE BREAK
 - FLOW LINE
 - 1 EXISTING CONTOUR (1' INTERVAL)
 - 5 EXISTING CONTOUR (5' INTERVAL)
 - RETAINING WALL
 - BLOCK WALL
 - STREET CENTERLINE
 - (PAD=72.87) FUTURE PAD ELEV
 - NEW PAVEMENT
 - PAVEMENT REPLACED

NOTE: BLOCKWALLS & RETAINING WALLS TO BE CLV STD DWG. CLV-102 & CLV STD DWG. TITLED "REGULAR C.M.U. & MORTARLESS HEADJOINT MASONRY WALL".

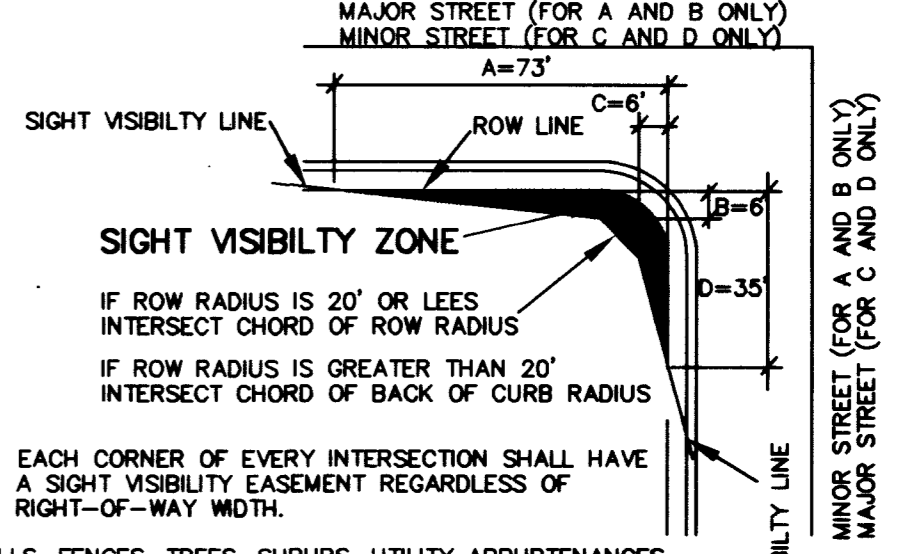

NOTE: EACH CORNER OF EVERY INTERSECTION SHALL HAVE A SIGHT VISIBILITY EASEMENT REGARDLESS OF RIGHT-OF-WAY WIDTH.

NO WALLS, FENCES, TREES, SHRUBS, UTILITY APPURTENANCES OR ANY OTHER OBJECT, OTHER THAN TRAFFIC CONTROL DEVICES AND STREETLIGHT POLES, MAY BE CONSTRUCTED OR INSTALLED WITHIN THE SITE VISIBILITY ZONE UNLESS SAID OBJECT IS MAINTAINED AT LESS THAN 24 INCHES IN HEIGHT, MEASURED FROM TOP OF CURB, OR WHERE NO CURB EXISTS, A HEIGHT OF 27 INCHES MEASURED FROM THE TOP OF ADJACENT ASPHALT, GRAVEL, OR PAVEMENT SURFACE.

TYPICAL INTERSECTION CORNER

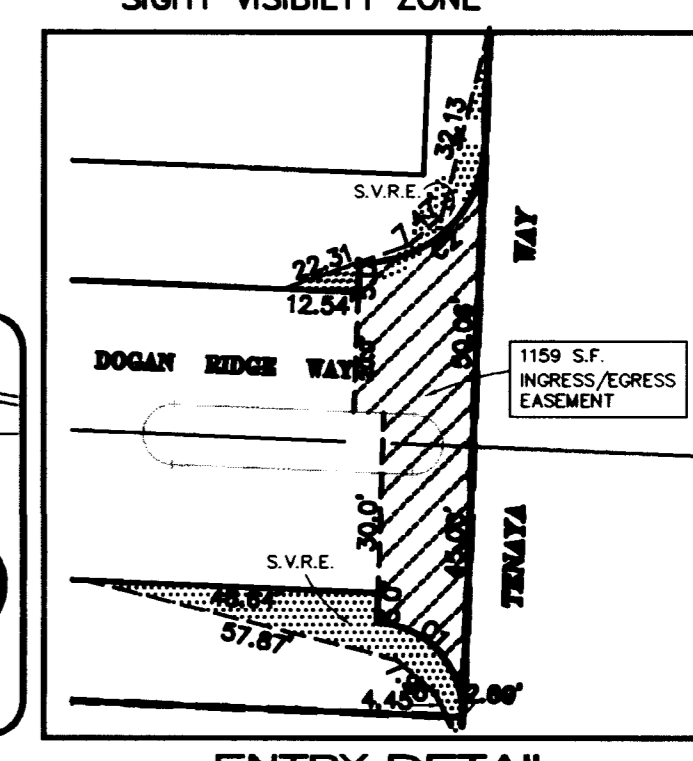

ENTRY DETAIL

Call before you Dig
1-800-227-2600
UNDERGROUND SERVICE ALERT (USA)

Call before you OVERHEAD
1-702-593-6111
NEVADA POWER ENVIRONMENT AND SAFETY SERVICES DEPARTMENT

CURVE TABLE

No.	RADIUS	DELTA	LENGTH	TANGENT
C1	20.00	90°00'00"	31.42	20.00
C2	20.00	90°00'00"	31.42	20.00
C3	55.00	90°00'00"	86.36	55.00
C4	4.00	180°00'00"	12.57	
C5	35.00	90°00'00"	54.98	35.00
C6	15.00	90°00'00"	23.56	15.00
C7	40.50	282°29'44"	199.65	
C8	40.50	79°30'10"	56.20	33.99
C9	40.50	79°30'10"	56.20	31.88
C10	40.50	86°17'03"	62.40	39.51
C11	40.50	38°17'45"	27.07	14.05
C12	28.00	51°14'52"	25.36	11.99
C13	40.50	28°18'38"	18.57	9.45
C14	40.50	80°18'28"	58.74	34.15
C15	40.50	69°24'18"	48.18	28.13
C16	40.50	81°23'41"	57.56	34.88
C17	40.50	24°53'44"	17.80	8.94
C18	44.00	90°42'50"	68.66	44.50
C19	25.00	90°42'50"	38.58	25.31

LINE TABLE

No.	BEARING	DISTANCE
L1	N02°21'03"E	5.00
L2	N87°38'57"W	40.00
L3	N87°38'57"W	30.00
L4	N87°38'57"W	24.00
L5	N87°38'57"W	20.00
L6	N02°21'03"E	38.00
L7	N87°30'01"E	5.00

CONSTRUCTION NOTES

- ① HANDICAP RAMP PER CCA STD. DWG. 235, CASE # A-B B-B
- ② 127.5 LF 24" ① CLASS RCP @ 0.5%

I CERTIFY THAT THIS GRADING PLAN CONFORMS TO THE APPROVED DRAINAGE STUDY FOR THIS SITE ON FILE WITH CLV FLOOD CONTROL.

EDWARD M. RAJNOVICH P.E. NO. 10149
DATE 2/16/99

PROJECT BENCHMARK
CITY LAS VEGAS BENCHMARK #48
ST. 11V9022W6, RIVET & PLATE ON POWER - TRANS PAD 500' EAST OF BUFFALO DR. @ 7535 W. DEER SPRINGS RD. ELEV. = 727.8646 M. (NAVD 88)
ELEV. = 2385.6000 FT.

BASIS OF BEARING
SOUTH 88°32'51" EAST - BEING THE NORTH LINE OF THE NORTHWEST QUARTER (NW 1/4) OF SECTION 22, TOWNSHIP 19 SOUTH, RANGE 60 EAST, M.D.M., CLARK COUNTY, NEVADA AS SHOWN IN BOOK 74 OF PLATS PAGE 53 OFFICIAL RECORDS, CLARK COUNTY, NEVADA

NOTE
CONTRACTOR TO VERIFY LOCATION AND ELEVATION OF ALL EXISTING UNDERGROUND UTILITIES PRIOR TO CONSTRUCTION. NOTIFY THE ENGINEER OF ANY DISCREPANCIES.

NOTE - PRIVATE STREETS
ALL PRIVATE STREETS ARE W/P.U.E. & CLV SEWER EASEMENT.

DESERT OAK HOMES

DESIGNER: JOHN J. DOPILNO, JR. CIVIL ENGINEER (No. 13559)

DATE: 2/10/99

SHEET G1 4 OF 12 SHEETS

DRAWING NO. 1074-4581-1

REV.	DATE	BY	REVISION
1	2/10/99	EMR	REVISION
2	2/10/99	EMR	REVISION
3	2/10/99	EMR	REVISION
4	2/10/99	EMR	REVISION
5	2/10/99	EMR	REVISION

