

H:\CAD\LANDDEV\5069\SWR-ALT\B 08-15-1997 03:37:54 pm Plotted by: dtb

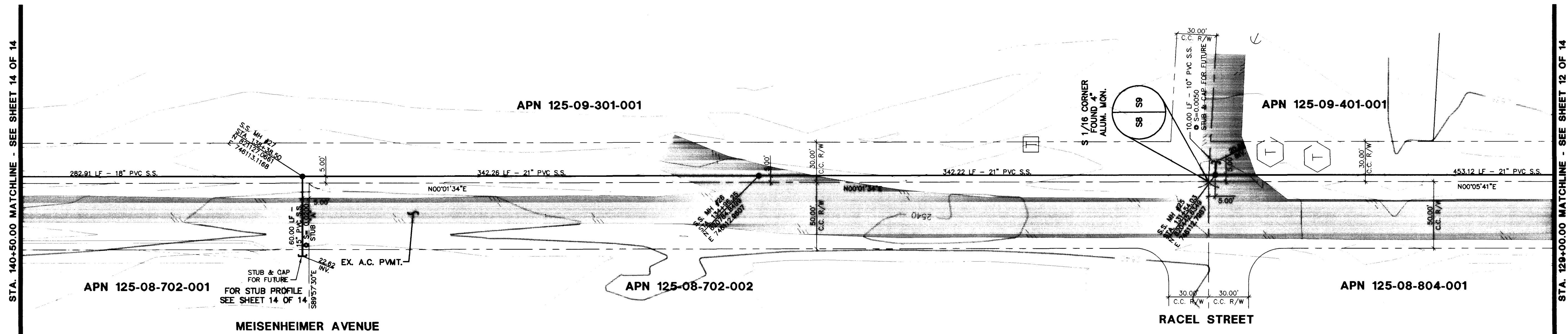
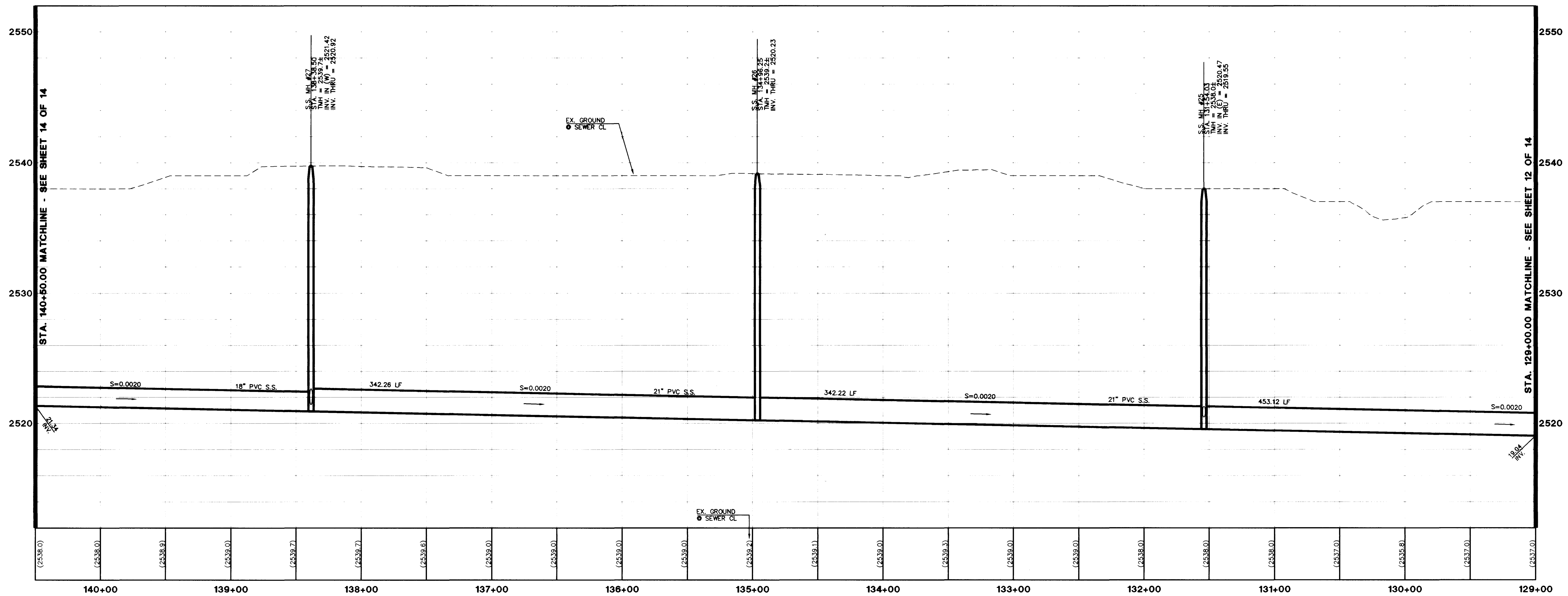

Avoid cutting underground utility lines. It's costly.
Call before you Dig
 1-800-227-2600

Avoid overhead power line contact.
Call before you OVERHEAD
 1-702-593-6111

BENCHMARK
 CLV BM NO. 7, STA. 1LV9017NES
 BLM BRASS CAP AT DURANGO DRIVE AND GRAND TETON DRIVE.
 ELEVATION = 2541.392 (NAVD 88)

NOTES:
 1. ALL STATIONING IS BASED ON SEWER LENGTHS FROM MANHOLE TO MANHOLE.
 2. ALL WORK PERFORMED WITHIN CLARK COUNTY RIGHT OF WAY REQUIRES A CLARK COUNTY PERMIT.

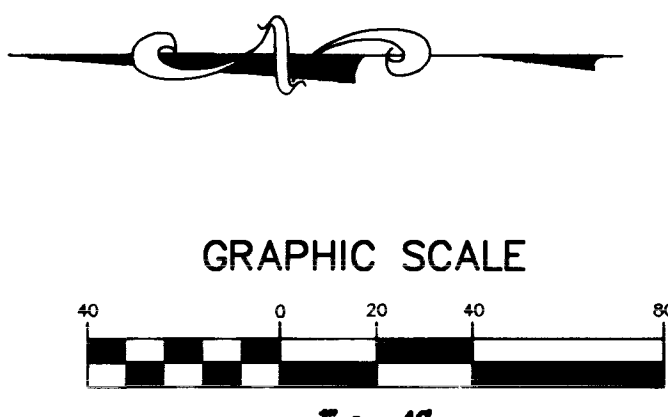

SOUTHWEST COMMUNITIES, INC.
 980 BROADBENT BOULEVARD
 HENDERSON, NEVADA 89014
 CITY OF LAS VEGAS, NEVADA

CONSULTING ENGINEERS • PLANNERS • LAND SURVEYORS
 2727 SOUTH RAINBOW BOULEVARD
 LAS VEGAS, NEVADA 89102-5148 PHONE (702) 873-7550 FAX (702) 362-2597

vtn novada

REV	DATE	BY	REVISION
1			
2			
3			
4			

PLAN AND PROFILE
DURANGO DRIVE
STA. 129+00.00 TO STA. 140+50.00
SPRING MOUNTAIN RANCH
(OFFSITE SEWER - ALTERNATE "B")

SEAL
 PROFESSIONAL ENGINEER - STATES
 THOMAS E. HAMES
 CIVIL
 No. 9426 NOV 1988
 8/15/97

WO NO. **5089**
 BY **dtb**
 DATE **APRIL 1997**
 SCALE HORIZ. 1" = 40'
 VERT. 1" = 4'
 SHEET **13** OF 14 SHEETS

3074-4518-05-B

