

BENCH MARK
 BM# 06024 C-1 - BOLT & PLATE IN TOP OF CURB LOCATED AT THE SE CORNER OF CARL AVE. & MALLARD AVE. CITY OF LAS VEGAS DATUM. ELEVATION 2266.85

STREET LIGHT NOTE
 All street light installations shall conform to the standard details and specifications of the City of Las Vegas, and shall also conform to the Uniform Standard Specifications for Public Works Construction of Off-Site Improvements, Clark County Area, latest edition, unless otherwise noted.

- GENERAL NOTES**
- All construction and materials shall be in accordance with the "Uniform Standard Specifications for Public Works Construction of Off-Site Improvements, Clark County Area, Nevada, latest issue; the "Uniform Standard Drawings for Public Works Construction, City of Las Vegas"; any other applicable approved standards issued by the controlling agency; the Clark County Code; and all local City codes and ordinances applicable.
 - The existence and location of any underground utility lines or structures shown on these plans are indicated by a search of the available records. The contractor is required to take reasonable measures to protect the utility lines shown and any other lines not of record or not shown on these drawings. Existing utility lines are located on plans only for the convenience of the contractor. Existing utility service laterals are not shown on the plans.
 - The contractor shall take all precautionary measures necessary to protect existing improvements which are to remain in place, from damage, and all such improvements or structures damaged by the contractor's operations shall be repaired or reconstructed satisfactory to the owner at the expense of the contractor.
 - The contractor shall not backfill any trenches in which waterlines have been uncovered until the waterlines have been inspected by the Las Vegas Valley Water District. The Water District shall be notified 48 hours in advance of construction in the vicinity of water lines.
 - All construction shall be as shown on these plans, any alterations shall have the prior written approval of the City Engineer.
 - Type V cement shall be used in all off-site concrete work. Concrete to be designed for a 3.5 inch min with a maximum water/cement ratio of 0.45 for as detailed by the Soils Engineer. Mix design to be approved by the quality control firm prior to use on the project.
 - The contractor shall, at his own expense, locate all overhead interferences which may affect his operation during construction. The contractor shall use extreme care to avoid damage to same. The contractor shall use extreme care to locate and mark overhead or underground power and/or telephone facilities as far as safely protect all personnel and equipment, and shall be responsible for all costs and liability in connection therewith.
 - Permits are required for any work in the public right of way. The contractor shall secure all permits and inspections required for this construction.
 - Expansion joints required, maximum every 300' in extended type curbs.
 - AC pavement to be 1/2" above top of all curbs and valley gutter after completion.
 - Apply fog seal only after all corrections and adjustments have been made.
 - Curbs and gutter with a grade of less than four tenths of one percent shall be constructed by forming. Each joint shall be checked for grade prior to construction and water tested as soon as possible after construction.
 - Wheelchair ramps shall be constructed in each quadrant of an intersection per standard drawing 22A. Exact location of ramp may be adjusted in the field by a city inspector.
 - Contractor shall provide all necessary horizontal and vertical rebar to provide for proper drainage and for ingress and egress to said construction. Exact dimensions to be determined by the City Engineer and as shown on plans.
 - All grading work shall conform to the soil report as prepared by the Soils Engineer or per these plans.
 - Exact location of all avenue lines may be determined in field by a City of Las Vegas Inspector. If location on plans is not clearly shown, or existing pavement condition requires relocation.
 - The contractor shall take all precautions necessary to protect existing permanent survey monuments. Any monument disturbed shall be replaced and adjusted as available records in accord with N.R.S. Statute No. 223.550.

Call before you Dig.
 1-800-227-2600

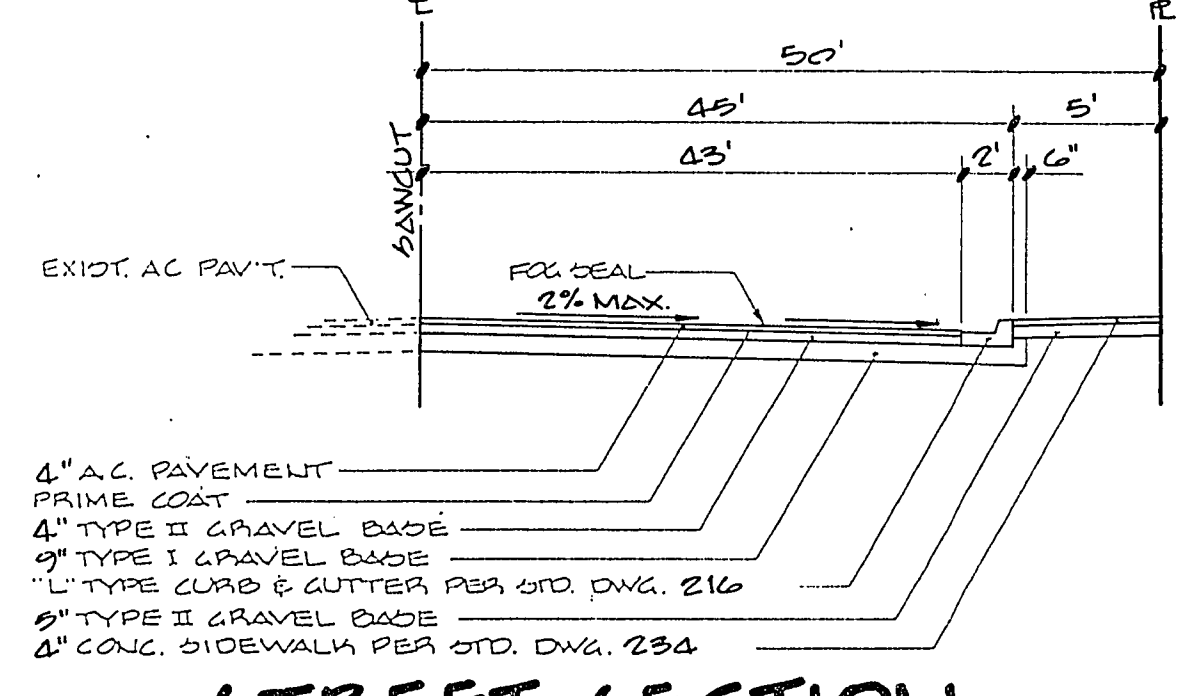

STREET SECTION

NOTE:
 COORDINATE CONSTRUCTION WITH "SHADOW HILLS" SHOPPING CENTER UNDER CONSTRUCTION NORTH SIDE OF LAKE MEAD BLVD.

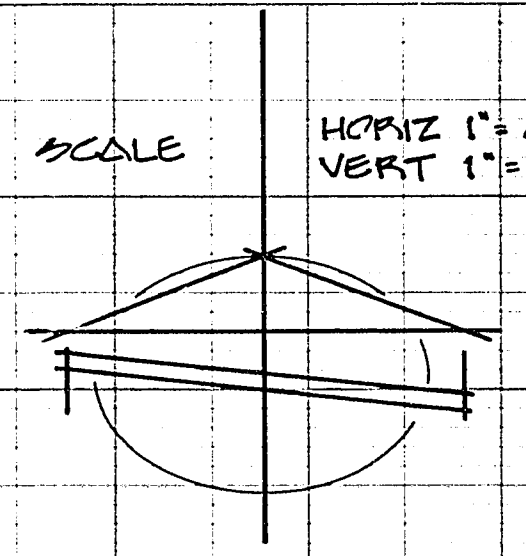
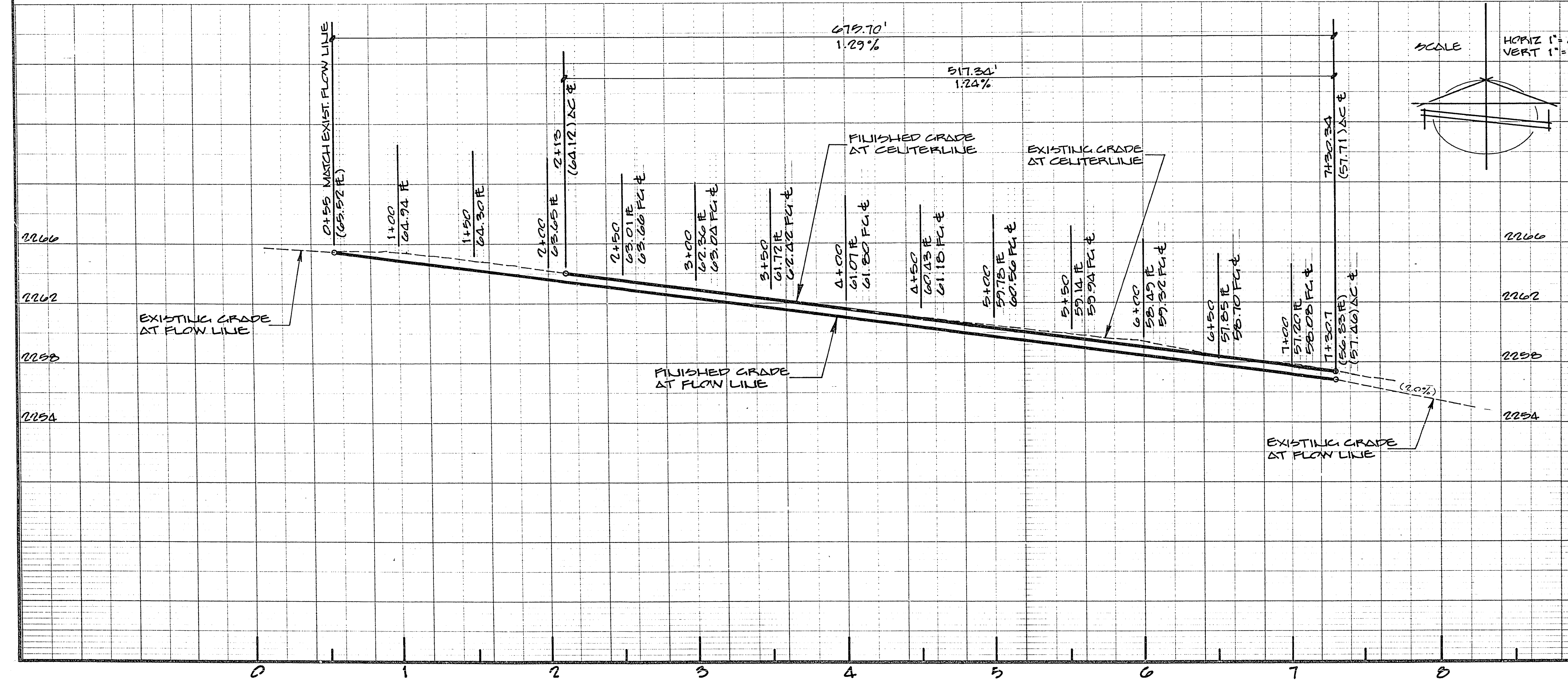

APPROVALS

SEE SHEET C1.1	DATE
CLV TRAFFIC ENGINEER	DATE
SEE SHEET C1.1	DATE
CLV ELECTRICAL SUPERVISOR	DATE
SEE SHEET C1.1	DATE
CLV ELECTRICAL COORDINATOR	DATE
SEE SHEET C1.1	DATE
CLV LAND DEVELOPMENT	DATE
SEE SHEET C1.1	DATE
CLV ENGINEER	DATE
NEVADA POWER	5/12/88 DATE

OFF-SITE (TO INCL. JONES BLVD.) ESTIMATED QUANTITIES

4" AC PAVEMENT	5,220 SQ. YDS
TYPE I GRAVEL BASE	1,138 CU. YDS
TYPE II GRAVEL BASE	457 CU. YDS
1" TYPE CURB & GUTTER	637 L.F.
4" CONC. SIDEWALK	4,037 SQ. FT.
STREET LIGHT	5 EA.
SAWCUT	290 L.F.
DRIVEWAYS	840 SQ. FT.

APP'D

REVISIONS

DATE

PREPARED FOR: THE BERRY & BERRY ASSOC.

DATE: APRIL 22, 1988

DESIGN: BAUGHMAN & TURNER

DRAWN: ANNA

CHECK: ANNA

SCALE: 1" = 40' VERT, 1" = 40' HORIZ

CIVIL ENGINEERS

MINING ENGINEERS

LAND SURVEYORS

3235 WEST CHELSEA BLVD.

LAS VEGAS, NEVADA 89025

702-735-1271

STREET & STREET LIGHT DESIGN

SECTION: 24-TOWNSHIP 20 SOUTH, RANGE 06 EAST, M.D.P. 4 M.

CITY OF LAS VEGAS

SILVER PALM APARTMENTS

SHEET: C1.5 OF 5

PROJ. NO: FB157PPT

107-V1570