

WATER QUANTITIES

8" WATER (PRIVATE)	3711 L.F.
8" WATER (PUBLIC)	1384 L.F.
8" GATE VALVE (PRIVATE)	9 EA.
8" TEE (PRIVATE)	4 EA.
8" 90° (PRIVATE)	6 EA.
8" 45° (PRIVATE)	4 EA.
8" 22.5° (PRIVATE)	2 EA.
8"x6" REDUCER (PRIVATE)	4 EA.
STANDARD F.H. ASSEMBLY (PRIVATE)	8 EA.
6"x2" METER W/ 8" D.C.V.A. (PUBLIC)	2 EA.

SEWER QUANTITIES

8" SEWER (PUBLIC)	2050 L.F.
48" SEWER MANHOLE (PUBLIC)	5 EA.
8" SEWER (PRIVATE)	892 L.F.
48" SEWER MANHOLE (PRIVATE)	2 EA.
6" CLEAN-OUT (PRIVATE)	2 EA.

STREET LIGHT QUANTITIES (PUBLIC)

150 W HPS	4 EA.
250 W HPS	4 EA.
1 1/4" CONDUIT W/ CABLE	1350 L.F.

SEWER CONTRIBUTION (PUBLIC)

AVERAGE FLOW = 24,500 GALLONS PER DAY
 PEAK FLOW = AVG FLOW X PEAKING FACTOR(3.0)
 PEAK FLOW = 87,500 GALLONS PER DAY

NOTE: ALL ON SITE SEWERS AND STORM DRAINS ARE TO BE PRIVATELY OWNED AND MAINTAINED.

APPROVALS:

Amie M. Hill
 CITY OF LAS VEGAS FIRE MARSHALL
 FOR TEMPORARY WATER CONNECTION ONLY
 DATE: 7-9-98

Paul R. Bault
 LAS VEGAS VALLEY WATER DISTRICT
 DATE: 7-9-98

NEVADA POWER COMPANY
 THIS APPROVAL IS ONLY FOR THE PLACEMENT AND CLEARANCE OF STREET LIGHT AND SIGNAL LIGHT INSTALLATIONS.

SEWER CONNECTION NOTE:

ONE OR MORE SEGMENTS OF THE DOWNSTREAM SEWER SYSTEM THAT WILL SERVE THIS PROJECT HAS NOT BEEN COMPLETED AND/OR ACCEPTED FOR MAINTENANCE BY THE CITY OF LAS VEGAS. ANY WORK DONE ON THIS PROJECT PRIOR TO THE COMPLETION AND/OR ACCEPTANCE OF THE DOWNSTREAM SEWER SYSTEM(S) SHALL BE DONE AT THE DEVELOPER'S OWN RISK. THE CITY OF LAS VEGAS RESERVES THE RIGHT TO PREVENT THE PHYSICAL CONNECTION OF THIS PROJECT INTO THE DOWNSTREAM SEWER SYSTEM UNTIL ALL SEGMENTS HAVE BEEN COMPLETED AND ACCEPTED FOR MAINTENANCE, OR UNTIL SUCH TIME AS THEY ARE DEEMED AVAILABLE FOR SERVICE.

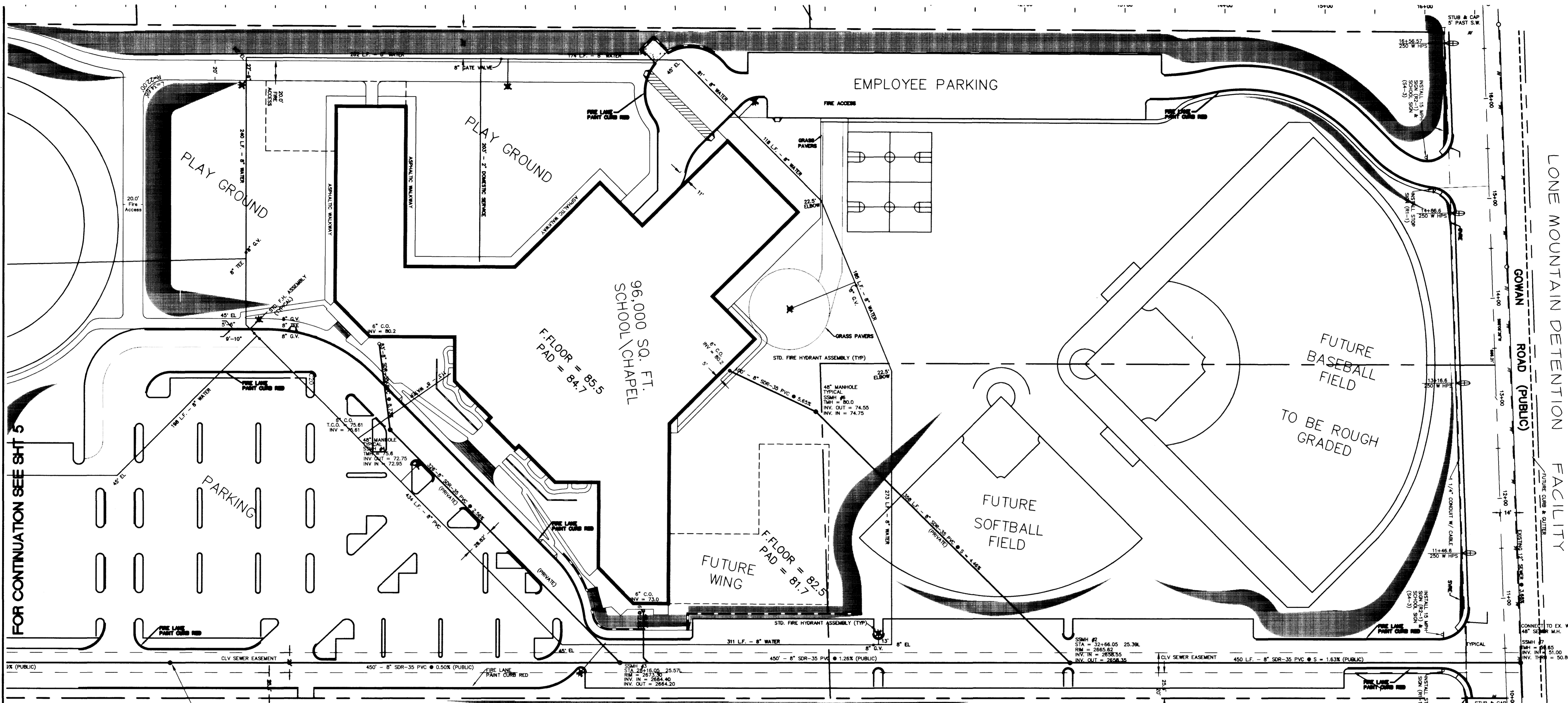
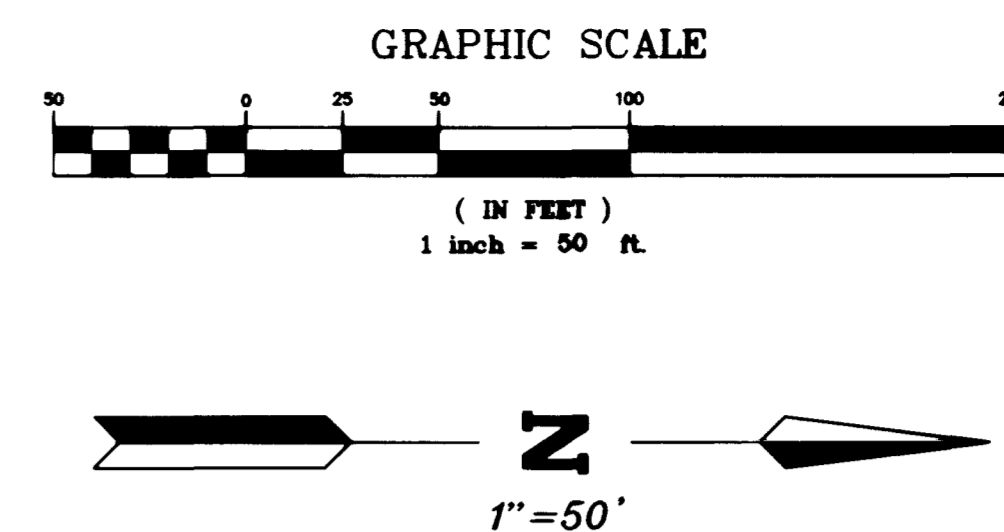

FOR CONTINUATION SEE SHT 5

CL.V. SEWER NOTES

- ALL CONSTRUCTION AND MATERIALS SHALL BE IN ACCORDANCE WITH THE LATEST EDITION OF THE DESIGN & CONSTRUCTION STANDARDS FOR WASTEWATER COLLECTION SYSTEMS AND THE UNIFORM STANDARD SPECIFICATIONS FOR PUBLIC WORKS' CONSTRUCTION OFF-SITE IMPROVEMENTS, CLARK COUNTY AREA, NEVADA, AS AMENDED. IN ALL CASES, THESE STANDARDS SHALL SUPERSEDE THE UNIFORM STANDARD SPECIFICATIONS. IT WILL BE THE RESPONSIBILITY OF THE CONTRACTOR TO BE AWARE OF THE CONTENTS OF THE ABOVE SPECIFICATION BOOKS.
- IT SHALL BE THE CONTRACTOR'S RESPONSIBILITY TO PERFORM CONSTRUCTION AS PER PLANS. ANY ADDITIONS, DELETIONS, OR CHANGES SHALL FIRST MEET WITH THE APPROVAL OF THE CITY ENGINEER.
- CHISEL "S" OR "G" IN CURBS WHERE SEWER OR GAS LATERALS PASS UNDER THE CURB.
- POLYVINYL (PVC) SEWER PIPE SHALL MEET ASTM D-3034 SDR 35 SPECIFICATIONS, INSTALLED WITH SAND BEDDING AND BACKFILL OF TYPE II GRAVEL AGGREGATE BASE.
- ALL MANHOLES IN PAVED STREETS 90' R/W AND LARGER SHALL HAVE CONCRETE COLLARS. STREETS LESS THAN EIGHTY (80') FOOT R/W WILL REQUIRE RETROFIT IF PAVING DOES NOT CONFORM TO CITY STANDARDS AT THE MANHOLE.
- TEE SADDLES SHALL BE USED TO CONNECT SEWER LATERALS TO EXISTING MAIN LINES UP TO 12" DIA. SIZE. CONNECTIONS TO 15" OR LARGER MAINS SHALL REQUIRE SPECIAL PROCEDURES. IN LINE "Y" S SHALL BE USED ON LINES TWELVE INCHES (12") OR ABOVE.
- A SEWER MAIN CROSSING OVER A WATER MAIN OR LESS THAN 18" UNDER A WATER MAIN, MUST BE REINFORCED CONCRETE ENCASED FOR A DISTANCE NOT LESS THAN TEN FEET (10') TO EACH SIDE OF THE CENTERLINE OF THE WATER MAIN.
- ALL CONTRACTORS INSTALLING SEWER MAINS THAT WILL BE UNDER THE JURISDICTION OF THE CONTROLLING AGENCY MUST BE CLASS "A" CONTRACTORS.
- THE CITY OF LAS VEGAS WILL NOT ACCEPT ANY SEWER MAINS WHICH HAVE A VERTICAL DEFLECTION OF MORE THAN ONE-TENTH (0.1) OF A FOOT FROM APPROVED CONSTRUCTION PLANS. SEWER MAINS FOUND TO EXCEED THIS TOLERANCE WILL HAVE TO BE REPAIRED OR REMOVED AND REPLACED TO THE SATISFACTION OF THE CITY ENGINEER PRIOR TO ACCEPTANCE BY THE CITY.
- INSTALLATION OF CURVED SEWER REQUIRES SPECIAL CONSTRUCTION PROCEDURES AND INSPECTIONS. CONTACT CITY OF LAS VEGAS CONSTRUCTION SERVICES 24 HOURS PRIOR TO INSTALLATION.

CL.V. STREETLIGHT NOTES

- ALL STREET LIGHTING INSTALLATIONS SHALL BE IN ACCORDANCE WITH THE STREET LIGHTING PLANS, THE "UNIFORM STANDARD SPECIFICATIONS FOR PUBLIC WORKS' CONSTRUCTION OFF-SITE IMPROVEMENTS, CLARK COUNTY AREA, NEVADA", LATEST REVISION, AND THE "UNIFORM STANDARD DRAWINGS FOR PUBLIC WORKS' CONSTRUCTION OFF-SITE IMPROVEMENTS, CLARK COUNTY AREA, NEVADA", LATEST REVISION.
- NO DEVIATION OF STREET LIGHT, PULL BOX, CONDUITS (ETC.) LOCATIONS SHALL BE PERMITTED WITHOUT WRITTEN APPROVAL OF THE CITY TRAFFIC/ELECTRICAL FIELD OPERATIONS DIVISION AND THE CITY ENGINEER. ANY DEVIATION FROM THE PLAN LOCATION WILL REQUIRE COMPLIANCE WITH SECTION 623.10.03 (E) OF THE SPECIFICATIONS.
- ALL EXISTING STREET LIGHTING SHALL REMAIN OPERATIONAL DURING CONSTRUCTION.
- ALL EMPTY CONDUIT SHALL HAVE PULL STRINGS INSTALLED PRIOR TO FINAL INSPECTION.
- ANY STRUCTURE SUCH AS BLOCK WALLS, CHAIN LINK FENCES, RETAINING WALLS, ETC., SHALL LEAVE A MINIMUM CLEARANCE OF EIGHTEEN INCHES (18") TO THE FACE OF STREET LIGHTING POLE ON ALL SIDES WHEN STREETLIGHT IS INSTALLED BEHIND SIDEWALK, AND SHALL AT NO TIME COMPLETELY ENCLOSE THE STREET LIGHTING POLE.
- AS-BUILT DRAWINGS SHALL BE SUPPLIED TO THE ELECTRICAL SERVICES SECTION PRIOR TO ANY PER FINAL INSPECTION. THE AS-BUILT DRAWING NEEDS TO BE STAMPED AS-BUILT AND SIGNED BY THE PREPARER.
- SERVICE POINT SHALL BE COORDINATED WITH NEVADA POWER COMPANY, AND WHEREVER POSSIBLE, BE LOCATED NEAR THE CENTER OF THE CIRCUIT. THIS SHALL BE THE CONTRACTOR'S RESPONSIBILITY.
- IT SHALL BE ASSUMED THAT IN THE ABSENCE OF AN EXISTING WORKABLE CIRCUIT TO ATTACH TO, ALL INSTALLATIONS SHALL REQUIRE A NEW SERVICE FOR OPERATION OF THE CIRCUIT.
- WHEREVER THERE IS AN OVERHEAD UTILITY THAT MAY CONFLICT WITH THE INSTALLATION OF STREET LIGHTING CIRCUITS AND/OR POLES, THESE CONFLICTS MUST BE RESOLVED BETWEEN THE DEVELOPER AND THE UTILITIES INVOLVED BEFORE STREETLIGHT BASES ARE INSTALLED AT NO EXPENSE TO THE CITY OF LAS VEGAS.
- THE CONTRACTOR SHALL FURNISH COMPLETE SERVICE TO TRANSFORMERS AND CONTROL SYSTEMS IF REQUIRED ON PLANS.

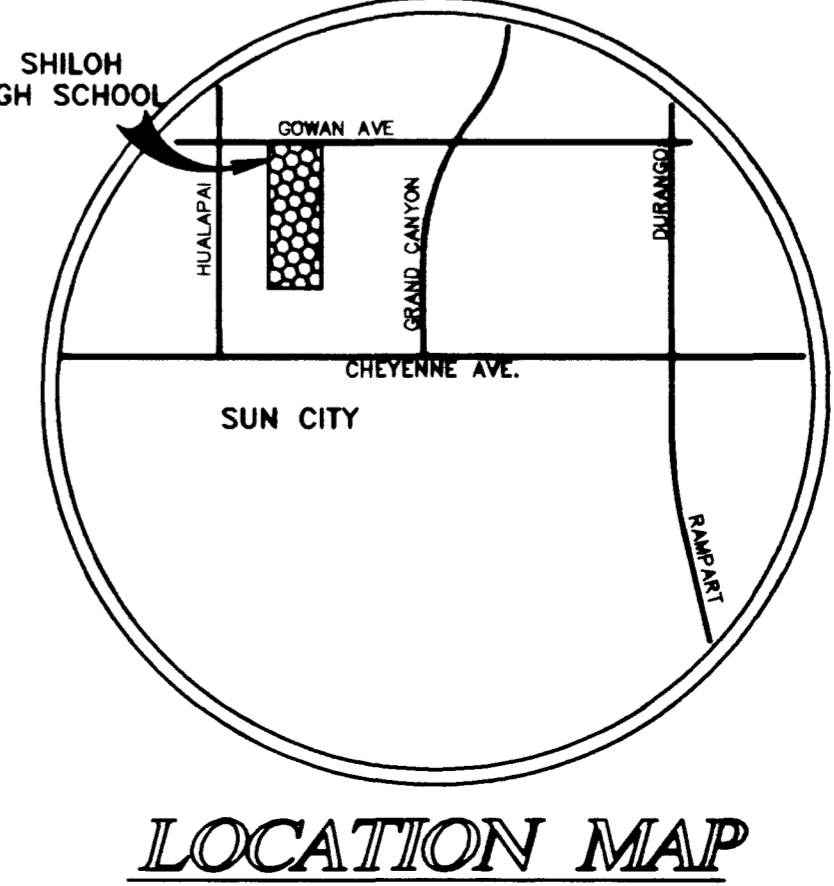

NOTICE!
 EXISTING UTILITIES ARE SHOWN ON PLANS FOR THE CONTRACTOR'S USE ONLY. THE CONTRACTOR IS RESPONSIBLE FOR THE PROTECTION OF ALL UTILITIES. THE ENGINEER BEARS NO RESPONSIBILITY FOR UTILITIES NOT SHOWN OR SHOWN INACCURATELY.

BEFORE YOU DIG
 CALL 1-800-227-2800

SHILOH CHRISTIAN SCHOOL

West Charleston Baptist Church
 6701 WEST CHARLESTON BOULEVARD
 LAS VEGAS, NEVADA 89102
 Telephone: (702) 295-4439

ALPHA & ENGINEERING COMPANY
 50 So. Jones #202, Las Vegas, NV, 89107
 Telephone: (702) 877-1300

MASTER UTILITY SHEET NORTH

DRAWN BY: RCV
 DESIGNED BY: RCV
 CHECKED BY: RCV
 PROJECT NO: 716101

SCALE: 1" = 40'

SHEET 6 OF 16 SHEETS
 DRAWING NO. 715-102

EDWARD F. TANEY
 PROFESSIONAL ENGINEER
 No. 9903

DATE DRAFTED
SCALE
PROJECT NO.

DATE DRAFTED
SCALE
PROJECT NO.

DATE DRAFTED
SCALE
PROJECT NO.

APPROVALS
 [Signature]
 [Signature]
 [Signature]

PROJECT DESCRIPTION NOTES
 [Text]

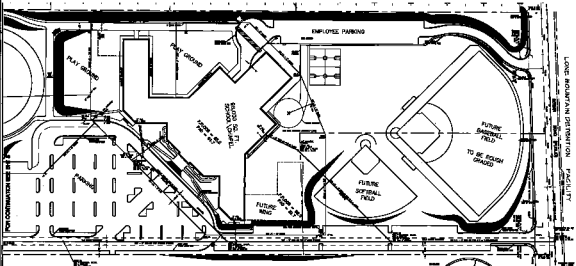

FOR CONTINUATION SEE SHEET 10

LONE MOUNTAIN DISTRI-PARK FACILITY

MELON CHRISTIAN SCHOOL West Charleston Road, Charleston, W. Va. 25303

MAINTENANCE DIVISION

ALPHA 06

CL.V. OWNER NOTES

- 1. ALL UTILITIES TO BE DELETED.
- 2. ALL UTILITIES TO BE DELETED.
- 3. ALL UTILITIES TO BE DELETED.
- 4. ALL UTILITIES TO BE DELETED.
- 5. ALL UTILITIES TO BE DELETED.
- 6. ALL UTILITIES TO BE DELETED.
- 7. ALL UTILITIES TO BE DELETED.
- 8. ALL UTILITIES TO BE DELETED.
- 9. ALL UTILITIES TO BE DELETED.
- 10. ALL UTILITIES TO BE DELETED.

- 1. ALL UTILITIES TO BE DELETED.
- 2. ALL UTILITIES TO BE DELETED.
- 3. ALL UTILITIES TO BE DELETED.
- 4. ALL UTILITIES TO BE DELETED.
- 5. ALL UTILITIES TO BE DELETED.
- 6. ALL UTILITIES TO BE DELETED.
- 7. ALL UTILITIES TO BE DELETED.
- 8. ALL UTILITIES TO BE DELETED.
- 9. ALL UTILITIES TO BE DELETED.
- 10. ALL UTILITIES TO BE DELETED.

CL.V. DISTRI-PARK NOTES

- 1. ALL UTILITIES TO BE DELETED.
- 2. ALL UTILITIES TO BE DELETED.
- 3. ALL UTILITIES TO BE DELETED.
- 4. ALL UTILITIES TO BE DELETED.
- 5. ALL UTILITIES TO BE DELETED.
- 6. ALL UTILITIES TO BE DELETED.
- 7. ALL UTILITIES TO BE DELETED.
- 8. ALL UTILITIES TO BE DELETED.
- 9. ALL UTILITIES TO BE DELETED.
- 10. ALL UTILITIES TO BE DELETED.

- 1. ALL UTILITIES TO BE DELETED.
- 2. ALL UTILITIES TO BE DELETED.
- 3. ALL UTILITIES TO BE DELETED.
- 4. ALL UTILITIES TO BE DELETED.
- 5. ALL UTILITIES TO BE DELETED.
- 6. ALL UTILITIES TO BE DELETED.
- 7. ALL UTILITIES TO BE DELETED.
- 8. ALL UTILITIES TO BE DELETED.
- 9. ALL UTILITIES TO BE DELETED.
- 10. ALL UTILITIES TO BE DELETED.



LOCATION MAP



DATE	BY



DATE PLOTTED
 PLOT NO.