

N  
SCALE: HORIZ. 1" = 40'  
VERT. 1" = 4'

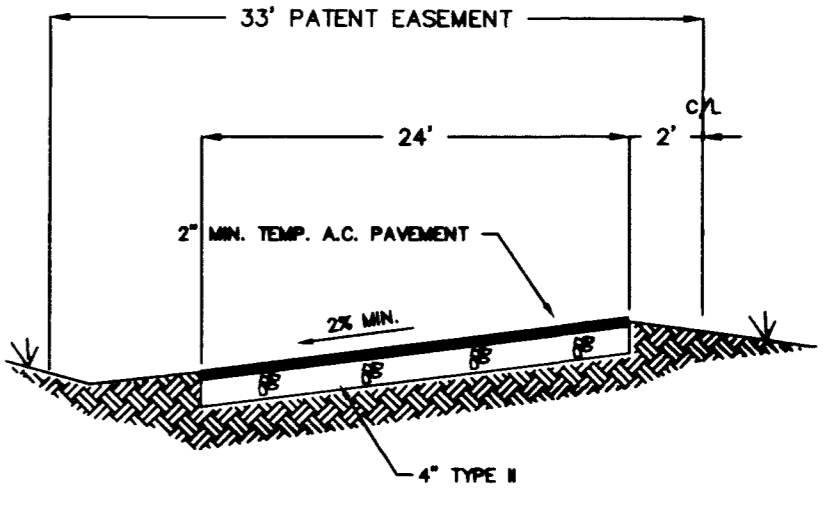
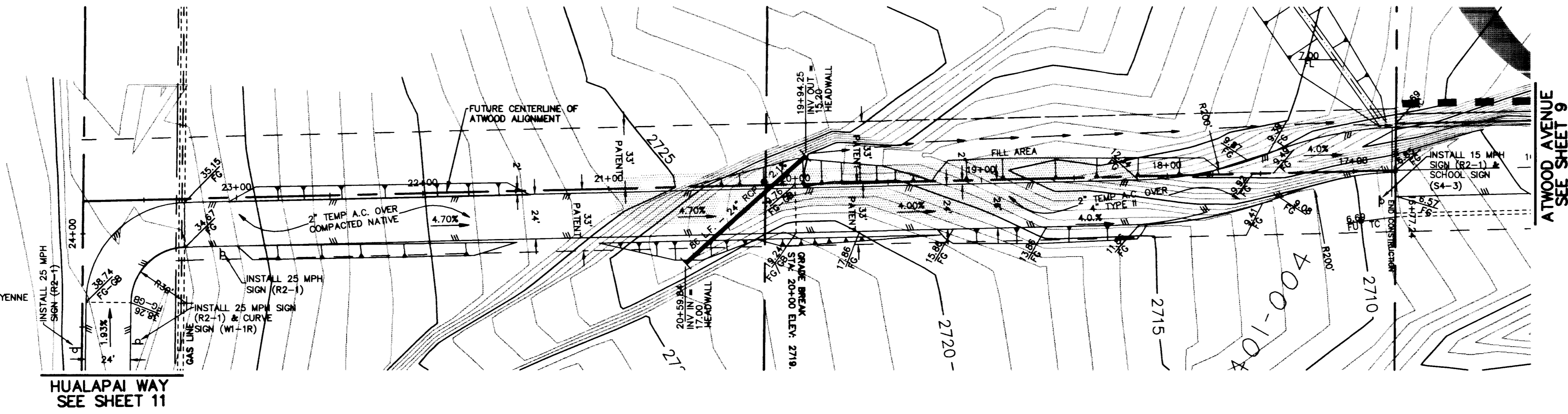

ATWOOD STREET ACCESS DRIVE

**BENCHMARK:**

CLARK COUNTY BENCHMARK #1C0017NNW6 - RIVET AND SQUARE ALUMINUM PLATE IN TOP OF CURB, ON THE SOUTH SIDE OF CHEYENNE AVENUE AND THE EXTENDED ALIGNMENT OF CAMBELL ROAD. ELEV. 768.043 METERS. (2519.82 NAVD 88)

METERS x (39.37 / 1200) = U.S. SURVEY FEET

**QUANTITIES THIS SHEET**

TEMP. 2" ASPHALTIC CONCRETE PAVING 1764 S.Y.  
24" STORM PIPE 86 L.F.

**BASIS OF BEARING:**

THE BASIS OF BEARING FOR THIS MAP IS THE WEST LINE OF THE SOUTHWEST QUARTER (SW 1/4) OF SECTION 7, TOWNSHIP 20 SOUTH, RANGE 60 EAST, MDM, BEING NORTH 00° 34' 03" EAST AS SHOWN IN THE OFFICE OF THE CLARK COUNTY, NEVADA RECORDER'S OFFICE IN FILE 69 OF SURVEYS ON PAGE 30.

**TEMPORARY ACCESS ROAD ATWOOD**

**NOTICE!**  
EXISTING UTILITIES ARE SHOWN ON PLANS FOR THE CONVE- NIENCE OF THE CONTRACTOR. ONLY. THE CONTRACTOR IS RESPONSIBLE FOR THE PRE- SENSATION OF ALL UTILITIES. THE ENGINEER ASSUMES NO RE- SONSIBILITY FOR UTILITIES NOT SHOWN OR SHOWN INCORRECTLY.

CALL BEFORE YOU DIG  
1-800-227-2800

<b>SHILOH CHRISTIAN SCHOOL</b> 6701 WEST CHARLESTON BOULEVARD LAS VEGAS, NEVADA 89102 (702) 295-4439		<b>West Charleston Baptist Church</b> 6701 WEST CHARLESTON BOULEVARD LAS VEGAS, NEVADA 89102 (702) 295-4439	
DRAWN BY: 04.30.98 RCY		DESIGNED BY: 04.30.98 RCY	
CHECKED BY: 04.30.98 RCY		PROJECT NO: 716101	
SCALE: 1"=40'		SHEET 10 OF 16 SHEETS DRAWING NO. 715-102	
<b>ALPHA &amp; COMPANY</b> ENGINEERING 50 So. Jones #202, Las Vegas, NV 89107 Telephone: (702) 877-1300		REV. DATE BY _____ _____ _____	

