

L:\1997\71610\171611MP Thu Jun 25 09:52:25 1998 Plotted by LOUIE

VIEW NAME: 9

ATWOOD AVENUE
SEE SHEET 10

FILE NAME: 71611MP.DWG

QUANTITIES THIS SHEET

3" ASPHALTIC CONCRETE PAVING	2070 S.F.
24" "L" CURB & GUTTER	518 L.F.
CROSS GUTTER	905 S.F.
HANDI CAP RAMP	60 S.F.
SIDEWALK	2,740 S.F.

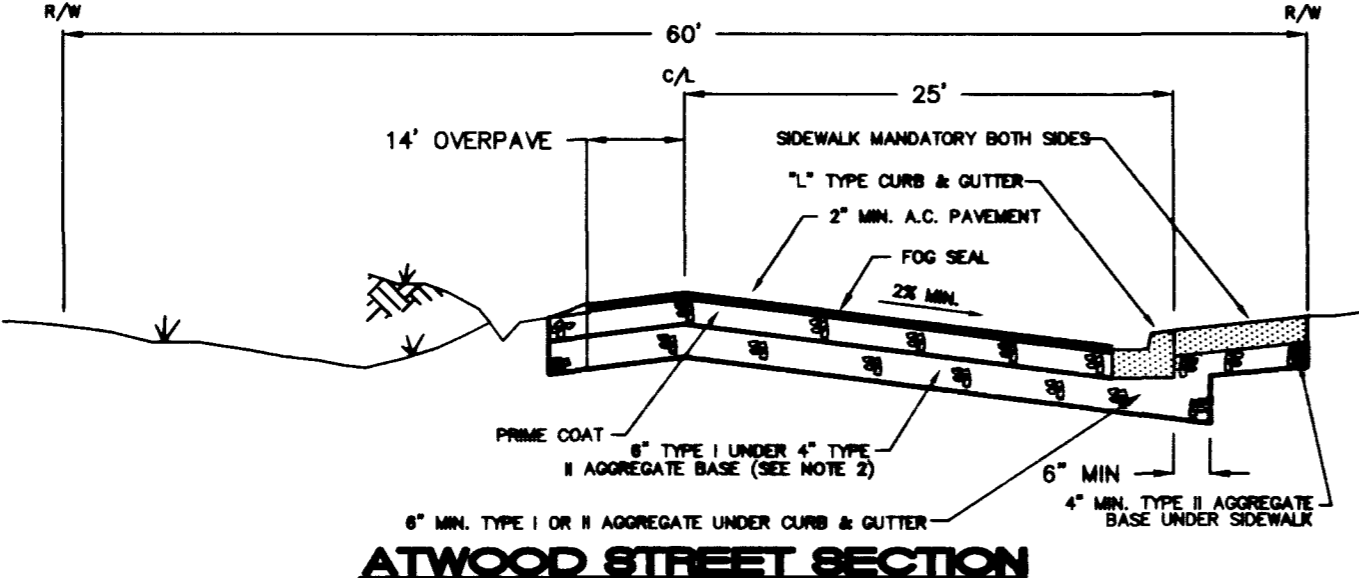
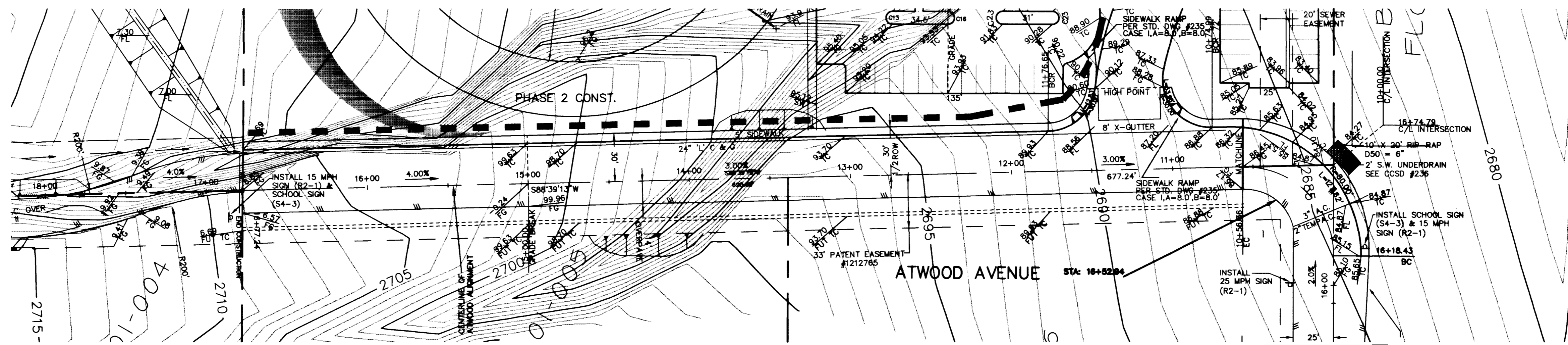
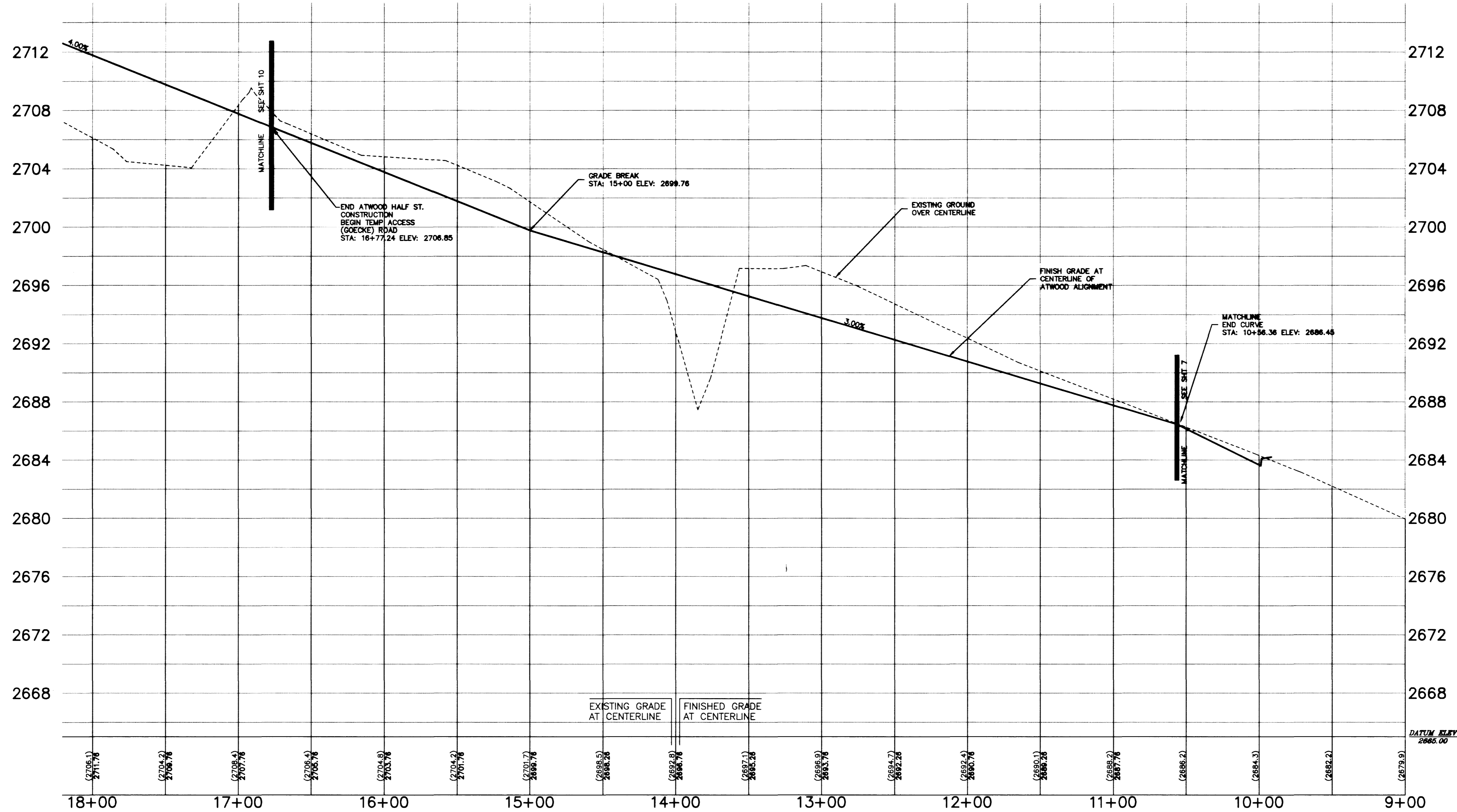

ATWOOD BENCHMARK:

CLARK COUNTY BENCHMARK #1C0017NNW6 - RIVT AND SQUARE ALUMINUM PLATE IN TOP OF CURB, ON THE SOUTH SIDE OF CHEYENNE AVENUE AND THE EXTENDED ALIGNMENT OF CAMBELL ROAD. ELEV. 768.043 METERS. (2519.82 NAVD 88)

METERS X (39.37 / 1200) = U.S. SURVEY FEET

BASIS OF BEARING:

THE BASIS OF BEARING FOR THIS MAP IS THE WEST LINE OF THE SOUTHWEST QUARTER (SW 1/4) OF SECTION 7, TOWNSHIP 20 SOUTH, RANGE 60 EAST, NDM, BEING NORTH 00° 34' 03" EAST AS SHOWN IN THE OFFICE OF THE CLARK COUNTY, NEVADA RECORDER'S OFFICE IN FILE 69 OF SURVEYS ON PAGE 30.

NOTICE!

EXISTING UTILITIES ARE SHOWN ON PLANS FOR THE CONVEYANCE OF THE CONTRACTOR ONLY. THE CONTRACTOR IS RESPONSIBLE FOR THE PROTECTION OF ALL UTILITIES. THE CONTRACTOR BEARS THE RESPONSIBILITY FOR UTILITIES NOT SHOWN OR SHOWN INCORRECTLY.

BEFORE YOU

Call DPs

1-800-227-2900

West Charleston Baptist Church
6701 WEST CHARLESTON BOULEVARD
LAS VEGAS, NEVADA 89102
(702) 295-4439

ALPHA &

ENGINEERING COMPANY
50 So. Jones #202, Las Vegas, NV, 89107
Telephone: (702) 877-1300

SHILOH CHRISTIAN SCHOOL

ATWOOD PLAN+PROFILE

DRAWN BY: RCV	04.30.98
DESIGNED BY: RCV	04.30.98
CHECKED BY: RCV	04.30.98
PROJECT NO: 716101	SCALE: 1"=40'

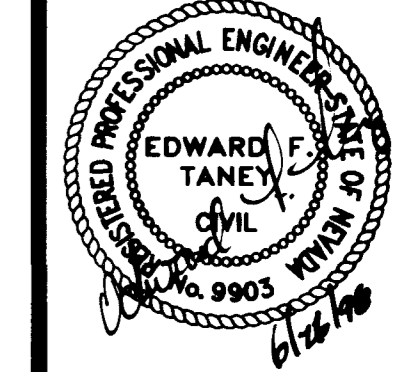

SHEET 9 OF 16 SHEETS
DRAWING NO. 715-102

REV	DATE	BY

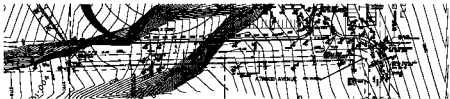
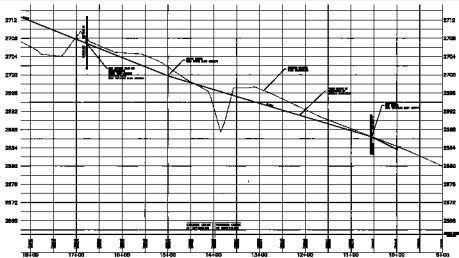

SCALE: HORIZ. 1" = 40'
VERT. 1" = 4'

QUANTITIES TO BE IN SET
 1. TOTAL SQUARE FEET
 2. TOTAL CUBIC YARDS
 3. TOTAL LINEAL FEET
 4. TOTAL WEIGHT
 5. TOTAL VOLUME
 6. TOTAL AREA

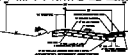

ATWOOD BENCHMARK
 THIS BENCHMARK IS THE BASIS OF BEARING FOR THE PROPOSED ROAD GRADE.
 THE BENCHMARK IS THE POINT OF BEGINNING FOR THE PROPOSED ROAD GRADE.

BASIS OF BEARING
 THE PROPOSED ROAD GRADE IS THE BASIS OF BEARING FOR THE PROPOSED ROAD GRADE.



		PROJECT NO. _____ SHEET NO. _____
DATE: _____ DRAWN BY: _____ CHECKED BY: _____ SCALE: _____	PROJECT NAME: ATWOOD PLAZA PROJECT NO.: _____ SHEET NO.: _____	PROJECT LOCATION: West Charleston, Fresno County, California PROJECT NO.: _____ SHEET NO.: _____
PROJECT NO.: _____ SHEET NO.: _____		PROJECT NAME: ALPHA 06 PROJECT NO.: _____ SHEET NO.: _____