

JOB NO. 62003.207

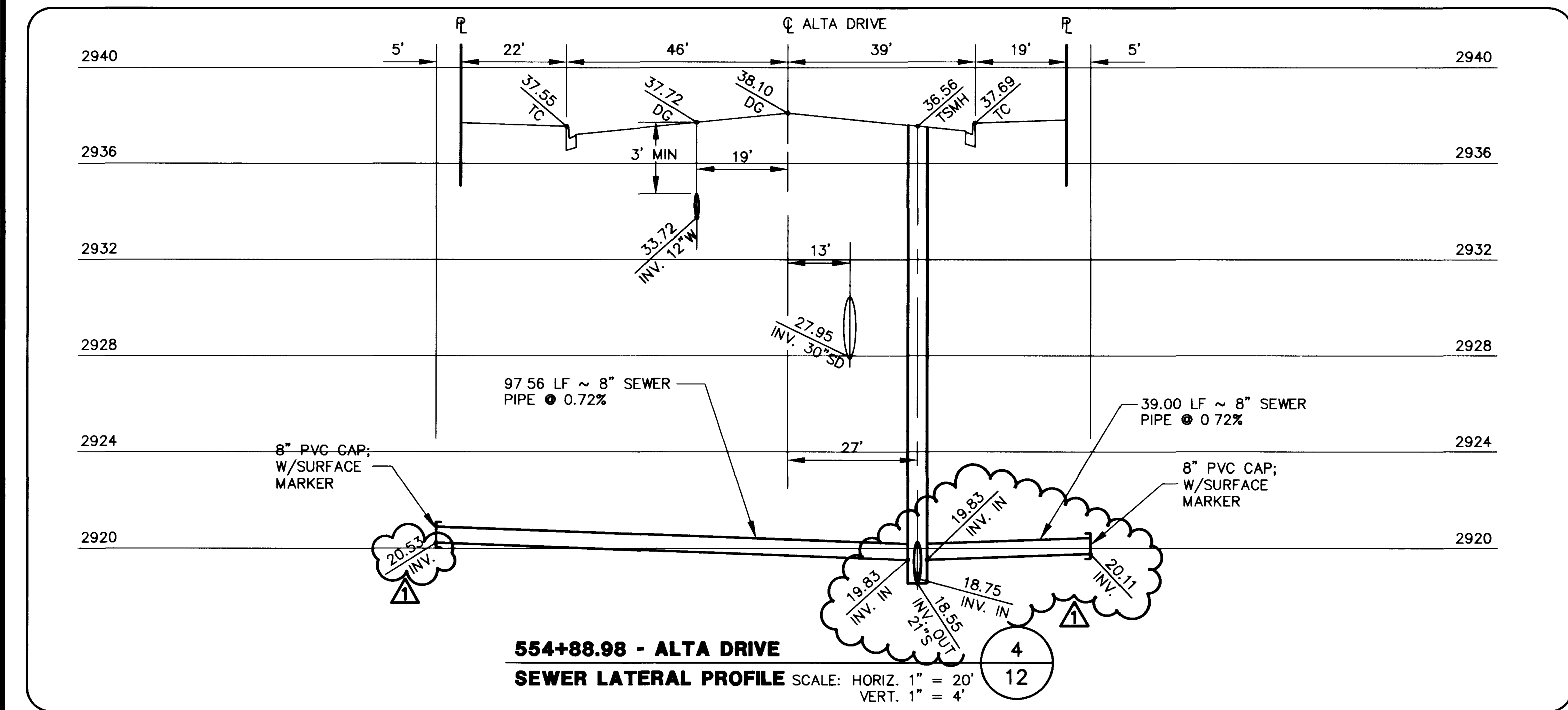

**RECORD DRAWINGS**

THESE PLANS SHOW RECORD INFORMATION RECEIVED FROM:  
 CONTRACTOR: WELLS, CARGO, INC. (WET UTILITY IMP.) 3/2/98  
 CONTRACTOR: WELLS, CARGO, INC. (ROADWAY IMPROVEMENTS) 3/2/98  
 THIS DATA MAY OR MAY NOT REFLECT THE ACTUAL FIELD LOCATIONS.  
 ALL DATA SHOULD BE CONFIRMED PRIOR TO USE ON DEVELOPMENT OR  
 ENGINEERING PLANS.

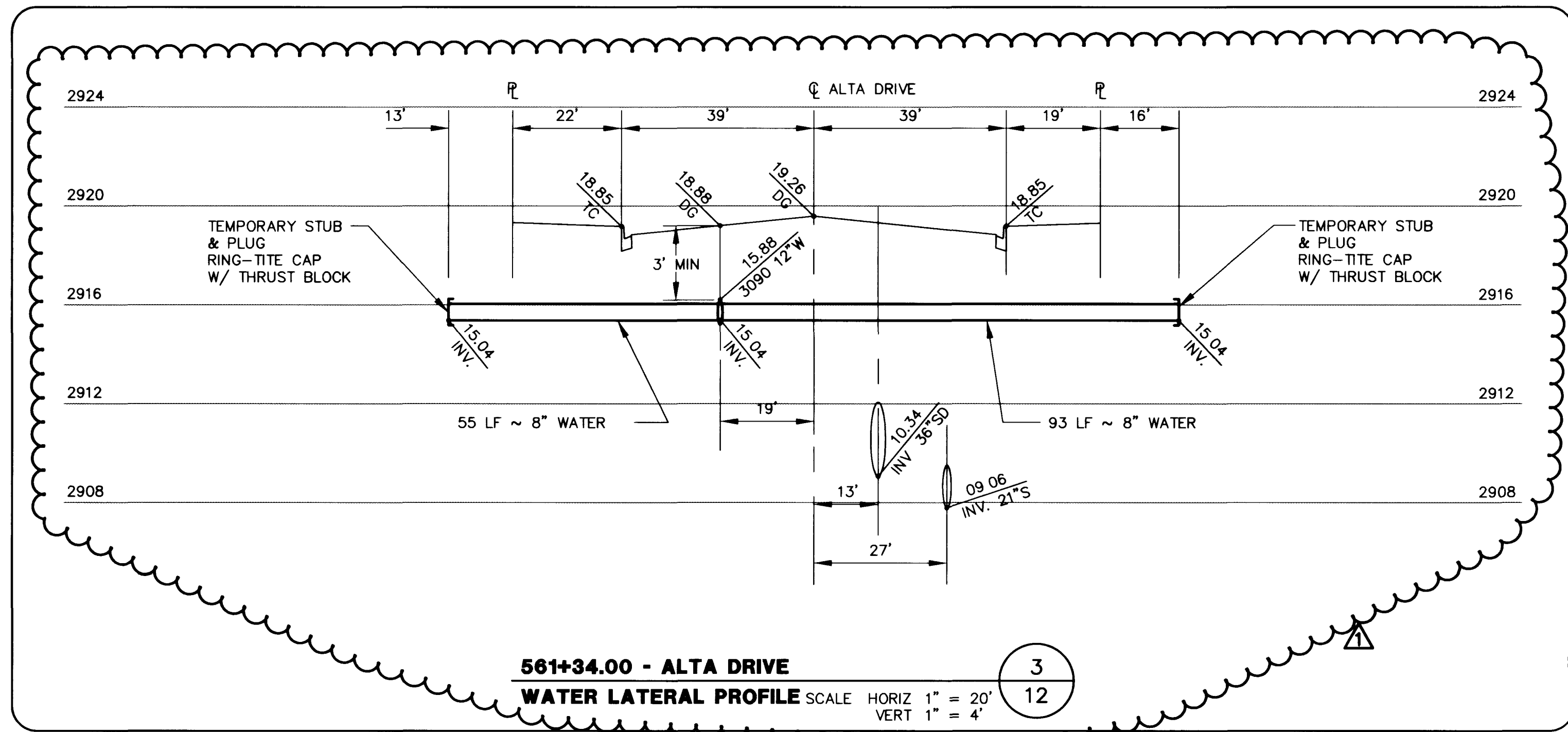
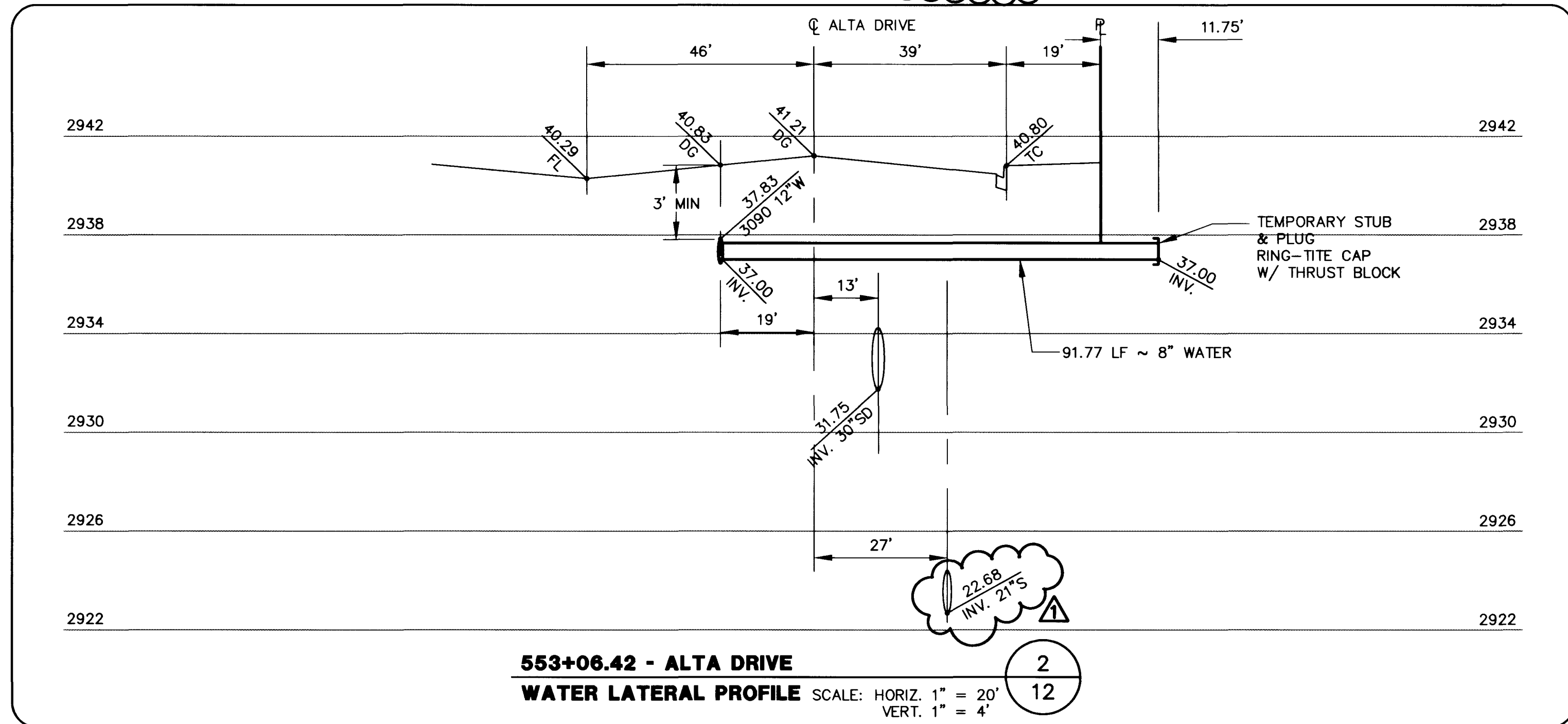
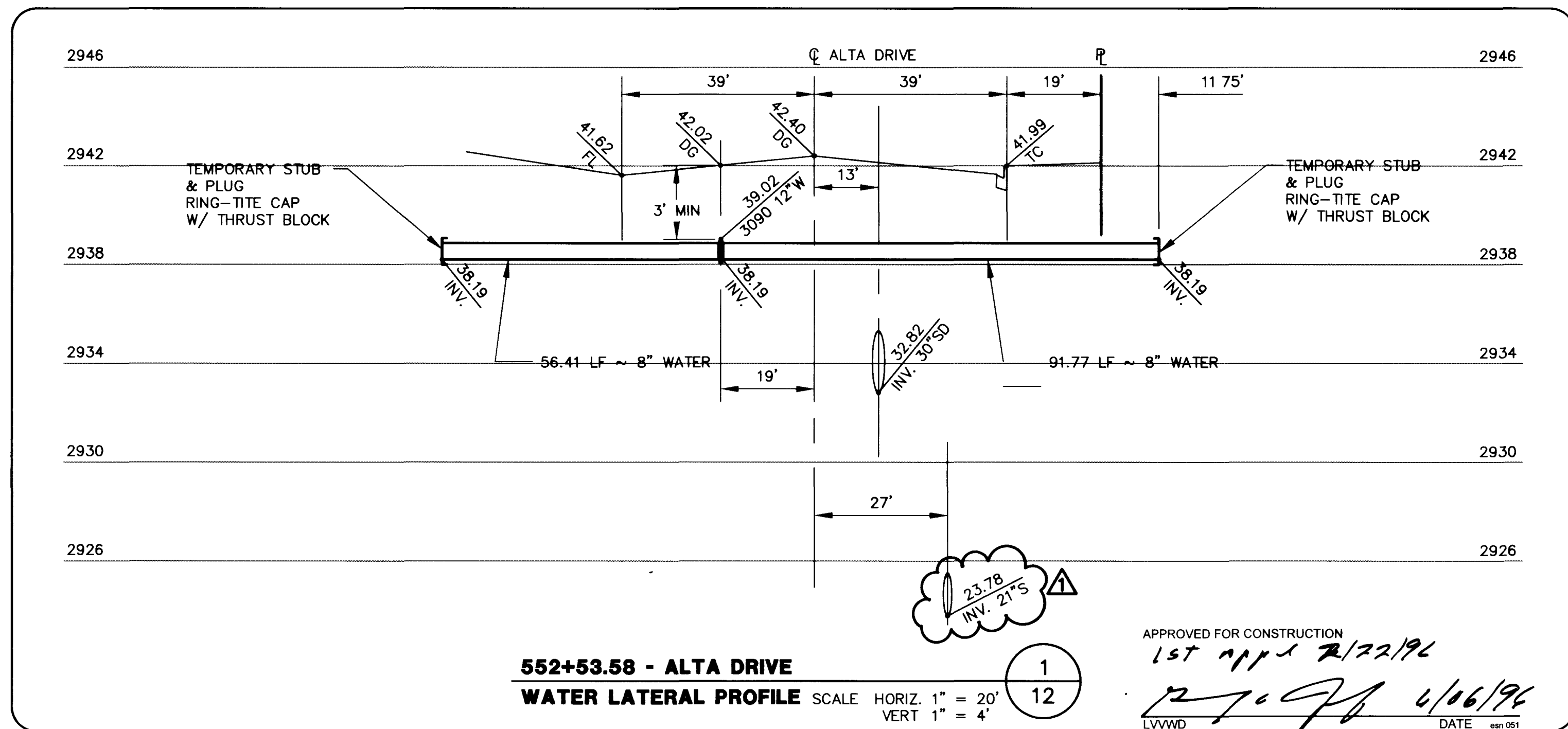

**SUMMERLIN  
ALTA DRIVE  
WATER & SEWER LATERAL DETAILS**

SHEET  
**12**  
SHT 12 OF 14

APPROVED FOR CONSTRUCTION  
 1st copy 7/22/96  
 12/10/96  
 DATE 6/16/96

G. C. WALLACE, INC.  
 Engineering/Architecture  
 1555 SOUTH RAINBOW BLVD./LAS VEGAS, NEVADA 89102

REV.	DATE	DESCRIPTION
1	7/22/96	ADD RECORD DRAWING INFO
2	7/24/96	REVISE SEWER FROM 18" TO 21" AND WATER LATERAL LOCATIONS
3	7/24/96	REVISE WATER LATERAL LOCATIONS

REVISIONS  
 NO. DATE DESCRIPTION  
 1 7/22/96  
 2 7/24/96  
 3 7/24/96

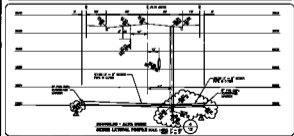
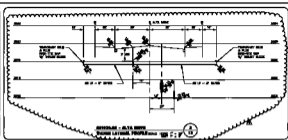
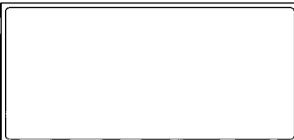

U.S. BARRACADE, INC.  
ARCHITECTS & ENGINEERS

SECTION - ALTA BARR  
SECTION LATERAL PROFILE HAS 1/4" = 1'

13