

**STREET "B/G"**

SCALE: HORIZ. 1" = 40'  
VERT. 1" = 4'

NOTE:  
THIS SET OF DRAWINGS IS BASED UPON NAVD 88 DATUM.  
NAVD 88 DATUM = 2.2' + SUMMERLIN DATUM.

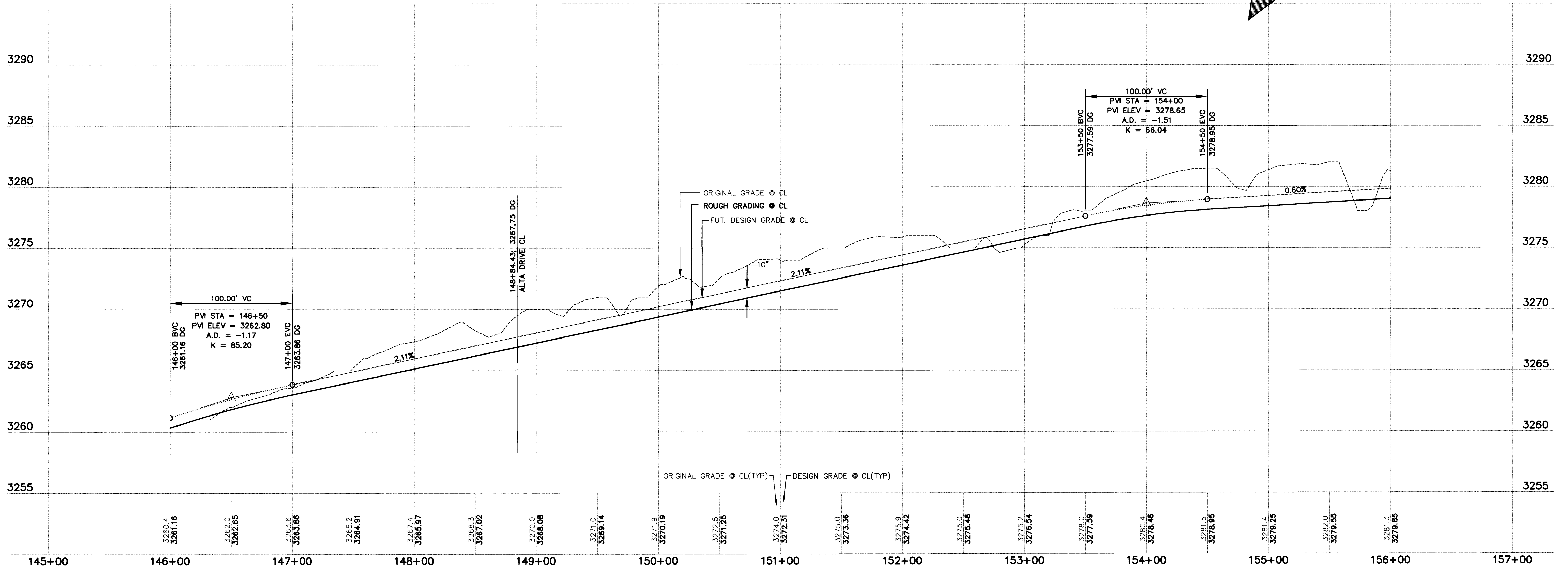

RECOMMENDED	DATE	DESCRIPTION
BERT A. HUGHES	10/25/99	
P.E. NO.	DATE	DATE
10259	10/25/99	12/05/97

ISSUE TO CONSTRUCT 12/05/97

ENGINEER: BERT A. HUGHES, CIVIL ENGINEER, LICENSE NO. 10259, STATE OF NEVADA

**G.C. WALLACE, INC.**  
ENGINEERING/ARCHITECTURE  
1555 SOUTH RANNEY BLVD., LAS VEGAS, NEVADA 89102 (702) 363-1200  
SUMMERLIN DIVISION: (702) 363-0991

**SUMMERLIN**  
VILLAGE 20 - ROUGH GRADING  
STREET "B/G"  
PLAN & PROFILE  
STA 146+00 TO 156+00

SHEET **38**  
SHT 38 OF 68

JOB NO. 62020.201

\\Server\07162020\201\DWG\1MPS\B5\B5-pp-00.dwg Wed Dec 03 09:20:10 1997 By GP

1751

107-V2777

