

CITY OF LAS VEGAS FIRE DEPT. NOTES

- ALL WORK SHALL BE DONE IN STRICT ACCORDANCE WITH THE CITY OF LAS VEGAS FIRE DEPARTMENT "HYDRANT SPECIFICATIONS", "HYDRANT INSTALLATION SPECIFICATIONS", AND ORDINANCE No. 3944.
- AUTHORIZED HYDRANTS FOR THIS PROJECT ARE:
 - A - KENNEDY GUARDIAN
 - B - MUELLER A-423 CENTURION
 - C - CLOW MODEL 2546 MEDALLION
- ON ANY NEW HOME OR BUILDING INSTALLATION, ACCESSIBLE FIRE HYDRANTS SHALL BE INSTALLED BEFORE COMBUSTIBLE CONSTRUCTION COMMENCES, AND SAID FIRE HYDRANTS SHALL BE IN GOOD WORKING ORDER WITH AN ADEQUATE WATER SUPPLY.
- CONTRACTOR SHALL PLACE A BLUE REFLECTIVE MARKER AT CENTERLINE OF STREET ADJACENT TO FIRE HYDRANT AS REQUIRED IN ORDINANCE No. 3944 TO IDENTIFY FIRE HYDRANT LOCATIONS.
- CALL THE LAS VEGAS BUILDING DEPARTMENT AT 229-2071 FOR UNDERGROUND INSPECTION, PRESSURE AND FLUSH VERIFICATION OF ALL FIRE HYDRANTS AND FIRE LINES BEFORE COVERING.
- PAINTING OF THE CURBS AND HYDRANT AND ANY WORK NECESSARY FOR PROTECTION OF HYDRANTS FROM PHYSICAL DAMAGE PER ORDINANCE No. 3944 SHALL BE COMPLETED BEFORE APPROVAL BY THE CITY OF LAS VEGAS FIRE DEPARTMENT.
- A PERMIT IS REQUIRED FROM THE FIRE DEPARTMENT FOR ON-SITE WATER LINE AND FIRE HYDRANT. THE PERMIT AND CONTRACTORS MATERIAL AND TEST CERTIFICATE FOR UNDERGROUND PIPING FORM SHALL BE OBTAINED FROM THE FIRE PROTECTION ENGINEER PRIOR TO ANY WORK BEGINNING.
- PRIVATE FIRE HYDRANTS SHALL BE PAINTED RED.
- A FLOW TEST MUST BE WITNESSED BY THE FIRE DEPARTMENT PRIOR TO OCCUPANCY FOR VERIFICATION OF REQUIRED ON-SITE WATER SUPPLY.
- ALL ON-SITE FIRE MAIN MATERIALS MUST BE U.L. LISTED AND A.W.W.A. APPROVED.
- FIRE HYDRANT SPACING:
 - RESIDENTIAL - 500 FEET UNSPRINKLERED, 1000 FEET SPRINKLERED
 - COMMERCIAL, INCLUDING MULTI-FAMILY - 500 FEET UNSPRINKLERED, 300 FEET SPRINKLERED.
- WHERE NEW WATER MAINS ARE EXTENDED ALONG STREETS, WHERE HYDRANTS ARE NOT NEEDED FOR PROTECTION OF STRUCTURES, FIRE HYDRANTS SHALL BE SPACED AT MAX. 1,000 FOOT SPACING TO PROVIDE FOR TRANSPORTATION HAZARDS.
- NO FIRE HYDRANT SHALL BE LOCATED WITHIN THE REQUIRED RADIUS OF A CUL-DE-SAC OR WITHIN 20 FEET OF THE PERIMETER OF THE RADIUS OF THE CUL-DE-SAC.
- NO FIRE HYDRANT SHALL BE LOCATED WITHIN 6' OF ANY CURB RETURN, DRIVEWAY, POWER POLE, STREETLIGHT, OR ANY OTHER OBSTRUCTION.
- TWO SOURCES OF SUPPLY ARE REQUIRED WHENEVER THERE ARE 4 OR MORE FIRE HYDRANTS INSTALLED ON A SINGLE SYSTEM.
- NOT MORE THAN 2 HYDRANTS CAN BE OUT OF SERVICE DUE TO A SINGLE MAIN BREAK.
- FIRE APPARATUS ACCESS ROADS SHALL HAVE AN UNOBSTRUCTED WIDTH OF NOT LESS THAN 20 FEET PROVIDED NO PARKING IS ALLOWED, NOT LESS THAN 28 FEET IF PARALLEL PARKING IS ALLOWED ON ONE SIDE, AND NOT LESS THAN 36 FEET IF PARALLEL PARKING IS ALLOWED ON BOTH SIDES. VERTICAL CLEARANCE SHALL NOT BE LESS THAN 13 FEET 6 INCHES.
- THE TURNING RADIUS OF ANY FIRE APPARATUS ACCESS ROAD AND/OR FIRE LANE, PUBLIC OR PRIVATE SHALL BE NOT LESS THAN 45 FEET OUTSIDE RADIUS AND 22 FEET INSIDE RADIUS.
- A FIRE APPARATUS ROAD SHALL BE REQUIRED WHEN ANY PORTION OF AN EXTERIOR WALL OF THE FIRST STORY IS LOCATED MORE THAN 150 FEET FROM A FIRE DEPARTMENT VEHICLE ACCESS. (SEE EXCEPTIONS IN U.F.C. 94, SECTION 902.2).
- ALL DEAD END FIRE APPARATUS ACCESS ROADS AND/OR FIRE LANES PUBLIC OR PRIVATE IN EXCESS OF 150 FEET IN LENGTH SHALL BE PROVIDED WITH AN APPROVED TURNAROUND AREA. SEE ORDINANCE No. 3944.
- ACCESS ROADS SHALL BE MARKED BY PLACING APPROVED SIGNS AT THE START OF THE DESIGNATED FIRE LANE, ONE SIGN AT THE END OF THE FIRE LANE AND WITH SIGNS AT INTERVALS OF 100 FEET ALONG ALL DESIGNATED FIRE LANES. SIGNS TO BE PLACED ON BOTH SIDES OF AN ACCESS ROADWAY IF NEEDED TO PREVENT PARKING ON EITHER SIDE. SIGNS TO BE INSTALLED NO HIGHER THAN 10 FEET OR LESS THAN 6 FEET FROM ROADWAY LEVEL. THE CURBS ALONG OR ON THE PAVEMENT OR CEMENT IF CURB IS NOT PRESENT, SHALL BE PAINTED WITH A RED WEATHER RESISTANT PAINT IN ADDITION TO THE SIGNS.
- ELECTRICALLY CONTROLLED ACCESS GATES SHALL BE PROVIDED WITH AN APPROVED EMERGENCY VEHICLE DETECTOR/RECEIVER SYSTEM. SAID SYSTEM SHALL BE INSTALLED IN ACCORDANCE WITH THE CITY OF LAS VEGAS GUIDELINES FOR AUTOMATIC EMERGENCY VEHICLE ACCESS GATES.

REVISED 1/96

CITY OF LAS VEGAS STREETLIGHT NOTES

- ALL STREETLIGHTS, POLES, FOUNDATIONS, LUMINAIRES AND SPACING REQUIREMENTS WILL CONFORM WITH THE REQUIREMENTS OF SUMMERLIN'S IMPROVEMENT STANDARDS.
- ALL HAND HOLE COVERS MUST BE INSTALLED, POLE CAPS POURED, AND PULL BOX LIDS BOLTED DOWN PRIOR TO ENERGIZING CIRCUIT. ALL WIRE MUST HAVE THW INSULATION.

CITY OF LAS VEGAS SEWER NOTES

- ALL CONSTRUCTION AND MATERIALS SHALL BE IN ACCORDANCE WITH THE LATEST EDITION OF THE DESIGN AND CONSTRUCTION STANDARDS FOR WASTEWATER COLLECTION SYSTEMS AND THE UNIFORM STANDARD SPECIFICATIONS FOR PUBLIC WORKS' CONSTRUCTION OFF-SITE IMPROVEMENTS, CLARK COUNTY AREA, NEVADA, AS AMENDED. IN ALL CASES, THESE STANDARDS SHALL SUPERSEDE THE UNIFORM STANDARD SPECIFICATIONS. IT WILL BE THE RESPONSIBILITY OF THE CONTRACTOR TO BE AWARE OF THE CONTENTS OF THE ABOVE SPECIFICATION BOOKS.
- IT SHALL BE THE CONTRACTOR'S RESPONSIBILITY TO PERFORM CONSTRUCTION AS PER PLANS, ANY ADDITIONS, DELETIONS, OR CHANGES SHALL MEET WITH THE APPROVAL OF THE CONTROLLING AGENCY.
- CHISEL "S" OR "G" IN CURBS WHERE SEWER OR GAS LATERALS PASS UNDER THE CURB.
- POLYVINYL (PVC) SEWER PIPE SHALL MEET ASTM D-3034 SDR 35 SPECIFICATIONS, INSTALLED WITH SAND BEDDING AND BACKFILL OF TYPE II GRAVEL.
- ALL MANHOLES IN PAVED STREETS 80' R/W AND LARGER, SHALL HAVE CONCRETE COLLARS.
- TEE SADDLES SHALL BE USED TO CONNECT SEWER LATERALS TO EXISTING MAIN LINES UP TO 12" DIA. SIZE. CONNECTIONS TO 15" OR LARGER MAINS SHALL REQUIRE SPECIAL PROCEDURES.
- A SEWER MAIN CROSSING OVER A WATER MAIN OR LESS THAN 18" UNDER A WATER MAIN MUST BE REINFORCED CONCRETE ENCASED FOR A DISTANCE NOT LESS THAN TEN FEET (10') TO EACH SIDE OF THE CENTERLINE OF THE WATER MAIN.
- ALL CONTRACTORS INSTALLING SEWER MAINS THAT WILL BE UNDER THE JURISDICTION OF THE CONTROLLING AGENCY MUST BE CLASS "A" CONTRACTORS.
- THE CITY OF LAS VEGAS WILL NOT ACCEPT ANY SEWER MAINS WHICH HAVE A VERTICAL DEFLECTION OF MORE THAN ONE TENTH (0.1) OF A FOOT FROM THE APPROVED CONSTRUCTION PLANS. SEWER MAINS FOUND TO EXCEED THIS TOLERANCE WILL HAVE TO BE REPAIRED OR REMOVED AND REPLACED TO THE SATISFACTION OF THE CITY ENGINEER PRIOR TO ACCEPTANCE BY THE CITY.

REVISED 10/91

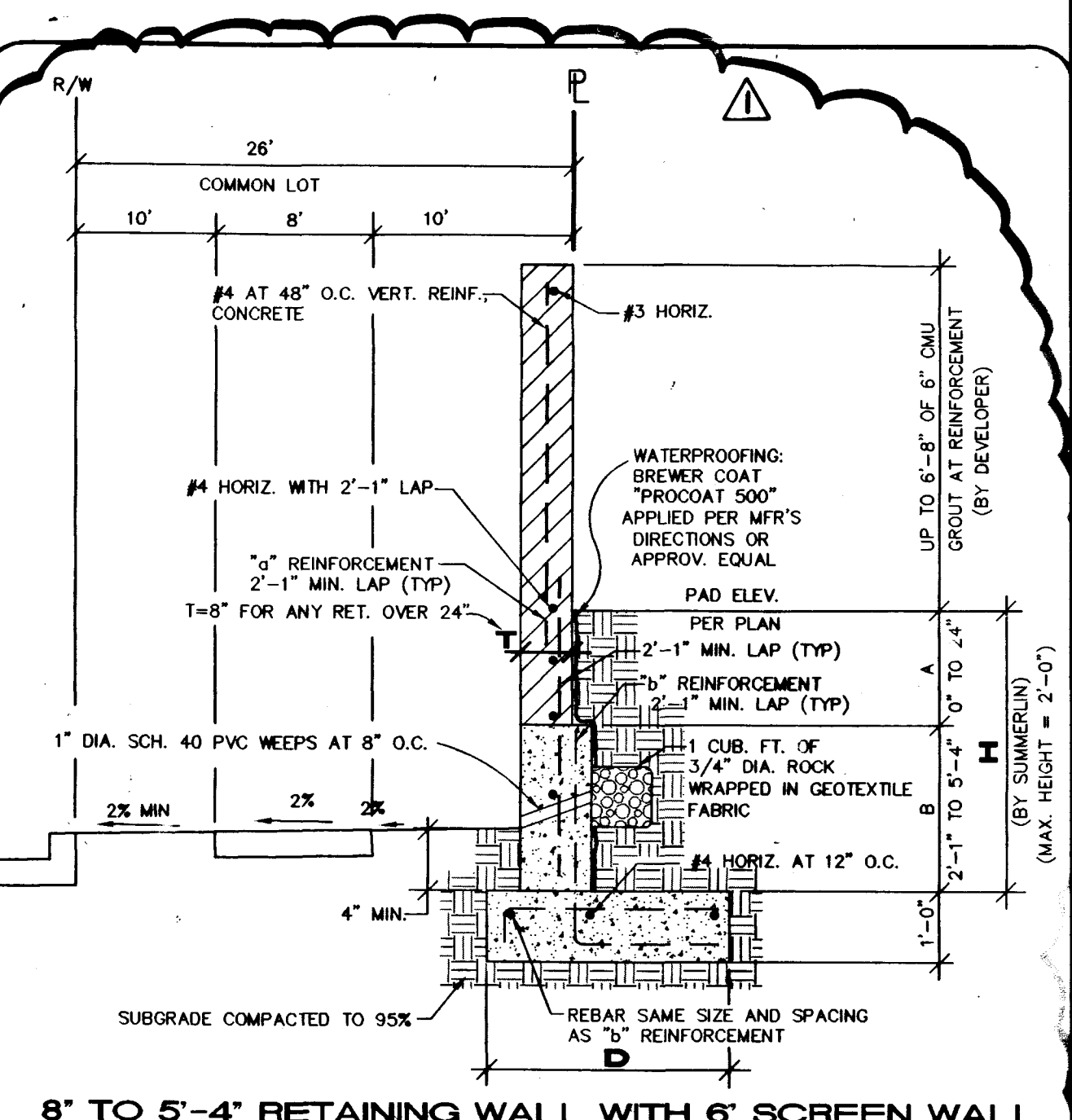
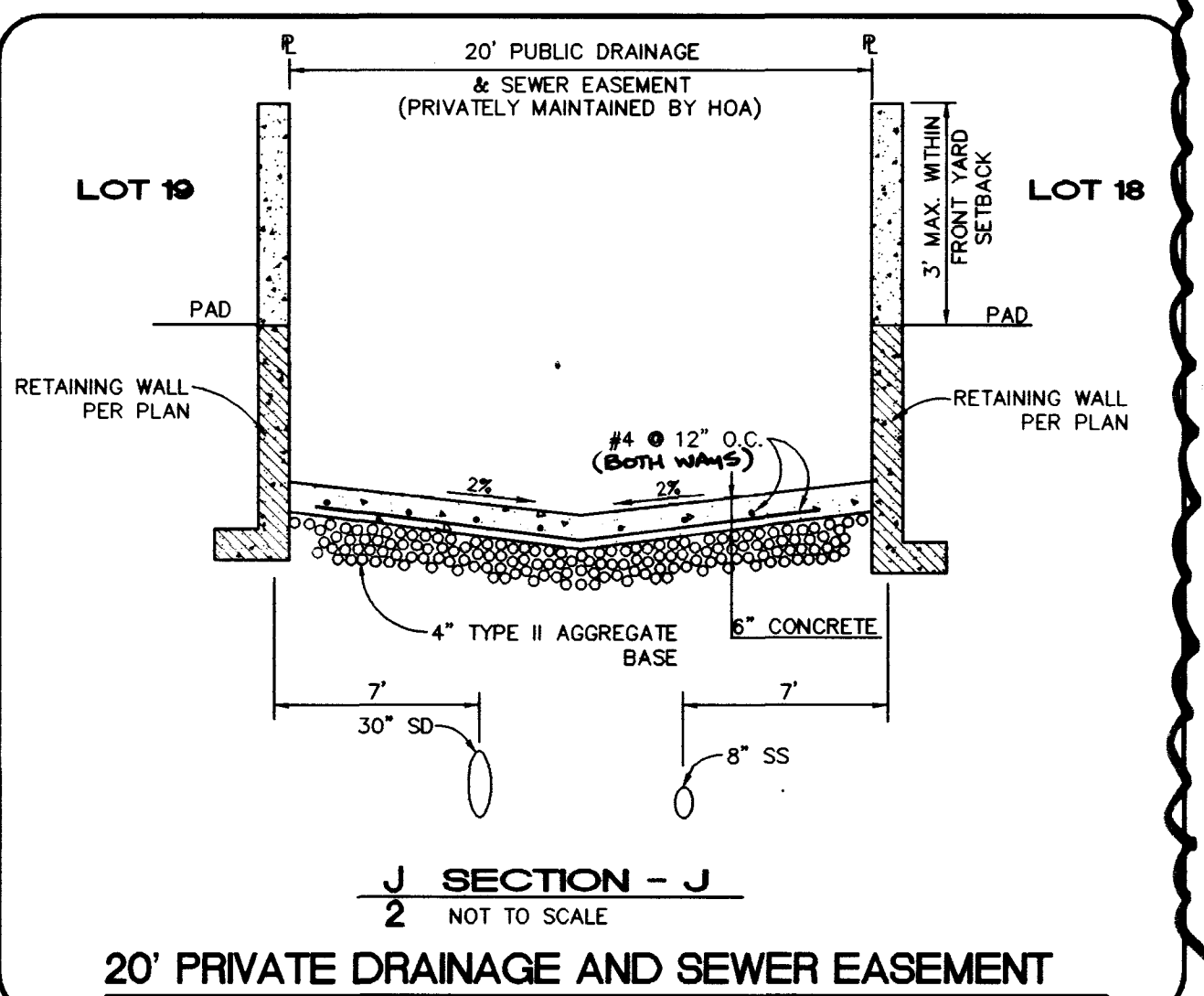
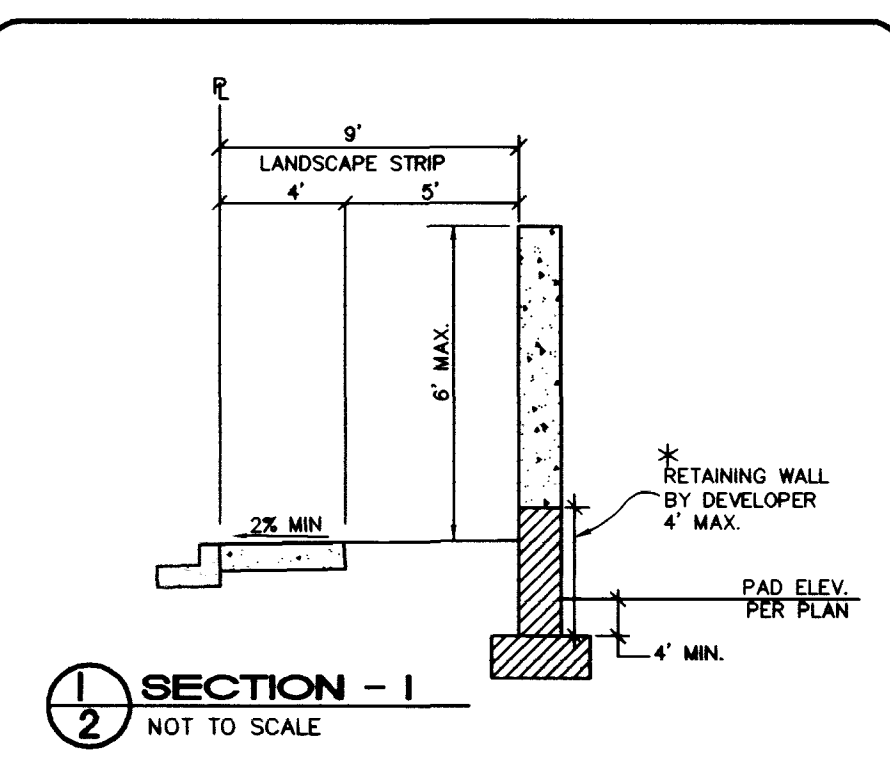
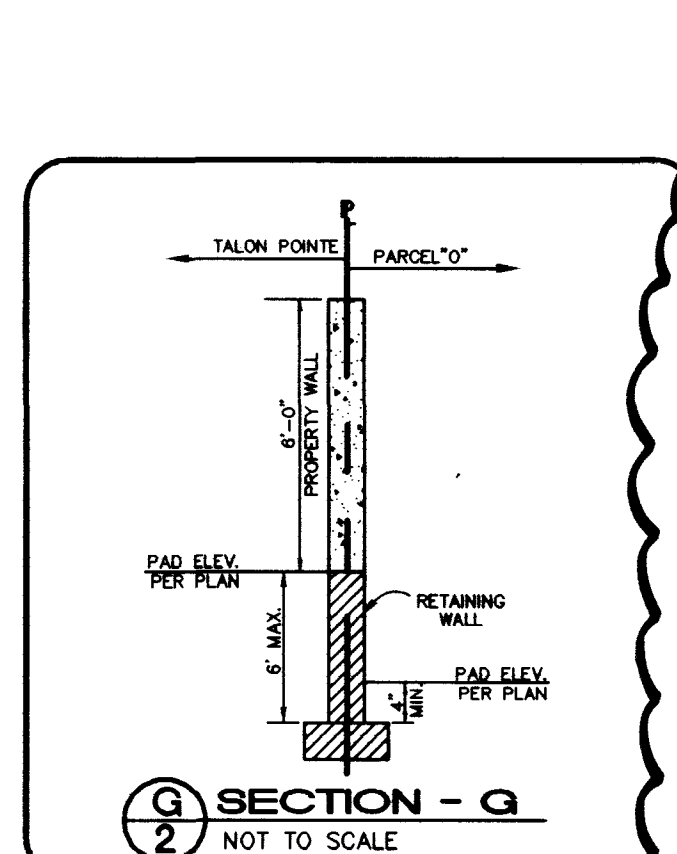
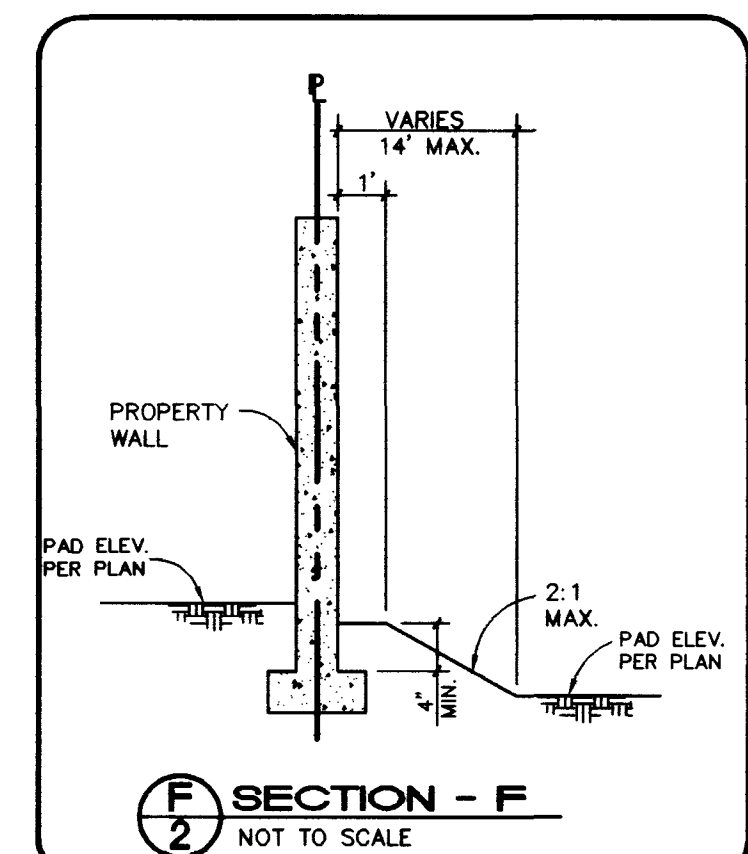
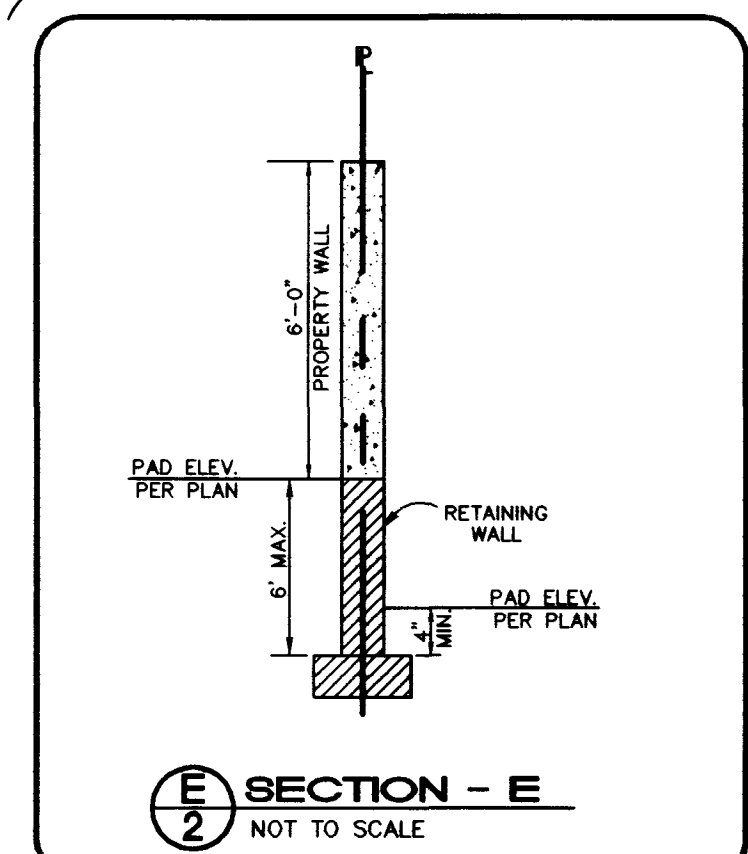
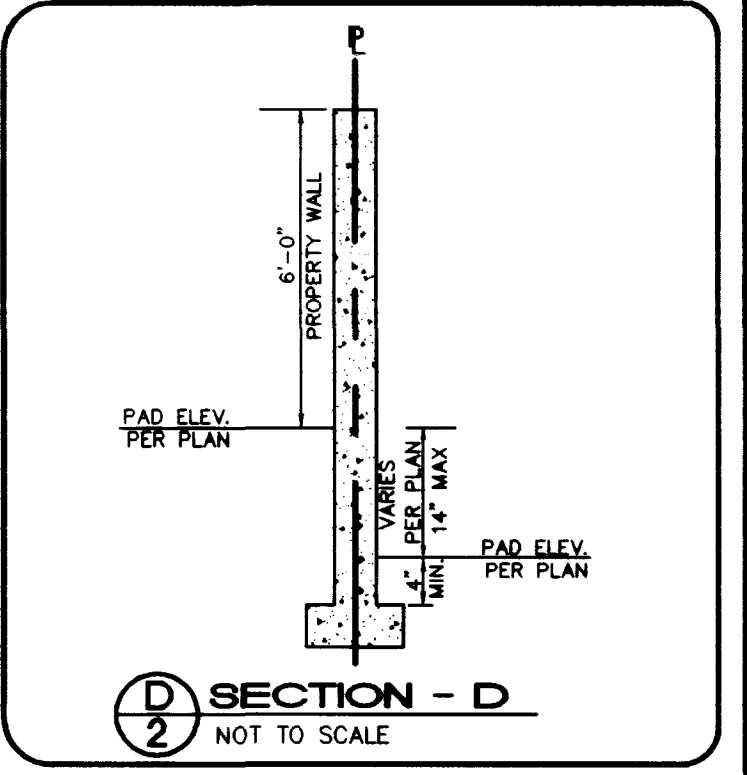
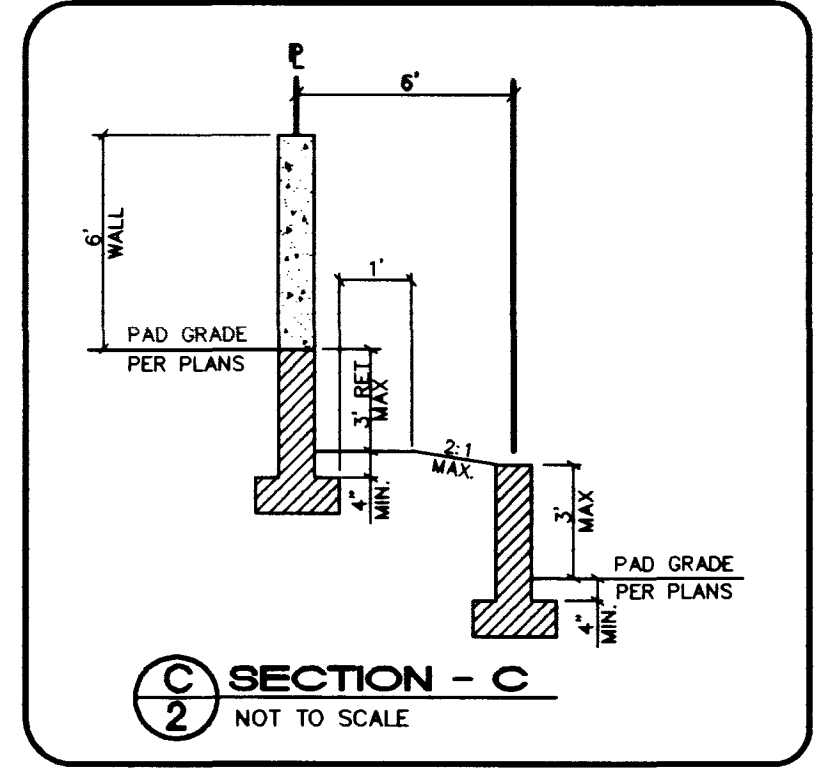
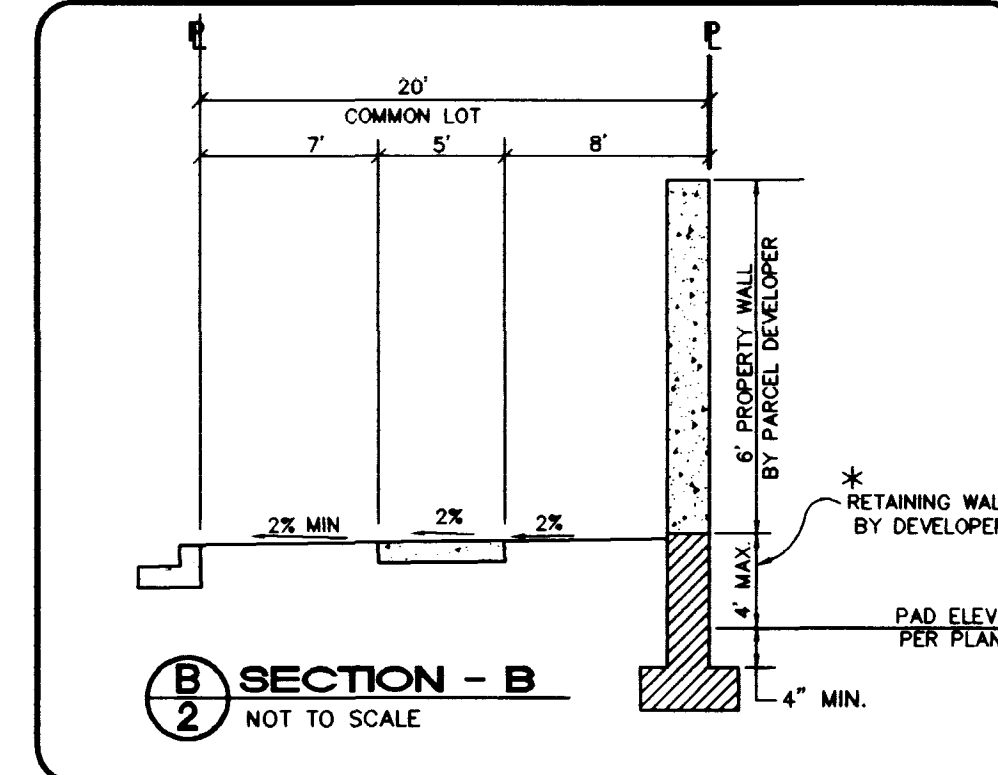
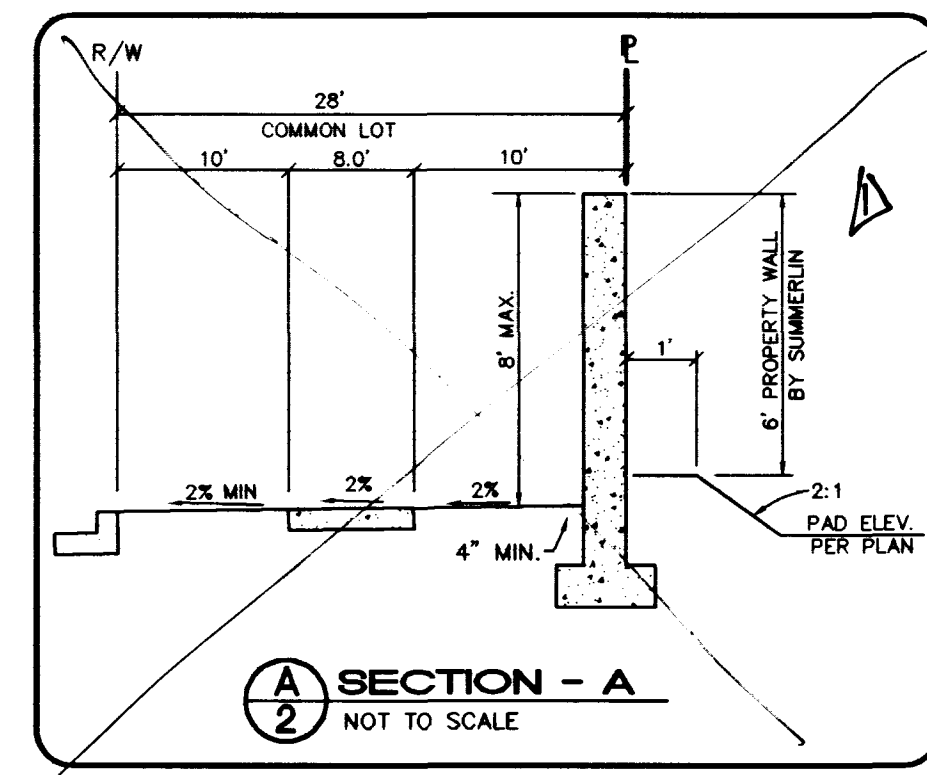

REINFORCING SCHEDULE

T	H	D	REINFORCEMENT	REINFORCEMENT
BLOCK THICKNESS	RETAINED HEIGHT	FOOTING WIDTH	"a"	"b"
0' to 8" RETAINING	8"	2'-0"	#4 AT 48" O.C. VERT.	N.A.
9" to 24" RETAINING	6"	2'-0"	#4 AT 24" O.C. VERT.	N.A.
2'-1" to 3'-4" RETAINING	8"	2'-3"	#4 AT 24" O.C. VERT.	N.A.
3'-5" to 5'-4" RETAINING	8"	3'-4"	#4 AT 24" O.C. VERT.	#5 AT 16" O.C. VERT.

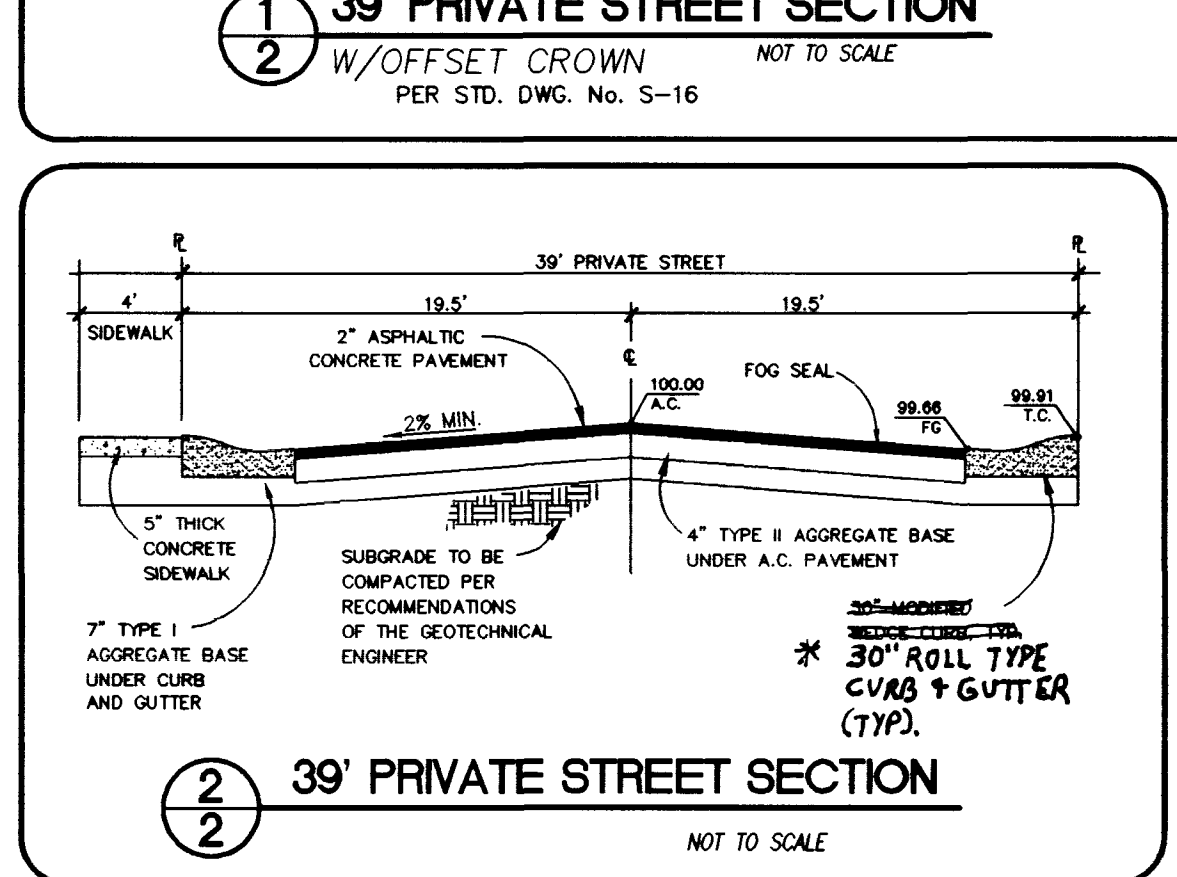
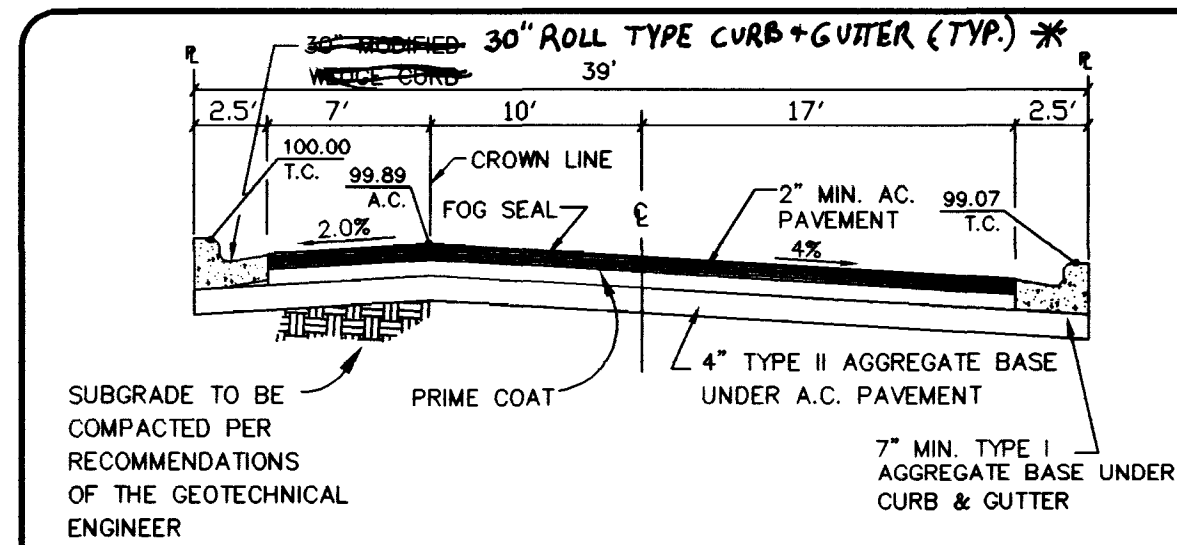
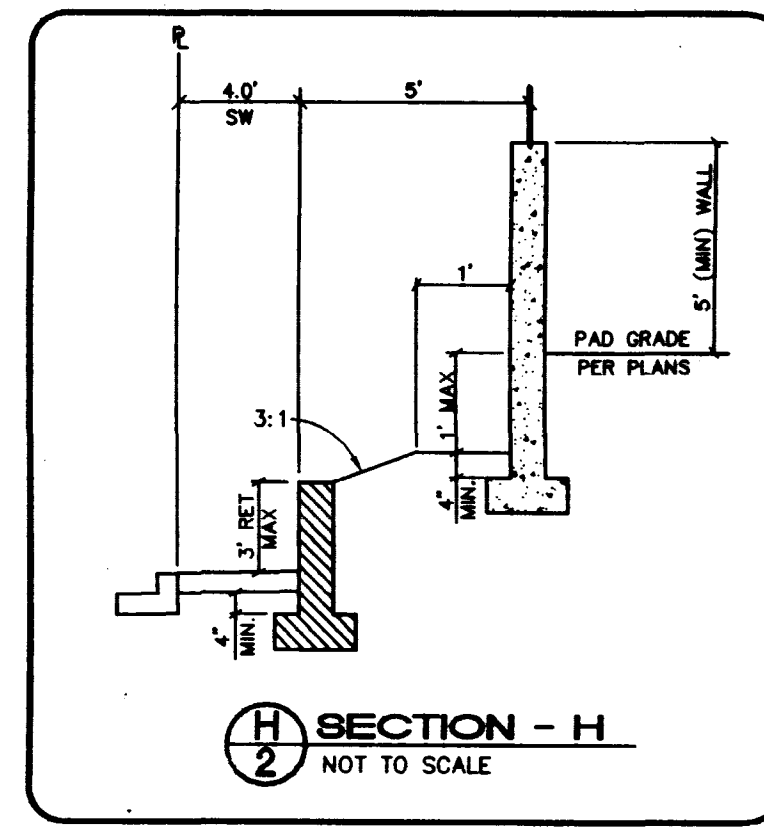

* NOTE: 30" ROLL TYPE CURB+GUTTER PER UNIFORM STD. DWG. NO. 217A.

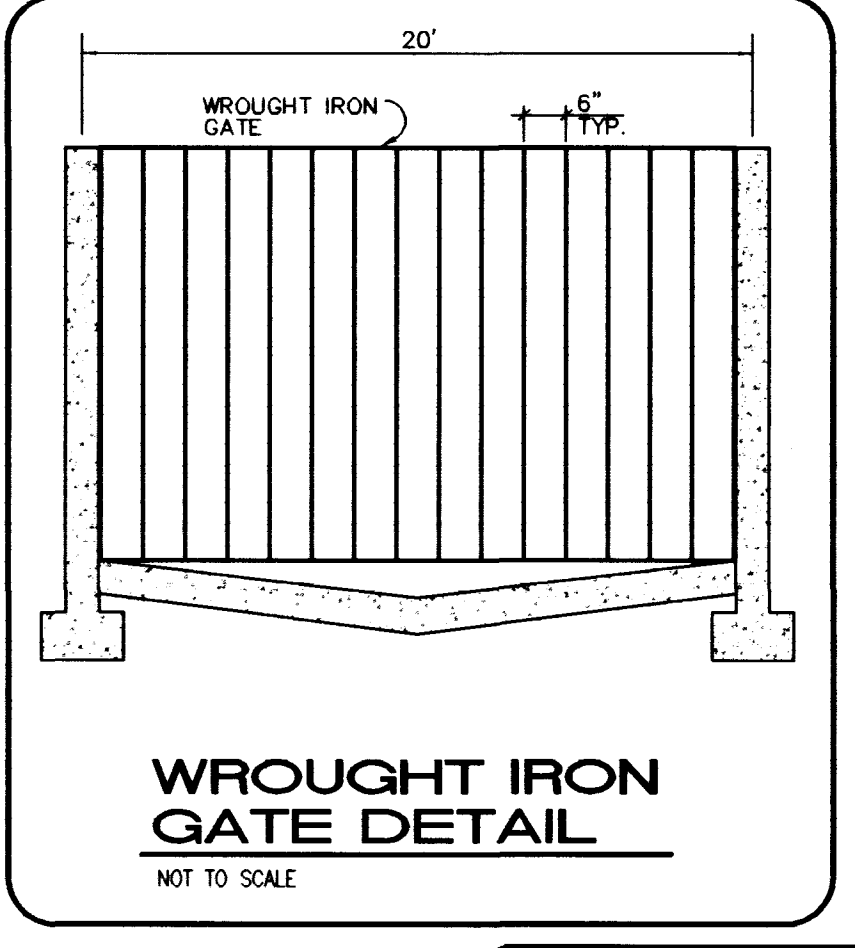
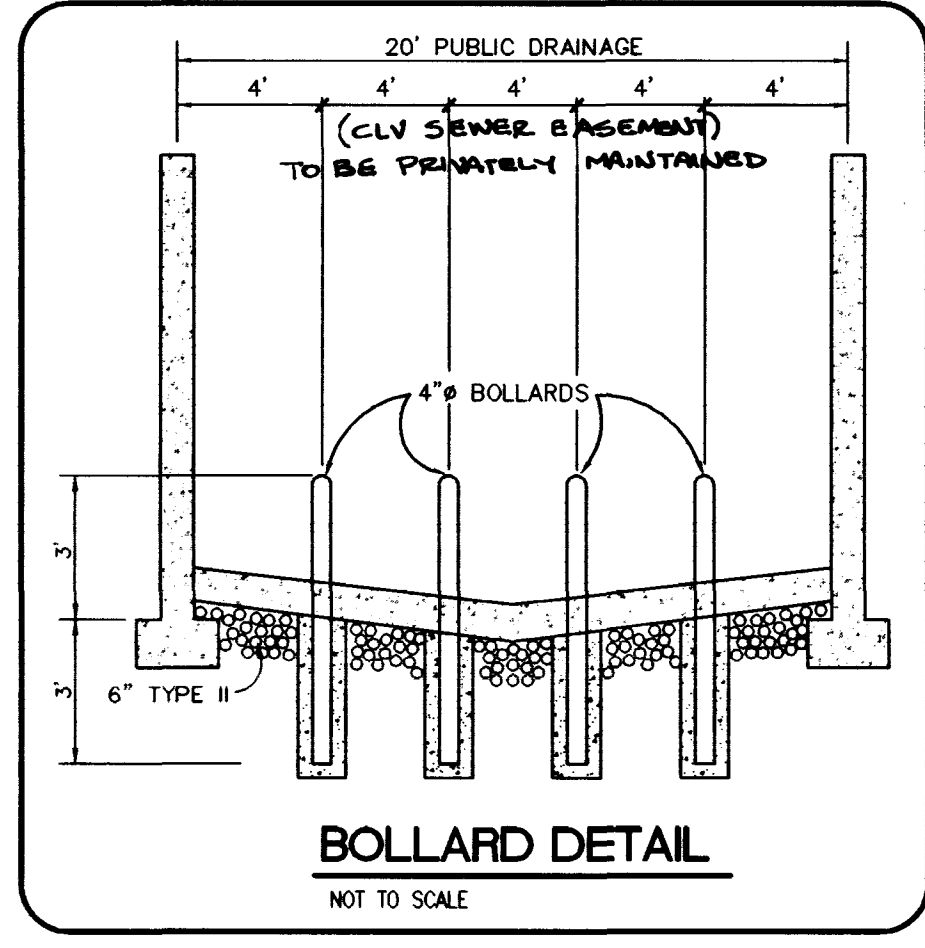
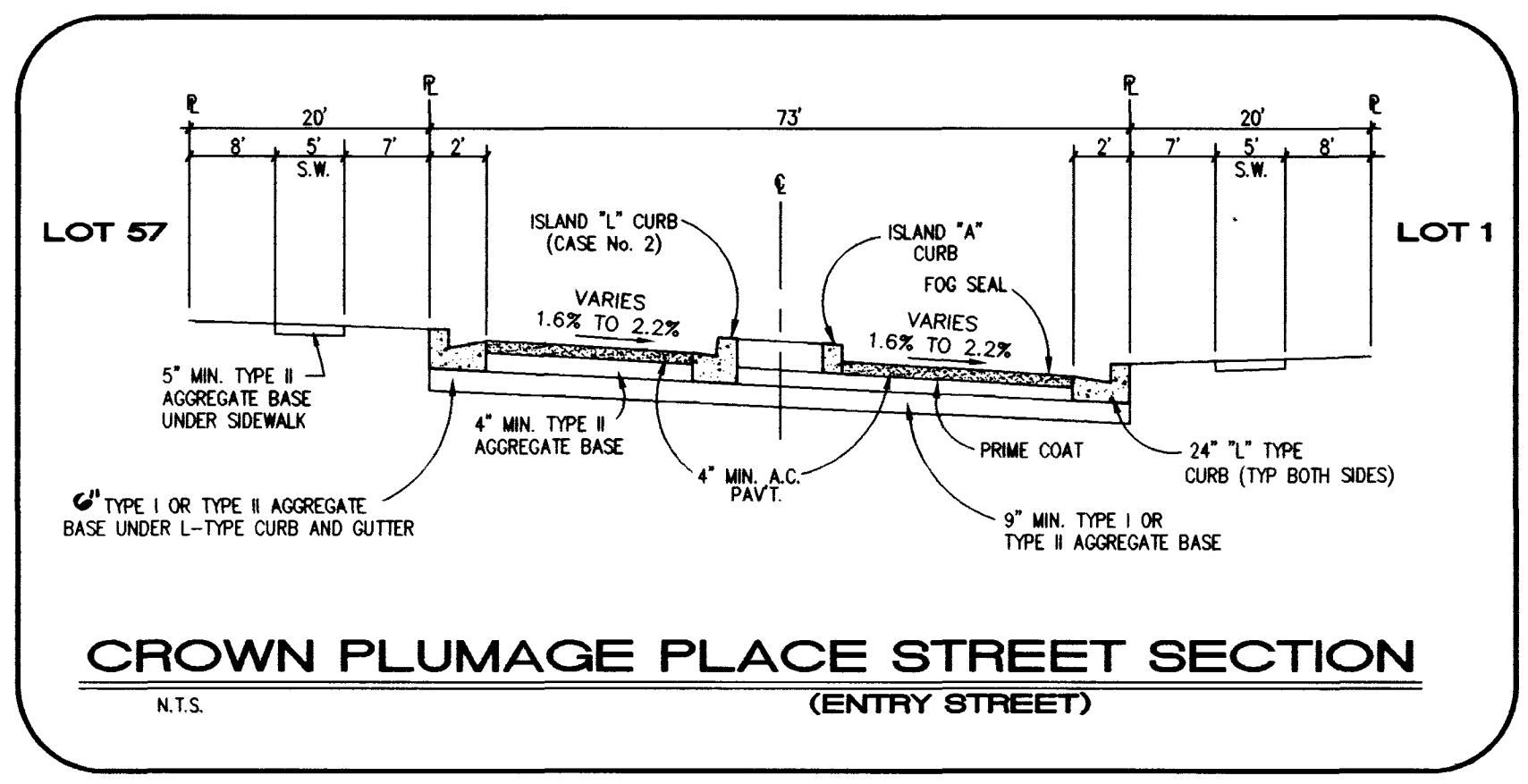

* ALL RETAINING WALLS IN THIS PARCEL AT DEVELOPER'S COST.

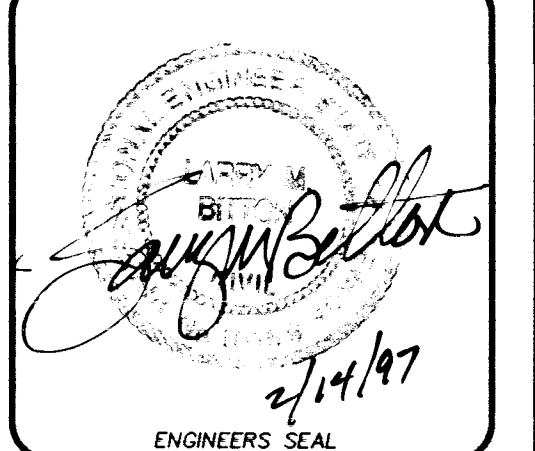

J.M. PETERS NEVADA

901 N. Green Valley Parkway
Suite 100
North Las Vegas, NV 89014
Telephone: 702/263-2775
FACSIMILE: 702/263-2775
FRENCH BRANCH Telephone: 702/263-7500

ENGINEERING - PLANNING - SURVEYING - CONSTRUCTION SERVICES

TALON POINTE UNIT ONE NOTES and DETAILS

Scale: 8/8"=1'-0"

Drawn by: P.M./M.L. File No.: 87818P

Checked by: M.P. Date: OCT 1996

Job Number: 5878 Sheet Number: 2 OF 9 Date: OCT 1996

REVISIONS: SECTION - A

No. 1

Date: 10/97

APPR. 10/97

SET OF LAY OUTS FOR DEPT. 1078

- 1. GENERAL NOTES
- 2. PLAN OF THE PROJECT
- 3. ELEVATIONS
- 4. SECTIONAL ELEVATIONS
- 5. FOUNDATION PLAN
- 6. FOUNDATION ELEVATIONS
- 7. FOUNDATION SECTIONS
- 8. FOUNDATION DETAILS
- 9. FOUNDATION CONNECTIONS
- 10. FOUNDATION CONNECTIONS
- 11. FOUNDATION CONNECTIONS
- 12. FOUNDATION CONNECTIONS
- 13. FOUNDATION CONNECTIONS
- 14. FOUNDATION CONNECTIONS
- 15. FOUNDATION CONNECTIONS
- 16. FOUNDATION CONNECTIONS
- 17. FOUNDATION CONNECTIONS
- 18. FOUNDATION CONNECTIONS
- 19. FOUNDATION CONNECTIONS
- 20. FOUNDATION CONNECTIONS
- 21. FOUNDATION CONNECTIONS
- 22. FOUNDATION CONNECTIONS
- 23. FOUNDATION CONNECTIONS
- 24. FOUNDATION CONNECTIONS
- 25. FOUNDATION CONNECTIONS
- 26. FOUNDATION CONNECTIONS
- 27. FOUNDATION CONNECTIONS
- 28. FOUNDATION CONNECTIONS
- 29. FOUNDATION CONNECTIONS
- 30. FOUNDATION CONNECTIONS
- 31. FOUNDATION CONNECTIONS
- 32. FOUNDATION CONNECTIONS
- 33. FOUNDATION CONNECTIONS
- 34. FOUNDATION CONNECTIONS
- 35. FOUNDATION CONNECTIONS
- 36. FOUNDATION CONNECTIONS
- 37. FOUNDATION CONNECTIONS
- 38. FOUNDATION CONNECTIONS
- 39. FOUNDATION CONNECTIONS
- 40. FOUNDATION CONNECTIONS
- 41. FOUNDATION CONNECTIONS
- 42. FOUNDATION CONNECTIONS
- 43. FOUNDATION CONNECTIONS
- 44. FOUNDATION CONNECTIONS
- 45. FOUNDATION CONNECTIONS
- 46. FOUNDATION CONNECTIONS
- 47. FOUNDATION CONNECTIONS
- 48. FOUNDATION CONNECTIONS
- 49. FOUNDATION CONNECTIONS
- 50. FOUNDATION CONNECTIONS

- 1. GENERAL NOTES
- 2. PLAN OF THE PROJECT
- 3. ELEVATIONS
- 4. SECTIONAL ELEVATIONS
- 5. FOUNDATION PLAN
- 6. FOUNDATION ELEVATIONS
- 7. FOUNDATION SECTIONS
- 8. FOUNDATION DETAILS
- 9. FOUNDATION CONNECTIONS
- 10. FOUNDATION CONNECTIONS
- 11. FOUNDATION CONNECTIONS
- 12. FOUNDATION CONNECTIONS
- 13. FOUNDATION CONNECTIONS
- 14. FOUNDATION CONNECTIONS
- 15. FOUNDATION CONNECTIONS
- 16. FOUNDATION CONNECTIONS
- 17. FOUNDATION CONNECTIONS
- 18. FOUNDATION CONNECTIONS
- 19. FOUNDATION CONNECTIONS
- 20. FOUNDATION CONNECTIONS
- 21. FOUNDATION CONNECTIONS
- 22. FOUNDATION CONNECTIONS
- 23. FOUNDATION CONNECTIONS
- 24. FOUNDATION CONNECTIONS
- 25. FOUNDATION CONNECTIONS
- 26. FOUNDATION CONNECTIONS
- 27. FOUNDATION CONNECTIONS
- 28. FOUNDATION CONNECTIONS
- 29. FOUNDATION CONNECTIONS
- 30. FOUNDATION CONNECTIONS
- 31. FOUNDATION CONNECTIONS
- 32. FOUNDATION CONNECTIONS
- 33. FOUNDATION CONNECTIONS
- 34. FOUNDATION CONNECTIONS
- 35. FOUNDATION CONNECTIONS
- 36. FOUNDATION CONNECTIONS
- 37. FOUNDATION CONNECTIONS
- 38. FOUNDATION CONNECTIONS
- 39. FOUNDATION CONNECTIONS
- 40. FOUNDATION CONNECTIONS
- 41. FOUNDATION CONNECTIONS
- 42. FOUNDATION CONNECTIONS
- 43. FOUNDATION CONNECTIONS
- 44. FOUNDATION CONNECTIONS
- 45. FOUNDATION CONNECTIONS
- 46. FOUNDATION CONNECTIONS
- 47. FOUNDATION CONNECTIONS
- 48. FOUNDATION CONNECTIONS
- 49. FOUNDATION CONNECTIONS
- 50. FOUNDATION CONNECTIONS

- 1. GENERAL NOTES
- 2. PLAN OF THE PROJECT
- 3. ELEVATIONS
- 4. SECTIONAL ELEVATIONS
- 5. FOUNDATION PLAN
- 6. FOUNDATION ELEVATIONS
- 7. FOUNDATION SECTIONS
- 8. FOUNDATION DETAILS
- 9. FOUNDATION CONNECTIONS
- 10. FOUNDATION CONNECTIONS
- 11. FOUNDATION CONNECTIONS
- 12. FOUNDATION CONNECTIONS
- 13. FOUNDATION CONNECTIONS
- 14. FOUNDATION CONNECTIONS
- 15. FOUNDATION CONNECTIONS
- 16. FOUNDATION CONNECTIONS
- 17. FOUNDATION CONNECTIONS
- 18. FOUNDATION CONNECTIONS
- 19. FOUNDATION CONNECTIONS
- 20. FOUNDATION CONNECTIONS
- 21. FOUNDATION CONNECTIONS
- 22. FOUNDATION CONNECTIONS
- 23. FOUNDATION CONNECTIONS
- 24. FOUNDATION CONNECTIONS
- 25. FOUNDATION CONNECTIONS
- 26. FOUNDATION CONNECTIONS
- 27. FOUNDATION CONNECTIONS
- 28. FOUNDATION CONNECTIONS
- 29. FOUNDATION CONNECTIONS
- 30. FOUNDATION CONNECTIONS
- 31. FOUNDATION CONNECTIONS
- 32. FOUNDATION CONNECTIONS
- 33. FOUNDATION CONNECTIONS
- 34. FOUNDATION CONNECTIONS
- 35. FOUNDATION CONNECTIONS
- 36. FOUNDATION CONNECTIONS
- 37. FOUNDATION CONNECTIONS
- 38. FOUNDATION CONNECTIONS
- 39. FOUNDATION CONNECTIONS
- 40. FOUNDATION CONNECTIONS
- 41. FOUNDATION CONNECTIONS
- 42. FOUNDATION CONNECTIONS
- 43. FOUNDATION CONNECTIONS
- 44. FOUNDATION CONNECTIONS
- 45. FOUNDATION CONNECTIONS
- 46. FOUNDATION CONNECTIONS
- 47. FOUNDATION CONNECTIONS
- 48. FOUNDATION CONNECTIONS
- 49. FOUNDATION CONNECTIONS
- 50. FOUNDATION CONNECTIONS



1. FOUNDATION WALL SECTION
2. FOUNDATION WALL SECTION

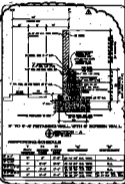

REINFORCING SCHEDULE

NO.	DESCRIPTION	QUANTITY	UNIT	WEIGHT	TOTAL WEIGHT
1	NO. 4	100	LB.	100	100
2	NO. 6	50	LB.	150	150
3	NO. 8	20	LB.	200	200
4	NO. 10	10	LB.	300	300
5	NO. 12	5	LB.	400	400
6	NO. 14	2	LB.	500	500
7	NO. 16	1	LB.	600	600
8	NO. 18	1	LB.	700	700
9	NO. 20	1	LB.	800	800
10	NO. 22	1	LB.	900	900
11	NO. 24	1	LB.	1000	1000
12	NO. 26	1	LB.	1100	1100
13	NO. 28	1	LB.	1200	1200
14	NO. 30	1	LB.	1300	1300
15	NO. 32	1	LB.	1400	1400
16	NO. 34	1	LB.	1500	1500
17	NO. 36	1	LB.	1600	1600
18	NO. 38	1	LB.	1700	1700
19	NO. 40	1	LB.	1800	1800
20	NO. 42	1	LB.	1900	1900
21	NO. 44	1	LB.	2000	2000
22	NO. 46	1	LB.	2100	2100
23	NO. 48	1	LB.	2200	2200
24	NO. 50	1	LB.	2300	2300
25	NO. 52	1	LB.	2400	2400
26	NO. 54	1	LB.	2500	2500
27	NO. 56	1	LB.	2600	2600
28	NO. 58	1	LB.	2700	2700
29	NO. 60	1	LB.	2800	2800
30	NO. 62	1	LB.	2900	2900
31	NO. 64	1	LB.	3000	3000
32	NO. 66	1	LB.	3100	3100
33	NO. 68	1	LB.	3200	3200
34	NO. 70	1	LB.	3300	3300
35	NO. 72	1	LB.	3400	3400
36	NO. 74	1	LB.	3500	3500
37	NO. 76	1	LB.	3600	3600
38	NO. 78	1	LB.	3700	3700
39	NO. 80	1	LB.	3800	3800
40	NO. 82	1	LB.	3900	3900
41	NO. 84	1	LB.	4000	4000
42	NO. 86	1	LB.	4100	4100
43	NO. 88	1	LB.	4200	4200
44	NO. 90	1	LB.	4300	4300
45	NO. 92	1	LB.	4400	4400
46	NO. 94	1	LB.	4500	4500
47	NO. 96	1	LB.	4600	4600
48	NO. 98	1	LB.	4700	4700
49	NO. 100	1	LB.	4800	4800
50	NO. 102	1	LB.	4900	4900
51	NO. 104	1	LB.	5000	5000
52	NO. 106	1	LB.	5100	5100
53	NO. 108	1	LB.	5200	5200
54	NO. 110	1	LB.	5300	5300
55	NO. 112	1	LB.	5400	5400
56	NO. 114	1	LB.	5500	5500
57	NO. 116	1	LB.	5600	5600
58	NO. 118	1	LB.	5700	5700
59	NO. 120	1	LB.	5800	5800
60	NO. 122	1	LB.	5900	5900
61	NO. 124	1	LB.	6000	6000
62	NO. 126	1	LB.	6100	6100
63	NO. 128	1	LB.	6200	6200
64	NO. 130	1	LB.	6300	6300
65	NO. 132	1	LB.	6400	6400
66	NO. 134	1	LB.	6500	6500
67	NO. 136	1	LB.	6600	6600
68	NO. 138	1	LB.	6700	6700
69	NO. 140	1	LB.	6800	6800
70	NO. 142	1	LB.	6900	6900
71	NO. 144	1	LB.	7000	7000
72	NO. 146	1	LB.	7100	7100
73	NO. 148	1	LB.	7200	7200
74	NO. 150	1	LB.	7300	7300
75	NO. 152	1	LB.	7400	7400
76	NO. 154	1	LB.	7500	7500
77	NO. 156	1	LB.	7600	7600
78	NO. 158	1	LB.	7700	7700
79	NO. 160	1	LB.	7800	7800
80	NO. 162	1	LB.	7900	7900
81	NO. 164	1	LB.	8000	8000
82	NO. 166	1	LB.	8100	8100
83	NO. 168	1	LB.	8200	8200
84	NO. 170	1	LB.	8300	8300
85	NO. 172	1	LB.	8400	8400
86	NO. 174	1	LB.	8500	8500
87	NO. 176	1	LB.	8600	8600
88	NO. 178	1	LB.	8700	8700
89	NO. 180	1	LB.	8800	8800
90	NO. 182	1	LB.	8900	8900
91	NO. 184	1	LB.	9000	9000
92	NO. 186	1	LB.	9100	9100
93	NO. 188	1	LB.	9200	9200
94	NO. 190	1	LB.	9300	9300
95	NO. 192	1	LB.	9400	9400
96	NO. 194	1	LB.	9500	9500
97	NO. 196	1	LB.	9600	9600
98	NO. 198	1	LB.	9700	9700
99	NO. 200	1	LB.	9800	9800
100	NO. 202	1	LB.	9900	9900
101	NO. 204	1	LB.	10000	10000
102	NO. 206	1	LB.	10100	10100
103	NO. 208	1	LB.	10200	10200
104	NO. 210	1	LB.	10300	10300
105	NO. 212	1	LB.	10400	10400
106	NO. 214	1	LB.	10500	10500
107	NO. 216	1	LB.	10600	10600
108	NO. 218	1	LB.	10700	10700
109	NO. 220	1	LB.	10800	10800
110	NO. 222	1	LB.	10900	10900
111	NO. 224	1	LB.	11000	11000
112	NO. 226	1	LB.	11100	11100
113	NO. 228	1	LB.	11200	11200
114	NO. 230	1	LB.	11300	11300
115	NO. 232	1	LB.	11400	11400
116	NO. 234	1	LB.	11500	11500
117	NO. 236	1	LB.	11600	11600
118	NO. 238	1	LB.	11700	11700
119	NO. 240	1	LB.	11800	11800
120	NO. 242	1	LB.	11900	11900
121	NO. 244	1	LB.	12000	12000
122	NO. 246	1	LB.	12100	12100
123	NO. 248	1	LB.	12200	12200
124	NO. 250	1	LB.	12300	12300
125	NO. 252	1	LB.	12400	12400
126	NO. 254	1	LB.	12500	12500
127	NO. 256	1	LB.	12600	12600
128	NO. 258	1	LB.	12700	12700
129	NO. 260	1	LB.	12800	12800
130	NO. 262	1	LB.	12900	12900
131	NO. 264	1	LB.	13000	13000
132	NO. 266	1	LB.	13100	13100
133	NO. 268	1	LB.	13200	13200
134	NO. 270	1	LB.	13300	13300
135	NO. 272	1	LB.	13400	13400
136	NO. 274	1	LB.	13500	13500
137	NO. 276	1	LB.	13600	13600
138	NO. 278	1	LB.	13700	13700
139	NO. 280	1	LB.	13800	13800
140	NO. 282	1	LB.	13900	13900
141	NO. 284	1	LB.	14000	14000
142	NO. 286	1	LB.	14100	14100
143	NO. 288	1	LB.	14200	14200
144	NO. 290	1	LB.	14300	14300
145	NO. 292	1	LB.	14400	14400
146	NO. 294	1	LB.	14500	14500
147	NO. 296	1	LB.	14600	14600
148	NO. 298	1	LB.	14700	14700
149	NO. 300	1	LB.	14800	14800
150	NO. 302	1	LB.	14900	14900
151	NO. 304	1	LB.	15000	15000
152	NO. 306	1	LB.		