

GRADING NOTES

1. ALL GRADES SHOWN ARE .3 FEET BELOW FINISH GRADE TO ALLOW FOR LANDSCAPING; EXCEPT TC, FL, AND FG, WHICH ARE TO FINISH GRADE.
2. FINAL GRADES ADJACENT TO STRUCTURE AFTER LANDSCAPING SHALL BE 0.7 FEET BELOW FINISH FLOOR.
3. THE QUANTITIES SHOWN ARE ESTIMATES ONLY AND ARE NOT TO BE USED FOR BIDDING PURPOSES.
4. THE CONTRACTOR SHALL VERIFY ALL CONDITIONS AND DIMENSIONS AND REPORT ALL DISCREPANCIES TO THE ENGINEER BEFORE BEGINNING WORK.
5. FINISH FLOOR ELEVATION IS TO BE 1.0 FOOT ABOVE PAD GRADE.
6. ALL LOTS ARE TO BE F.H.A. TYPE "A" DRAINAGE.
7. ALL IMPROVEMENTS TO BE PROTECTED FROM EROSION.
8. ALL SLOPES ARE TO BE TWO FEET HORIZONTAL TO ONE FOOT VERTICAL UNLESS OTHERWISE NOTED.
9. SEE FINAL MAP FOR EXACT BEARINGS AND DISTANCES.
10. SEE DETAIL SHEETS FOR STREET SECTIONS AND DETAILS.

LEGEND

- 10' CURB TRANSITION
- EXISTING IMPROVEMENTS
- PROPOSED BLOCK RETAINING WALL
- PROPOSED BLOCK WALL
- SLAB BREAK
- INDEX CONTOUR
- INTERMEDIATE CONTOUR
- SCARP
- SWALE
- SETBACK LINE
- 9 LOT NUMBER
- 1 BLOCK NUMBER
- FG FINISH GRADE
- FL FLOW LINE
- TC TOP OF CURB
- 99.9 PAD GRADE

" I CERTIFY THAT THIS GRADING PLAN CONFORMS TO THE APPROVED DRAINAGE STUDY ON FILE AT THE CITY OF LAS VEGAS."

Edward F. Taney P.E. #9903 DATE

UNIT TWO PAVING QUANTITIES(PRIVATE)

2" ASPHALTIC CONCRETE PAVING	5,853 S.Y.
30" ROLL' TYPE CURB & GUTTER	1,901 L.F.
24" ISL CURB	2,382 S.F.
SIDEWALK	26,754 S.F.
24" VALLEY GUTTER	208 S.F.
8' VALLEY GUTTER	1,840 S.F.

DEVIATION FROM STANDARDS

CURVES #9 & #10 HAVE A RADIUS LESS THAN 300'
THIS IS A DEVIATION FROM STANDARDS

LINE DATA TABLE

NO.	BEARING	DISTANCE
L1	S61°37'25"E	11.24
L2	N81°57'25"W	7.42
L3	N02°11'46"E	19.41
L4	S24°23'25"E	18.83
L5	S83°59'38"W	7.14
L6	N28°45'36"W	4.12
L7	N30°19'56"W	10.00
L8	N25°34'06"W	4.33
L9	S38°00'07"E	3.79
L10	S33°56'05"E	11.30
L11	S56°06'52"W	9.27
L12	N56°06'52"E	6.49

SIDEWALK RAMP DATA CASE 1 RAMP

RAMP #	A	B	SLOPE
1	4.5'	15.0'	-4.13%
2	21.5'	4.5'	6.00%
3	8.0'	8.0'	1.80%

BCR & CURVE DATA AT BACK OF CURB

NO.	RADIUS	DELTA	LENGTH	TANGENT
C1	22.50	89°24'40"	35.11	22.23
C2	22.50	93°44'52"	36.81	24.02
C3	500.00	114°9'17"	102.87	51.62
C4	500.00	07°52'46"	68.16	34.44
C5	500.00	09°21'09"	81.62	40.90
C6	600.00	04°06'15"	42.80	21.41
C7	600.00	09°32'40"	99.35	50.09
C8	400.00	05°10'29"	36.13	18.08
C9	100.00	36°07'51"	63.06	32.62
C10	100.00	53°55'08"	94.11	50.96
C11	120.00	69°09'56"	144.88	82.73
C12	272.00	08°57'28"	42.53	21.31
C13	328.00	12°58'13"	74.29	37.28
C14	328.00	03°29'28"	19.99	10.00
C15	328.00	09°28'44"	54.28	27.19
C16	400.00	02°41'08"	18.16	9.38
C17	324.00	11°01'19"	62.33	31.28
C18	276.00	09°43'12"	46.82	23.47
C19	512.50	11°18'13"	100.87	50.60
C20	487.50	01°59'52"	17.00	8.50
C21	487.50	03°48'31"	32.40	16.21
C22	487.50	03°51'48"	30.03	15.09
C23	487.50	02°27'08"	20.98	10.43
C24	512.50	00°16'51"	2.51	1.28
C25	512.50	01°50'01"	16.40	8.20
C26	512.50	03°21'35"	30.02	15.03
C27	512.50	05°24'19"	21.52	10.78
C28	512.50	07°54'48"	84.51	42.32
C29	587.50	01°33'30"	15.98	7.99
C30	587.50	02°44'59"	28.20	14.10
C31	587.50	02°57'03"	30.28	15.13
C32	587.50	00°44'51"	7.67	3.83
C33	112.50	06°49'36"	13.40	6.71
C34	112.50	15°45'15"	30.93	15.56

NOTICE!
EXISTING UTILITIES ARE SHOWN ON PLANS FOR THE CONVEYANCE OF THE CONTRACTOR ONLY. THE CONTRACTOR IS RESPONSIBLE FOR VERIFYING THE LOCATION OF ALL UTILITIES. THE OWNER BEARS THE RESPONSIBILITY FOR UTILITIES NOT SHOWN OR SHOWN INCORRECTLY.
1-800-227-2800
LAS VEGAS, NEVADA 89102

BENCHMARK
BM # 106
2" BRASS CAP SUMMERLIN DATUM.
ELEVATION = 2927.86

APPROVED: [Signature]

DATE: 1/18/96

REVISION: [Table]

ALPHA ENGINEERING COMPANY

ROUGH GRADING PLAN

SUNSET MESA - UNIT 2

TITLE: [Blank]

PROJECT: [Blank]

JOB # NS-78-20

NAME: VERTREES/LDB/MAD

DATE: 1/18/96

SCALE: 1" = 30'

PAGE: 2

7620C-3 of 6

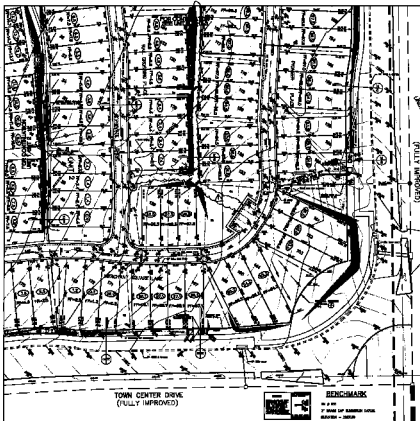

HILLCREST AVENUE
(RESUBDIVISION)
BY THE CITY OF SUNSHINE

HILLCREST AVENUE
(RESUBDIVISION)
BY THE CITY OF SUNSHINE

TOWN CENTER DRIVE
(FULLY IMPROVED)



BENCHMARK
17
7' READ UP BENCHMARK SIGN
BENCH - 1000

GRADING NOTES

1. EXISTING GRADE SHOWN BY DASHED LINES. GRADE TO BE MAINTAINED BY DOTTED LINES.
2. ALL GRADES TO BE MAINTAINED UNLESS OTHERWISE NOTED.
3. ALL GRADES TO BE MAINTAINED UNLESS OTHERWISE NOTED.
4. ALL GRADES TO BE MAINTAINED UNLESS OTHERWISE NOTED.
5. ALL GRADES TO BE MAINTAINED UNLESS OTHERWISE NOTED.
6. ALL GRADES TO BE MAINTAINED UNLESS OTHERWISE NOTED.
7. ALL GRADES TO BE MAINTAINED UNLESS OTHERWISE NOTED.
8. ALL GRADES TO BE MAINTAINED UNLESS OTHERWISE NOTED.
9. ALL GRADES TO BE MAINTAINED UNLESS OTHERWISE NOTED.
10. ALL GRADES TO BE MAINTAINED UNLESS OTHERWISE NOTED.

LEGEND

- 1. 1" = 10' HORIZONTAL
- 2. 1" = 10' VERTICAL
- 3. 1" = 10' CURVE RADIUS
- 4. 1" = 10' CURVE CHORD
- 5. 1" = 10' CURVE OFFSET
- 6. 1" = 10' CURVE CHORD BEARING
- 7. 1" = 10' CURVE CHORD BEARING
- 8. 1" = 10' CURVE CHORD BEARING
- 9. 1" = 10' CURVE CHORD BEARING
- 10. 1" = 10' CURVE CHORD BEARING

UNIT TWO PAVING QUANTITIES (PRIVATE)

1" ASPHALT CONCRETE SURFACE	880 S.F.
1" 1/2" ASPHALT CONCRETE SURFACE	520 S.F.
1" 1/2" ASPHALT CONCRETE SURFACE	520 S.F.
1" 1/2" ASPHALT CONCRETE SURFACE	520 S.F.
1" 1/2" ASPHALT CONCRETE SURFACE	520 S.F.
1" 1/2" ASPHALT CONCRETE SURFACE	520 S.F.

DEVIATION FROM STANDARDS

NOTED AS PER PLAN & CHECK WITH THE CITY OF SUNSHINE

LINE DATA SHEET

LINE NO.	START STATION	END STATION	CHORD BEARING	CHORD DIST.	CHORD OFFSET
1	0+00	0+10	N 89° 00' 00" W	10.00	0.00
2	0+10	0+20	N 89° 00' 00" W	10.00	0.00
3	0+20	0+30	N 89° 00' 00" W	10.00	0.00
4	0+30	0+40	N 89° 00' 00" W	10.00	0.00
5	0+40	0+50	N 89° 00' 00" W	10.00	0.00

REVERSE CURVE DATA SHEET

LINE NO.	START STATION	END STATION	CHORD BEARING	CHORD DIST.	CHORD OFFSET
1	0+00	0+10	N 89° 00' 00" W	10.00	0.00
2	0+10	0+20	N 89° 00' 00" W	10.00	0.00
3	0+20	0+30	N 89° 00' 00" W	10.00	0.00
4	0+30	0+40	N 89° 00' 00" W	10.00	0.00
5	0+40	0+50	N 89° 00' 00" W	10.00	0.00

FOR A CURVE DATA AT BACK OF CURVE

LINE NO.	START STATION	END STATION	CHORD BEARING	CHORD DIST.	CHORD OFFSET
1	0+00	0+10	N 89° 00' 00" W	10.00	0.00
2	0+10	0+20	N 89° 00' 00" W	10.00	0.00
3	0+20	0+30	N 89° 00' 00" W	10.00	0.00
4	0+30	0+40	N 89° 00' 00" W	10.00	0.00
5	0+40	0+50	N 89° 00' 00" W	10.00	0.00

LINE NO.	START STATION	END STATION	CHORD BEARING	CHORD DIST.	CHORD OFFSET
1	0+00	0+10	N 89° 00' 00" W	10.00	0.00
2	0+10	0+20	N 89° 00' 00" W	10.00	0.00
3	0+20	0+30	N 89° 00' 00" W	10.00	0.00
4	0+30	0+40	N 89° 00' 00" W	10.00	0.00
5	0+40	0+50	N 89° 00' 00" W	10.00	0.00

THE CITY OF SUNSHINE
 SUNSHINE AVENUE
 SUNSHINE, ARIZONA 85701
 480-944-2200
 480-944-2201
 480-944-2202
 480-944-2203
 480-944-2204
 480-944-2205
 480-944-2206
 480-944-2207
 480-944-2208
 480-944-2209
 480-944-2210
 480-944-2211
 480-944-2212
 480-944-2213
 480-944-2214
 480-944-2215
 480-944-2216
 480-944-2217
 480-944-2218
 480-944-2219
 480-944-2220
 480-944-2221
 480-944-2222
 480-944-2223
 480-944-2224
 480-944-2225
 480-944-2226
 480-944-2227
 480-944-2228
 480-944-2229
 480-944-2230
 480-944-2231
 480-944-2232
 480-944-2233
 480-944-2234
 480-944-2235
 480-944-2236
 480-944-2237
 480-944-2238
 480-944-2239
 480-944-2240
 480-944-2241
 480-944-2242
 480-944-2243
 480-944-2244
 480-944-2245
 480-944-2246
 480-944-2247
 480-944-2248
 480-944-2249
 480-944-2250

ALPHA & OMEGA ENGINEERING COMPANY
 1000 N. GILBERT AVENUE, SUITE 100
 SUNSHINE, ARIZONA 85701
 480-944-2200
 480-944-2201
 480-944-2202
 480-944-2203
 480-944-2204
 480-944-2205
 480-944-2206
 480-944-2207
 480-944-2208
 480-944-2209
 480-944-2210
 480-944-2211
 480-944-2212
 480-944-2213
 480-944-2214
 480-944-2215
 480-944-2216
 480-944-2217
 480-944-2218
 480-944-2219
 480-944-2220
 480-944-2221
 480-944-2222
 480-944-2223
 480-944-2224
 480-944-2225
 480-944-2226
 480-944-2227
 480-944-2228
 480-944-2229
 480-944-2230
 480-944-2231
 480-944-2232
 480-944-2233
 480-944-2234
 480-944-2235
 480-944-2236
 480-944-2237
 480-944-2238
 480-944-2239
 480-944-2240
 480-944-2241
 480-944-2242
 480-944-2243
 480-944-2244
 480-944-2245
 480-944-2246
 480-944-2247
 480-944-2248
 480-944-2249
 480-944-2250

ROUGH GRADING PLAN
 SUNSHINE AVENUE - UNIT 2

2

11-27-52

107Y-4445-2