

JOB NO. 701.170



* NOTE:
A MINIMUM 2' HIGH FLOOD WALL SHALL BE CONSTRUCTED AS PART OF THIS PERIMETER WALL, ADJACENT TO LOTS 185 THRU 221.

I CERTIFY THAT THIS GRADING PLAN IS IN CONFORMANCE WITH THE CITY ENGINEERING STUDY ON FILE AT THE CITY OF LAS VEGAS FOR THIS PROJECT.

DATE: 10/21/10
P.L.E. NO. DATE

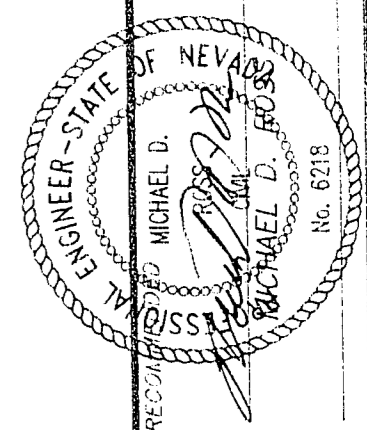

G.C. WALLACE, INC.
Engineering Architecture

DEL WEBB COMMUNITIES, INC.
SUN CITY LAS VEGAS UNIT NO. 40
GRADING PLAN III

SHEET 26 OF 32 SHEETS

MATCH LINE - SEE SHEET 27

WALL NOTES:
1. APPROVAL OF THESE PLANS BY THE CITY ENGINEER DOES NOT PERTAIN TO CONSTRUCTION OF NEW WALLS (RETAINING OR NON-RETAINING) OR MODIFICATIONS TO EXISTING WALLS.
2. ALL WALLS, NEW OR EXISTING, ARE REVIEWED BY THE CITY ENGINEER FOR GRADING RELATIONSHIPS ONLY.
3. ALL WALLS, RETAINING AND NON-RETAINING, MUST BE APPROVED AND A PERMIT OBTAINED FROM THE DEPARTMENT OF BUILDING AND SAFETY.

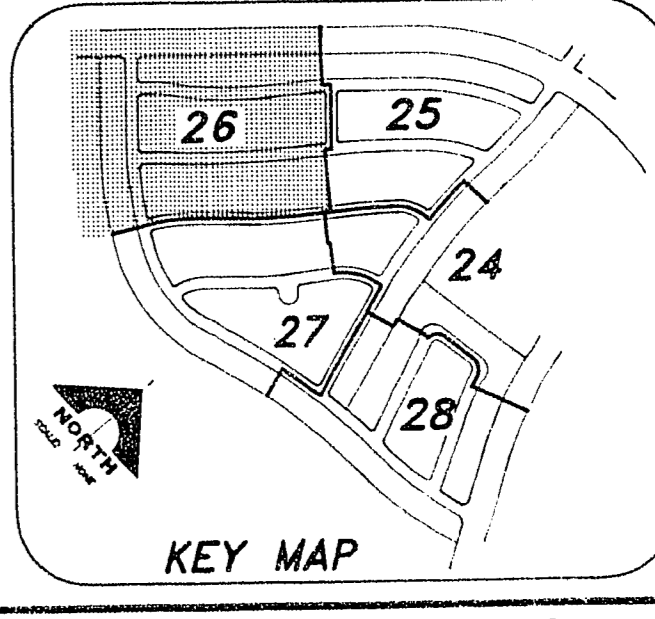

10-20-26-1074-4/41-40