

FINAL MAP OF SUN CITY LAS VEGAS - UNIT NO. 38 AT SUMMERLIN

A PLANNED DEVELOPMENT AND COMMON INTEREST COMMUNITY

BEING A SUBDIVISION OF ALL OF PARCEL 2 AS SHOWN BY MAP THEREOF ON FILE IN FILE 72, PAGE 57 OF PARCEL MAPS IN THE CLARK COUNTY RECORDER'S OFFICE, CLARK COUNTY, NEVADA, LYING WITHIN SECTION 13, TOWNSHIP 20 SOUTH, RANGE 59 EAST, M.D.M., CITY OF LAS VEGAS, CLARK COUNTY, NEVADA

NOTE:
FOR SIDE PROPERTY LINES: SET CONCRETE NAIL AND TIN IN THE REAR WALL ON THE PROPERTY LINE PROJECTED. SET SAWCUT IN THE BACK OF CURB AT THE FRONT OF THE LOT ON THE PROPERTY LINE PROJECTED.

SET 2"x2" HUB AND TACK AT LOT CORNERS WHERE THERE IS NO BLOCK WALL.

NOTE:
DIRECT VEHICULAR ACCESS TO CHILDRESS DRIVE FROM ABUTTING LOTS IS PROHIBITED.

NOTE:
LOTS 33 THROUGH 40, INCLUSIVE, AND LOT 139 AND LOT 140 CONTAIN 2,924 SF EACH.

LOT 7
SUN CITY LAS VEGAS
UNIT NO. 31
BOOK 53, PAGE 01
OF PLATS

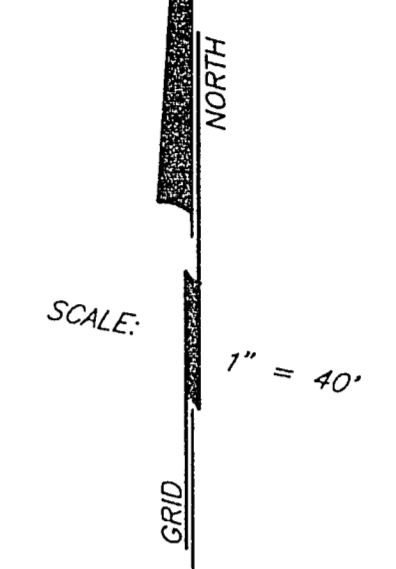

SEE SHEET 2 FOR KEY MAP AND BASIS OF BEARING

MATCH LINE - SEE SHEET 4 OF 6

MATCH LINE - SEE SHEET 3 OF 6

LEGEND

- SET 5/8" REBAR AND ALUM. CAP STAMPED P.L.S. 7755 W/ ALUMINIUM CAP TIES IN TOP OF CURB (UNLESS OTHERWISE NOTED)
- SET MONUMENTATION PER N.R.S. 278.371
- 47 LOT NUMBER
TOTAL RESIDENTIAL LOTS = 144
COMMON LOTS IN SUBDIVISION = 3
- ② BLOCK NUMBER
- ⑦ CURVE NUMBER
- L1 LINE SEGMENT NUMBER
- SUBDIVISION BOUNDARY LINE
- STREET CENTERLINE

LINE	BEARING	DISTANCE
L1	S 28°03'46" E	10.00'
L2	S 61°56'14" W	3.00'
L3	S 61°56'14" W	18.00'
L4	N 61°56'14" E	15.00'
L5	N 61°56'14" E	16.75'
L6	S 28°03'46" E	18.00'
L7	S 28°03'46" E	19.00'
L8	N 61°56'14" E	18.00'
L9	S 28°03'46" E	34.00'
L10	S 28°03'46" E	13.00'

CURVE	DELTA	RADIUS	LENGTH	TANGENT
1	00°53'54"	1330.00'	20.85'	10.43'
2	01°21'48"	1330.00'	31.65'	15.83'
3	80°00'00"	13.00'	20.42'	13.00'
4	87°32'04"	13.00'	19.86'	12.45'
5	88°24'30"	13.00'	20.06'	12.64'
6	88°38'05"	13.00'	20.11'	12.69'
7	11°24'06"	325.00'	64.67'	32.44'
8	11°24'12"	275.00'	54.73'	27.46'