

MONUMENT TIE MAP

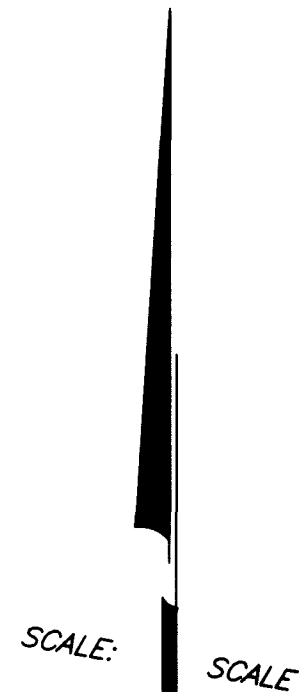

SEE SHEET 2 FOR KEY MAP AND BASIS OF BEARINGS

LOT 6
SUN CITY LAS VEGAS - UNIT NO. 31
BOOK 52, PAGE 01
OF PLATS

$\Delta = 90^{\circ}00'00''$
 $R = 165.00'$
 $L = 259.18'$
 $T = 165.00'$

LOT 6
SUN CITY LAS VEGAS - UNIT NO. 31
BOOK 52, PAGE 01
OF PLATS

I, LENNIS BOSWORTH, A PROFESSIONAL LAND SURVEYOR REGISTERED IN THE STATE OF NEVADA, DO HEREBY CERTIFY THAT THE MONUMENTS HAVE BEEN SET AND TIES ESTABLISHED AS SHOWN HEREON.

Lennis Bosworth
LENNIS BOSWORTH, P.L.S.
NEVADA CERTIFICATE NO. 5221

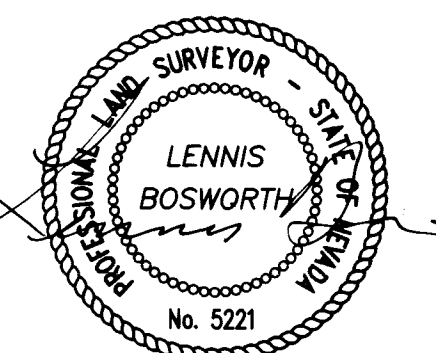

8-22-97

| CURVE | DELTA | RADIUS | LENGTH | TANGENT |
|-------|-----------|----------|--------|---------|
| 1 | 02°07'06" | 1000.00' | 36.97' | 18.49' |
| 2 | 01°03'34" | 1000.00' | 18.49' | 9.24' |
| 3 | 01°03'32" | 1000.00' | 18.48' | 9.24' |
| 4 | 02°07'06" | 1025.00' | 37.90' | 18.95' |

POINT OF BEGINNING

MATCH LINE - SEE SHEET 4 OF 5

NOTE:
DIRECT VEHICULAR ACCESS TO THOMAS W. RYAN BOULEVARD FROM ADJACENT LOTS IS PROHIBITED.

LEGEND

- SET 5/8" REBAR AND ALUM. CAP STAMPED P.L.S. NUM W/7755 REFERENCE TIES IN TOP OF CURB (UNLESS OTHERWISE NOTED)
- SET MONUMENTATION PER N.R.S. 278.371
- 102 LOT NUMBERS = 103
TOTAL LOTS
COMMON LOTS = 1

- ① BLOCK NUMBER
- ② CURVE NUMBER
- SUBDIVISION BOUNDARY LINE
- STREET CENTERLINE

NOTE:
FOR SIDE PROPERTY LINES: SET CONCRETE NAIL AND TIN IN THE REAR WALL ON THE PROPERTY LINE PROJECTED. SET SAWCUT IN THE BACK OF CURB AT THE FRONT OF THE LOT ON THE PROPERTY LINE PROJECTED.

SET 2" x 2" HUB AND TACK AT LOT CORNERS WHERE THERE IS NO BLOCK WALL.

SUN CITY LAS VEGAS - UNIT NO. 41

AT SUMMERLIN

A PLANNED DEVELOPMENT AND COMMON INTEREST COMMUNITY

BEING A SUBDIVISION OF A PORTION OF PARCEL 3 AS SHOWN BY MAP THEREOF ON FILE IN FILE 72, PAGE 57 OF PARCEL MAPS IN THE CLARK COUNTY RECORDER'S OFFICE, CLARK COUNTY, NEVADA, LYING WITHIN SECTION 13, TOWNSHIP 20 SOUTH, RANGE 59 EAST, M.D.M., CITY OF LAS VEGAS, CLARK COUNTY, NEVADA

