

CURVE DATA (1) INDICATES CURVE NUMBER

CURVE	DELTA	RADIUS	LENGTH	TANGENT
1	152°43'	1100.00'	295.83'	148.81'
2	19°43'55"	1062.50'	365.91'	184.78'
3	19°43'55"	1081.50'	372.45'	188.06'
4	19°43'55"	1118.50'	385.20'	194.53'
5	19°43'55"	1137.50'	391.74'	197.83'
6	04°19'24"	1100.00'	63.00'	41.52'

NOTE: CURVE DATA REPRESENTS PARTIAL CURVE, THIS SHEET ONLY.

CONSTRUCTION NOTES

IMPROVEMENTS

- 1. INSTALL A.C. PAVEMENT PER STREET SECTIONS, SEE SHEET 32
- 2. INSTALL "L" TYPE CURB & GUTTER (S-47)
- 3. ADJUST EXISTING WATER FACILITY TO GRADE

WATER

- 1. INSTALL CAP W/ 2" BLOW-OFF ASSEMBLY
- 2. INSTALL FIRE HYDRANT ASSEMBLY (U-33)
- 3. INSTALL 8" GATE VALVE & BOX (U-34)
- 4. INSTALL 8" X 8" X 8" TEE

STREET LIGHTING

- 1. STREET LIGHT OR COMMON TRENCH, SEE ELECTRICAL PLAN
- 2. SINGLE STREET LIGHT, SEE ELECTRICAL PLAN (E-2)

IRRIGATION

- 1. BANK "A": 1-6" & 2-4" SDR35 PVC

RECOMMENDED

BY: A. HUGHES

DATE: 10/25/97

P.E. NO. 10259

DATE: 10/25/97

100% SUBMITTAL 02-05-97

PALO BREA ROAD

SCALE: HORIZ. 1" = 20'
VERT. 1" = 5'

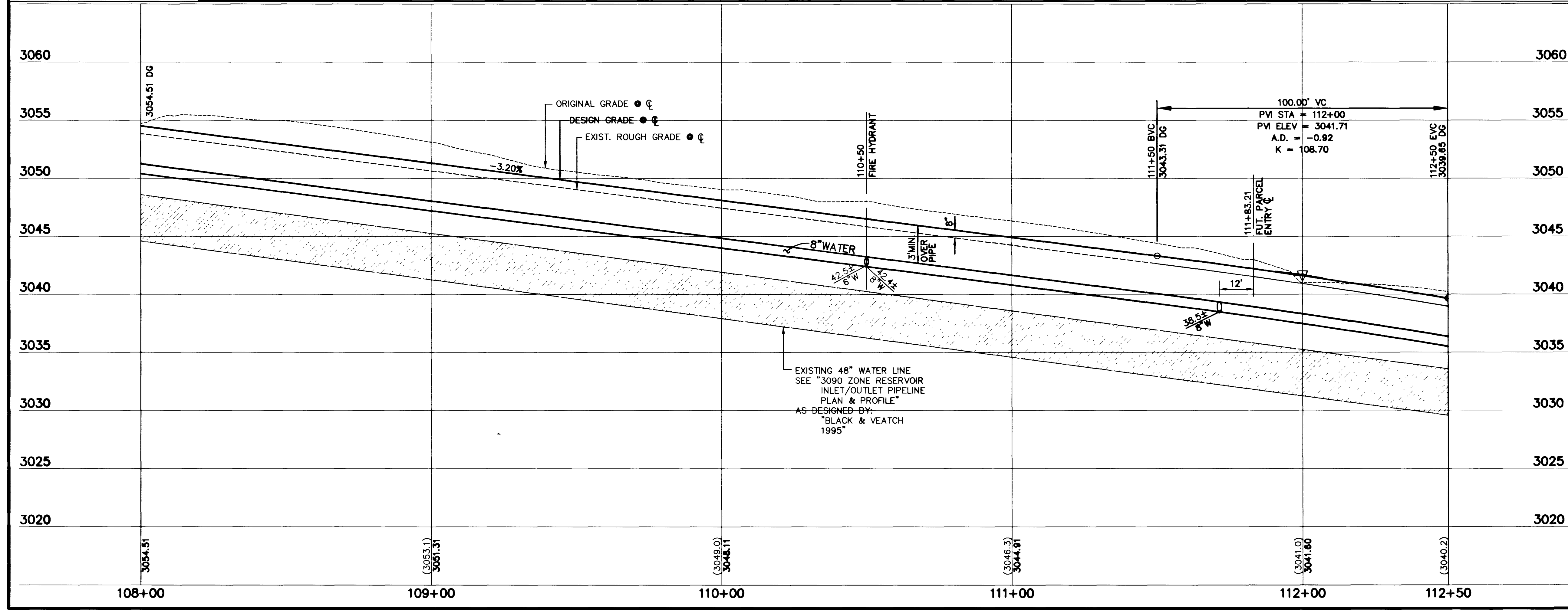
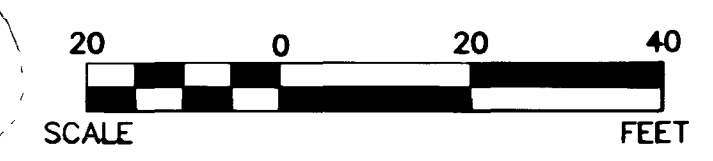

NOTE TO CONTRACTOR:

- ALL EXISTING UTILITY CROSSINGS MUST BE VERIFIED PRIOR TO CONSTRUCTION OF ANY MAIN LINES OR LATERALS THAT MAY BE ADVERSELY EFFECTED. ANY DISCREPANCIES IN LOCATION AND/OR ELEVATION MUST BE PROVIDED TO THE ENGINEER FOR ACCEPTANCE PRIOR TO CONSTRUCTION.
- TOPOGRAPHY SHOWN HEREIN REFLECTS ORIGINAL EXISTING TOPOGRAPHY. ACTUAL FIELD CONDITIONS INCLUDE SITE ROUGH GRADING.
- ALL COMMON LOTS AS SHOWN HEREIN TO BE PRIVATELY MAINTAINED BY THE H.O.A.
- ALL WATER LINE GATE VALVES, SERVICE GATE VALVES, AND FIRE HYDRANT GATE VALVES ARE TO BE CONSTRUCTED UNDER A.C. PAVEMENT. IT IS THE CONTRACTOR'S RESPONSIBILITY TO VERIFY THAT ALL WATER VALVES CANS DO NOT CREATE CONFLICTS WITH THE PROPOSED CURB LINE PRIOR TO PLACEMENT OF CONCRETE. ALL WATER FACILITIES SHOWN IN THESE DRAWINGS HAVE BEEN "SCALED-UP" FOR CLARITY ONLY.

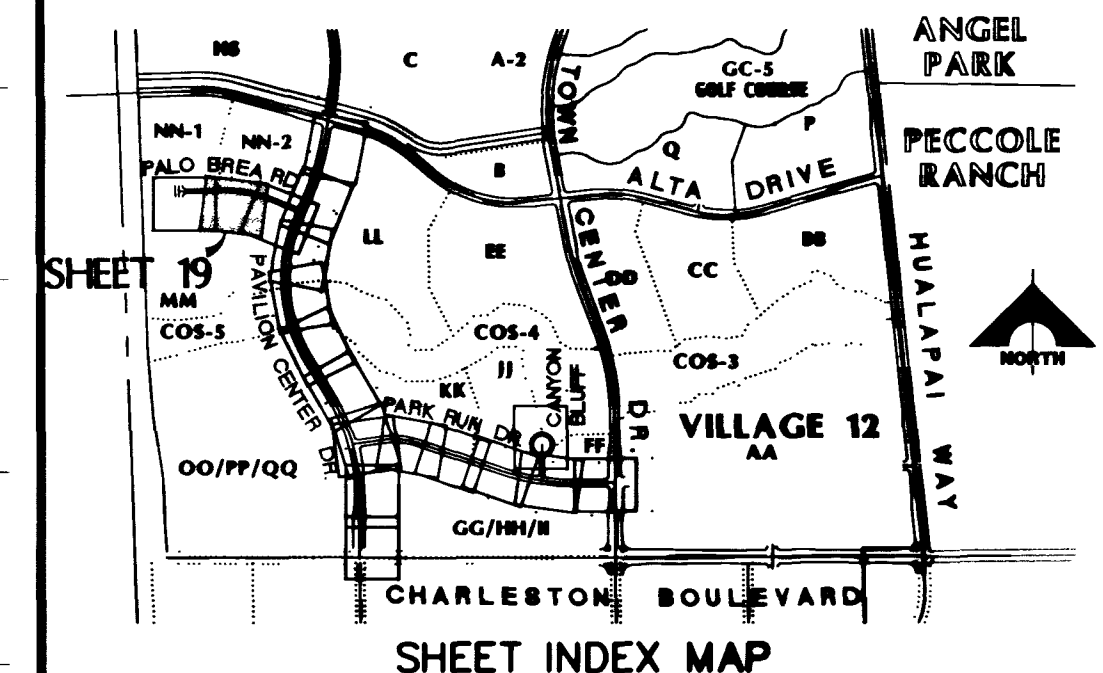

APPROVAL:

[Signature] 2-28-97

LAS VEGAS VALLEY WATER DISTRICT DATE

RECOMMENDED

BY: A. HUGHES

DATE: 10/25/97

P.E. NO. 10259

DATE: 10/25/97

100% SUBMITTAL 02-05-97

G. C. WALLACE, INC.
Engineering/Architecture
1555 SOUTH RAINBOW BLVD. LAS VEGAS, NEVADA 89102 (702) 363-1200
SUMMERLIN DIVISION (702) 363-0091

SUMMERLIN
VILLAGE 12 UNIT 2C IMPROVEMENTS
PALO BREA ROAD
PLAN & PROFILE
STA 108+00 TO 112+50

SHEET 19

DATE: 2-28-97

SHT 19 OF 41

JOB NO. 82011214

C:\VMS\12\UNIT-2C\IMPROV\1208P019.FRT Feb 14 15:21:41 1997 BY GT

8547 11-31-98 107Y-4463-2C

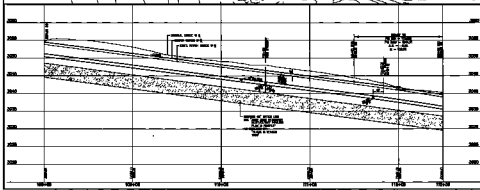
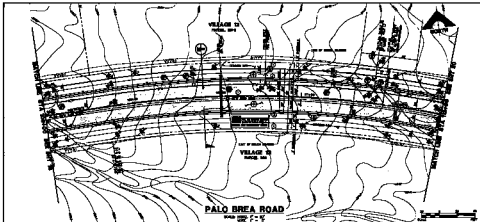

CHANGE DATA

NO.	DATE	BY	REVISION

GENERAL NOTES

1. ALL WORK SHALL BE IN ACCORDANCE WITH THE STANDARD SPECIFICATIONS FOR HIGHWAY CONSTRUCTION, 1988 EDITION, AS AMENDED.
2. THE CONTRACTOR SHALL BE RESPONSIBLE FOR OBTAINING ALL NECESSARY PERMITS AND APPROVALS FROM THE APPROPRIATE AGENCIES.
3. THE CONTRACTOR SHALL MAINTAIN ACCESS TO ALL ADJACENT PROPERTIES AT ALL TIMES.
4. THE CONTRACTOR SHALL MAINTAIN THE EXISTING UTILITIES AND SHALL BE RESPONSIBLE FOR ANY DAMAGE TO THEM.
5. THE CONTRACTOR SHALL MAINTAIN THE EXISTING DRAINAGE SYSTEM AND SHALL BE RESPONSIBLE FOR ANY DAMAGE TO IT.
6. THE CONTRACTOR SHALL MAINTAIN THE EXISTING EROSION CONTROL MEASURES AND SHALL BE RESPONSIBLE FOR ANY DAMAGE TO THEM.
7. THE CONTRACTOR SHALL MAINTAIN THE EXISTING LANDSCAPING AND SHALL BE RESPONSIBLE FOR ANY DAMAGE TO IT.
8. THE CONTRACTOR SHALL MAINTAIN THE EXISTING SIGNAGE AND SHALL BE RESPONSIBLE FOR ANY DAMAGE TO IT.
9. THE CONTRACTOR SHALL MAINTAIN THE EXISTING FENCING AND SHALL BE RESPONSIBLE FOR ANY DAMAGE TO IT.
10. THE CONTRACTOR SHALL MAINTAIN THE EXISTING UTILITIES AND SHALL BE RESPONSIBLE FOR ANY DAMAGE TO THEM.

APPROVAL:

 PROJECT ENGINEER

 SUPERVISOR

DATE: 10/15/10

SCALE: 1" = 40' PLAN, 1" = 10' SECTION

PROJECT INFORMATION:

PROJECT NO. 107Y-4483-2C

DATE: 10/15/10

SCALE: 1" = 40' PLAN, 1" = 10' SECTION

DATE PLOTTED: 10/15/10 10:15 AM