

PARK RUN DRIVE

SCALE: HORIZ. 1" = 20'
VERT. 1" = 5'

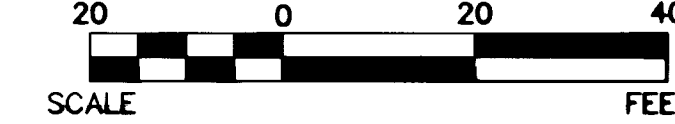

CURVE DATA ① INDICATES CURVE NUMBER

CURVE	DELTA	RADIUS	LENGTH	TANGENT
1	25°14'33"	650.00'	286.37'	145.50'
2	25°14'33"	620.00'	273.15'	138.83'
3	25°14'33"	680.00'	299.58'	152.28'

CONSTRUCTION NOTES

- IMPROVEMENTS**
- ① INSTALL A.C. PAVEMENT PER STREET SECTIONS, SEE SHEET 32
 - ② INSTALL "L" TYPE CURB & GUTTER (S-47)
 - ③ INSTALL "A" TYPE ISLAND CURB (S-50)
 - ④ INSTALL HANDICAP RAMP CURB DEPRESSION (S-75)

- SEWER**
- ⑤ INSTALL 48" DIA. SEWER MANHOLE (SD1-GLV)
 - ⑥ INSTALL TEMPORARY PLUG

- STORM DRAIN**
- ⑦ INSTALL TYPE II STORM DRAIN MANHOLE (SD1-DA)

- STREET LIGHTING**
- ⑧ STREET LIGHT OR COMMON TRENCH, SEE ELECTRICAL PLAN
 - ⑨ SINGLE STREET LIGHT, SEE ELECTRICAL PLAN (E-2)

- IRRIGATION**
- ⑩ BANK "A"; 1-6" & 2-4" SDR35 PVC

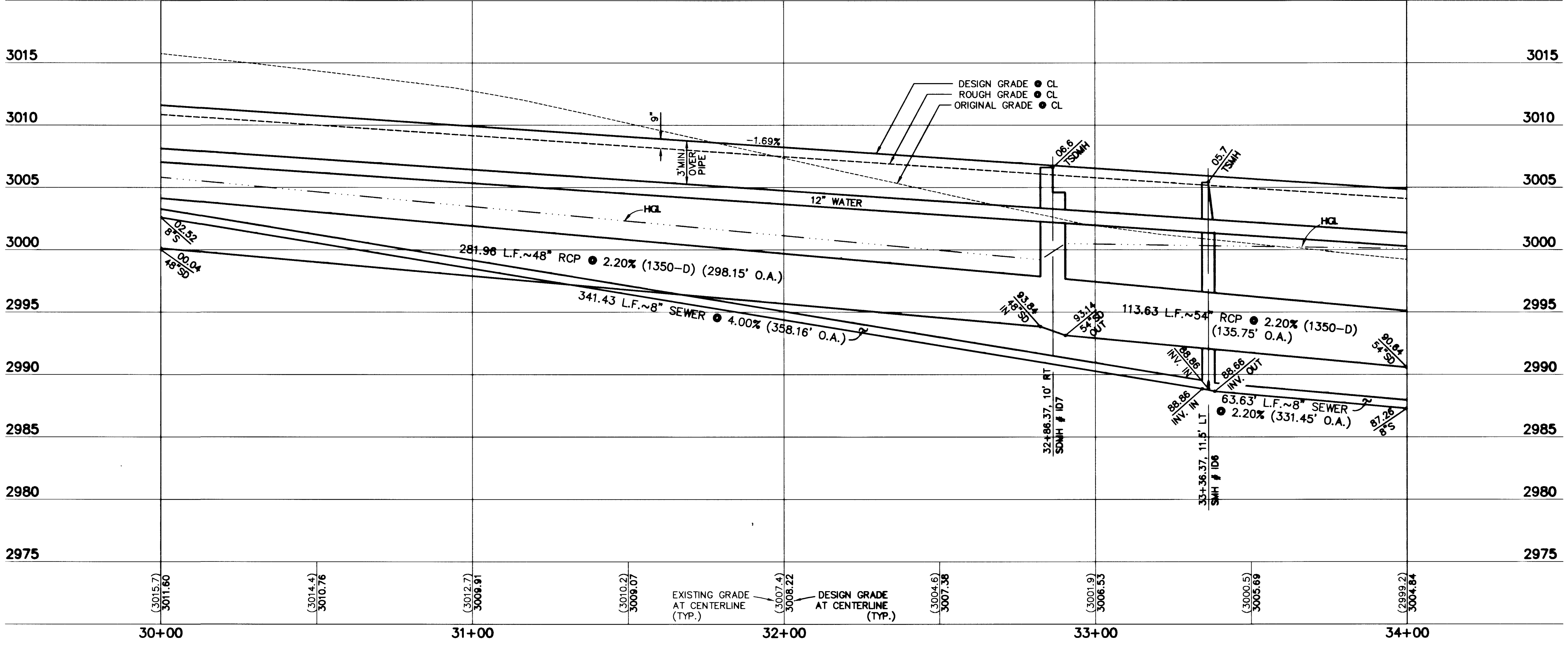
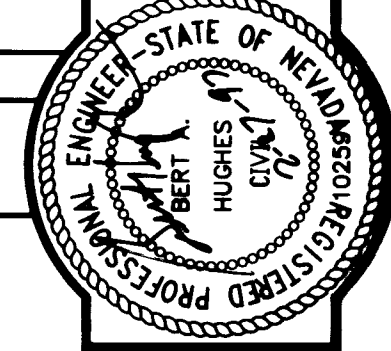

NOTE TO CONTRACTOR:

- ALL EXISTING UTILITY CROSSINGS MUST BE VERIFIED PRIOR TO CONSTRUCTION OF ANY MAIN LINES OR LATERALS THAT MAY BE ADVERSELY EFFECTED. ANY DISCREPANCIES IN LOCATION AND/OR ELEVATION MUST BE PROVIDED TO THE ENGINEER FOR ACCEPTANCE PRIOR TO CONSTRUCTION.
- TOPOGRAPHY SHOWN HEREIN REFLECTS ORIGINAL EXISTING TOPOGRAPHY. ACTUAL FIELD CONDITIONS INCLUDE SITE ROUGH GRADING.
- ALL COMMON LOTS AS SHOWN HEREIN TO BE PRIVATELY MAINTAINED BY THE H.O.A.
- ALL WATER LINE GATE VALVES, SERVICE GATE VALVES, AND FIRE HYDRANT GATE VALVES ARE TO BE CONSTRUCTED UNDER A.C. PAVEMENT. IT IS THE CONTRACTOR'S RESPONSIBILITY TO VERIFY THAT ALL WATER VALVES CANS DO NOT CREATE CONFLICTS WITH THE PROPOSED CURB LINE PRIOR TO PLACEMENT OF CONCRETE. ALL WATER FACILITIES SHOWN IN THESE DRAWINGS HAVE BEEN "SCALED-UP" FOR CLARITY ONLY.

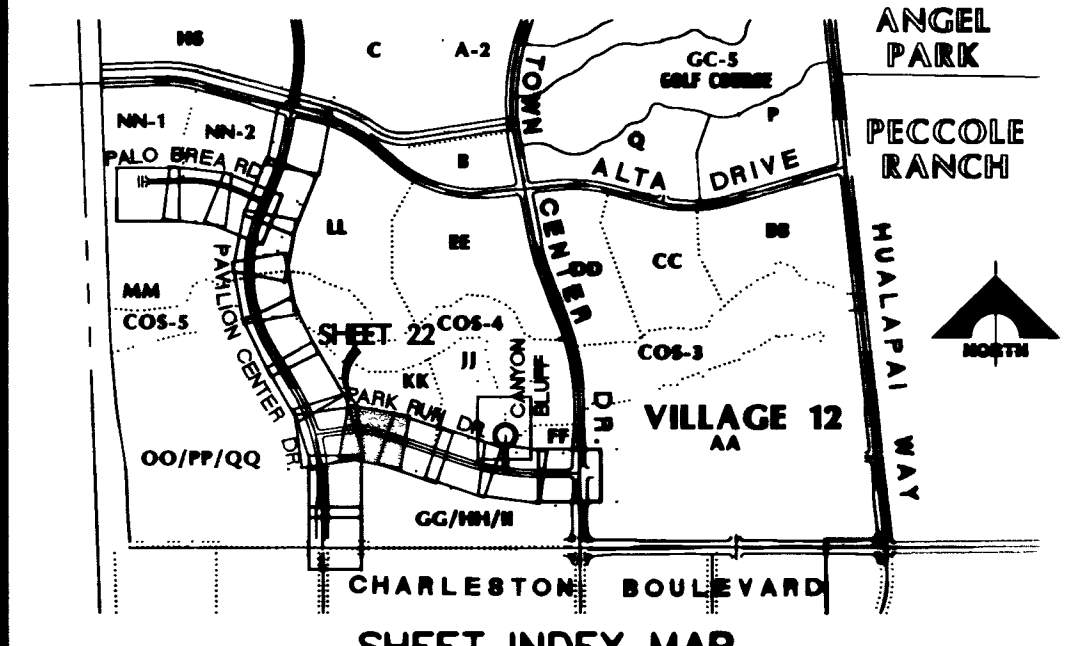

APPROVAL: *[Signature]* 2-28-97
LAS VEGAS VALLEY WATER DISTRICT DATE

100% SUBMITTAL 02-08-97
 RECOMMENDED
 G. C. WALLACE, INC.
 Engineering/Architecture
 1555 SOUTH RAINBOW BLVD., LAS VEGAS, NEVADA 89102 (702) 363-1200
 SUMMERLIN DIVISION (702) 363-0981
SUMMERLIN
VILLAGE 12 UNIT 2C IMPROVEMENTS
PARK RUN DRIVE
PLAN & PROFILE
STA 30+00 TO 34+00
 SHEET
22
 SHT 22 OF 41
 JOB NO. 62011214

C:\DRAWINGS\VL11-12\UNIT-2C\IMPROV\10100\12IDP022 Sat Feb 15 17:16:50 1997 by SIS/OT

0550 11-31-62 107Y-4463-2C

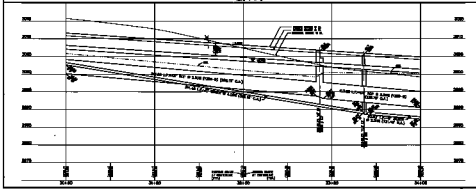
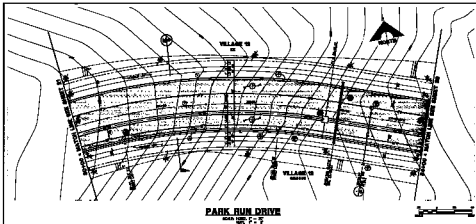

GENEVE DATA

DATE	BY	SCALE	PROJECT	REVISION
1/1/00	JG	AS SHOWN	10000000	1

CONSTRUCTION NOTES

REVISIONS

1. ALL NOTES TO BE OBSERVED FOR BEST RESULTS, BE AWARE OF THE ORDER OF THE ROAD WORK.
2. ALL NOTES TO BE OBSERVED FOR BEST RESULTS, BE AWARE OF THE ORDER OF THE ROAD WORK.
3. ALL NOTES TO BE OBSERVED FOR BEST RESULTS, BE AWARE OF THE ORDER OF THE ROAD WORK.

GENERAL NOTES

1. ALL NOTES TO BE OBSERVED FOR BEST RESULTS, BE AWARE OF THE ORDER OF THE ROAD WORK.
2. ALL NOTES TO BE OBSERVED FOR BEST RESULTS, BE AWARE OF THE ORDER OF THE ROAD WORK.
3. ALL NOTES TO BE OBSERVED FOR BEST RESULTS, BE AWARE OF THE ORDER OF THE ROAD WORK.

SCALE: 1" = 40' HORIZ. 1" = 10' VERT.

DATE: 1/1/00

PROJECT: 10000000

BY: JG

CHECKED: JG

APPROVED: JG

22

107Y-1483-2C