

JOB NO. JOB NO. 62011.213  
 October 24, 1996 8:14:37 a.m.  
 Drawing: C:\DWG\11-12\B\IMPROV\LG-WLATT.DWG

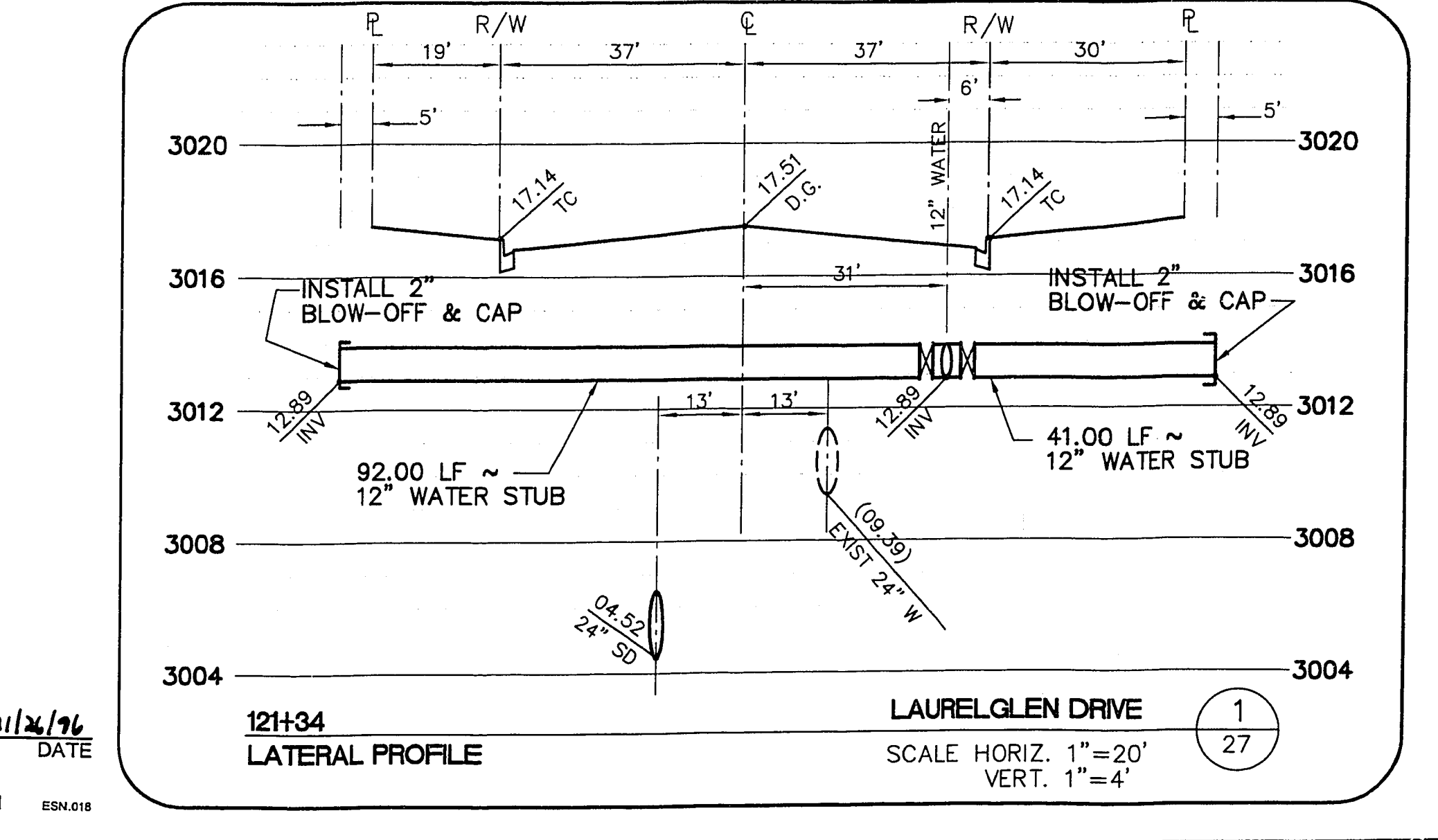
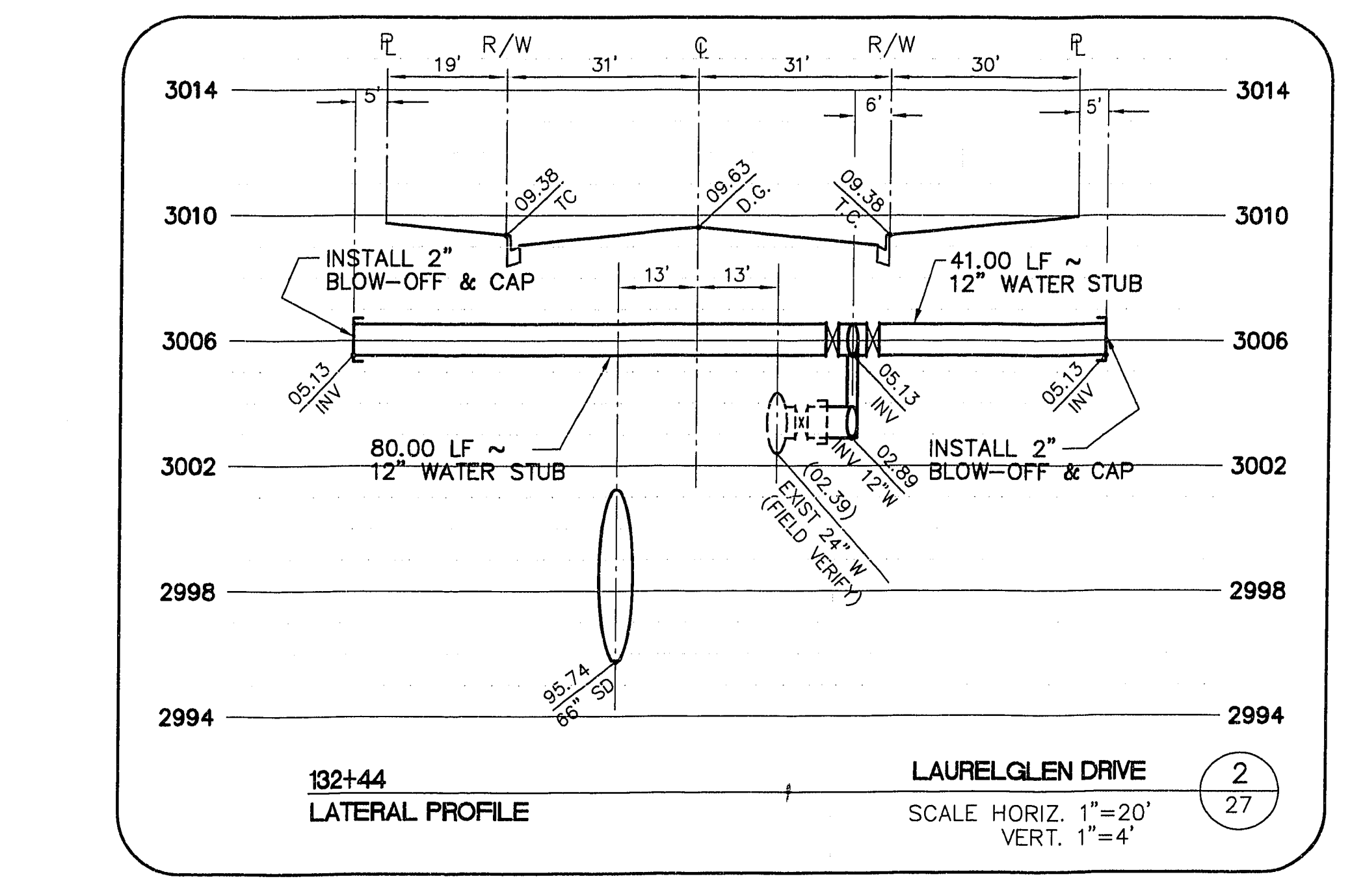
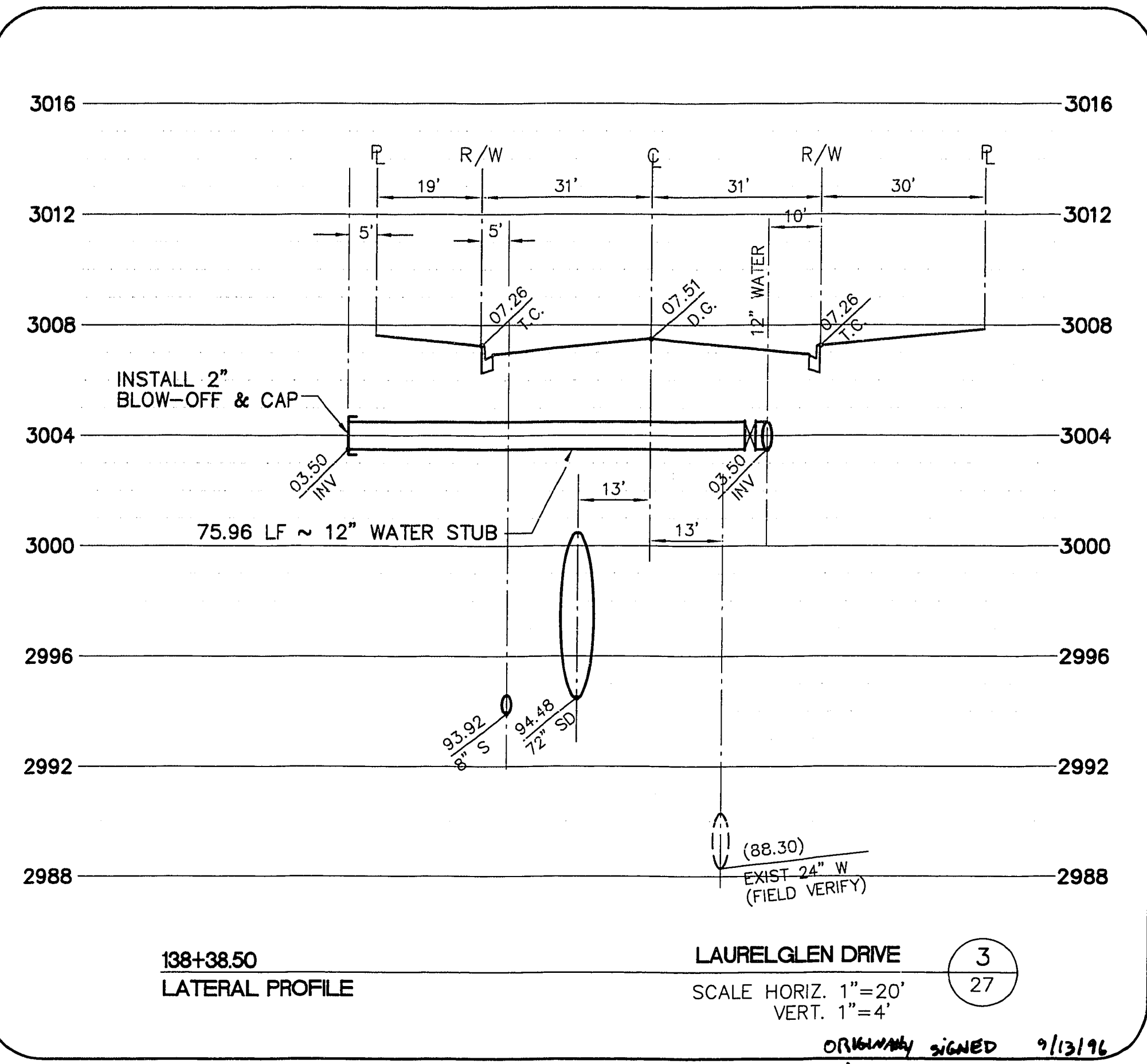
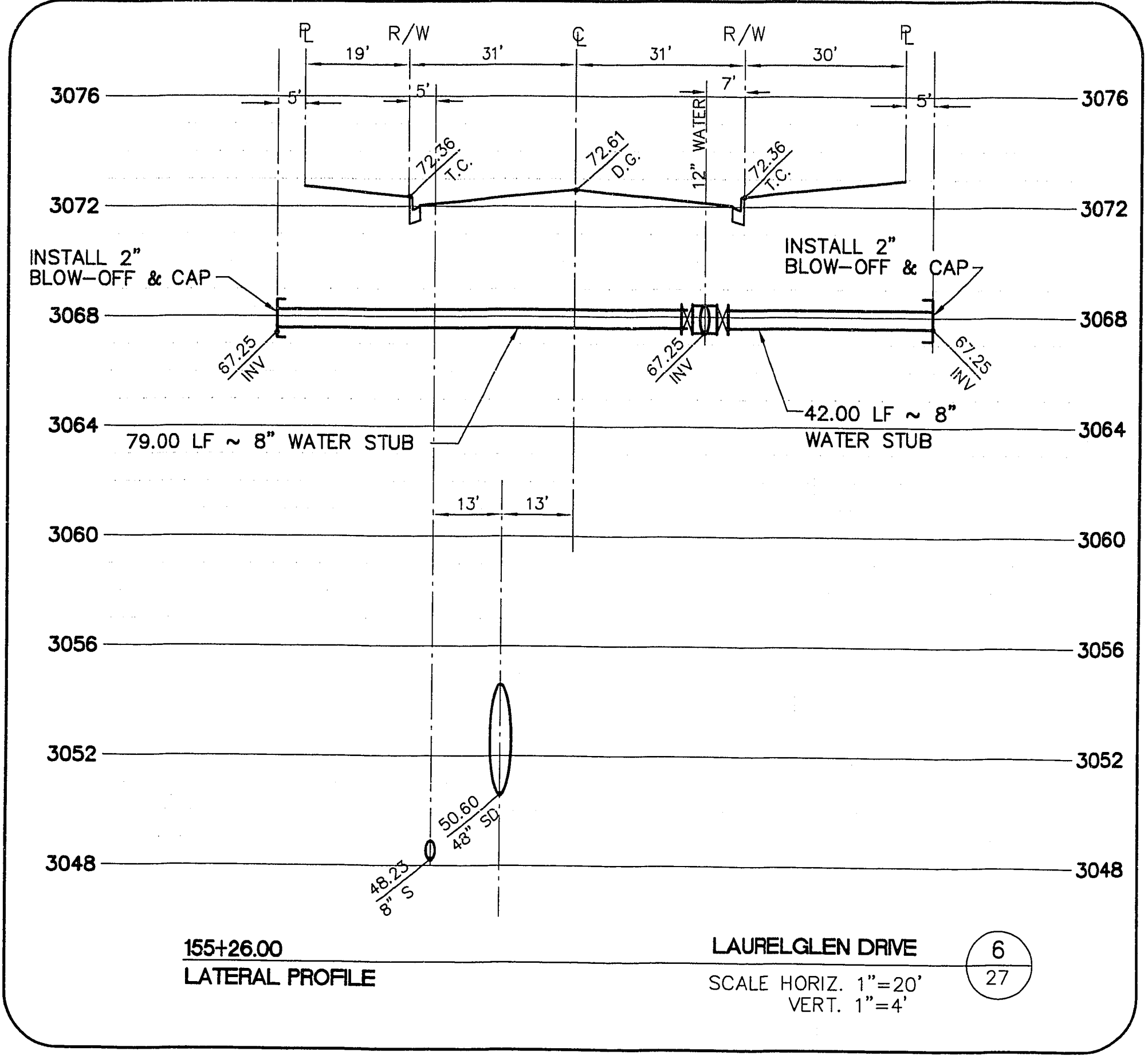
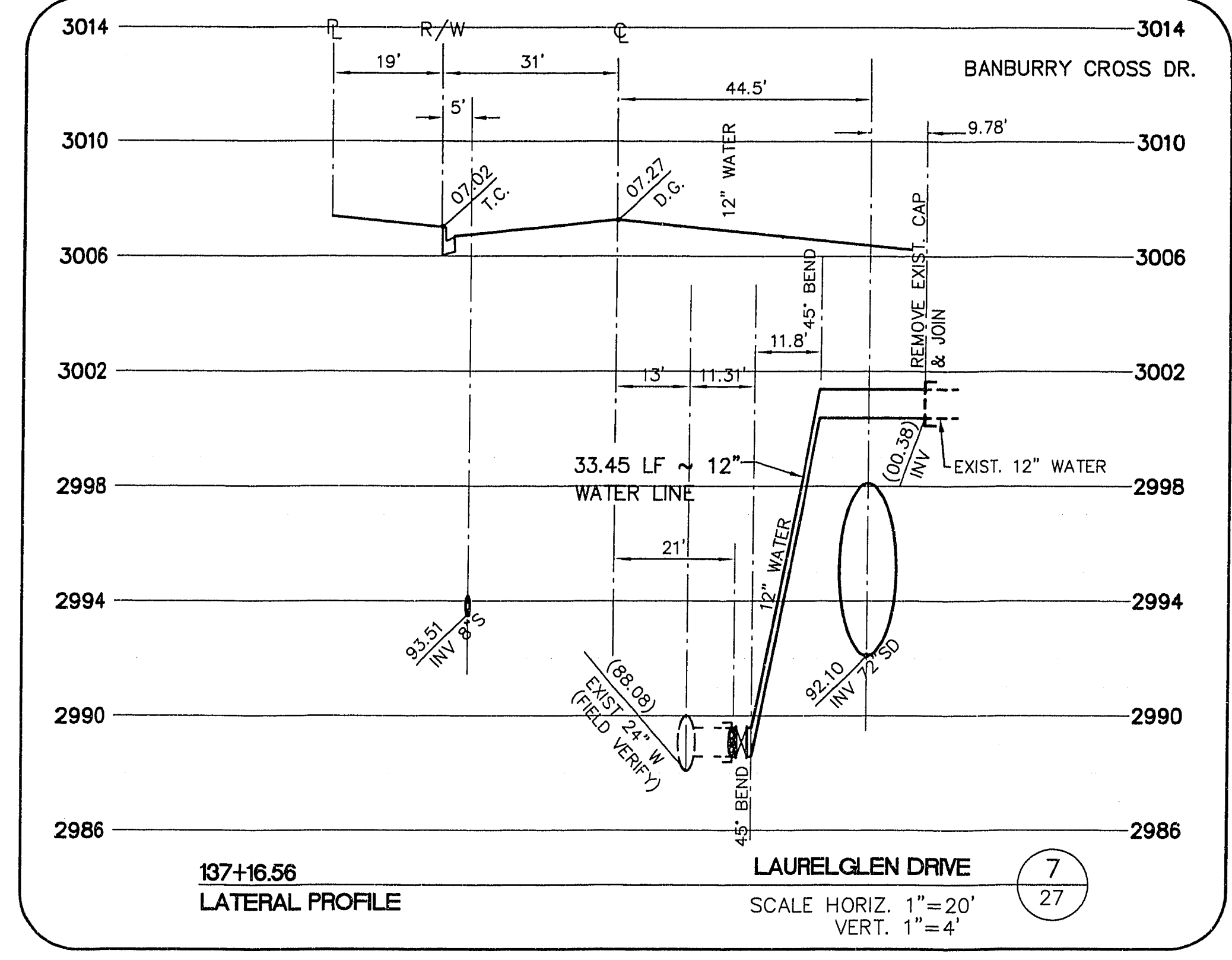
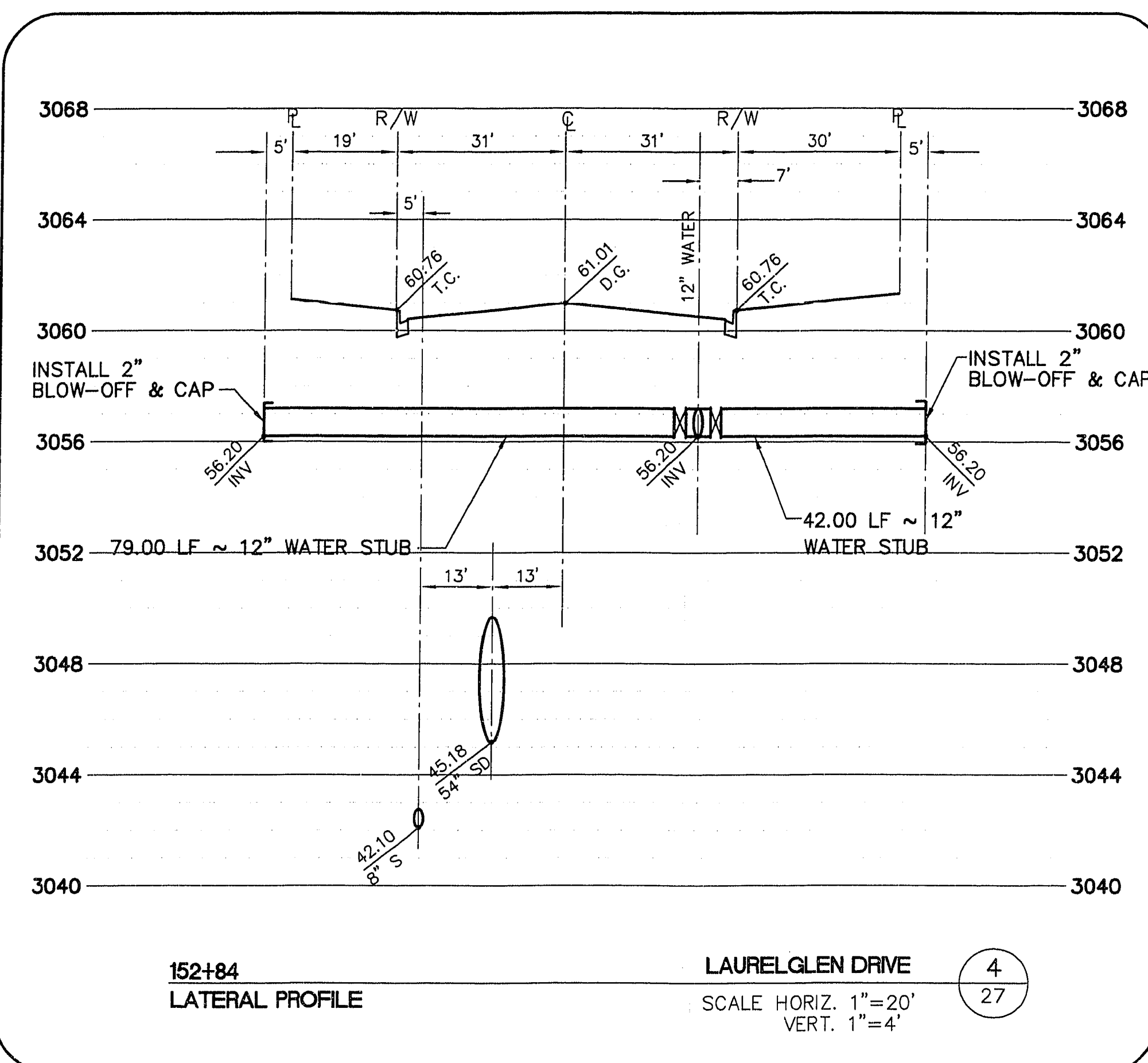
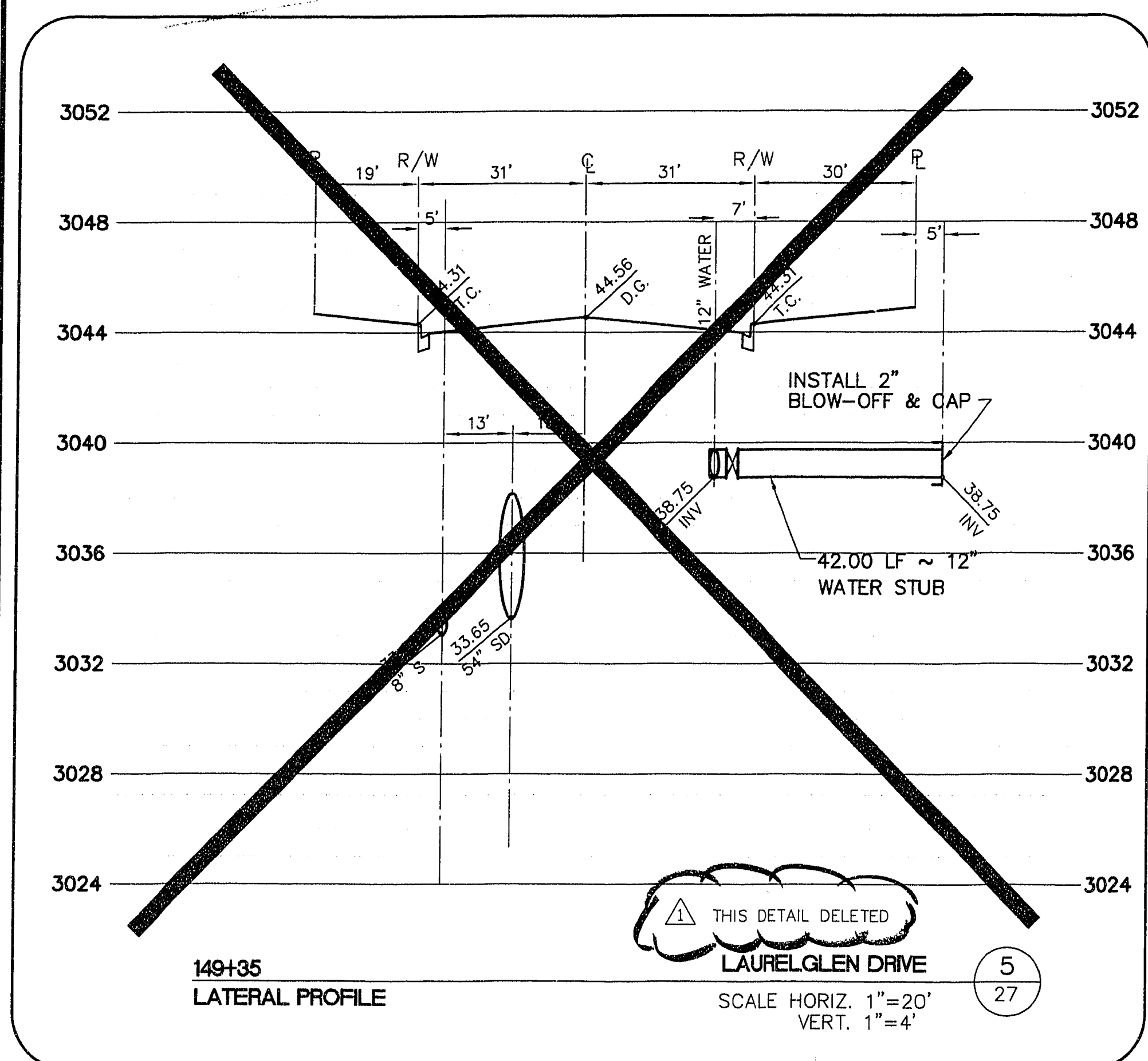

ORIGINALLY SIGNED 9/13/96  
 APPROVED FOR CONSTRUCTION 11/26/96  
 LAS VEGAS VALLEY WATER DISTRICT DATE EBN:018

**FINAL SUBMITTAL**  
 RECOMMENDED  
 ENGINEER  
 G. C. WALLACE, INC.  
 Engineering/Architecture  
 1855 SOUTH RAINBOW BLVD., LAS VEGAS, NEVADA 89102  
 10/18/96 DELETED WATER STUB STA 149+35 TO PARCEL L  
 5071 REVISION DATE  
 12/14/96 DATE  
 SHEET  
**27**  
 SHT 27 OF 46  
**ISSUE TO CONSTRUCT 10/07/96**