

ADJUST ALL EXIST. 3205 ZONE PIPELINE MANHOLES, VALVE COVERS, TEST STATIONS & A.V.A.R. TO MATCH GRADE.

JOIN EXISTING IMPROVEMENTS PER UNIT-2A AS SHOWN ON CLV# 107Y-4463-2A BEGIN CONSTRUCTION STA 118+00

MATCH LINE STA 122+00.00 SEE SHEET 14

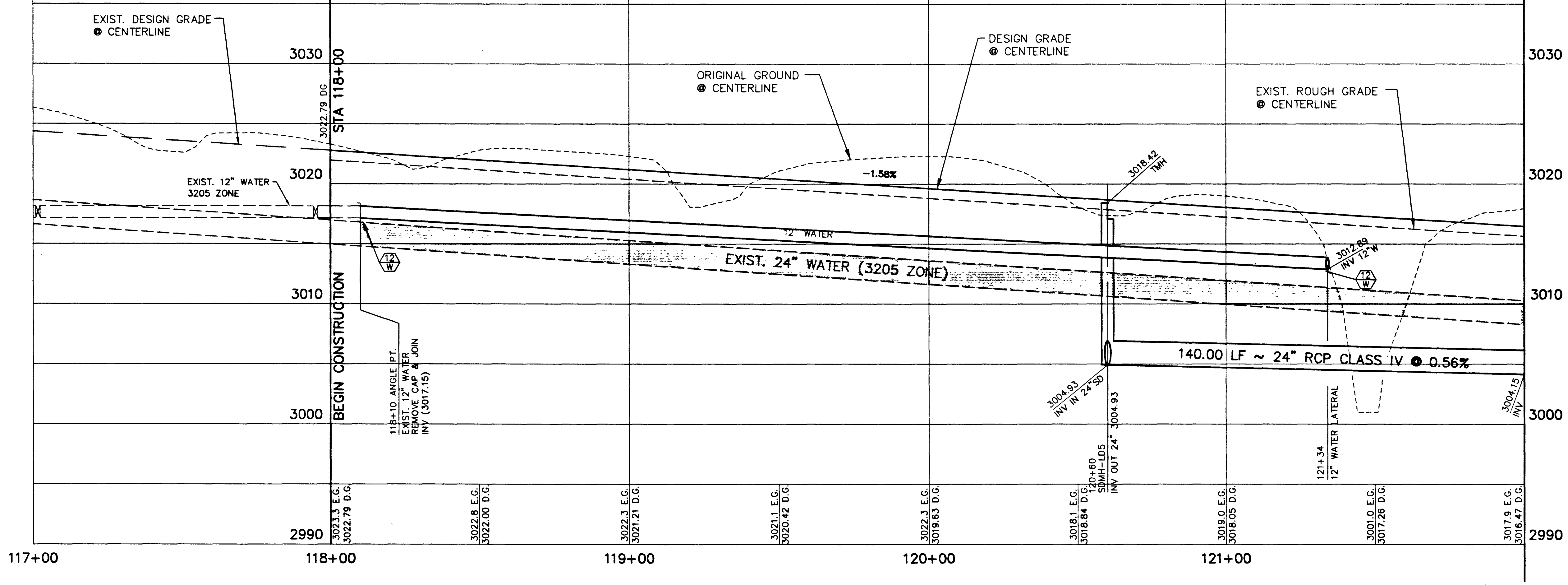

CURVE DATA ① INDICATES CURVE NUMBER (THIS SHEET ONLY)

CURVE	DELTA	RADIUS	LENGTH	TANGENT
1	02°23'16"	2037.00'	84.88'	42.45'
2	02°23'16"	2006.34'	83.70'	41.85'
3	02°23'16"	2000.00'	83.35'	41.68'
4	01°59'40"	1991.63'	51.85'	25.93'
5	10°52'17"	300.00'	56.92'	28.55'
6	11°46'03"	300.00'	61.61'	30.92'
7	02°23'16"	1963.00'	81.81'	40.91'
8	18°00'00"	2.17'	6.82'	---
9	18°00'00"	2.17'	6.82'	---

- CONSTRUCTION NOTES**
- IMPROVEMENTS**
- ① INSTALL "A" TYPE CURB (S-50)
 - ② INSTALL "L" TYPE CURB & GUTTER (S-47)
 - ③ INSTALL AC PAVEMENT PER SECTION SHEETS 37, 38 & 39
 - ④ INSTALL CROSSWALK (S-78)
 - ⑤ INSTALL DEPRESSED CURB (S-75)
- WATER**
- ① INSTALL WATER PIPES PER UD & C STD.
 - ② INSTALL 12" DIA. GATE VALVE & BOX (U-34)
 - ③ INSTALL 6" DIA. GATE VALVE & BOX (U-34)
 - ④ INSTALL 12"x12"x12" TEE (U-34)
 - ⑤ INSTALL 12"x12"x12"x12" CROSS (U-34)
 - ⑥ INSTALL 12"x12" ELBOW (U-34)
 - ⑦ INSTALL 12"x12"x8" TEE (U-34)
 - ⑧ INSTALL 12"x12"x8"x6" CROSS (U-32)
 - ⑨ INSTALL 2" BLOW-OFF & CAP (U-32)
 - ⑩ INSTALL FIRE HYDRANT ASSEMBLY COMPLETE PER (U-33)
 - ⑪ IRRIGATION SLEEVE (U-18)
 - ⑫ GATE VALVE MUST BE IN THE CLOSED POSITION PRIOR TO REMOVAL OF CAP.
 - ⑬ INSTALL THRUST BLOCK ON ALL HORIZONTAL & VERTICAL BENDS, CROSSING & TEES PER L.V.V.W.D. U.D.S. PLATE NO. 5
- STORM DRAIN**
- ① INSTALL STORM DRAIN PIPES PER SUMMERLIN STD. U-20
 - ② INSTALL STORM DRAIN MANHOLE (D1-D10)
 - ③ INSTALL 4" TYPE "A" DROP INLET (D-12)
 - ④ INSTALL TYPE "B" DROP INLET (D-13)
 - ⑤ INSTALL TYPE "C" MODIFIED DROP INLET (SEE PLANS FOR LENGTH) (D-14)
 - ⑥ INSTALL 6" TYPE "A" DROP INLET (D-12)
- SEWER**
- ① INSTALL SEWER PIPES PER SUMMERLIN STD. U-20
 - ② INSTALL SEWER MANHOLE (SD1-B CLV)
- STREET LIGHTING**
- ① INSTALL STREET LIGHT, SEE ELECTRICAL PLANS (E-2)
 - ② STREET LIGHT OR COMMON TRENCH, SEE ELECTRICAL PLANS
- TRAFFIC**
- ① INSTALL 2-3" CONDUIT (E-32)
 - ② INSTALL NO. 5 PULLBOX (E-32)

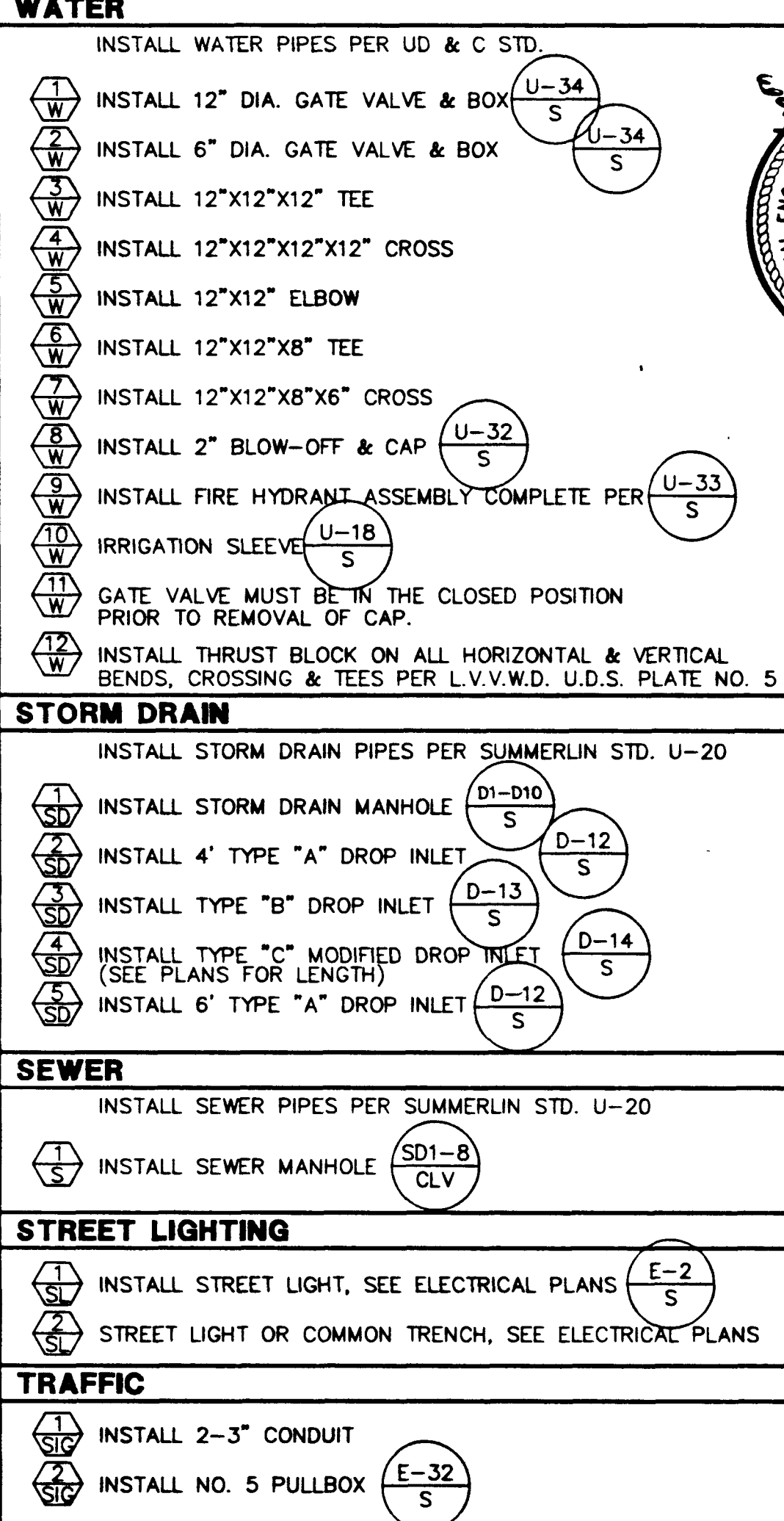

APPROVAL:

Harvey P. Reeves 1/13/96
LAS VEGAS VALLEY WATER DISTRICT DATE

FINAL SUBMITTAL

RECOMMENDED BY: CHRISTOPHER W. ANDERSON

DATE: 11/13/96

STATE OF NEVADA

REGISTERED PROFESSIONAL ENGINEER

NO. 5071

1555 SOUTH RAINBOW, SUITE 100, LAS VEGAS, NEVADA 89102

G.C. WALLACE, INC.
Engineering/Architecture

SUMMERLIN

THE ARBORS AT SUMMERLIN
VILLAGE 11/12 UNIT 2B IMPROVEMENTS
LAUREL GLEN DRIVE
PLAN & PROFILE STA 118+00 TO 122+63.42

SHEET 13

SHT 13 OF 46

