

JOB NO. 62011.212 January 8, 1997 12:28:11 p.m. Drawing: C:\DWG\VLIT-12\24\DETAILS\112A-L52.DWG

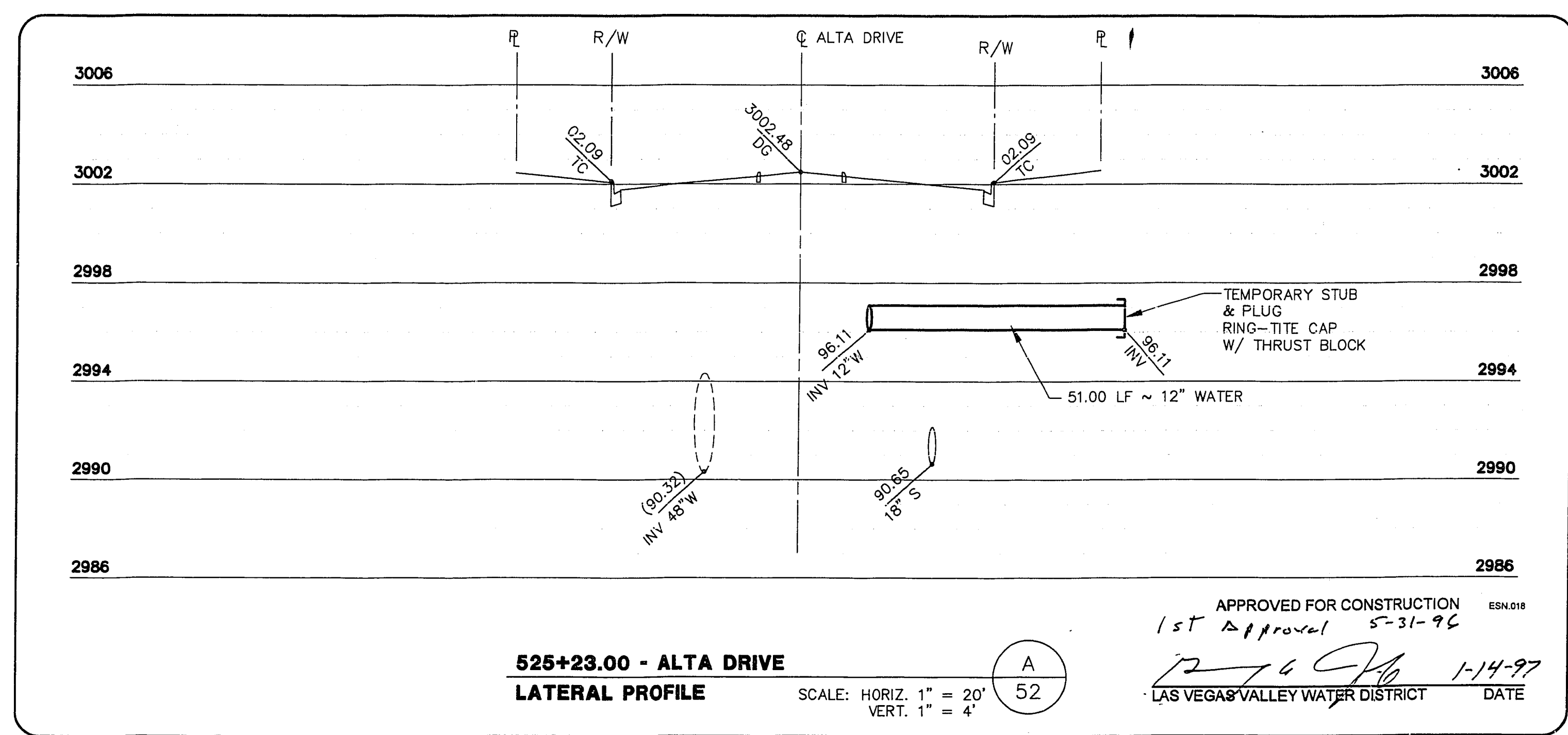
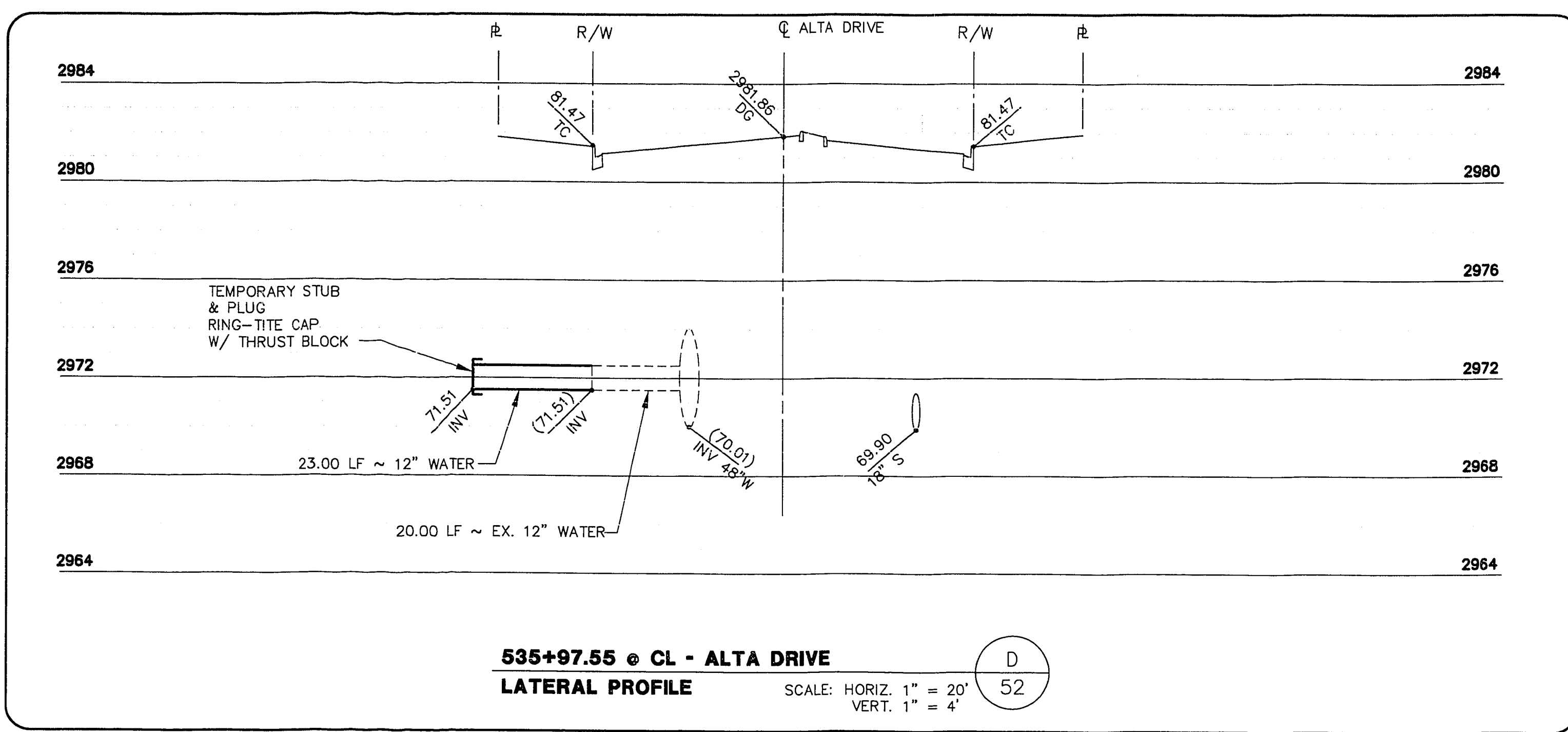
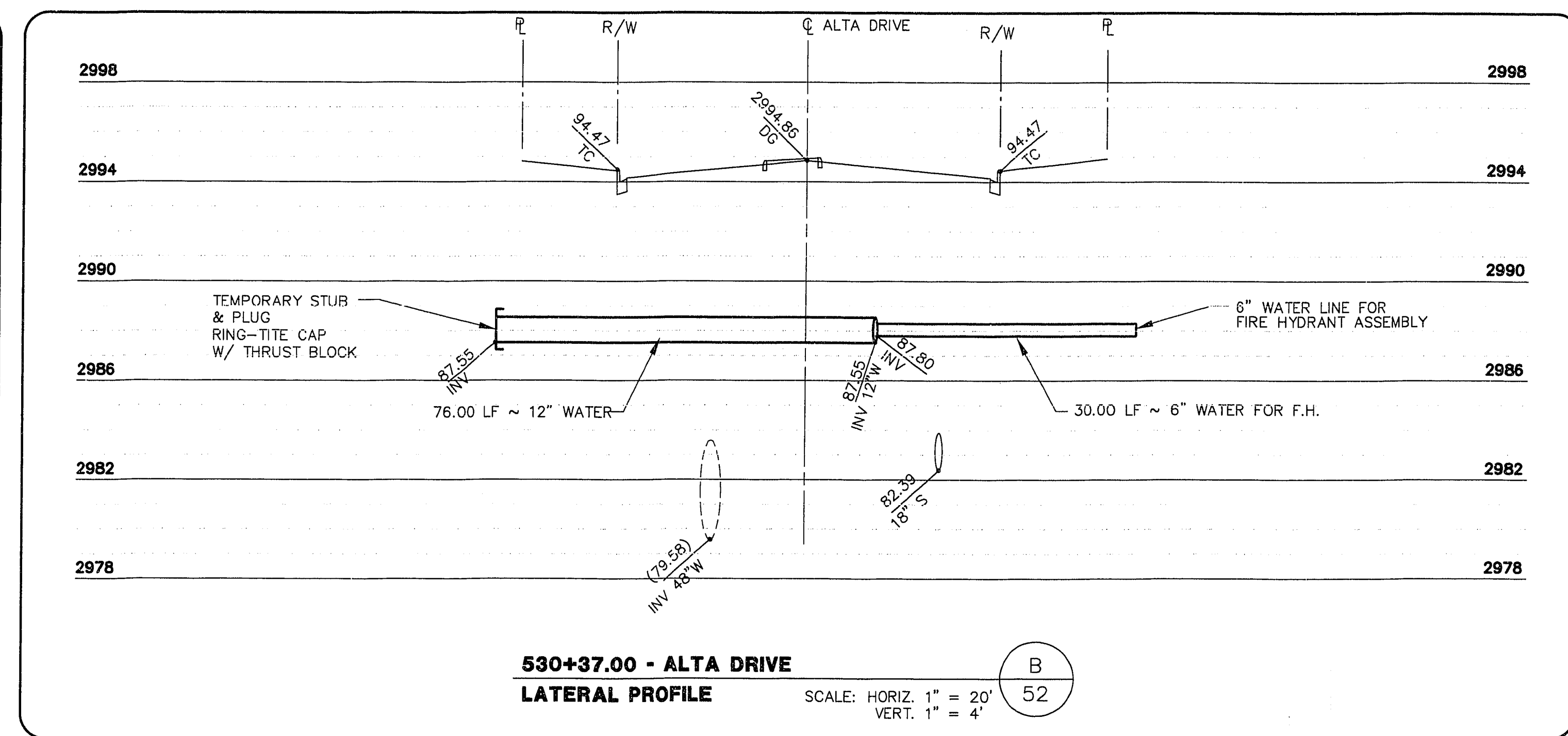
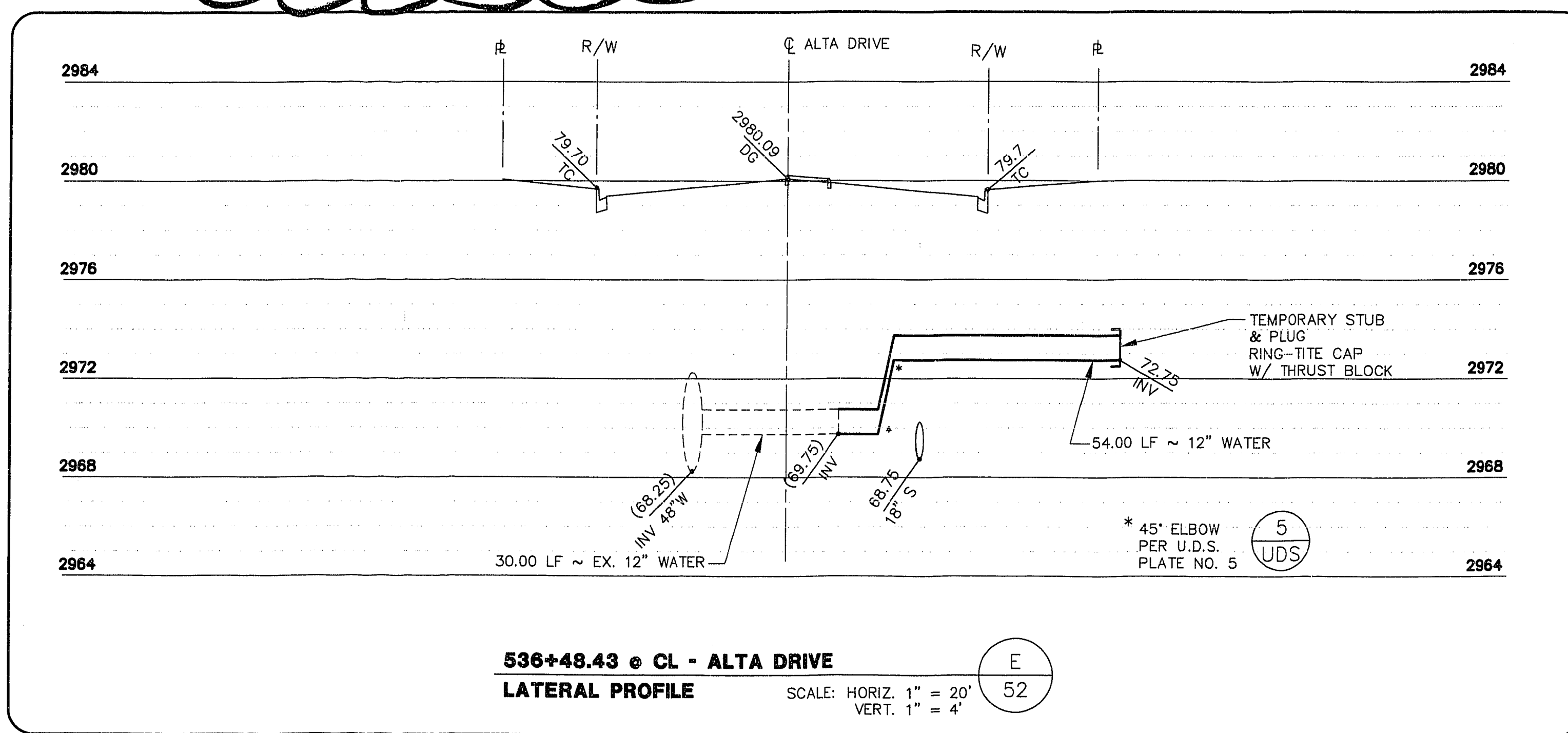
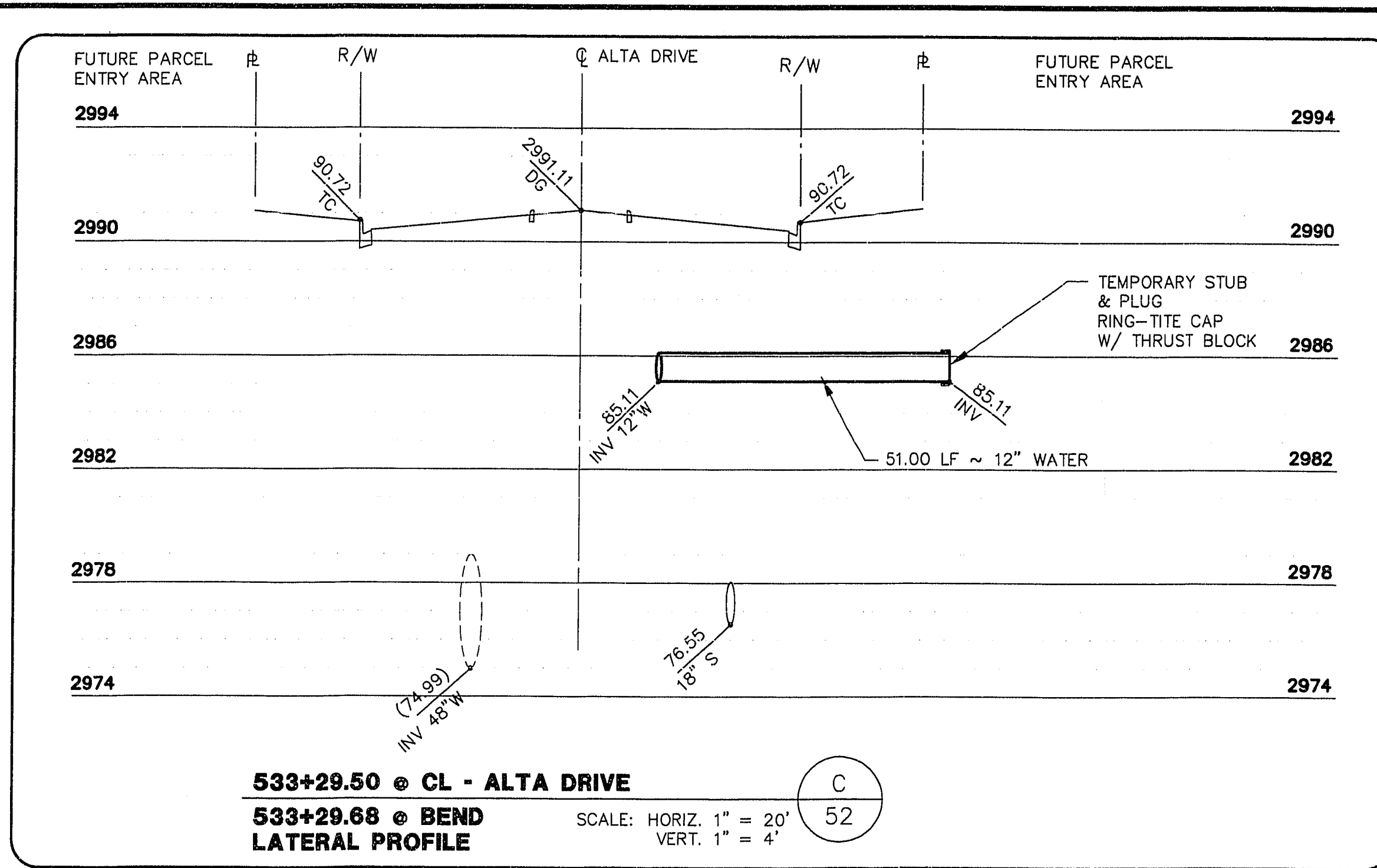
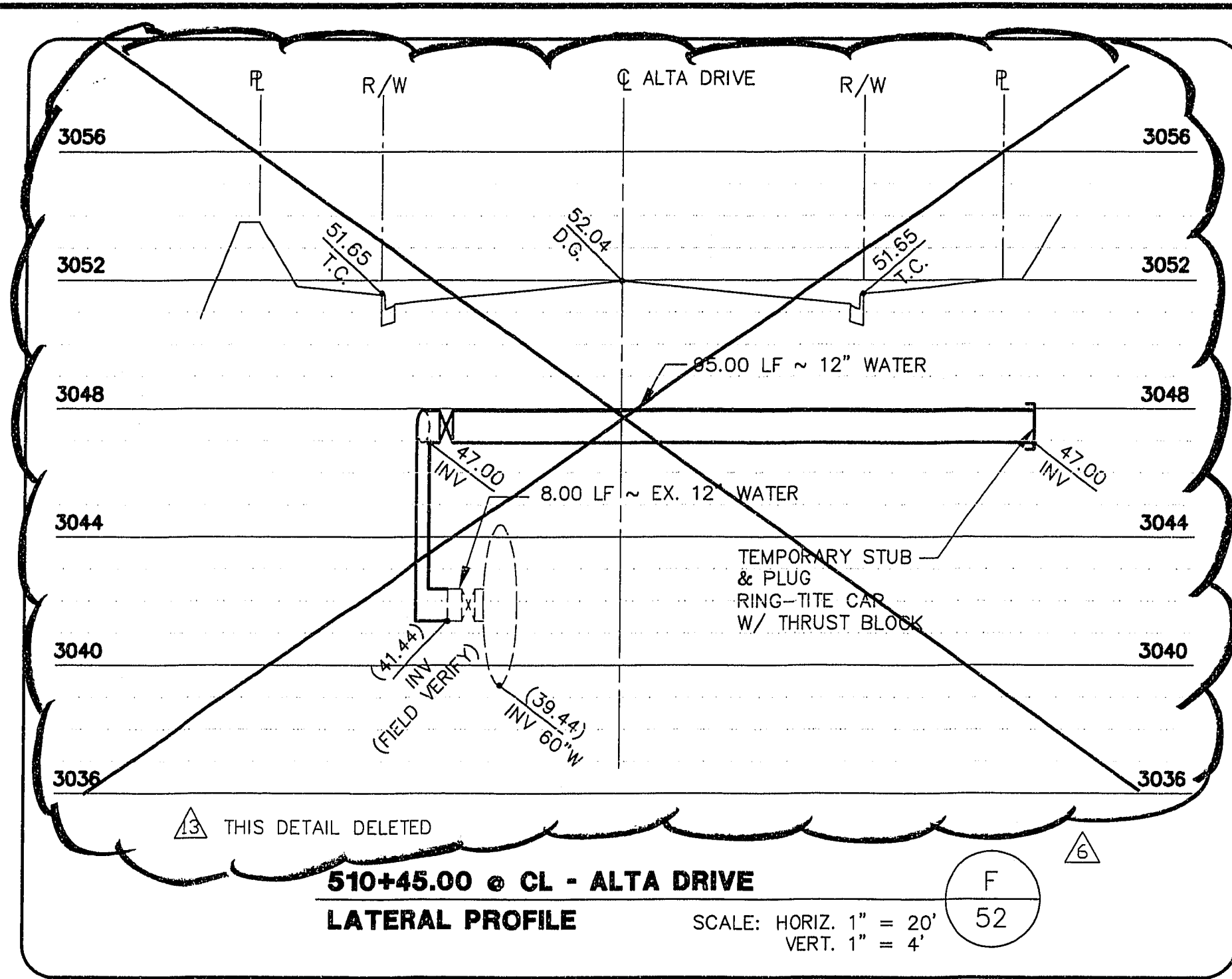
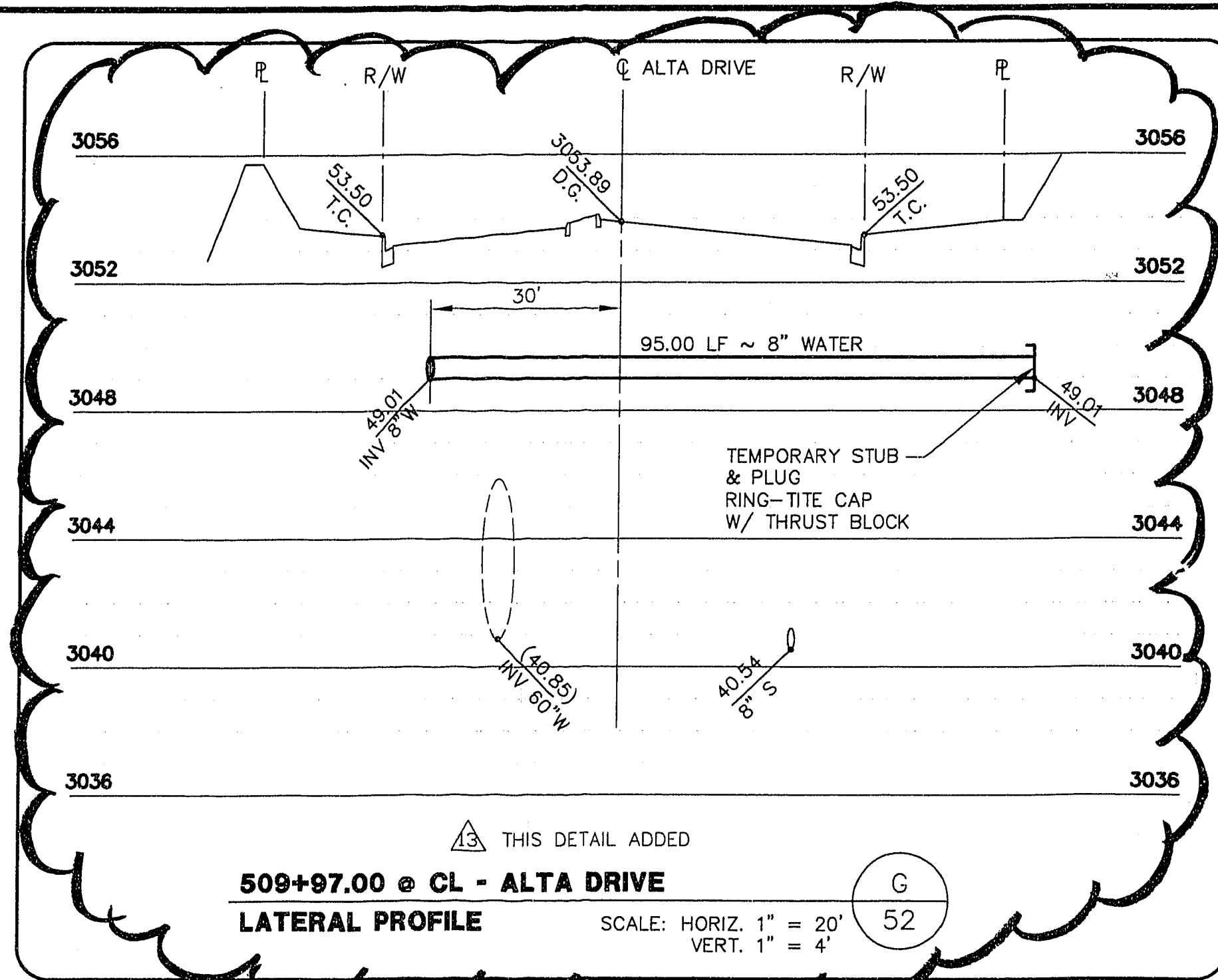

APPROVED FOR CONSTRUCTION
1st Approval 5-31-96
LAS VEGAS VALLEY WATER DISTRICT
DATE 1-14-97

RECOMMENDED	DATE	DESCRIPTION
CHRISTOPHER W. ANDERSON	7/7/97	ADD WATER STUB TO PARCEL NW-1 (FORMERLY PARCEL MW-2) DELETE STUB TO PARCEL NW-2
5071	8/7/96	DELETED WATER STUB TO H.S. ADD WATER STUB TO PARCEL MW-1

REVISIONS

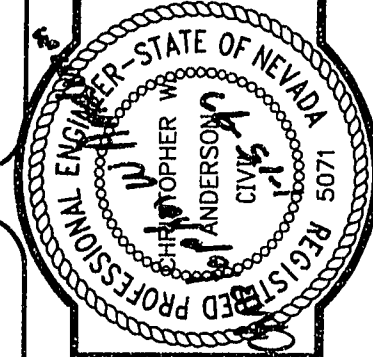

G. C. WALLACE, INC.
Engineering/Architecture
1555 SOUTH RAINBOW BLVD/LAS VEGAS, NEVADA 89102

SUMMERLIN
VILLAGE 11/12 THE ARBORS - UNIT 2A
ALTA DRIVE
WATER LATERALS

SHEET
52
SHT 52 OF 64

FINAL SUBMITTAL

11-32-176

567Y-4463-2A