

A.P.N.
163-04-701-001

BASIS OF BEARING
THE NORTH LINE OF THE NORTHWEST QUARTER (NW 1/4) OF THE SOUTHEAST QUARTER (SE 1/4) OF SECTION 4, TOWNSHIP 21 SOUTH, RANGE 60 EAST, M.D.M., CITY OF LAS VEGAS, CLARK COUNTY, NEVADA, AS SHOWN ON THE PLAT IN BOOK 45, OF PLATS, PAGE 75, OFFICIAL RECORDS OF CLARK COUNTY, NEVADA, WHICH BEARS: SOUTH 89°23'00" EAST

BENCHMARK
CITY OF LAS VEGAS BENCH MARK NO. 0LV10-4E4
RIVET AND PLATE IN TOP OF CURB @ NW CORNER OF BUFFALO DRIVE AND OAKEY BLVD.
ELEVATION 2531.57 FEET, NAVD 1988 DATUM

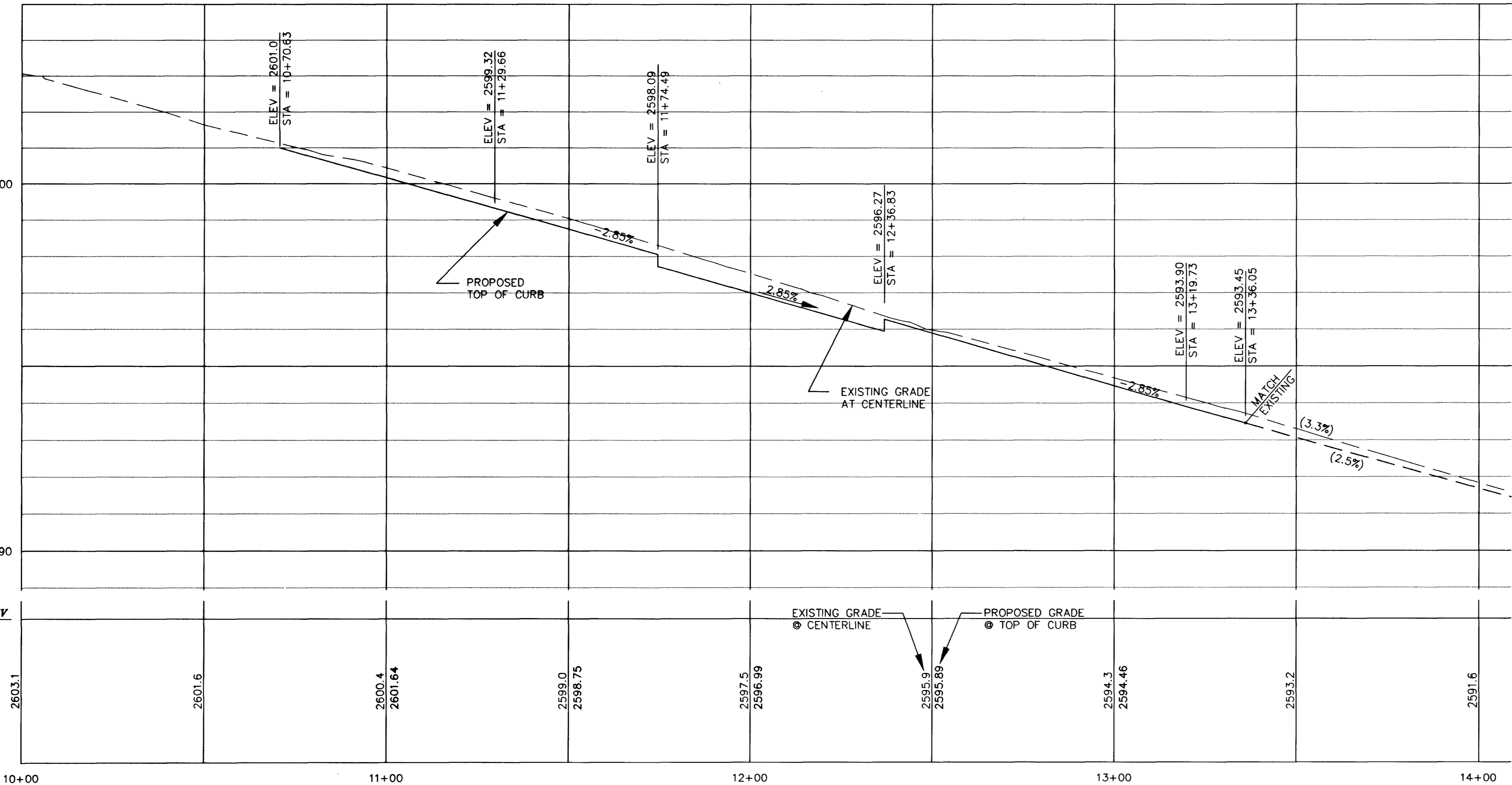

LINE TABLE

No.	BEARING	DISTANCE
L1	S00°37'00"W	1.54'
L2	N89°23'00"W	3.85'
L3	S89°23'00"E	3.06'
L4	S00°37'00"W	1.40'

CURVE TABLE

No.	RADIUS	DELTA	LENGTH	TANGENT
C1	10.00'	81°22'23"	14.20'	8.60'
C2	10.00'	180°00'00"	31.42'	---
C3	15.00'	97°35'10"	25.55'	17.13'
C4	30.62'	37°39'13"	20.12'	10.44'
C5	14.59'	49°09'05"	12.52'	6.67'
C6	41.57'	13°09'37"	9.55'	4.80'
C7	57.07'	13°04'56"	13.03'	6.54'
C8	43.92'	31°20'12"	24.02'	12.32'
C9	10.12'	53°58'27"	9.53'	5.15'
C10	2.75'	28°20'25"	1.36'	0.70'
C11	17.38'	31°27'11"	9.54'	4.89'
C12	45.60'	13°42'08"	10.91'	5.48'
C13	62.39'	23°31'48"	25.62'	12.99'
C14	27.59'	53°12'01"	25.62'	13.82'
C15	29.59'	58°34'48"	30.26'	16.60'
C16	71.52'	24°15'13"	30.27'	15.37'
C17	82.85'	08°47'45"	12.72'	6.37'
C18	30.00'	94°45'19"	49.61'	32.60'
C19	15.00'	90°00'00"	23.56'	15.00'
C20	30.00'	24°11'37"	12.67'	6.43'
C21	30.00'	58°56'30"	30.86'	16.95'
C22	5.00'	145°15'07"	12.68'	15.98'
C23	5.00'	90°00'00"	7.85'	5.00'
C24	23.00'	109°59'16"	44.15'	32.84'
C25	31.00'	75°34'14"	40.89'	24.03'
C26	15.00'	55°34'57"	14.55'	7.91'
C27	25.00'	90°00'00"	39.27'	25.00'

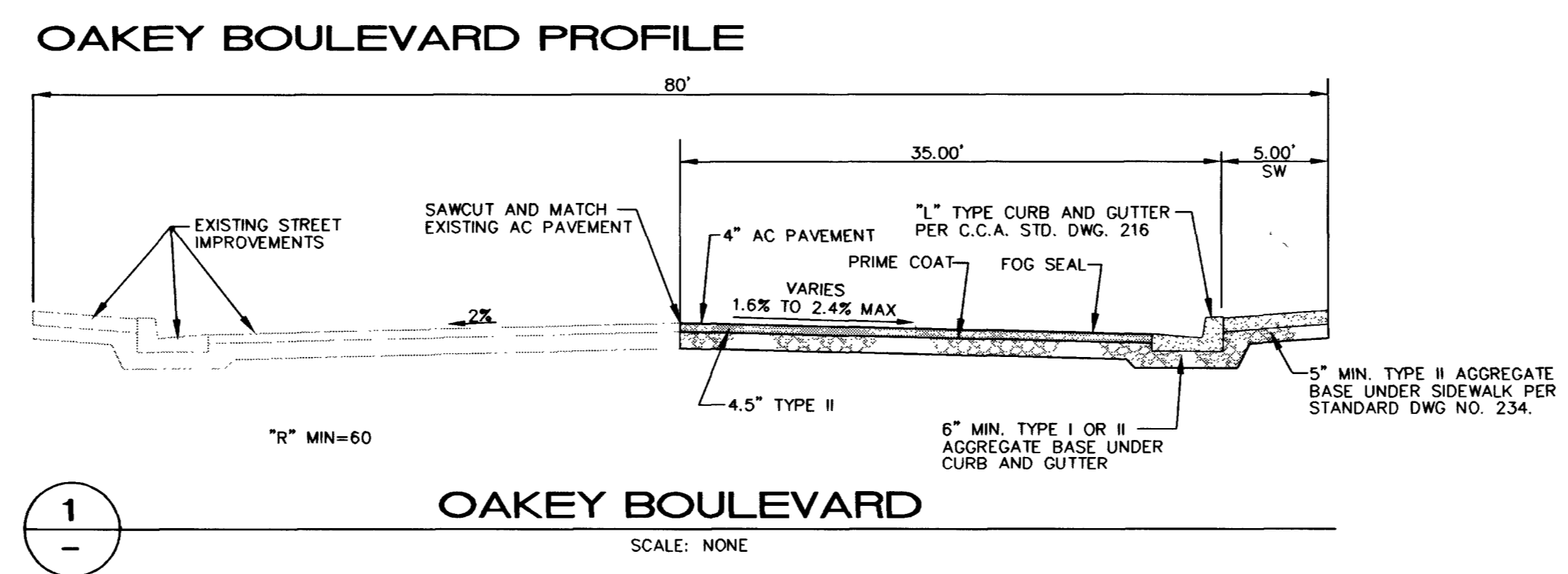

CALL BEFORE YOU OVERHEAD
1-702-593-6111

NOTICE!
EXISTING UTILITIES ARE SHOWN ON PLANS FOR THE CONVENIENCE OF THE CONTRACTOR ONLY. THE CONTRACTOR IS RESPONSIBLE FOR THE PROTECTION OF ALL UTILITIES. THE ENGINEER BEARS NO RESPONSIBILITY FOR UTILITIES NOT SHOWN OR SHOWN INCORRECTLY.

Call BEFORE YOU DIAL
1-800-227-2600

PINNACLE ARCHITECTURAL STUDIO
8670 W. SPRING Mtn RD, SUITE 102
LAS VEGAS, NEVADA 89117
(702) 656-5955

ENGINEERING COMPANY
50 So. Jones #202, Las Vegas, NV, 89107
Telephone: (702) 877-1300

ZEPHYRENE VILLALUZ RESIDENCE
S/E COR. OAKEY & CIMARRON

OAKEY BOULEVARD PLAN AND PROFILE

SCALE: 1" = 20'

PROJECT NO: 208610

CHECKED BY: [Signature]

DESIGNED BY: [Signature]

DRAWN BY: [Signature]

PROFESSIONAL ENGINEER
GEORGE SPINNEY JR.
No. 7844
EXPIRES 12/31/2004

SHEET PP1
6 OF 7 SHEETS
DRAWING NO. 107-13674

208610.MP.DWG

50177