

SOUTHWEST GAS CORPORATION

F-CLV 2015 SS-YUCCA & FRANCIS
 CITY OF LAS VEGAS, NV
 WR# 1994603

LEGEND:

- EXISTING GAS LINE
- GAS LINE TO BE ABANDONED
- EXISTING GAS SERVICE
- PROPOSED MAIN GAS LINE (NEW)
- PROPOSED SERVICE LATERAL (NEW)
- PROPOSED SERVICE LINE (NEW)
- RIGHT OF WAY LINE
- STREET CENTERLINE
- PROPERTY LINE
- BACK OF CURB
- MATCHLINE
- EASEMENT
- EXISTING ANODELESS RISER
- EXISTING ANODE RISER
- EXISTING GAS LIGHT
- EXISTING GAS VALVE

SHEET INDEX

1. COVER SHEET
2. MATERIALS AND SIGNATURE SHEET
3. STEEL MATERIALS AND SIGNATURE SHEET
4. DESIGN PLAN
5. DETAIL SHEET - "A" & "B"

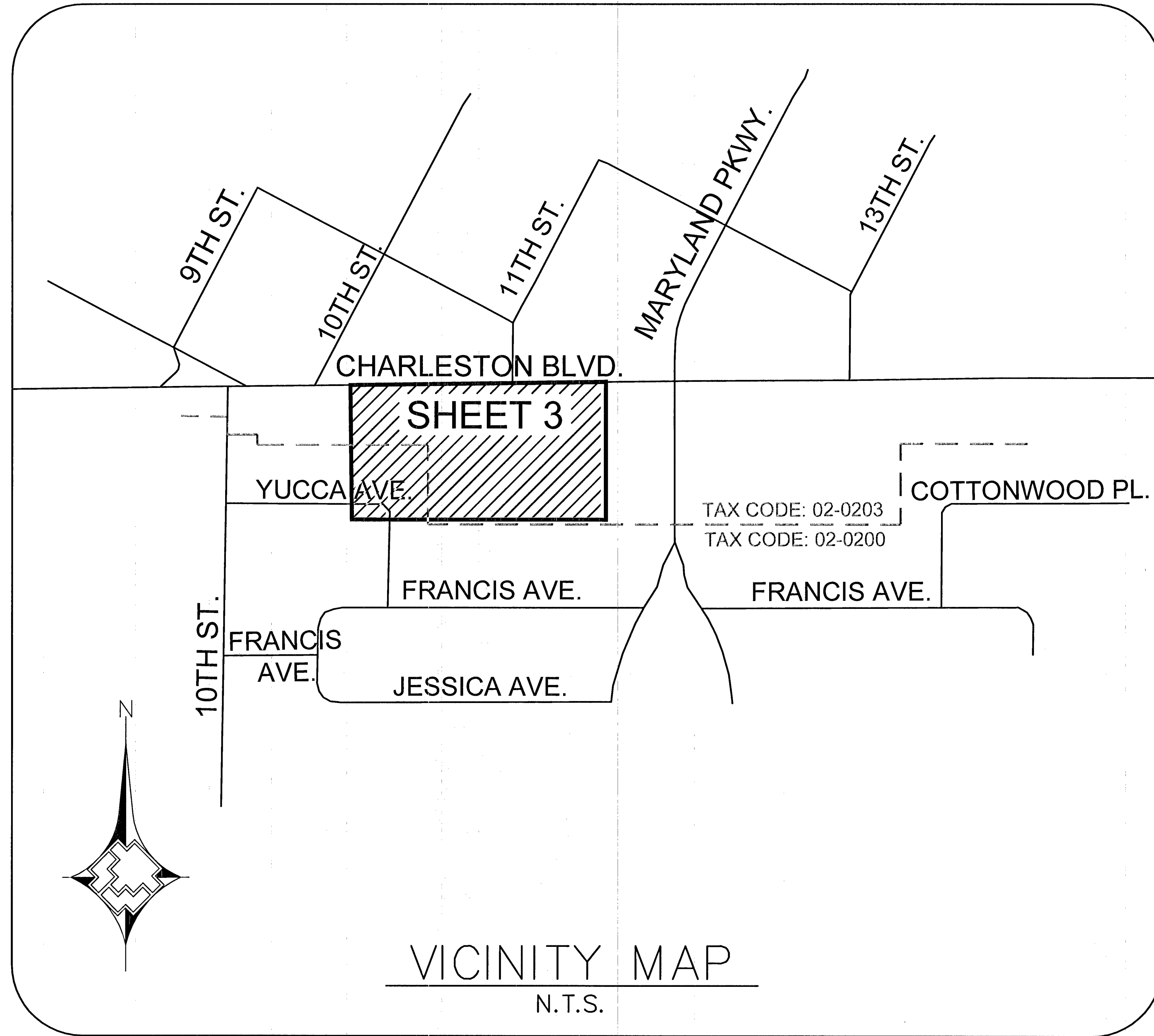
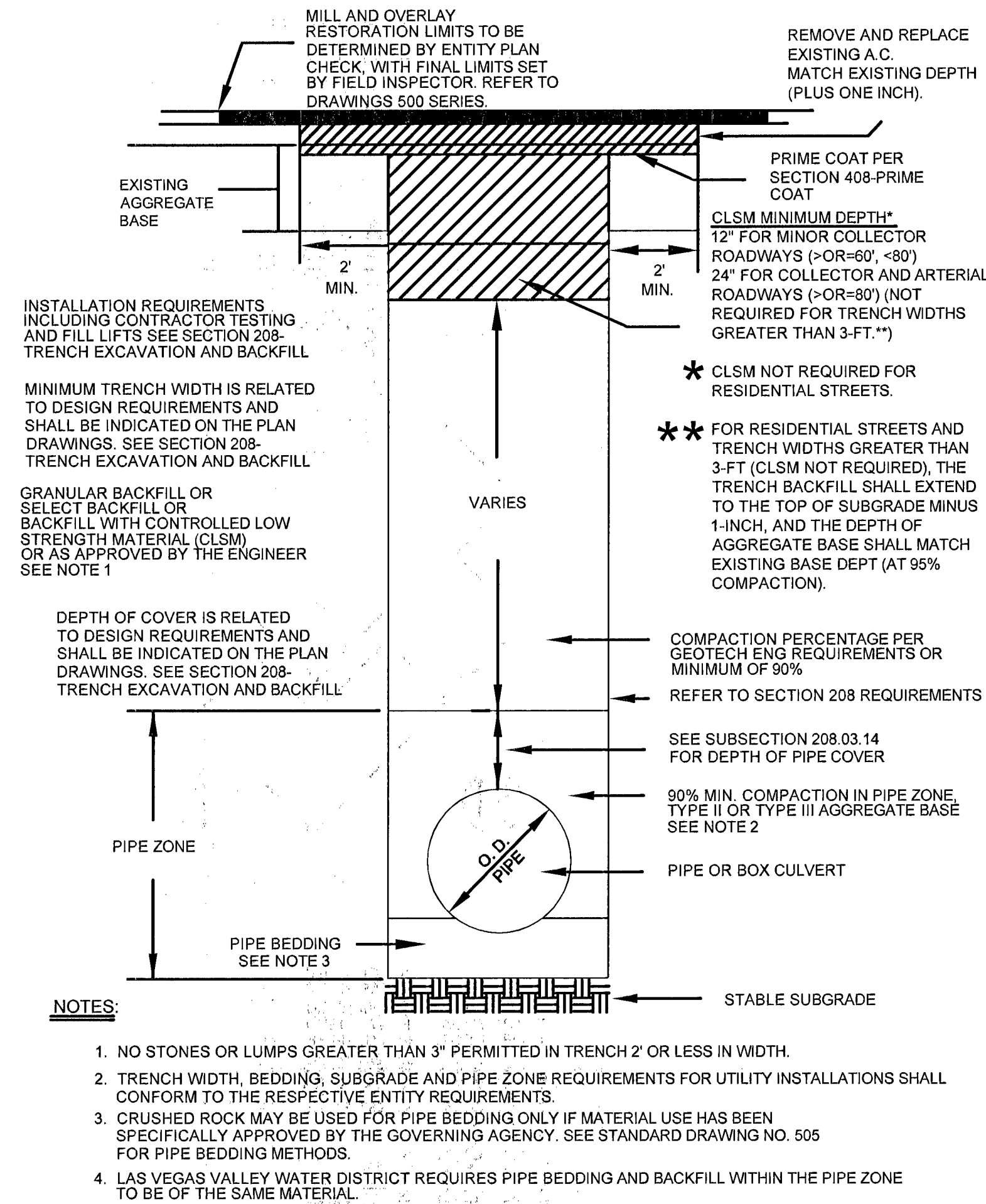

RTC STD DWG 503



Total footage located in Public ROW 675'

APPROVED FOR CONSTRUCTION

THIS APPROVAL IS FOR WORK IN CLV R/W OR CLV EASEMENTS ONLY. OBTAINING PERMISSIONS OR EASEMENTS FOR WORK SHOWN ON PRIVATE PROPERTY IS THE RESPONSIBILITY OF THE UTILITY.

APPROVAL: DATE: 3/24/15

Hansen 58387 Dwg 102V3665-GAT

NO.	DESCRIPTION	BY	DATE	APPVD
REVISIONS				

TAX CODES	UNIT NO.	UNIT TYPE	INSTL. PROPOSED	RETIRED	INSTL. COMPLETED	RETIRED

AS-BUILT DRAWING-PRESSURE TEST DATA

PIPE DIA.	TEST MEDIUM	TEST METHOD
	<input type="checkbox"/> AIR <input type="checkbox"/> NITROGEN <input type="checkbox"/> WATER	<input type="checkbox"/> GAUGE <input type="checkbox"/> CHART <input type="checkbox"/> SOAP PRESS REC SN#

VISUAL INSPECTION CERTIFICATION

I HAVE VISUALLY INSPECTED ALL HEATED FUSIONS, SOLVENT CEMENT, MECHANICAL JOINTS, AND WELDS THAT I HAVE PERFORMED.

NAME: SEE SHEET 2 DATE: SEE SHEET 2

AS-BUILTS ACCEPTED BY: _____ DATE: _____
 POSTED BY: _____ DATE: _____
 POSTING APPROVED BY: _____ DATE: _____

CONSTRUCTION

INSPECTOR: SEE SHEET 2
 FOREMAN: SEE SHEET 2
 REVIEWED BY: SEE SHEET 2

PERMIT INFORMATION

CITY OF LAS VEGAS
 TAX CODE: 02-0203

ISOLATION AREA	W.R. NO.
ISO_21 DIST_293	1994603
LOCATION	ATLAS #/TITLE #
T21S R61E SEC 3	x630y512

ENGINEER/TECH:	PHONE:	
MARIA RUSHING	702-365-2008	
ACCOUNT REP:	PHONE:	
MARIA RUSHING	702-365-2008	
SHEET NO.:	SCALE:	DATE:
1 OF 5	N.T.S.	11/18/14
DWN. BY:	CHKD. BY:	APPVD. BY:
ZONE ENG		
TITLE		
F-CLV 2015 SS-YUCCA & FRANCIS		