

W:\Active\18147028\Drawings\unit 2 plans\02-UT1.dwg (patrow Mon, 09 Jun 2003 - 1:58pm)

54900 55561

MATCHLINE - SEE SHEET 16

MATCHLINE - SEE SHEET 19

APN 125-22-501-001
UNDEVELOPED

PRIVATE STREET NOTE
NOTE: ALL PRIVATE STREETS ARE PUBLIC DRAINAGE EASEMENTS, CLY SEWER AND PUE EASEMENTS TO BE PRIVATELY MAINTAINED BY THE HOME OWNERS ASSOCIATION.

NOTE:
INSTALL PIPELINE MARKER BALLS IN TRENCH ABOVE EACH HORIZONTAL ELBOW FITTING, PER MANUFACTURER INSTRUCTIONS.

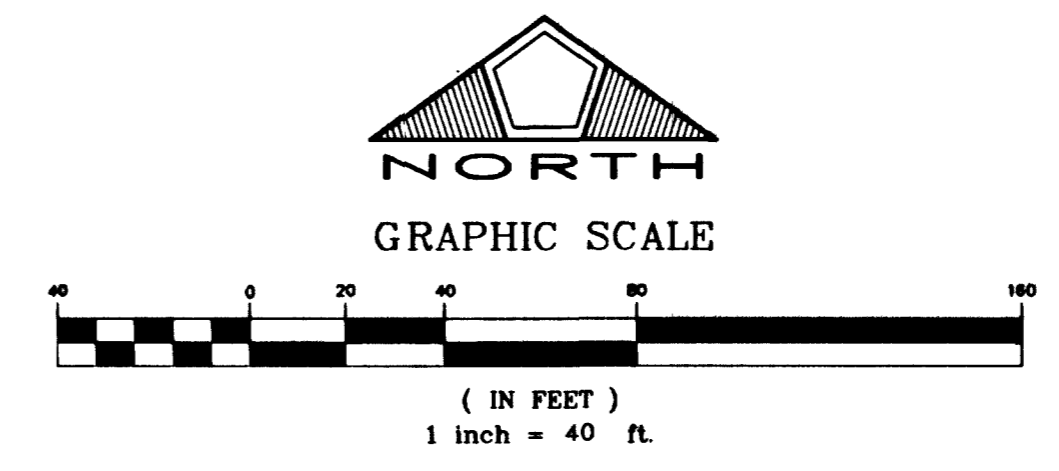

CONTRACTOR SHALL FIELD LOCATE AND PROTECT ALL SNWA/SNWS APPURTENANCES INCLUDING, BUT NOT LIMITED TO, A/VAR, ACCESS MANNWAYS AND CATHODIC PROTECTION SYSTEMS. ALL ABOVE GROUND STRUCTURES AND AT GRADE STRUCTURES MUST BE ADJUSTED TO NEW GRADE AT CONTRACTORS EXPENSE. CATHODIC PROTECTION TEST STATIONS, RECTIFIERS, AND A/VAR'S MUST BE RELOCATED TO SIDEWALK PER SNWA STANDARDS AND AT CONTRACTORS EXPENSE. CONTRACTOR TO NOTIFY SOUTHERN NEVADA WATER AUTHORITY DEVELOPMENT-BLANK REVIEW AT (702) 832-3444 AT LEAST 48 HOURS PRIOR TO CONSTRUCTION ACTIVITY.

SOUTHERN NEVADA WATER AUTHORITY DATE _____
SNWA APPROVAL IS VALID FOR ONE (1) YEAR FROM SIGNATURE DATE. IF CONSTRUCTION WITHIN THE EASEMENT OR RESTRICTED PIPE SAFETY ZONE IS NOT COMPLETE, PLANS MUST BE RESUBMITTED TO SNWA FOR APPROVAL.

BENCHMARK
CITY OF LAS VEGAS BENCHMARK NO. 1LVS0 11WS. RIVET AND PLATE IN TOP OF CURB, SOUTHEAST CORNER OF RAINBOW BLVD AND FLANAGAN DRIVE.
ELEVATION = 724.3103 METERS (NAVD '88 PUBLISHED)
ELEVATION = 2376.34 U.S. SURVEY FEET (NAVD '88 CALCULATED)
PROJECT ELEVATION = 2376.52 U.S. SURVEY FEET

BASIS OF BEARING
THE BASIS OF BEARING FOR THIS SURVEY IS THE WEST LINE OF THE SOUTHEAST QUARTER (SE 1/4) OF SECTION 15, TOWNSHIP 19 SOUTH, RANGE 60 EAST, M.D.M., CLARK COUNTY, NEVADA, AS SHOWN IN

MANHOLE SCHEDULE
SEE SHEET 19

TRAFFIC LEGEND
L 9" O3 STREET NAME SIGN (PER STD DWG 250)
O 30" STOP SIGN (R1-1) LOCATE AT BCR
- BLUE REFLECTIVE MARKER
- STREET SIGN AS NOTED PER PLAN

APPROVALS
Richard Bell 6/10/03
CITY FIRE MARSHAL DATE
Sally Khan 7/18/03
LAS VEGAS VALLEY WATER DISTRICT DATE

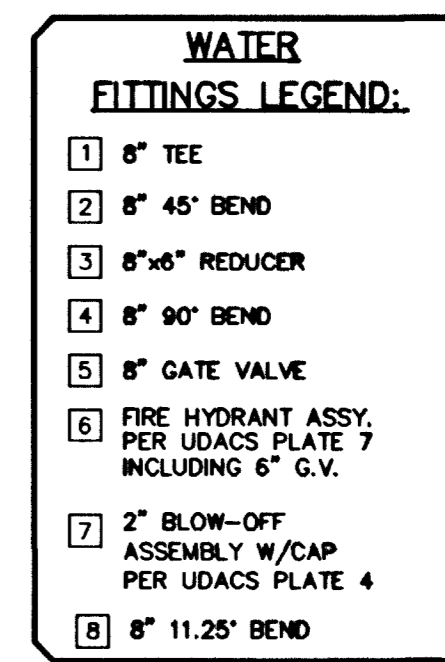
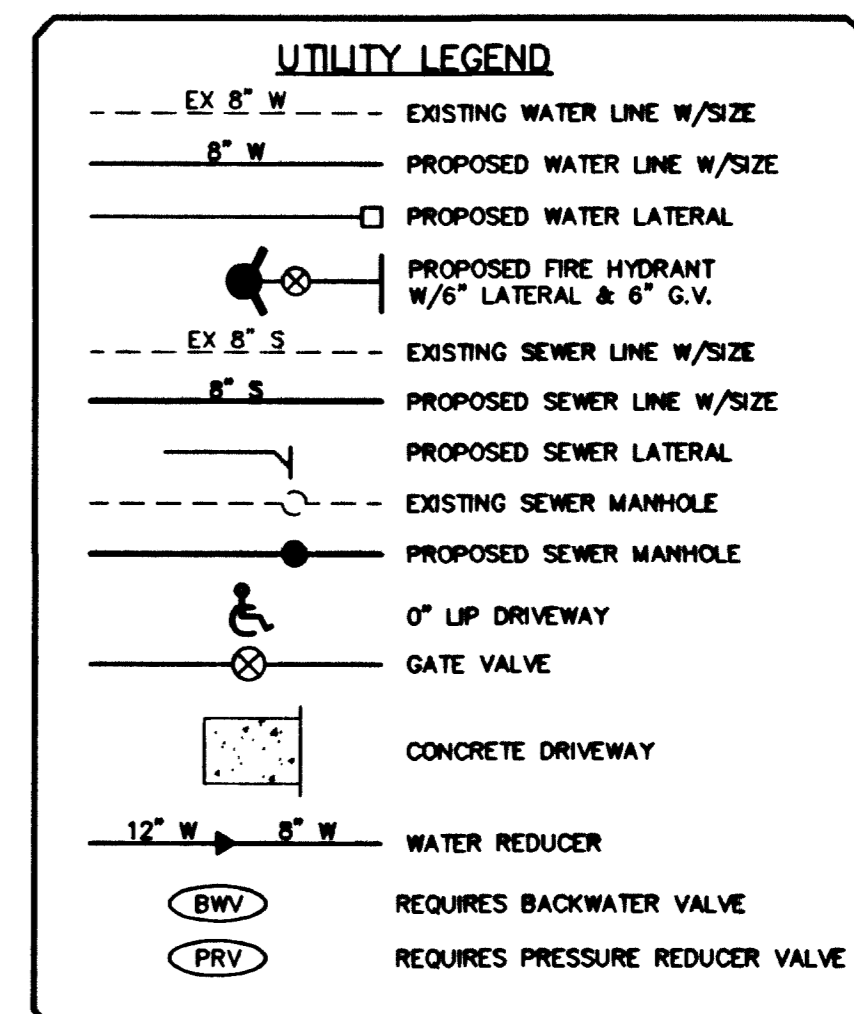
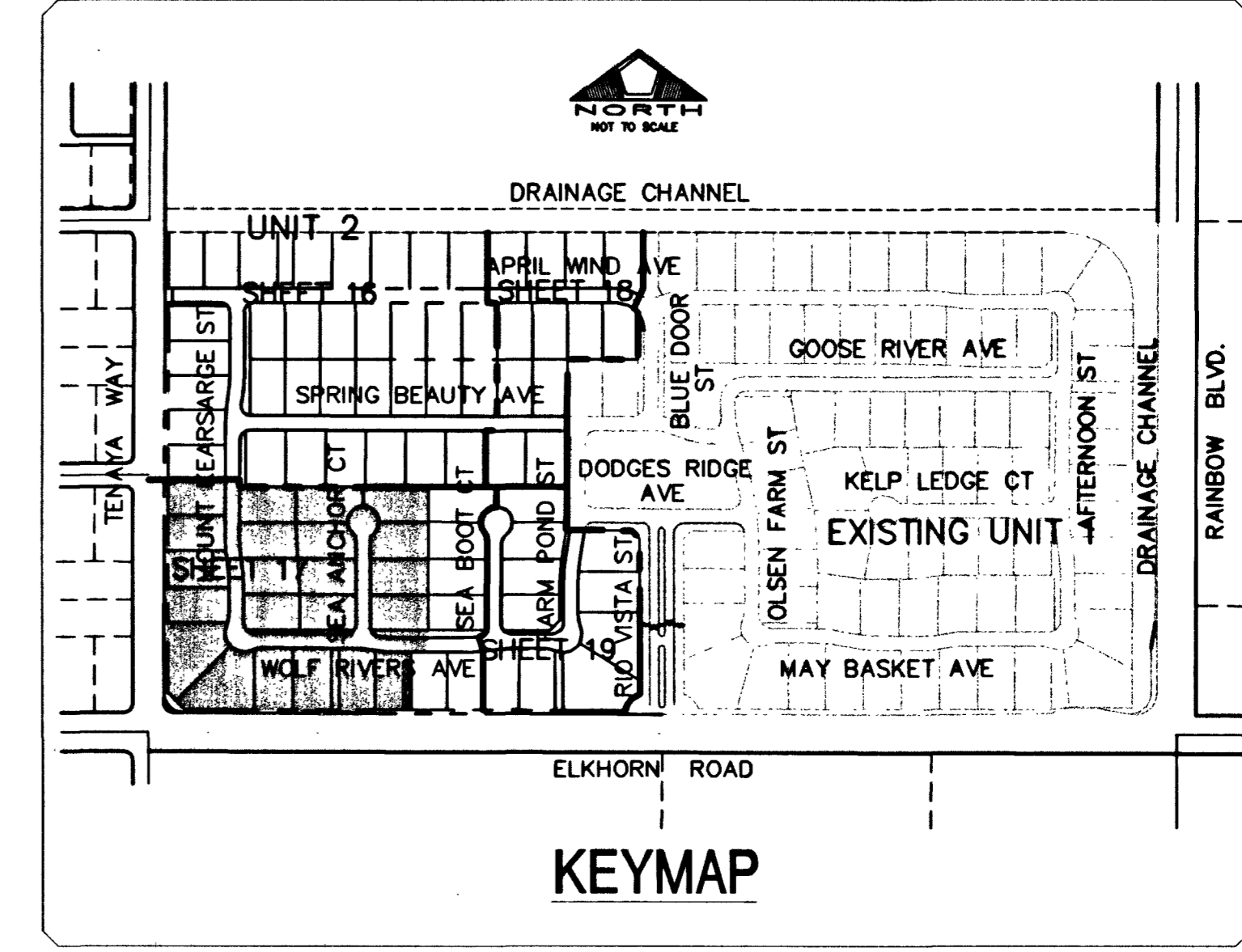

Call before you Dig
1-800-227-2600
www.callbeforeyoudig.com

Call before you Dig
Overhead
1-702-593-6111

NO.	DESCRIPTION	DATE	APP'D

DATE: 6/9/2003
S.L.Y.
DRAWN BY: D.L.
DESIGNED BY: R.P.S.
CHECKED BY: R.W.C.
ADA CHECKED:
JOB NO.: 88147028
SCALE: 1"=40'

Stanlec Consulting Inc.
7251 West Charleston Blvd.
Las Vegas NV U.S.A.
89117
Tel: 702.258.0115
Fax: 702.258.4956
www.stanlec.com

1633 VILLAGE CENTER CIRCLE, SUITE 250
LAS VEGAS, NV, U.S.A. 89134
(702) 258-7880

PULTE HOMES
WYETH RANCH UNIT 2
UTILITY & TRAFFIC PLAN 2

PROFESSIONAL ENGINEER - STATE LICENSED
RICHARD A. BELL
11/12/84
CIVIL
3447

SHEET
17
OF 20

16744699-2